

**TIP PROJECT: B-4088**

STATE OF NORTH CAROLINA  
 DIVISION OF HIGHWAYS  
 PLAN FOR PROPOSED  
 HIGHWAY EROSION CONTROL  
**CRAVEN COUNTY**

**LOCATION: BRIDGE NO 74 OVER BRANCH UPPER BROAD CREEK  
 ON SR 1615**  
**TYPE OF WORK: GRADING, PAVING, DRAINAGE, AND STRUCTURE**

STATE	STATE PROJECT REFERENCE NO.	SHEET NO.	TOTAL SHEETS
N.C.	B-4088	EC-1	
STATE PROJ. NO.	F.A. PROJ. NO.	DESCRIPTION	

**EROSION AND SEDIMENT CONTROL MEASURES**

Std. #	Description	Symbol
1630.03	Streambank Reforestation	
1630.05	Temporary Silt Ditch	
1605.01	Temporary Diversion	
1606.01	Temporary Silt Fence	
1606.01	Special Sediment Control Fence	
1622.01	Temporary Berms and Slope Drains	
1630.01	Riser Basin	
1630.02	Silt Basin Type B	
1633.01	Temporary Rock Silt Check Type-A	
1633.01	Temporary Rock Silt Check Type-B	
1634.01	Temporary Rock Sediment Dam Type-A	
1634.02	Temporary Rock Sediment Dam Type-B	
1635.01	Rock Pipe Inlet Sediment Trap Type-A	
1635.02	Rock Pipe Inlet Sediment Trap Type-B	
1630.04	Stilling Basin	
Rock Inlet Sediment Trap:		
1632.01	Type A	
1632.02	Type B	
1632.03	Type C	
	Skimmer Basin	
	Tiered Skimmer Basin	

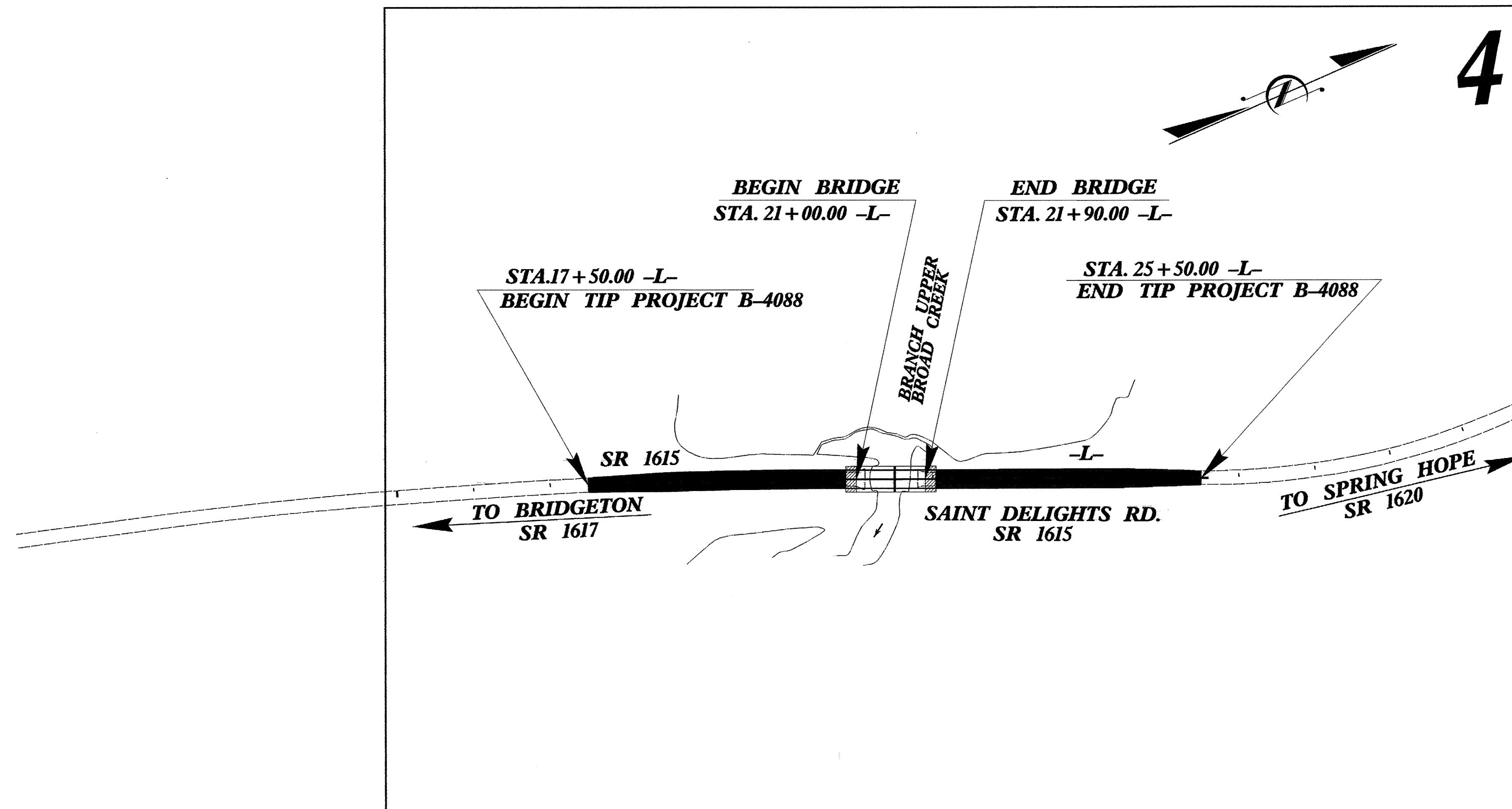

**THIS PROJECT CONTAINS  
 EROSION CONTROL PLANS  
 FOR CLEARING AND  
 GRUBBING PHASE OF  
 CONSTRUCTION.**

**THIS PROJECT HAS  
 BEEN DESIGNED TO  
 SENSITIVE WATERSHED  
 STANDARDS.**

**ENVIRONMENTALLY  
 SENSITIVE AREA(S) EXIST  
 ON THIS PROJECT**  
*Refer To E. C. Special Provisions  
 for Special Considerations.*

**GRAPHIC SCALE**

0

PLANS

0

PROFILE (HORIZONTAL)

0

PROFILE (VERTICAL)

ROADSIDE ENVIRONMENTAL UNIT  
 DIVISION OF HIGHWAYS  
 STATE OF NORTH CAROLINA

Prepared In the Office of:  
**ROADSIDE ENVIRONMENTAL UNIT**  
 1 South Wilmington St.  
 Raleigh, NC 27611  
**2006 STANDARD SPECIFICATIONS**

Roadway Standard Drawings

The following roadway english standards as appear in "Roadway Standard Drawings"- Roadway Design Unit - N. C. Department of Transportation - Raleigh, N. C., dated July 18, 2006 and the latest revision thereto are applicable to this project and by reference hereby are considered a part of these plans.

1605.01 Temporary Silt Fence	1630.05 Temporary Diversion
1606.01 Special Sediment Control Fence	1632.03 Rock Inlet Sediment Trap Type C
1607.01 Gravel Construction Entrance	1633.01 Temporary Rock Silt Check Type A
1622.01 Temporary Berms and Slope Drains	

I:\projects\007\_1421\07-14-06\08\env\22502.dwg

PROJECT REFERENCE NO. <i>B-4088</i>	SHEET NO. EC-2/CONST.4
RW SHEET NO.	
ROADWAY DESIGN ENGINEER	HYDRAULICS ENGINEER

CLEARING AND GRUBBING  
EROSION CONTROL FOR  
CONSTRUCTION SHEET 4

NOTE:  
PLACE TEMPORARY ROCK SILT CHECKS TYPE - A AT  
DRAINAGE OUTLETS.

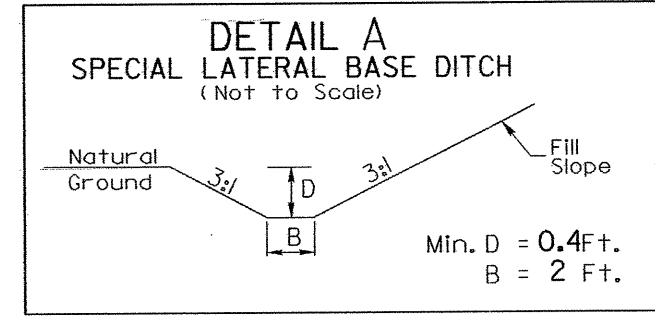

23+00 TO 24+30 RT-L-  
EST. DDE = 11.0 CY

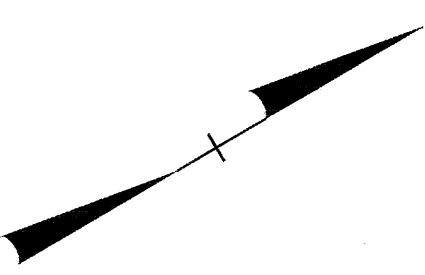

- NOTES:
- THERE IS NO PROPOSED RIGHT OF WAY FOR THIS PROJECT.
  - PAVE TO FACE OF GUARDRAIL
  - SEE SHEET 5 FOR -L- PROFILE
- L- POT STA. 25+50.00  
END TIP PROJECT B-4088

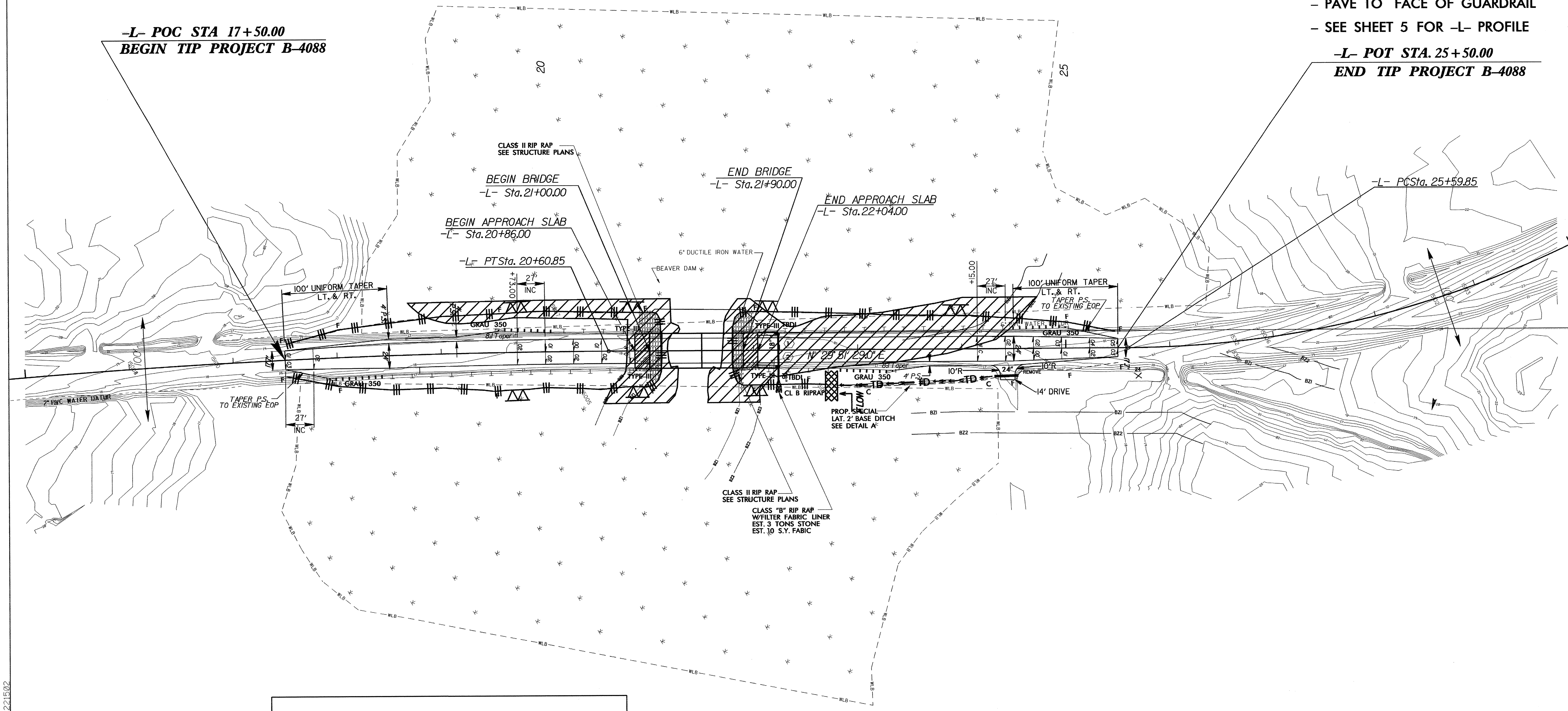

-L- POC STA 17+50.00  
BEGIN TIP PROJECT B-4088

-L- PCSta. 25+59.85

**SHOULDER BERM GUTTER LOCATIONS:**  
BEGIN: -L- STA. 22+04.00 LT.  
END: -L- STA. 22+25.00 LT  
BEGIN: -L- STA. 22+04.00 RT.  
END: -L- STA. 22+25.00 RT

**ENVIRONMENTALLY SENSITIVE AREA**  
SEE PROJECT SPECIAL PROVISIONS

PROJECT REFERENCE NO. B-4088	SHEET NO. EC-3/CONST.4
RW SHEET NO.	
ROADWAY DESIGN ENGINEER	HYDRAULICS ENGINEER

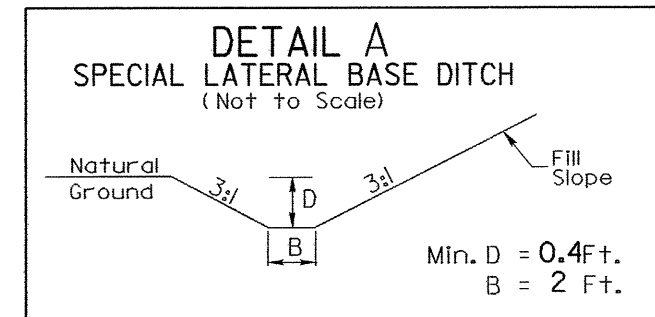

23+00 TO 24+30 RT-L-  
EST. DDE = 11.0 CY

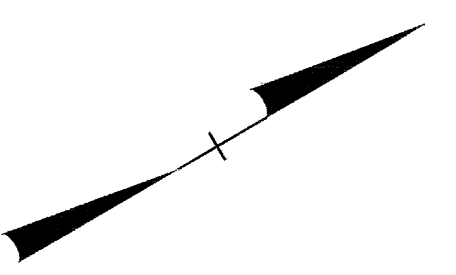

- NOTES:**
- THERE IS NO PROPOSED RIGHT OF WAY FOR THIS PROJECT.
  - PAVE TO FACE OF GUARDRAIL
  - SEE SHEET 5 FOR -L- PROFILE
- L- POT STA. 25+50.00**  
**END TIP PROJECT B-4088**

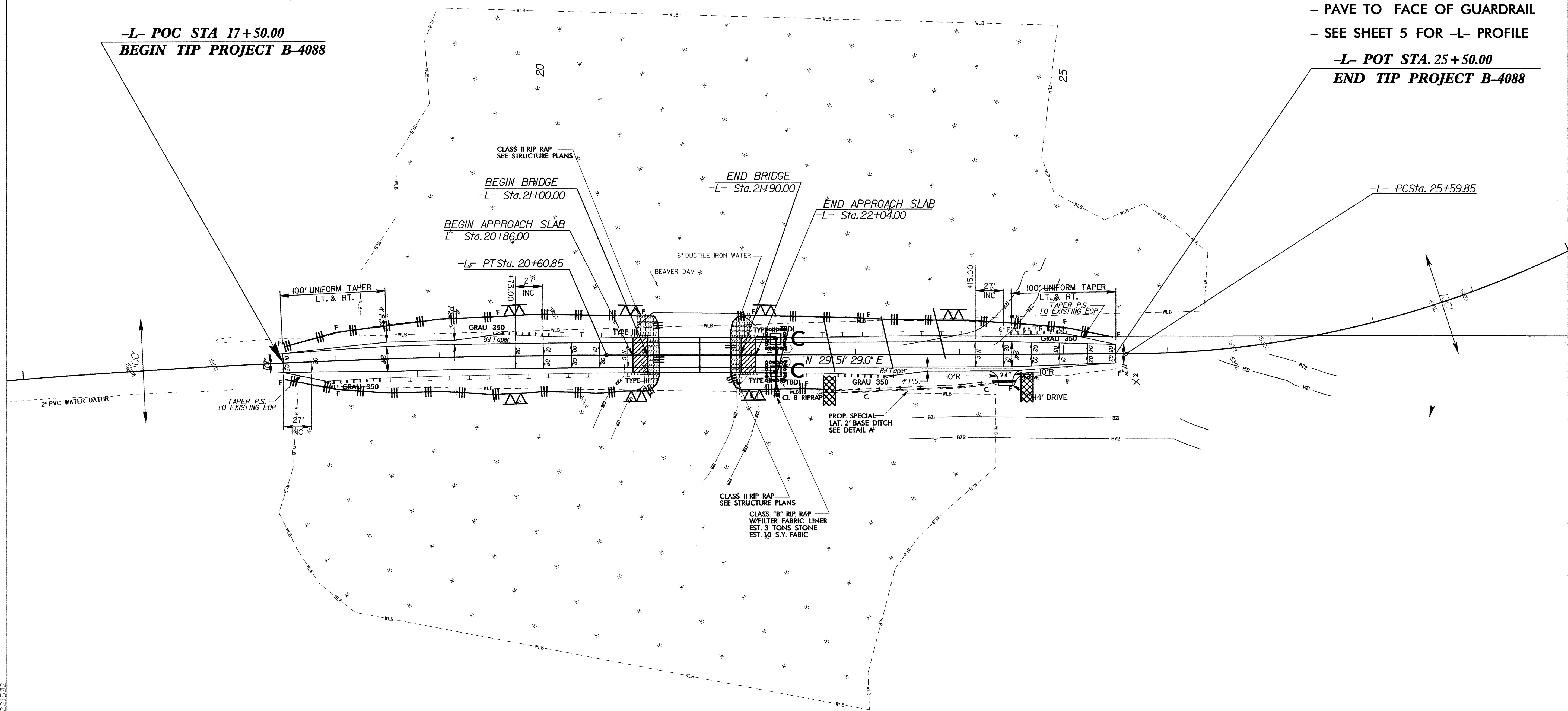

**SHOULDER BERM GUTTER LOCATIONS:**  
 BEGIN: -L- STA. 22+04.00 LT.  
 END: -L- STA. 22+25.00 LT  
 BEGIN: -L- STA. 22+04.00 RT.  
 END : -L- STA. 22+25.00 RT