

**GASTON COUNTY
NORTH CAROLINA**

12CR.10361.5
12CR.20361.6

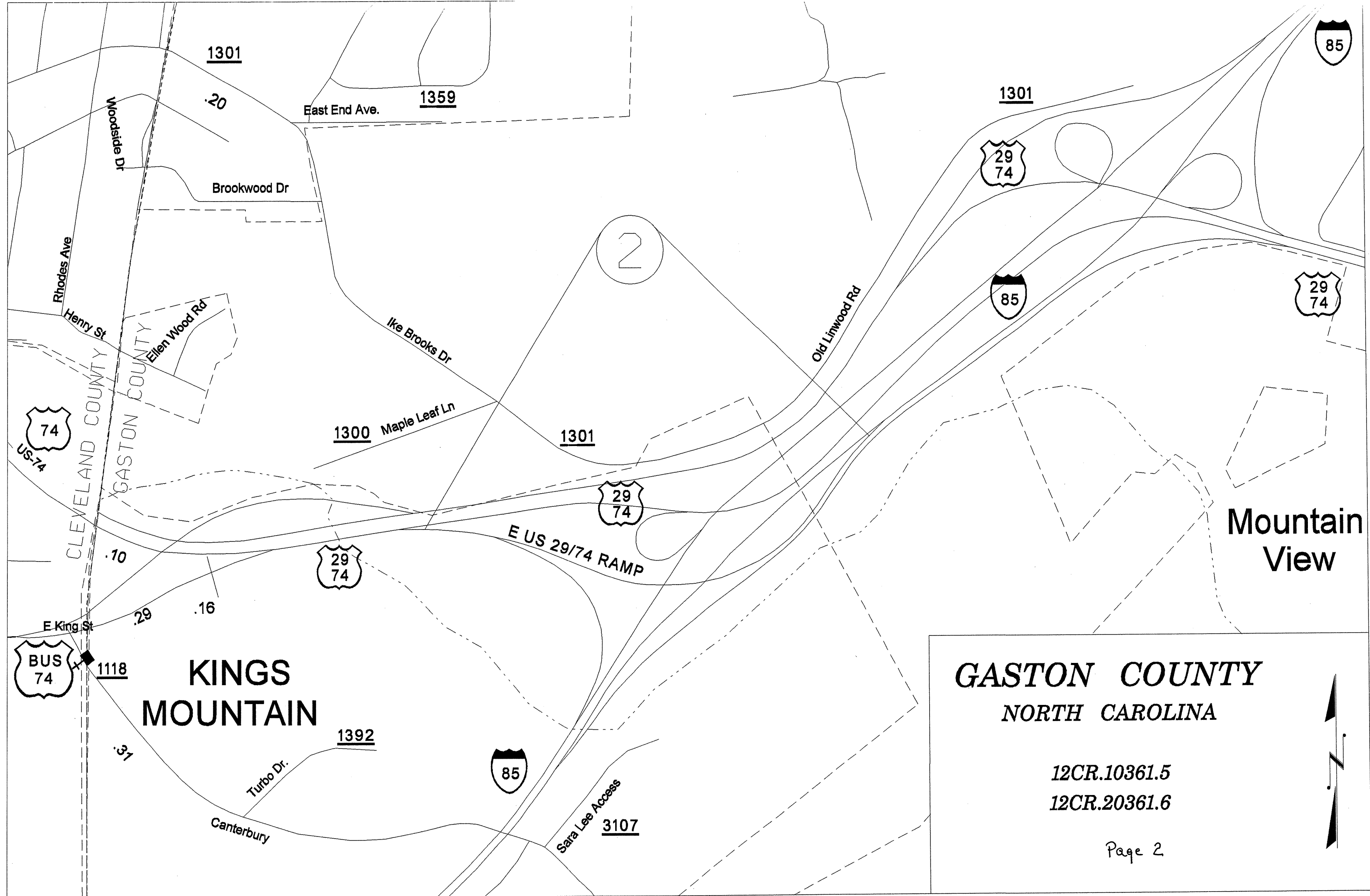

NC/SC Stateline



GASTON COUNTY
NORTH CAROLINA

12CR.10361.5
12CR.20361.6

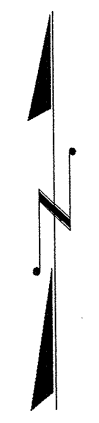

GASTONIA

Hunters Crossing Ln

Beartooth Ct

2446

2400

Rivermont Dr

274

274

2446

2445

2416

GASTON COUNTY NORTH CAROLINA

12CR.10361.5

12CR.20361.6

Page 4

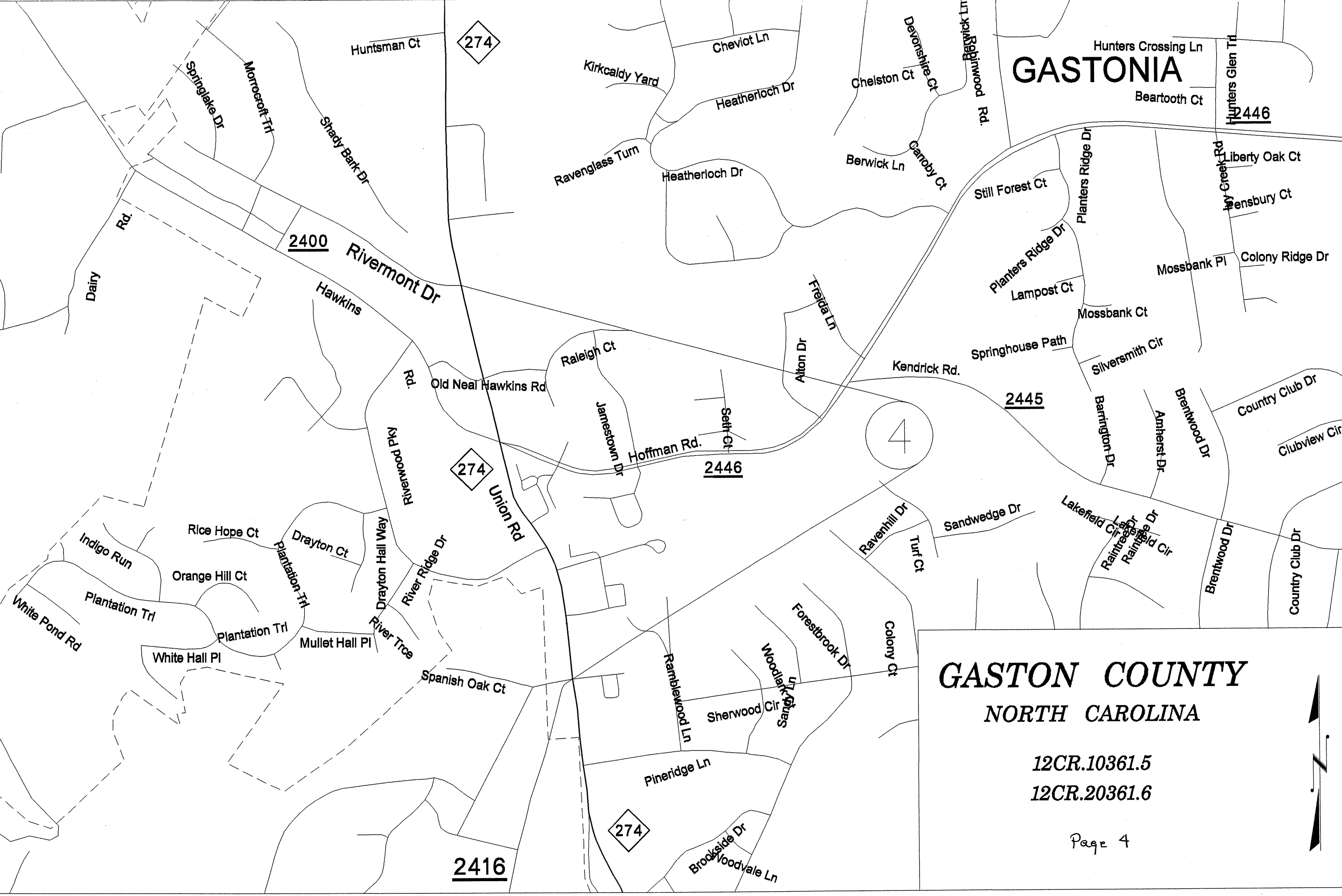
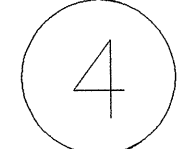
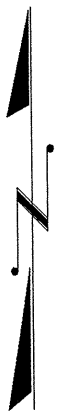

GASTONIA

GASTON COUNTY NORTH CAROLINA

12CR.10361.5

12CR.20361.6

Page 5

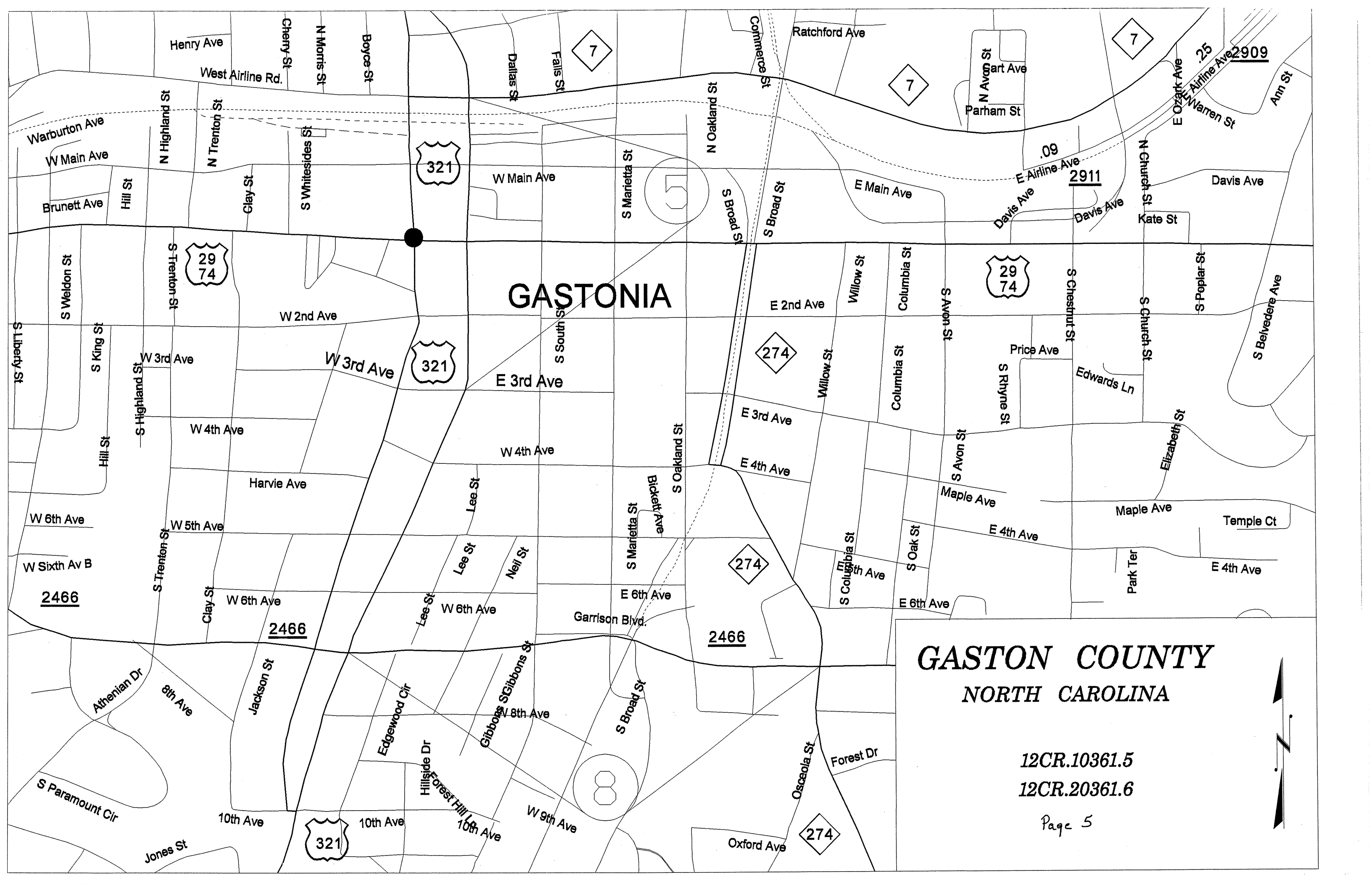

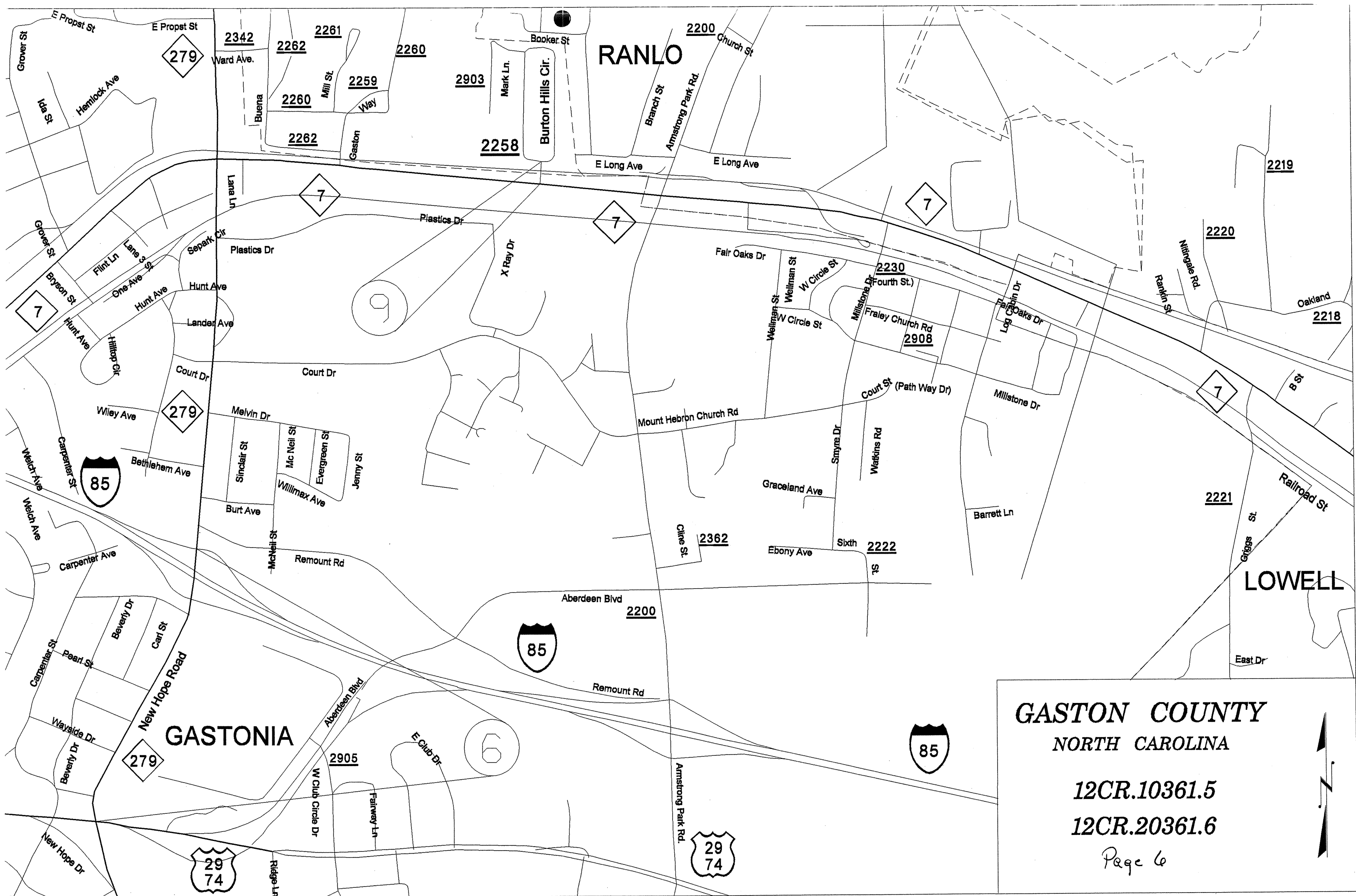

GASTON COUNTY
NORTH CAROLINA

12CR.10361.5
 12CR.20361.6

Page 6

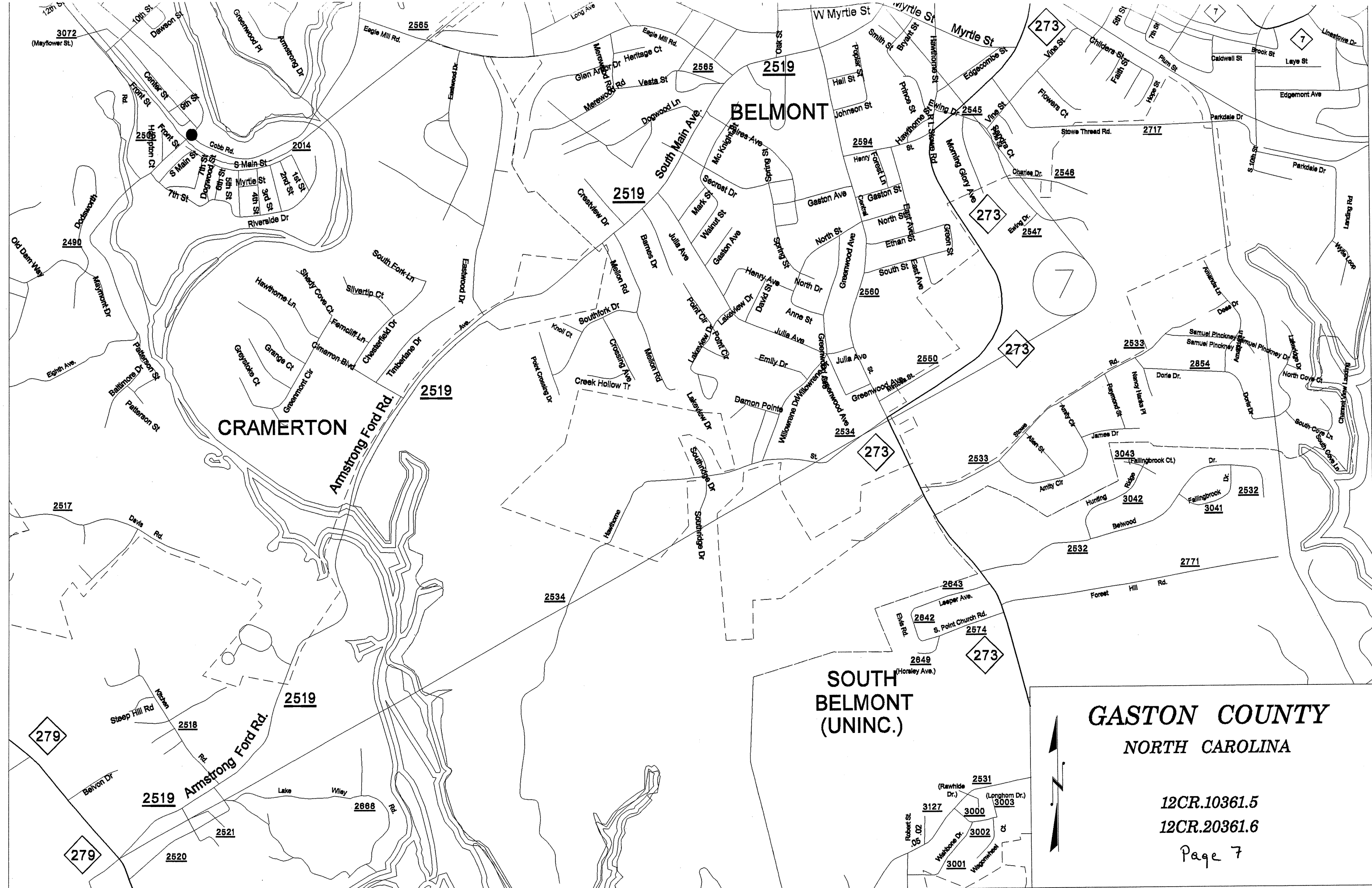

BELMONT

CRAMERTON

SOUTH BELMONT (UNINC.)

**GASTON COUNTY
NORTH CAROLINA**

12CR.10361.5
12CR.20361.6

GASTON COUNTY NORTH CAROLINA

12CR.10361.5

12CR.20361.6

Page 8

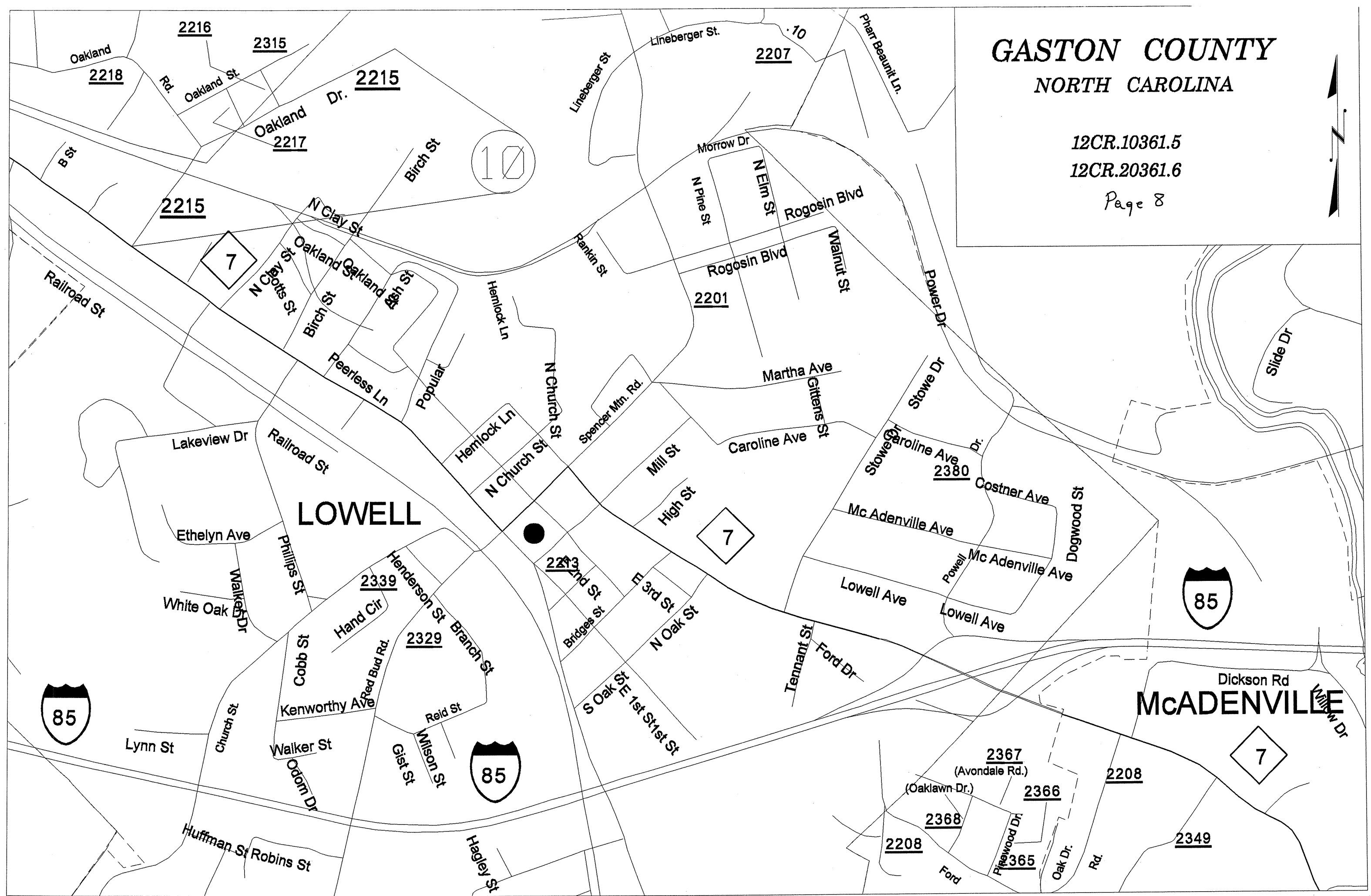

DALLAS

GASTON COUNTY NORTH CAROLINA

12CR.10361.5

12CR.20361.6

Page 10

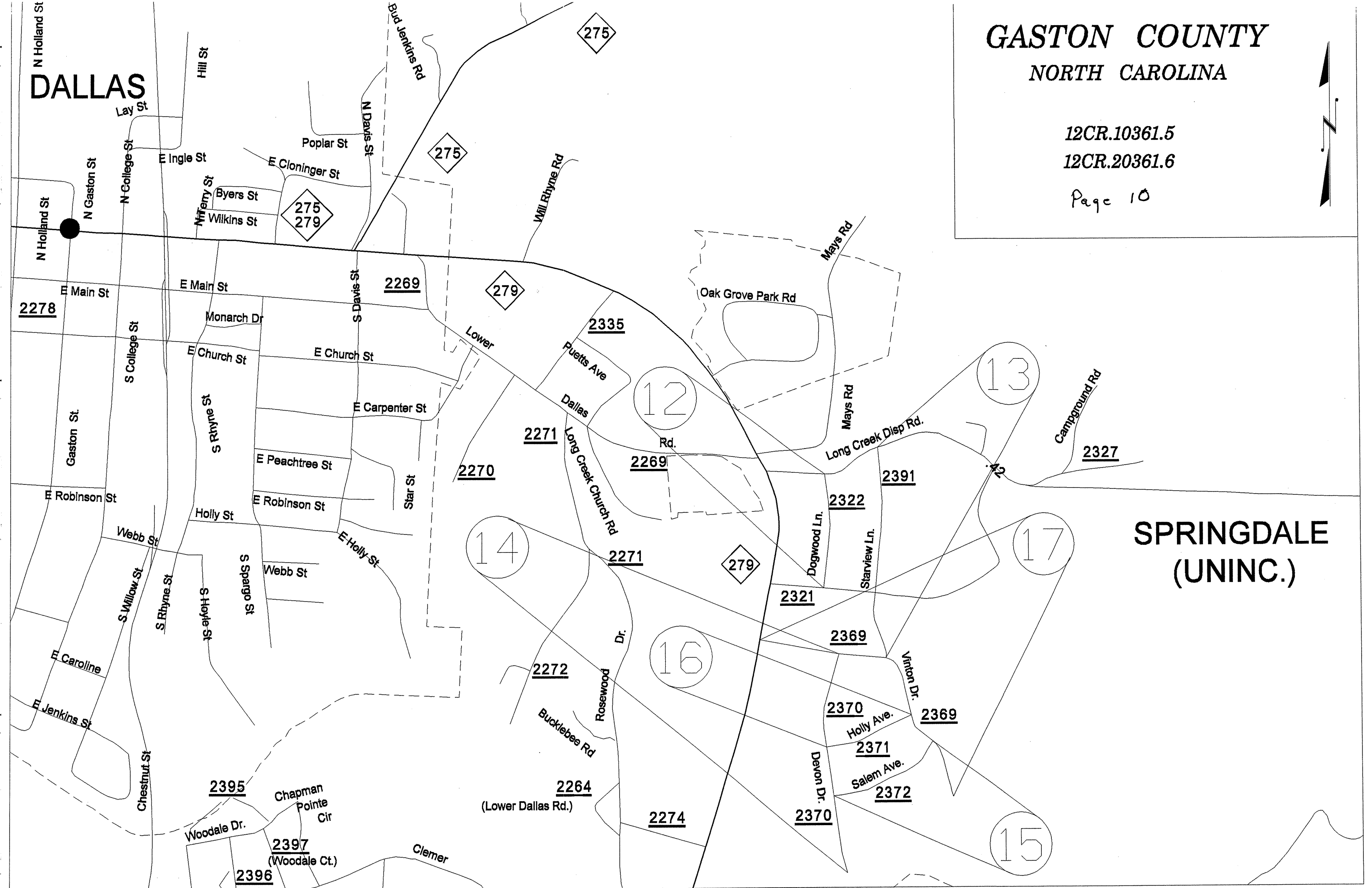

PROJECT NO.	SHEET NO.	TOTAL NO.
12CR.10361.5, 12CR.20361.6	1	2

SUMMARY OF QUANTITIES

PROJECT NO	COUNTY	MAP NO	ROUTE	DESCRIPTION	TYP NO	LENGTH MI	WIDTH FT	INCIDENTAL STONE BASE TONS	SHOULDER RECONSTRUCTION SMI	2" MILLING SY	5" MILLING SY	0" TO 2" MILLING SY	1.5" TO 3" MILLING SY	0" TO 3" MILLING SY	INCIDENTAL MILLING SY	BASE COURSE, B25.0C TONS	SURFACE COURSE, S9.5B TONS	LEVELING COURSE, S9.5B TONS	SURFACE COURSE, S9.5C TONS	LEVELING COURSE, S9.5C TONS	SURFACE COURSE, S12.5C TONS	LEVELING COURSE, S12.5C TONS	PG 64-22 PLANT MIX TONS	PG 70-22 PLANT MIX TONS	PATCHING EXISTING PAVEMENT TONS	ASPH SURF TREATMENT, MAT COURSE SY	WHEEL CHAIR RAMPS EA	ADJUST CATCH BASIN EA	ADJUST DROP INLET EA	ADJUST MANHOLES EA	ADJUST METER OR VALVE BOX EA	PORTABLE LIGHTING LS	
12CR.10361.5	Gaston	1	NC 274 (UNION RD)	0.4 MILE SOUTH OF SR 2439 (END OF 3-LANE) TO SR 2435	1	1.42	24	10	2.80								1,848	93					117		185								
12CR.10361.5	Gaston	2	E US 29/74 RAMP	E US 29/74 TO N I-85	16	0.65	VAR. 33-39		1.06						800.00						1,470	73		86	110								
12CR.10361.5	Gaston	3	NC 161 (KINGS MTN HWY)	CLEVELAND CO. LINE TO NC 274	1 2 3	3.05 0.10 0.05	25 VAR. 28-38 VAR. 24-34	30	6.10			600.00	1,600.00		550.00	4,650	233					294		465			2	1					
12CR.10361.5	Gaston	4	NC 274 (UNION RD)	RIVERMONT DR TO SR 2416	4 5	0.47 0.11	61 61			4,650.00	4,650.00	6,000.00				1460					2,633	132	63	152	198					22	9		
12CR.10361.5	Gaston	5	N US 321 (S YORK ST)	3RD AVENUE TO NC 7	6 7 8	0.11 0.11 0.18	38 34 VAR. 31-34					2,120.00	5,050.00		550.00	700	50					45		70				3	11	12	1		
12CR.10361.5	Gaston	6	NC 279 (NEW HOPE RD)	I-85 SB RAMP TO US 29/74	15 9	0.09 0.46	62 VAR. 64-74					500.00	20,000.00		400.00			1,900	95				120	190						11	11	*	
TOTAL FOR PROJ NO. 12CR.10361.5						6.51		40	9.96	4,650.00	4,650.00	9,220.00	26,650.00		2,300.00	1460	7,198	376	1,900	95	4,103	205	519	358	1,218			2	4	44	32	1	
12CR.20361.6	Gaston	7	SR 2519 (ARMSTRONG FORD RD)	NC 279 TO MYRTLE ST	6 10 14	0.40 2.36 0.40	VAR. 21-32 VAR. 24-33 24	100				2,400.00	7,140.00		550.00		4,750	238				300		475					1	4	1		
12CR.20361.6	Gaston	8	SR 2466 (GARRISON BLVD)	US 321 N TO NC 274	11	0.67	62							16,000.00	1,400.00		2,300	115				145		230			5		16	6	*		
12CR.20361.6	Gaston	9	SR 2258 (BURTON HILLS CIR)	NC 7 TO NC 7	10	0.53	VAR. 16-22	50							200.00		525	100				38		150					4				
12CR.20361.6	Gaston	10	SR 2215 (OAKLAND DR)	NC 7 TO CULDESAC	10 12	0.35 0.06	VAR. 17-60 17	70							300.00		450	150				37		45					3				
12CR.20361.6	Gaston	11	SR 2000 (HICKORY GROVE RD)	SR 2040 TO SR 2059	13	2.62	VAR. 21-36	90								3,140	157					205		314	38000.00								
12CR.20361.6	Gaston	12	SR 2322 (DOGWOOD LN)	SR 2327 TO SR 2321	10	0.17	22									204	11					13		5									
12CR.20361.6	Gaston	13	SR 2391 (STARVIEW LN)	SR 2327 TO SR 2369	10	0.31	26	10								439	44					29		22									
12CR.20361.6	Gaston	14	SR 2370 (DEVON DR)	SR 2369 TO DEAD END	10	0.33	VAR. 20-24	30								396	40					26		20									
12CR.20361.6	Gaston	15	SR 2372 (SALEM AVE)	SR 2370 TO SR 2369	10	0.18	24									235	24					16		12									
12CR.20361.6	Gaston	16	SR 2371 (HOLLY AVE)	SR 2370 TO SR 2369	10	0.14	23									175	18					12		9									
12CR.20361.6	Gaston	17	SR 2369 (VINTON DR)	NC 279 TO DEAD END	10	0.40	25	30								545	55					36		28									
TOTAL FOR PROJ NO. 12CR.20361.6						8.92		380				2,400.00	7,140.00	16,000.00	2,450.00	0	13,159	952				857		1,310	38000.00	5		1	27	7	1		
GRAND TOTAL						15.43		420	9.96	4,650.00	4,650.00	11,620.00	33,790.00	16,000.00	4,750.00	1460	20,357	1,328	1,900	95	4,103	205	1,376	358	2,528	38000.00	5	2	5	71	39	1	

PROJECT NO.	SHEET NO.	TOTAL NO.
12CR.10361.5	2	2
12CR.20361.6		

THERMOPLASTIC AND PAINT QUANTITIES

PROJECT NO	COUNTY	MAP NO	ROUTE	DESCRIPTION	4685000000-E		4686000000-E		4690000000-E		4695000000-E		4705000000-E		4710000000-E		4721000000-E		4725000000-E		4810000000-E		4820000000-E	4905000000-N	
					4" X 90 M WHITE THERMO	4" X 90 M YELLOW THERMO	4" X 120 M YELLOW THERMO	4" X 120 M WHITE THERMO	8" X 120 M WHITE THERMO	6" X 120 M WHITE THERMO	8" X 90 M WHITE THERMO	8" X 90 M YELLOW THERMO	16" X 120 M WHITE THERMO	24" X 120 M WHITE THERMO	THERMO MSG SCHOOL 120 M EA	THERMO RXR 120 M EA	THERMO LT ARROW 90 M EA	THERMO RT ARROW 90 M EA	THERMO STR & RT ARROW 90 M EA	THERMO STR & LT ARROW 90 M EA	THERMO STR ARROW 90 M EA	4" WHITE PAINT	4" YELLOW PAINT	8" WHITE PAINT	SNOW PLOWABLE MARKERS
NO					LF	LF	LF	LF	LF	LF	LF	LF	LF	LF	EA	EA	EA	EA	EA	EA	EA	EA	EA	EA	
12CR.10361.5	Gaston	1	NC 274 (UNION RD)	0.4 MILE SOUTH OF SR 2439 (END OF 3-LANE) TO SR 2435	15,279		14,620							50	6									103	
12CR.10361.5	Gaston	2	E US 29/74 RAMP	E US 29/74 TO N I-85	3,500	3,500		860			300													60	
12CR.10361.5	Gaston	3	NC 161 (KINGS MTN HWY)	CLEVELAND CO. LINE TO NC 274	34,200		37,500	80	182		350	50	100	94		4	2							250	
12CR.10361.5	Gaston	4	NC 274 (UNION RD)	RIVERMONT DR TO SR 2416			8,700	1,800						200	6		29	2	4					400	
12CR.10361.5	Gaston	5	N US 321 (S YORK ST)	3RD AVENUE TO NC 7				1,050			800			170			2		6	7				120	
12CR.10361.5	Gaston	6	NC 279 (NEW HOPE RD)	I-85 SB RAMP TO US 29/74		5,800	1,000	3,500	130		60			200			17	11						450	
TOTAL FOR PROJ NO. 12CR.10361.5					52,979	9,300	61,820	7,290	312	145	1,510	50	100	714	12	4	50	13	10	7	12			1,383	
					62,279		69,110				1,560				16		92								
12CR.20361.6	Gaston	7	SR 2519 (ARMSTRONG FORD RD)	NC 279 TO MYRTLE ST										110		4		4							
12CR.20361.6	Gaston	8	SR 2466 (GARRISON BLVD)	US 321 TO NC 274			10,000	2,000	600				240	250	450		14	27							
12CR.20361.6	Gaston	9	SR 2258 (BURTON HILLS CIR)	NC 7 TO NC 7																					
12CR.20361.6	Gaston	10	SR 2215 (OAKLAND DR)	NC 7 TO CULDESAC																					
12CR.20361.6	Gaston	11	SR 2000 (HICKORY GROVE RD)	SR 2040 TO SR 2059										75			3		1	2					
12CR.20361.6	Gaston	12	SR 2322 (DOGWOOD LN)	SR 2327 TO SR 2321																					
12CR.20361.6	Gaston	13	SR 2391 (STARVIEW LN)	SR 2327 TO SR 2369																					
12CR.20361.6	Gaston	14	SR 2370 (DEVON DR)	SR 2369 TO DEAD END																					
12CR.20361.6	Gaston	15	SR 2372 (SALEM AVE)	SR 2370 TO SR 2369																					
12CR.20361.6	Gaston	16	SR 2371 (HOLLY AVE)	SR 2370 TO SR 2369																					
12CR.20361.6	Gaston	17	SR 2369 (VINTON DR)	NC 279 TO DEAD END																					
TOTAL FOR PROJ NO. 12CR.20361.6							10,000	2,000	600			240	250	635		14	34	5	2						
							12,000				240				41		229,245								
GRAND TOTAL					52,979	9,300	71,820	9,290	912	145	1,510	290	350	1,349	12	18	84	13	15	9	12	107,290	121,955	90	1,383
					62,279		81,110				1,800				30		133					229,245			

PROJ. REFERENCE NO.	SHEET NO.	TOTAL SHEETS
GASTON COUNTY	1 OF 4	
STATE PROJ. NO.	F. A. PROJ. NO.	DESCRIPTION
12CR.10361.5		
12CR.20361.6		

PAVEMENT SCHEDULE	
A	ASPHALT SURFACE TREATMENT, MAT COURSE
B	PROP. APPROX. 5" ASPHALT CONCRETE BASE COURSE, TYPE B25.0C, AT AN AVERAGE RATE OF 570 LBS. PER SQ. YD.
C	PROP. APPROX. 1 1/2" ASPHALT CONCRETE SURFACE COURSE, TYPE S9.5B, AT AN AVERAGE RATE OF 168 LBS. PER SQ. YD.
D	PROP. APPROX. 1 1/2" ASPHALT CONCRETE SURFACE COURSE, TYPE S9.5C, AT AN AVERAGE RATE OF 168 LBS. PER SQ. YD.
E	SHOULDER RECONSTRUCTION
F	MILL ASPHALT PAVEMENT APPROX. 2" AS DIRECTED BY ENGINEER
G	MILL ASPHALT PAVEMENT APPROX. 5" AS DIRECTED BY ENGINEER
H	MILL ASPHALT PAVEMENT APPROX. 0" - 2" (10'-0 WIDE FROM CURB)
J	MILL ASPHALT PAVEMENT APPROX. 1 1/2" - 3" AS DIRECTED BY ENGINEER
K	MILL ASPHALT PAVEMENT APPROX. 0" - 3" AS DIRECTED BY ENGINEER
L	MILL ASPHALT PAVEMENT APPROX. 0" - 3" (20'-0 WIDE FROM CURB)
M	PROP. APPROX. 2" ASPHALT CONCRETE SURFACE COURSE, TYPE S12.5C, AT AN AVERAGE RATE OF 224 LBS. PER SQ. YD.

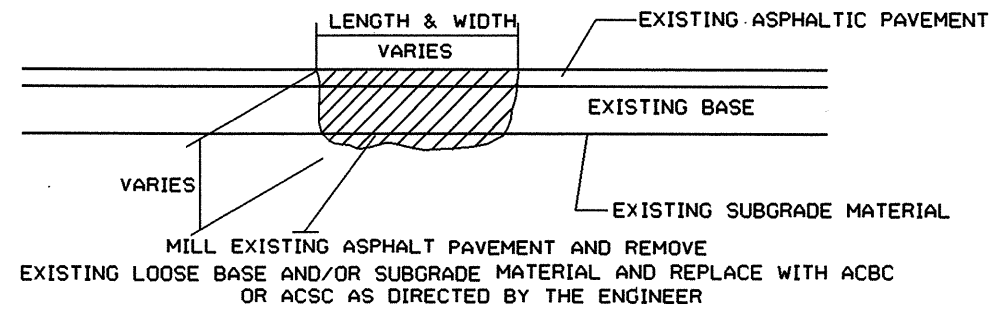

MILL EXISTING ASPHALT PAVEMENT AND REMOVE EXISTING LOOSE BASE AND/OR SUBGRADE MATERIAL AND REPLACE WITH ACBC OR ACSC AS DIRECTED BY THE ENGINEER

PATCHING EXISTING PAVEMENT

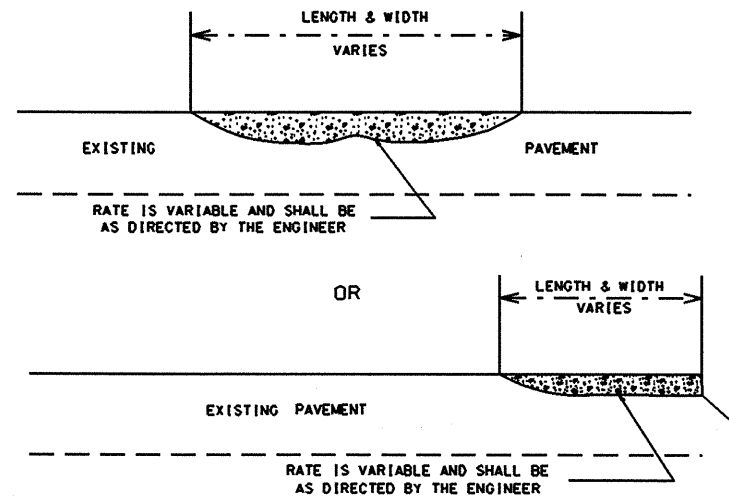

ASPHALT CONCRETE SURFACE COURSE
TYPE S9.5B. (LEVELING COURSE)

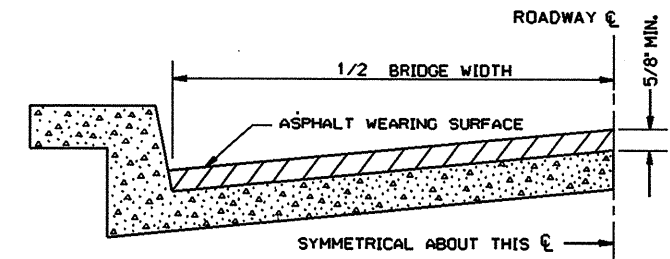

BRIDGE HALF TYPICAL SECTION

FOR BRIDGES WITH FLOOR DRAINS, CARE SHALL BE EXERCISED IN PLACING THE WEARING SURFACE AROUND FLOOR DRAINS SO AS NOT TO HINDER EFFECTIVE DRAINAGE. ALL DRAINS SHALL BE LEFT OPEN.

THE PROPOSED WEARING SURFACE SHALL VARY IN THICKNESS AS NECESSARY TO PROVIDE A SMOOTH RIDING SURFACE. A THICKNESS OF NOT LESS THAN 5/8" SHALL BE PROVIDED. THE MAXIMUM THICKNESS SHALL PREFERABLY BE 1-1/2" UNLESS IT IS IMPRACTICAL TO PROVIDE A SMOOTH RIDING SURFACE OTHERWISE.

NOTES

ALL UNPAVED S.R. ROADS TO BE SURFACED 50' FROM EDGE OF PAVEMENT OF MAIN PROJECT.
ALL PAVED S.R. ROADS TO BE RESURFACED TO THE ENDS OF THE RADII, OR AS DIRECTED BY THE ENGINEER.
EDGES, PAVEMENT WIDENING, INTERSECTIONS AND BRIDGE FLARES ARE INCLUDED IN THE TABLE OF QUANTITIES.
SHOULDERS AND DITCHES ARE TO BE CONSTRUCTED BY OTHERS UNLESS OTHERWISE NOTED.
BRIDGES TO BE RESURFACED AT LOCATIONS AND TO DEPTH AS DIRECTED BY THE ENGINEER.

NOTE: PAVEMENT EDGE SLOPES ARE 1:1 UNLESS SHOWN OTHERWISE.

MILL BRIDGE APPROACHES 100' TO PROVIDE A SMOOTH TRANSITION AS DIRECTED.

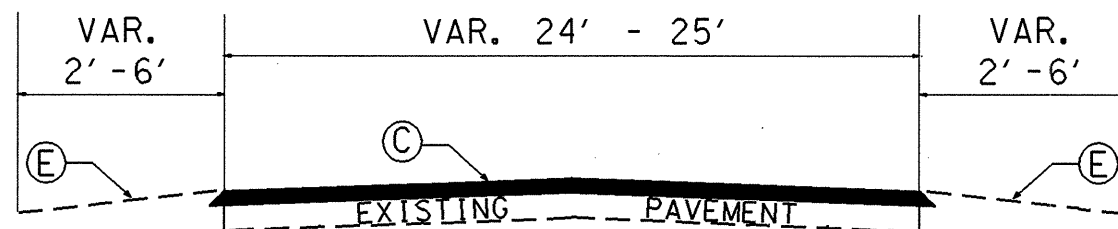

TYPICAL SECTION NO. 1

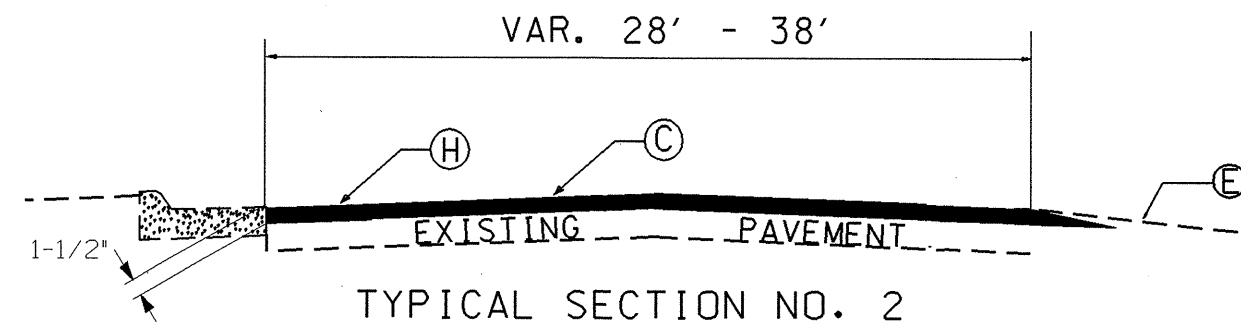

TYPICAL SECTION NO. 2

(APPROXIMATELY 0.10 MILE)

MILL 1-1/2" @ CURB TO 0" @ 10'-0

PROJ. REFERENCE NO.	SHEET NO.	TOTAL SHEETS
GASTON COUNTY	20F 4	
STATE PROJ. NO.	F. A. PROJ. NO.	DESCRIPTION
12CR. 10361. 5		
12CR. 20361. 6		

PAVEMENT SCHEDULE	
A	ASPHALT SURFACE TREATMENT, MAT COURSE
B	PROP. APPROX. 5" ASPHALT CONCRETE BASE COURSE, TYPE B25.0C, AT AN AVERAGE RATE OF 570 LBS. PER SQ. YD.
C	PROP. APPROX. 1½" ASPHALT CONCRETE SURFACE COURSE, TYPE S9.5B, AT AN AVERAGE RATE OF 168 LBS. PER SQ. YD.
D	PROP. APPROX. 1½" ASPHALT CONCRETE SURFACE COURSE, TYPE S9.5C, AT AN AVERAGE RATE OF 168 LBS. PER SQ. YD.
E	SHOULDER RECONSTRUCTION
F	MILL ASPHALT PAVEMENT APPROX. 2" AS DIRECTED BY ENGINEER
G	MILL ASPHALT PAVEMENT APPROX. 5" AS DIRECTED BY ENGINEER
H	MILL ASPHALT PAVEMENT APPROX. 0" - 2" (10'-0 WIDE FROM CURB)
J	MILL ASPHALT PAVEMENT APPROX. 1½" - 3" AS DIRECTED BY ENGINEER
K	MILL ASPHALT PAVEMENT APPROX. 0" - 3" AS DIRECTED BY ENGINEER
L	MILL ASPHALT PAVEMENT APPROX. 0" - 3" (20'-0 WIDE FROM CURB)
M	PROP. APPROX. 2" ASPHALT CONCRETE SURFACE COURSE, TYPE S12.5C, AT AN AVERAGE RATE OF 224 LBS. PER SQ. YD.

NOTE: PAVEMENT EDGE SLOPES ARE 1:1 UNLESS SHOWN OTHERWISE.
MILL BRIDGE APPROACHES 100' TO PROVIDE A SMOOTH TRANSITION AS DIRECTED.

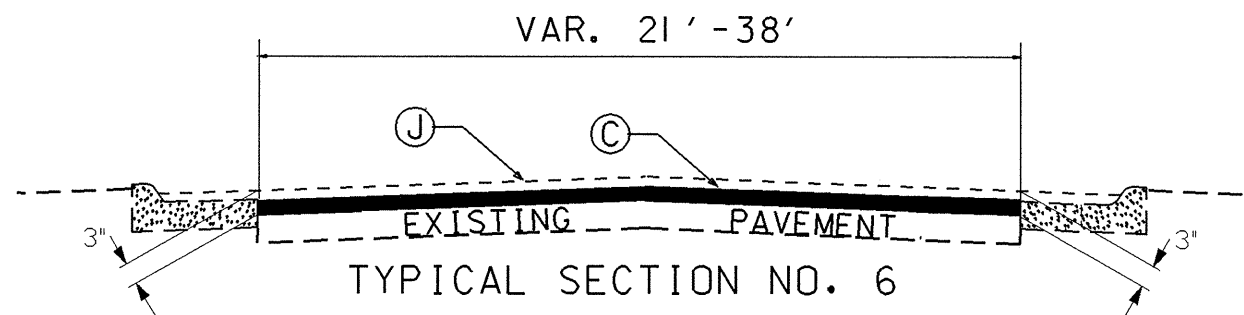
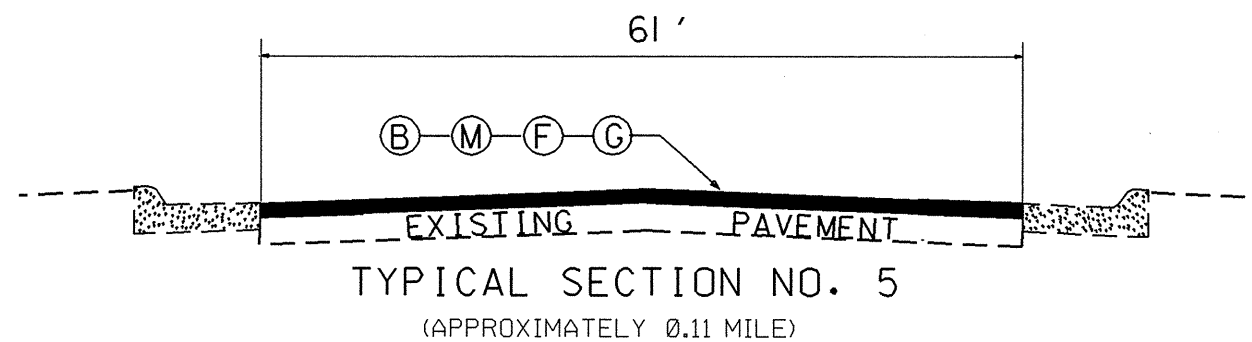
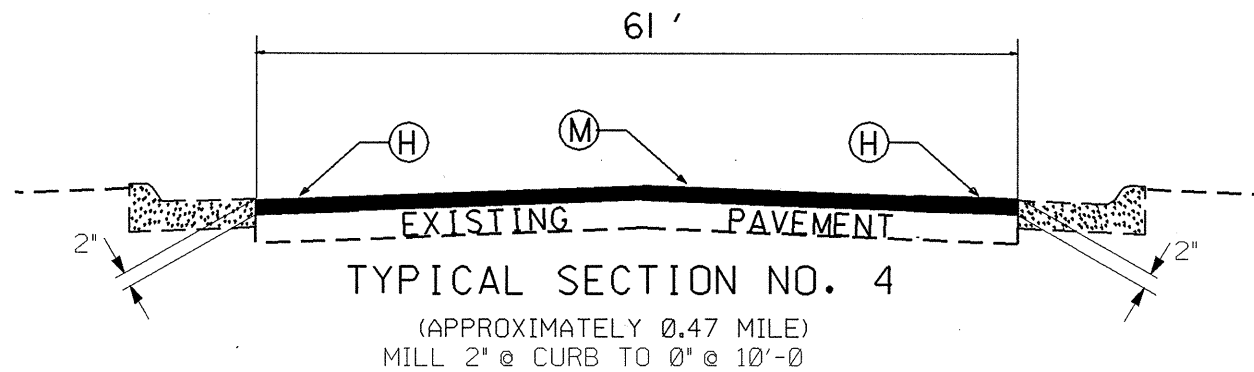
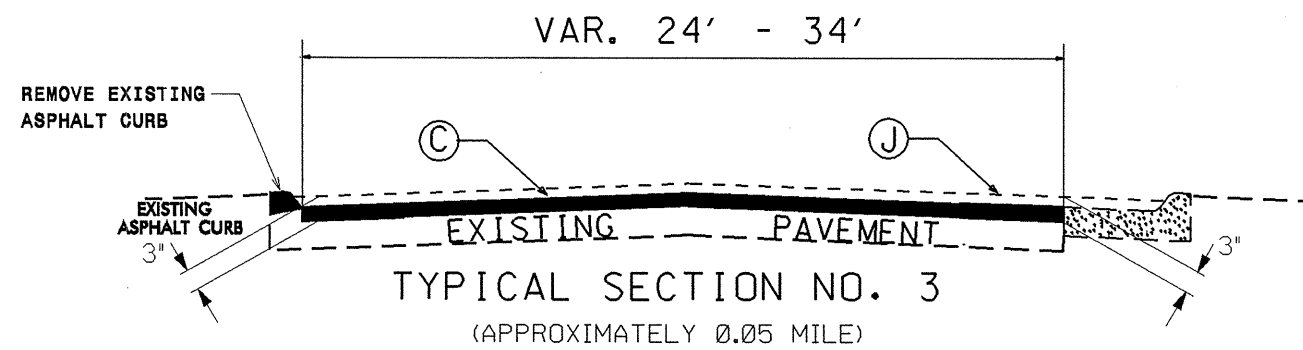

PROJ. REFERENCE NO.	SHEET NO.	TOTAL SHEETS
GASTON COUNTY	3 OF 4	
STATE PROJ. NO.	F. A. PROJ. NO.	DESCRIPTION
12CR. 10361.5		
12CR. 20361.6		

PAVEMENT SCHEDULE	
A	ASPHALT SURFACE TREATMENT, MAT COURSE
B	PROP. APPROX. 5" ASPHALT CONCRETE BASE COURSE, TYPE B25.0C, AT AN AVERAGE RATE OF 570 LBS. PER SQ. YD.
C	PROP. APPROX. 1½" ASPHALT CONCRETE SURFACE COURSE, TYPE S9.5B, AT AN AVERAGE RATE OF 168 LBS. PER SQ. YD.
D	PROP. APPROX. 1½" ASPHALT CONCRETE SURFACE COURSE, TYPE S9.5C, AT AN AVERAGE RATE OF 168 LBS. PER SQ. YD.
E	SHOULDER RECONSTRUCTION
F	MILL ASPHALT PAVEMENT APPROX. 2" AS DIRECTED BY ENGINEER
G	MILL ASPHALT PAVEMENT APPROX. 5" AS DIRECTED BY ENGINEER
H	MILL ASPHALT PAVEMENT APPROX. 0" - 2" (10'-0 WIDE FROM CURB)
J	MILL ASPHALT PAVEMENT APPROX. 1½" - 3" AS DIRECTED BY ENGINEER
K	MILL ASPHALT PAVEMENT APPROX. 0" - 3" AS DIRECTED BY ENGINEER
L	MILL ASPHALT PAVEMENT APPROX. 0" - 3" (20'-0 WIDE FROM CURB)
M	PROP. APPROX. 2" ASPHALT CONCRETE SURFACE COURSE, TYPE S12.5C, AT AN AVERAGE RATE OF 224 LBS. PER SQ. YD.

NOTE: PAVEMENT EDGE SLOPES ARE 1:1 UNLESS SHOWN OTHERWISE.

MILL BRIDGE APPROACHES 100' TO PROVIDE A SMOOTH TRANSITION AS DIRECTED.

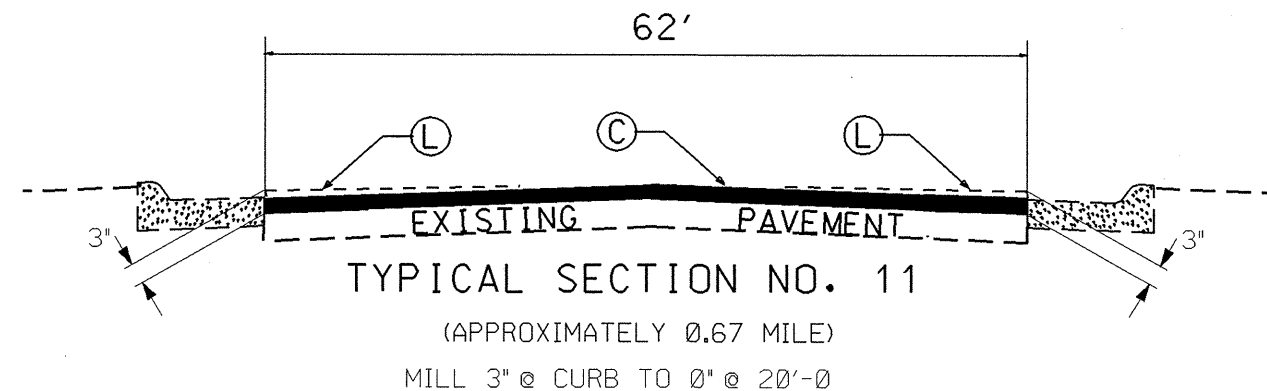
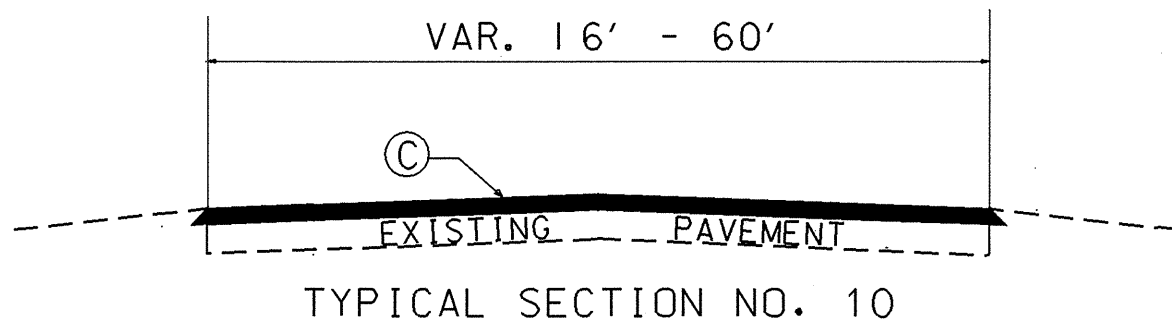
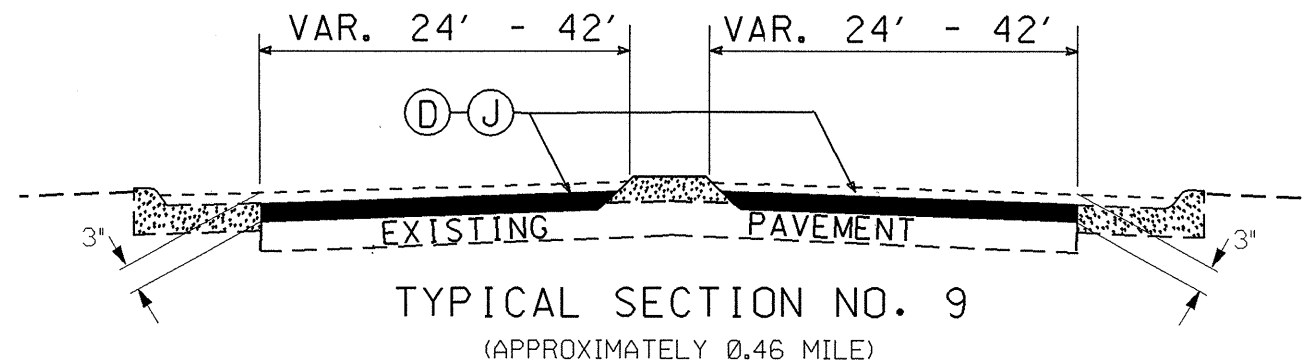
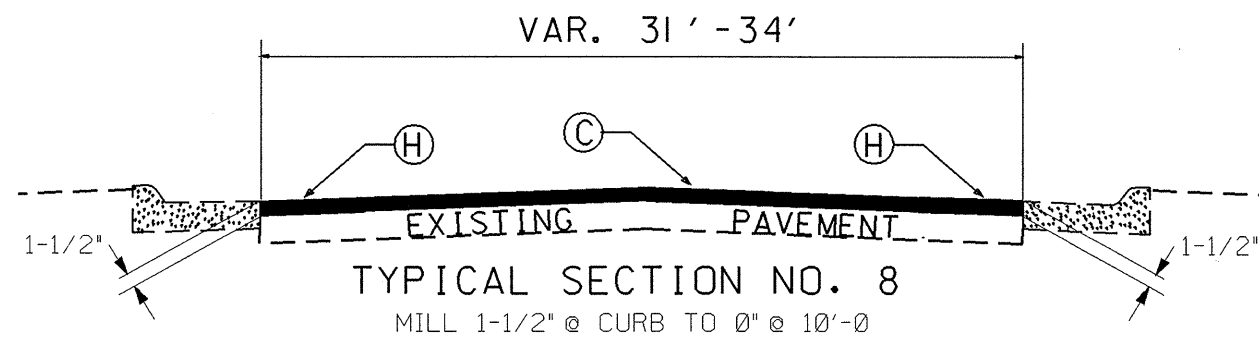
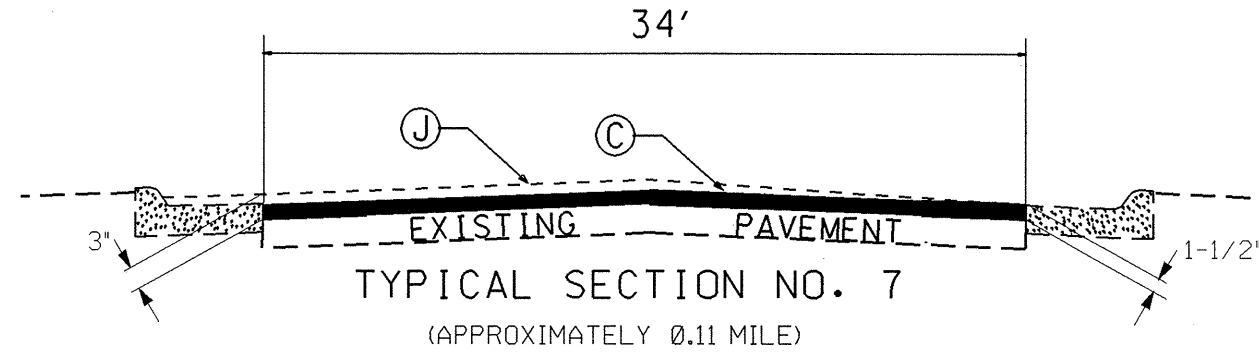

PROJ. REFERENCE NO.	SHEET NO.	TOTAL SHEETS
GASTON COUNTY	4 OF 4	
STATE PROJ. NO.	F. A. PROJ. NO.	DESCRIPTION
12CR.10361.5		
12CR.20361.6		

PAVEMENT SCHEDULE	
A	ASPHALT SURFACE TREATMENT, MAT COURSE
B	PROP. APPROX. 5" ASPHALT CONCRETE BASE COURSE, TYPE B25.0C, AT AN AVERAGE RATE OF 570 LBS. PER SQ. YD.
C	PROP. APPROX. 1½" ASPHALT CONCRETE SURFACE COURSE, TYPE S9.5B, AT AN AVERAGE RATE OF 168 LBS. PER SQ. YD.
D	PROP. APPROX. 1½" ASPHALT CONCRETE SURFACE COURSE, TYPE S9.5C, AT AN AVERAGE RATE OF 168 LBS. PER SQ. YD.
E	SHOULDER RECONSTRUCTION
F	MILL ASPHALT PAVEMENT APPROX. 2" AS DIRECTED BY ENGINEER
G	MILL ASPHALT PAVEMENT APPROX. 5" AS DIRECTED BY ENGINEER
H	MILL ASPHALT PAVEMENT APPROX. 0" - 2" (10'-0 WIDE FROM CURB)
J	MILL ASPHALT PAVEMENT APPROX. 1½" - 3" AS DIRECTED BY ENGINEER
K	MILL ASPHALT PAVEMENT APPROX. 0" - 3" AS DIRECTED BY ENGINEER
L	MILL ASPHALT PAVEMENT APPROX. 0" - 3" (20'-0 WIDE FROM CURB)
M	PROP. APPROX. 2" ASPHALT CONCRETE SURFACE COURSE, TYPE S12.5C, AT AN AVERAGE RATE OF 224 LBS. PER SQ. YD.

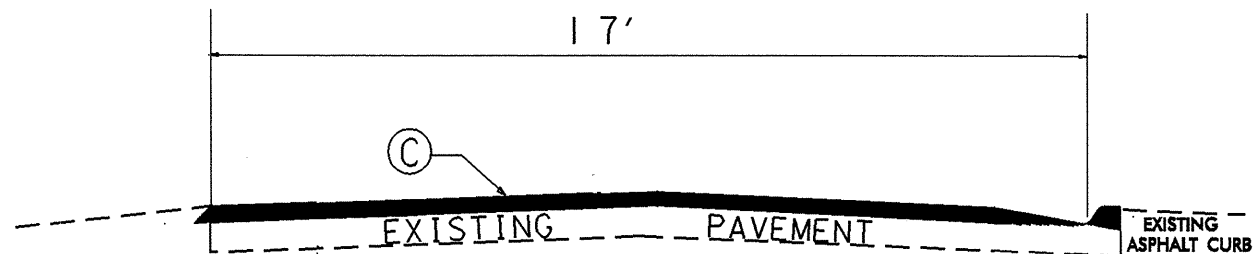

TYPICAL SECTION NO. 12
(APPROXIMATELY 0.06 MILE)

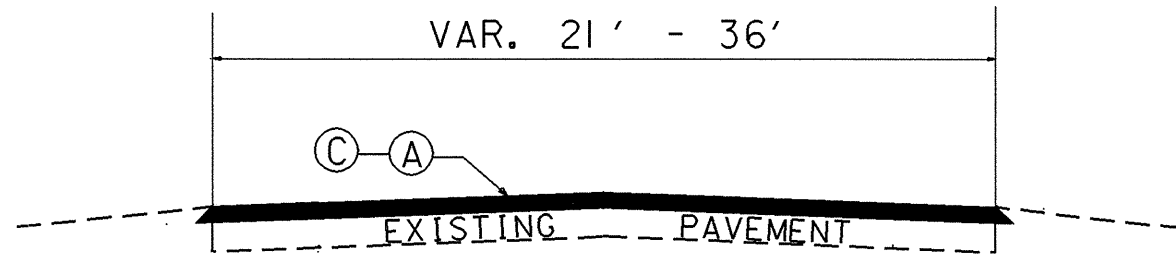

TYPICAL SECTION NO. 13
(APPROXIMATELY 3.88 MILE)

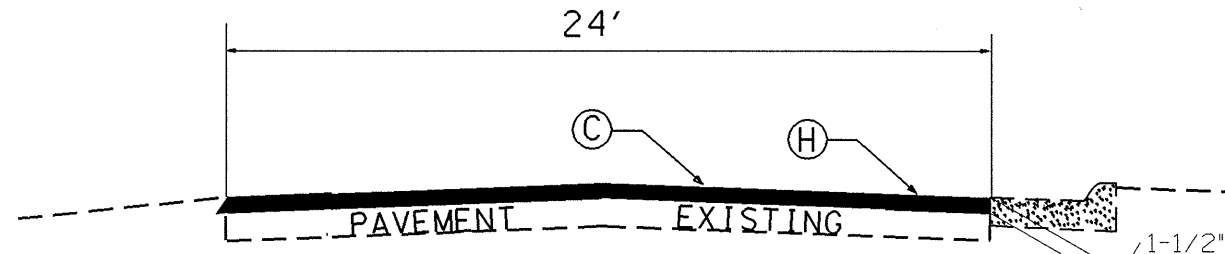

TYPICAL SECTION NO. 14
(APPROXIMATELY 0.40 MILE)
MILL 1-1/2" @ CURB TO 0" @ 10'-0

NOTE: PAVEMENT EDGE SLOPES ARE 1:1 UNLESS SHOWN OTHERWISE.
MILL BRIDGE APPROACHES 100' TO PROVIDE A SMOOTH TRANSITION AS DIRECTED.

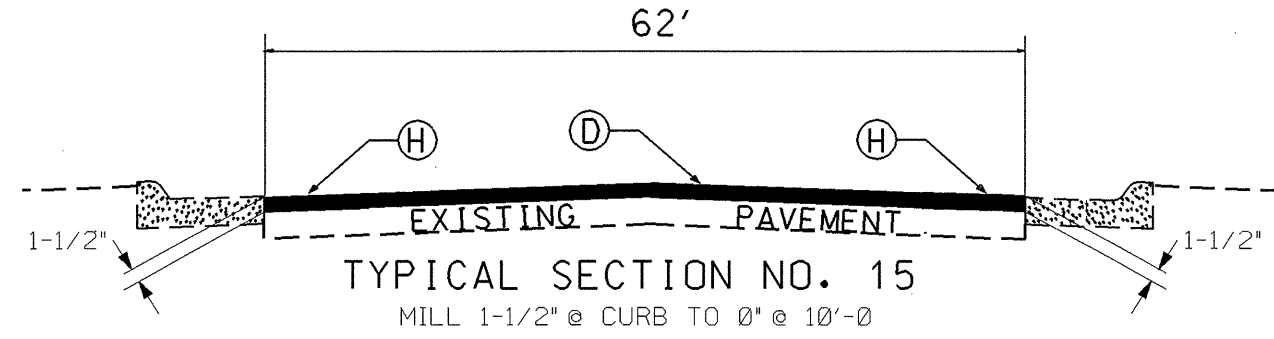

TYPICAL SECTION NO. 15
MILL 1-1/2" @ CURB TO 0" @ 10'-0

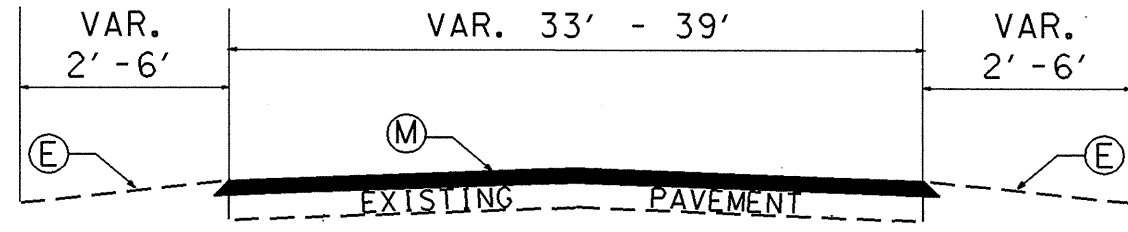

TYPICAL SECTION NO. 16

TWO-WAY UNDIVIDED ** (L-LINES)

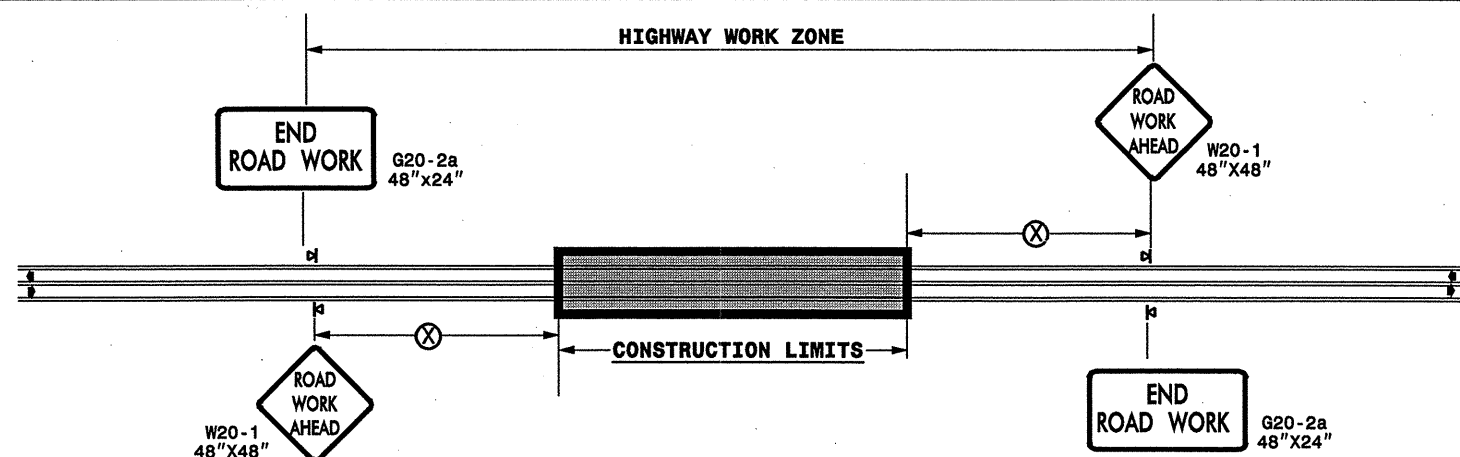

POSTED SPEED LIMIT (M.P.H.)	RECOMMENDED MINIMUM SIGN SPACING
≤ 50	500'
≥ 55	1000'

STATE OF NORTH CAROLINA
DEPT. OF TRANSPORTATION
DIVISION OF HIGHWAYS
RALEIGH, N.C.

ROADWAYS INTERSECTING ALONG 2 WAY UNDIVIDED WORK ZONE (Y-LINES)

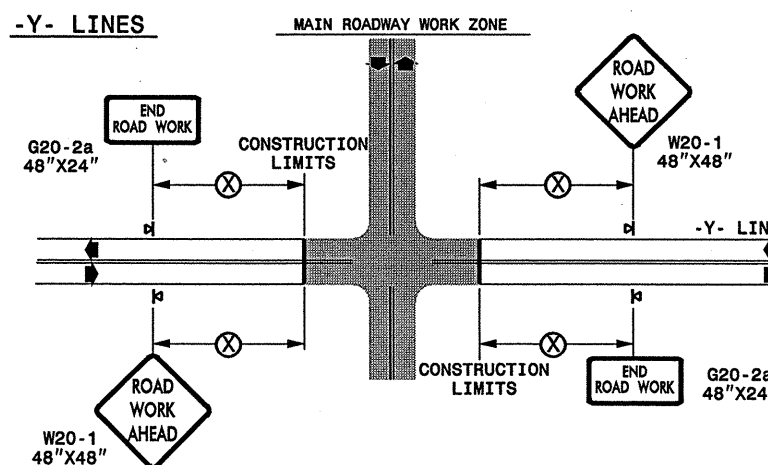

GENERAL NOTES

- USE FLUORESCENT ORANGE SHEETING (TYPE VII OR HIGHER) ON ALL ADVANCED WORK ZONE SIGNS.
- DO NOT INSTALL ADVANCE WARNING SIGNS MORE THAN 3 DAYS PRIOR TO BEGINNING OF WORK.
- ALL SIGN SPACING DIMENSIONS ARE APPROXIMATE, FIELD ADJUST AS NECESSARY OR AS DIRECTED.
- USE PORTABLE WORK ZONE SIGNS ONLY WITH PORTABLE WORK ZONE SIGN STANDS SPECIFICALLY DESIGNED FOR ONE ANOTHER. PORTABLE WORK ZONE SIGNS MAY BE ROLL UP OR APPROVED COMPOSITE.
- PROVIDE PORTABLE WORK ZONE SIGN STANDS, PORTABLE SIGNS AND SIGN SHEETING WHICH ARE LISTED ON THE NORTH CAROLINA DEPARTMENT OF TRANSPORTATION'S APPROVED PRODUCT LIST OR ACCEPTED AS TRAFFIC QUALIFIED BY THE TRAFFIC CONTROL UNIT.
- ** TWO-WAY UNDIVIDED ADVANCE WARNING SIGN CONFIGURATION MAY BE USED ON URBAN MULTI-LANE FACILITIES WHERE CONDITIONS LIMIT THE USE OF DUAL MOUNTED SIGNS AS DETERMINED BY THE ENGINEER.



LEGEND

◀ PORTABLE SIGN

◀ DIRECTION OF TRAFFIC FLOW

DETAIL DRAWING
FOR TWO-WAY UNDIVIDED
WORK ZONE WARNING SIGNS

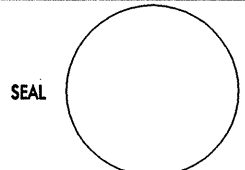
SHEET 1 OF 1

APPROVED: _____	DATE: _____	DETAIL DRAWING FOR TWO-WAY UNDIVIDED ADVANCED WORK ZONE WARNING SIGNS	
			
SCALE: NONE		REVISIONS	
DATE: _____		7-98	10/01
DWG. BY: _____		10-98	03/04
DESIGN BY: _____		01/01	11/04
REVIEWED BY: _____			

28-NOV-2006 16:17
 \\DOT\DFSR00101\GROUPS-WZTCCC\design\group4\resurfacing\resurfacing2006\dwl2\12cr103615etggeston\2cr103615.2wayundivurbfrwys\july2006.dgn
 psey@more AT WZTCCC603

ADVANCED WORK ZONE WARNING SIGNING FOR FREEWAYS (4 LANES OR GREATER)

DETAIL A

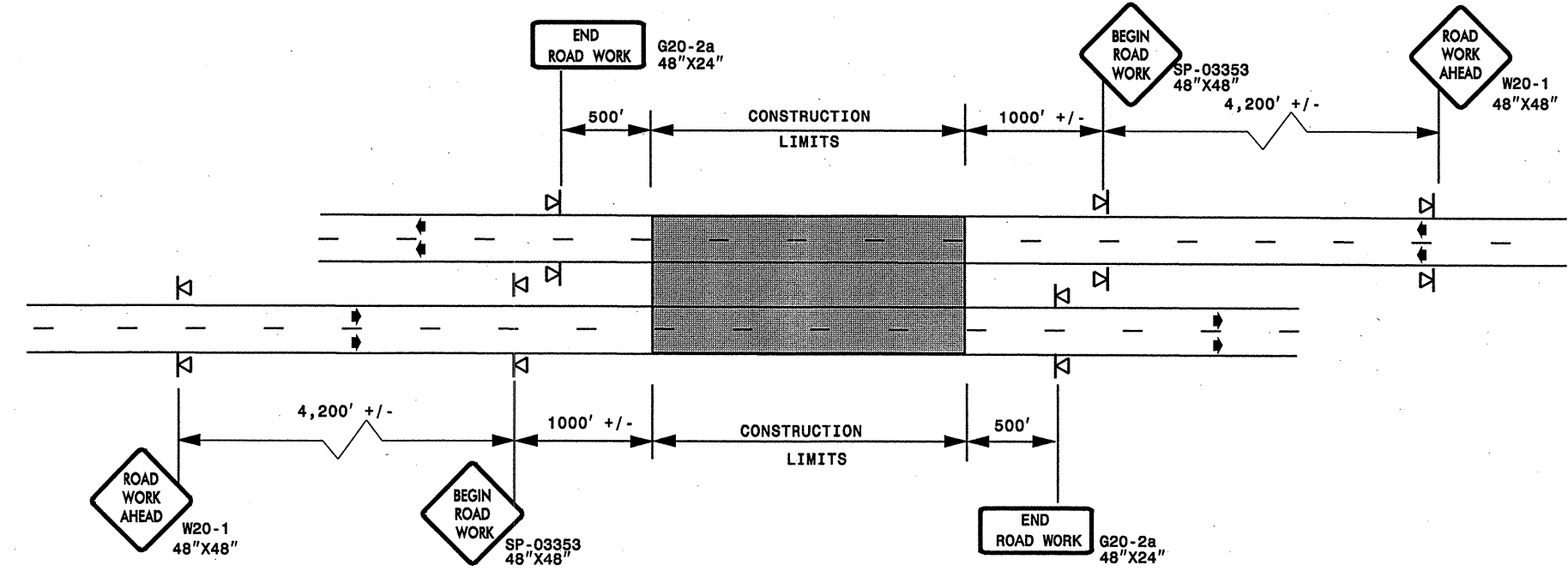

STATE OF NORTH CAROLINA
DEPT. OF TRANSPORTATION
DIVISION OF HIGHWAYS
RALEIGH, N.C.

ROADWAYS INTERSECTING ALONG FREEWAY WORK ZONE (Y-LINES)

DETAIL B

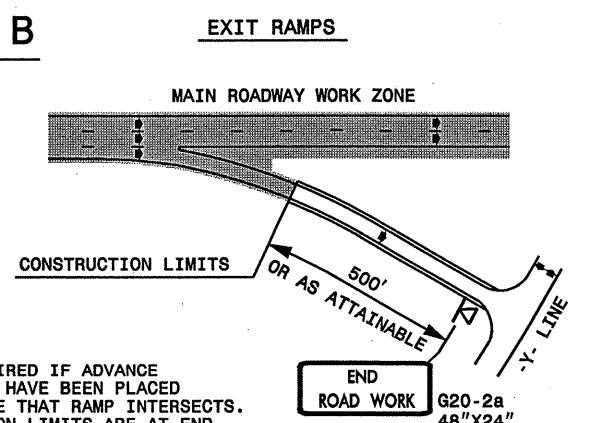

NOTE:
SIGN NOT REQUIRED IF ADVANCE WARNING SIGNS HAVE BEEN PLACED ALONG -Y- LINE THAT RAMP INTERSECTS. IF CONSTRUCTION LIMITS ARE AT END OF RAMP, PLACE SIGN AT END OF RAMP.

DETAIL C

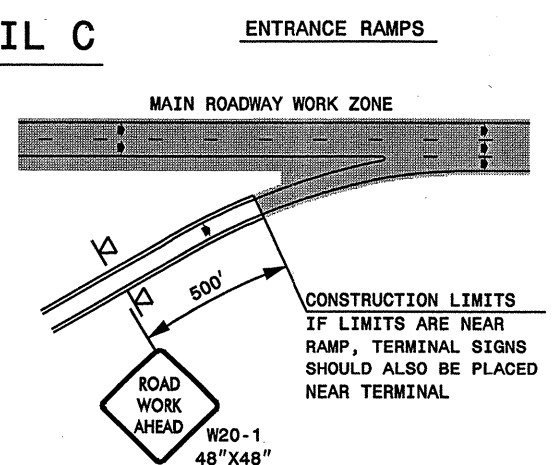

CONSTRUCTION LIMITS IF LIMITS ARE NEAR RAMP, TERMINAL SIGNS SHOULD ALSO BE PLACED NEAR TERMINAL

DETAIL D

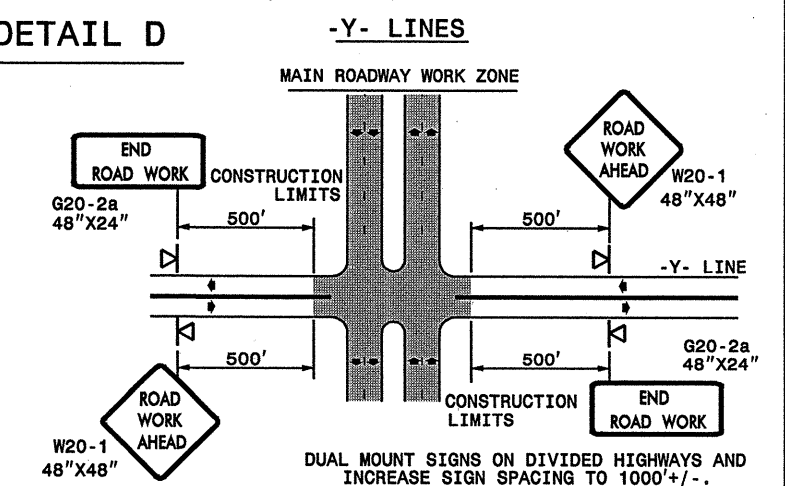

DUAL MOUNT SIGNS ON DIVIDED HIGHWAYS AND INCREASE SIGN SPACING TO 1000'+/-.

GENERAL NOTES

- USE FLUORESCENT ORANGE SHEETING (TYPE VII OR HIGHER) ON ALL ADVANCED WORK ZONE SIGNS.
- DO NOT INSTALL ADVANCE WARNING SIGNS MORE THAN 3 DAYS PRIOR TO BEGINNING OF WORK.
- ALL SIGN SPACING DIMENSIONS ARE APPROXIMATE, FIELD ADJUST AS NECESSARY OR AS DIRECTED.
- USE PORTABLE WORK ZONE SIGNS ONLY WITH PORTABLE WORK ZONE SIGN STANDS SPECIFICALLY DESIGNED FOR ONE ANOTHER. PORTABLE WORK ZONE SIGNS MAY BE ROLL UP OR APPROVED COMPOSITE.
- PROVIDE PORTABLE WORK ZONE SIGN STANDS, PORTABLE SIGNS AND SIGN SHEETING WHICH ARE LISTED ON THE NORTH CAROLINA DEPARTMENT OF TRANSPORTATION'S APPROVED PRODUCT LIST OR ACCEPTED AS TRAFFIC QUALIFIED BY THE TRAFFIC CONTROL UNIT.
- ** TWO-WAY UNDIVIDED ADVANCE WARNING SIGN CONFIGURATION MAY BE USED ON MULTI-LANE FACILITIES WHERE CONDITIONS LIMIT THE USE OF DUAL MOUNTED SIGNS AS DETERMINED BY THE ENGINEER.

LEGEND

◁ PORTABLE SIGN

➡ DIRECTION OF TRAFFIC FLOW

**DETAIL DRAWING
FOR FREEWAYS
WORK ZONE WARNING SIGNS
(SHORT-DURATION LANE CLOSURES)**

SHEET 1 OF 1

APPROVED: _____ DATE: _____	DETAIL DRAWING FOR FREEWAYS WORK ZONE WARNING SIGNS										
SEAL	SCALE: NONE										
	DATE: _____		<table border="1"> <tr> <th colspan="2">REVISIONS</th> </tr> <tr> <td>7-98</td> <td>10/01</td> </tr> <tr> <td>10-98</td> <td>03/04</td> </tr> <tr> <td>01/01</td> <td>11/04</td> </tr> </table>	REVISIONS		7-98	10/01	10-98	03/04	01/01	11/04
	REVISIONS										
	7-98		10/01								
10-98	03/04										
01/01	11/04										
DESIGN BY: _____	CHD FILE: _____										
REVIEWED BY: _____											

28-NOV-2006 16:24 \\DOT\OFFSR0010\GROUPS-WT\CCC\design\resurfacing\resurfacing2006\div12\12cr103615freeway4lanes\react\July2006.dgn

SP 03353

SIGN NUMBER: SP-03353 TYPE: A QUANTITY: 1 SIGN WIDTH: 4'-0" HEIGHT: 4'-0" TOTAL AREA: 16.0 Sq.Ft. BORDER TYPE: FLUSH RECESS: 0.89" WIDTH: 0.75" RADIUS: 1.38" NO. Z BARS: N/A LENGTH: N/A	BACKG COLOR: Fluorescent Orange COPY COLOR: Black SYMBOL	DESIGN BY: CL DOWNEY PROJECT ID: ALL PROJECTS	CHECKED BY: CHECKED DIV: DIV	STD #: W20-1 DATE: Aug 20, 2003
--	--	--	---------------------------------	------------------------------------

BORDER
R=1.38"
TH=0.75"
IN=0.59"

22.4" 21.6" 22.4"

LETTER POSITIONS

Letter spacings are to start of next letter

Letter	B	E	G	I	N	Text Length		
BEGIN	22.4	5.3	4.6	5.4	2.5	5.8	22.4	C7
ROAD	23.4	5	5.2	5.6	5.8	23.4	C7	
WORK	22.8	6.4	5.6	5.2	4	22.8	C7	

Spacing Factor is 1 unless specified otherwise

FILENAME: SPEC25HAK

NORTH CAROLINA D.O.T. SIGN DETAIL

STATE OF NORTH CAROLINA
 DEPT. OF TRANSPORTATION
 DIVISION OF HIGHWAYS
 RALEIGH, N.C.

DETAIL DRAWING FOR
 WORK ZONE SIGNS
 BEGIN ROAD WORK

GENERAL NOTES FOR SIGN SP-03353 "BEGIN ROAD WORK"

- SIGN SP-03353 "BEGIN ROAD WORK" ONLY APPLIES TO FULL CONTROL AND PARTIAL CONTROL OF ACCESS ROADWAYS
- WHEN USED, INSTALL SIGN SP-03353 "BEGIN ROAD WORK" ACCORDING TO DETAIL FOR FREEWAY WORK ZONE SIGNS

APPROVED: _____ DATE: _____	DETAIL DRAWING FOR ADVANCED WORK ZONE WARNING SIGN DESIGNS	
SEAL 	SCALE: NONE	REVISIONS
	DATE: 0803	0404
	DESIGN BY:	1104
	REVIEWED BY:	
		CADD FILE

28-NOV-2006 16:26
 \\DOT\SR0010\GROUPS-WZT\CCC\designgroup4\resurfacing\resurfacing2006\div2\12cr103615etcgaston\12cr103615SignDesigns\July2006.dgn
 pseymore AT WZT\226603