

09/08/99

T.I.P. NO.	SHEET NO.
B-4188	UC-1

TIP PROJECT: B-4188

STATE OF NORTH CAROLINA
DIVISION OF HIGHWAYS

**UTILITY CONSTRUCTION PLANS
MARTIN COUNTY**

LOCATION: BRIDGE NO. 36 OVER SMITHWICK CREEK ON SR 1523
TYPE OF WORK: UTILITIES

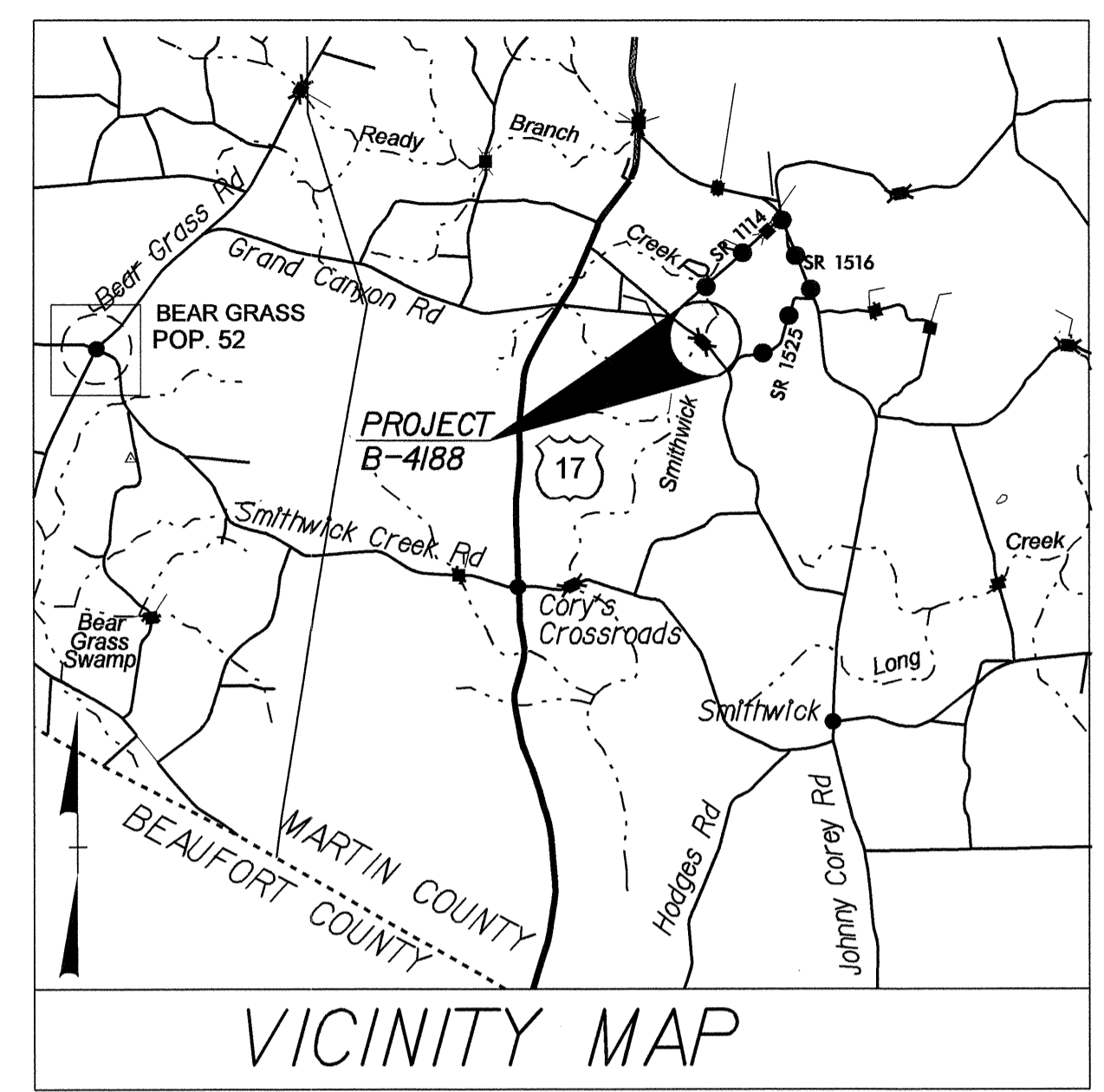

VICINITY MAP

--- OFFSITE DETOUR

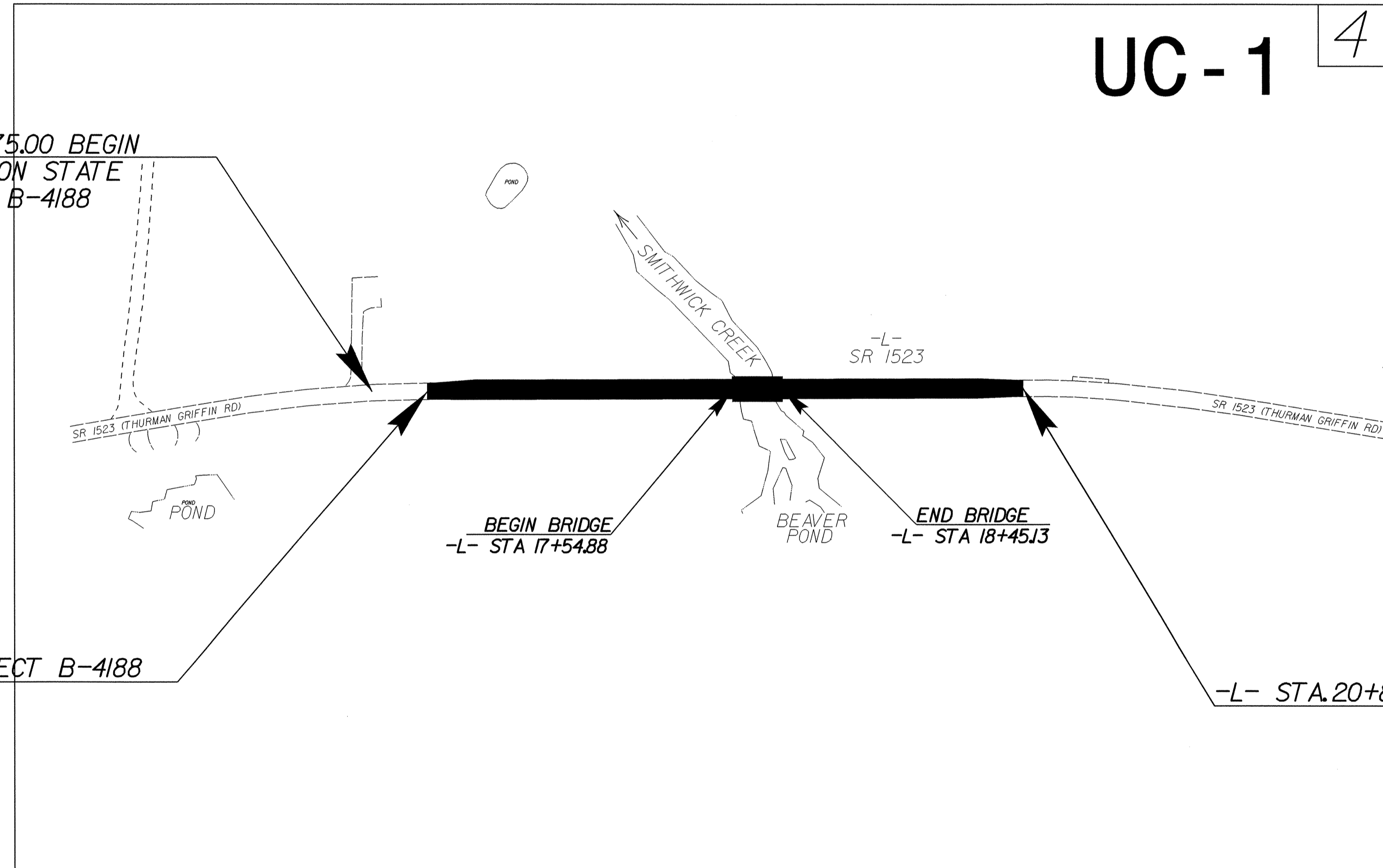
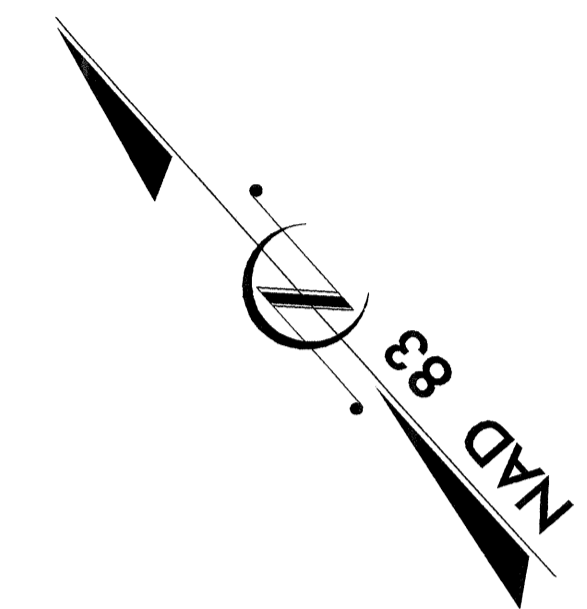

UC-1 4

-L- STA.14+35.91 BEGIN STATE PROJECT B-4188

-L- STA.20+87.08 END STATE PROJECT B-4188

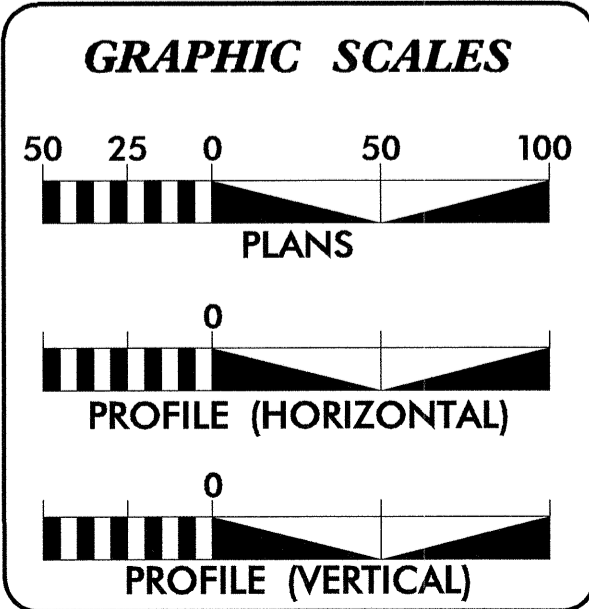

INDEX OF SHEETS	
SHEET NO.	DESCRIPTION
UC-1	TITLE SHEET
UC-2	UTILITY CONSTRUCTION AND DETAILS SHEET

WATER AND SEWER OWNERS ON PROJECT

(1) MARTIN COUNTY WATER

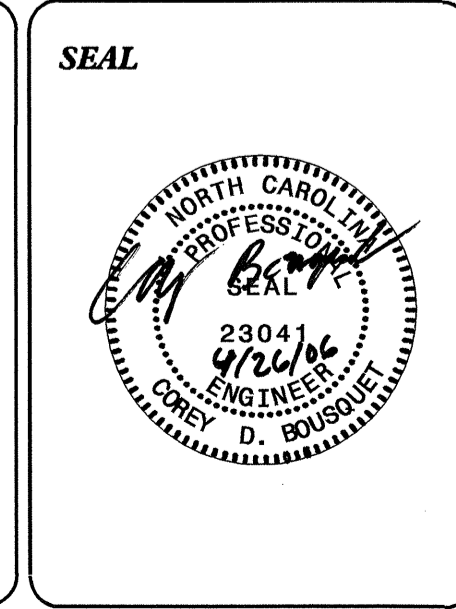

PREPARED IN THE OFFICE OF:
**DIVISION OF HIGHWAYS
PROJECT SERVICES
UTILITY SECTION**

1591 MAIL SERVICES CENTER
RALEIGH NC 27699-1591
PHONE (919) 250-4128
FAX (919) 250-4119

Roger Worthington, P.E. UTILITIES SECTION ENGINEER
Corey Bousquet, P.E. UTILITIES SQUAD LEADER PROJECT ENGINEER
Nabil Hamdan UTILITIES PROJECT DESIGNER

26-APR-2006 14:56 R:\Utilities\B4188_Ut_Title_UC1_psh.dgn

5/14/99

PROJECT REFERENCE NO.	SHEET NO.
B-4188	UC-02
DESIGNED BY: NSH	
DRAWN BY: NSH	
CHECKED BY: CDB	
APPROVED BY: CDB	
REVISED:	
NORTH CAROLINA DEPARTMENT OF TRANSPORTATION PROJECT SERVICES UNIT PHONE: (919) 250-4128 FAX: (919) 250-4119	
UTILITY CONSTRUCTION PLANS ONLY	

-L-	
PI Sta 13+21.81	PI Sta 21+97.78
$\Delta = 9^{\circ} 46' 54.5''$ (RT)	$\Delta = 9^{\circ} 26' 42.8''$ (RT)
$D = 4' 16' 32.9''$	$D = 4' 16' 32.9''$
$L = 228.77'$	$L = 220.90'$
$T = 114.66'$	$T = 110.70'$
$R = 1,340.00'$	$R = 1,340.00'$

RELOCATE FIRE HYDRANT

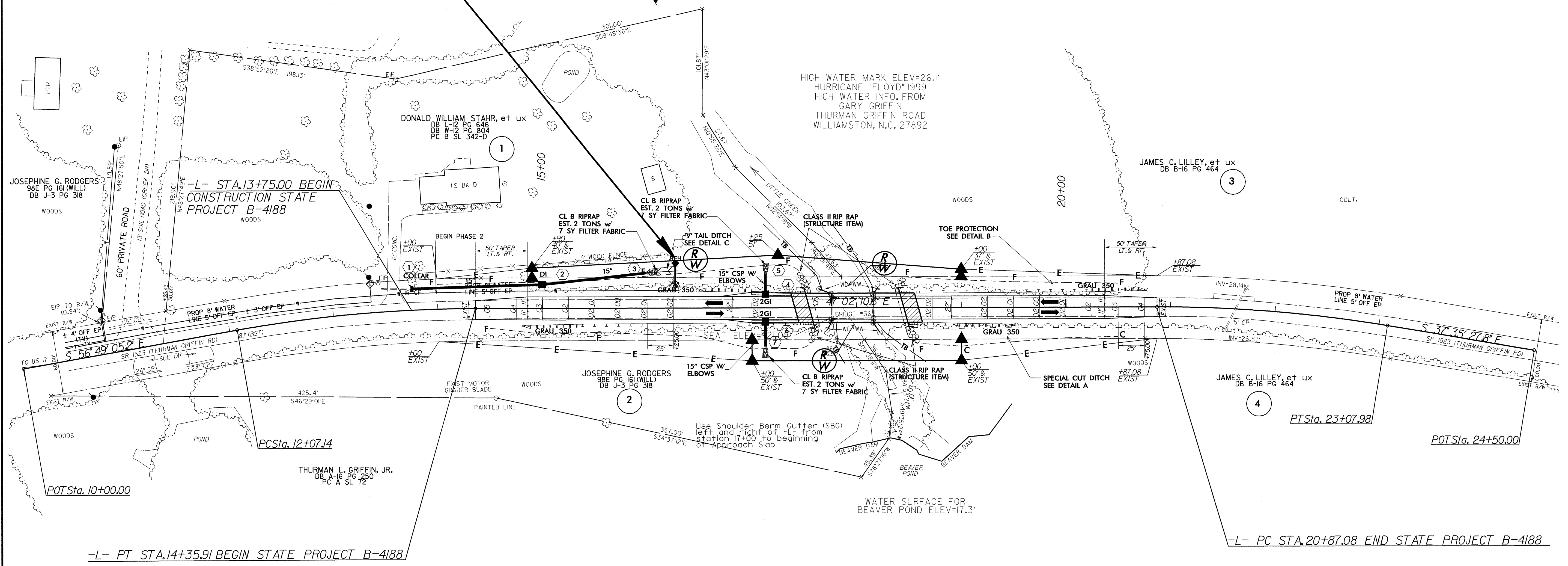

MAXIMUM TRENCH WIDTH AT TOP OF PIPE			
NOMINAL PIPE SIZE (INCHES)	TRENCH WIDTH (INCHES)	NOMINAL PIPE SIZE (INCHES)	TRENCH WIDTH (INCHES)
4	28	20	44
6	30	24	48
8	32	30	54
10	34	36	60
12	36	42	66
14	38	48	72
16	40	54	78
18	42		

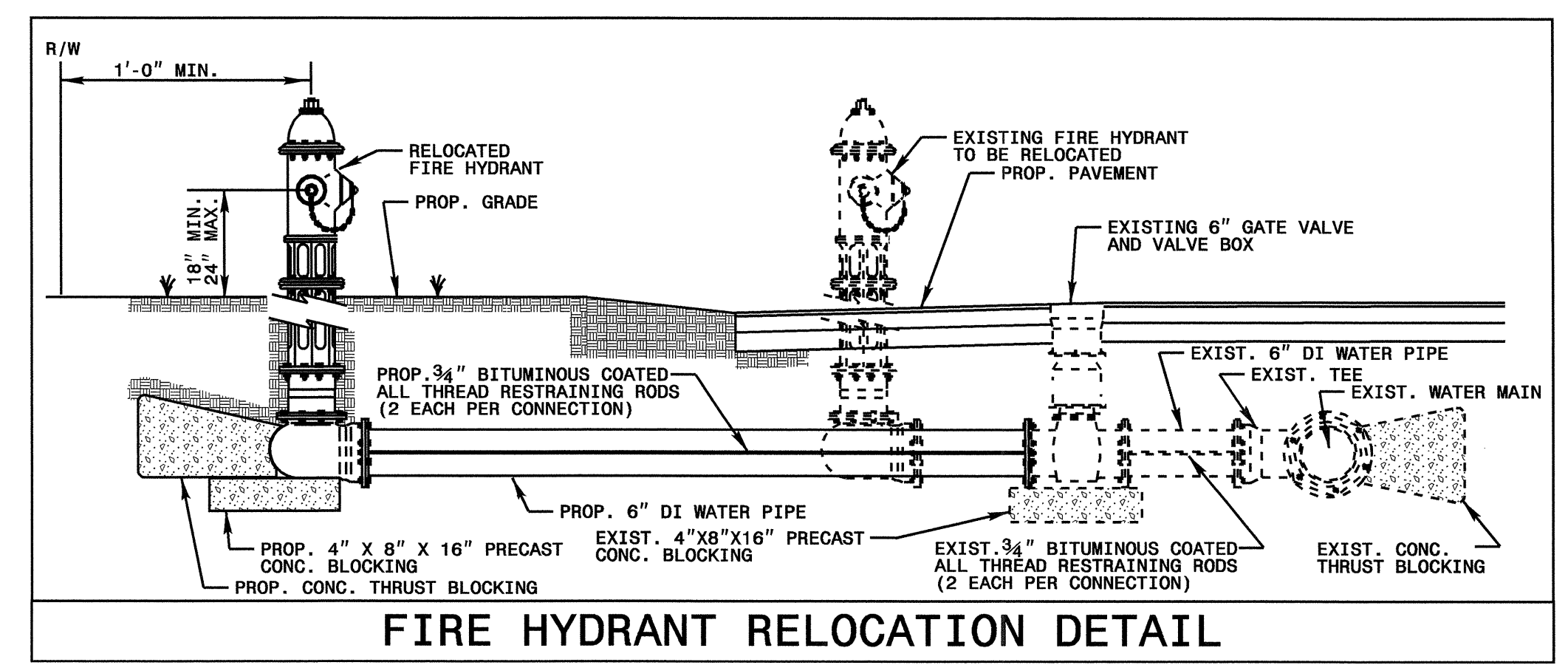
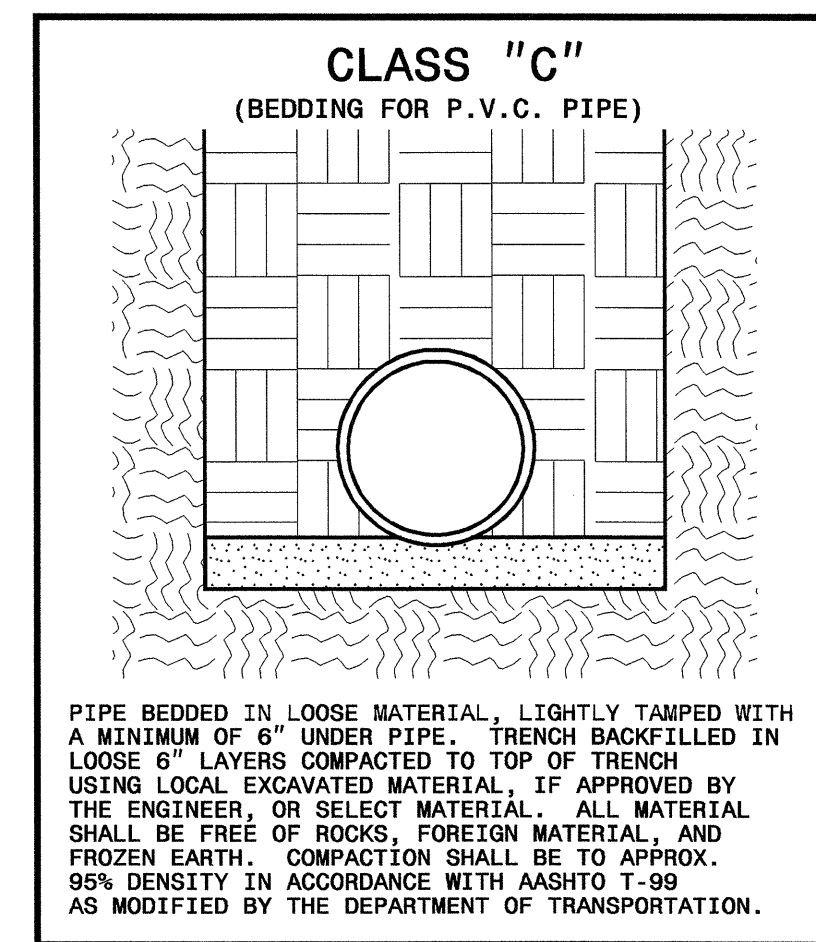

FIRE HYDRANT RELOCATION DETAIL

26-APR-2006 14:08
 \\utilities\rd\ut\proj\B4188_Ut_04_UC02_psh.dgn
 hmanan