



STATE OF NORTH CAROLINA  
DEPARTMENT OF TRANSPORTATION

MICHAEL F. EASLEY  
GOVERNOR

LYNDO TIPPETT  
SECRETARY

May 8, 2006

**Addendum No. 1**

RE: Contract ID: C201290  
WBS# 33122.3.2  
F. A. # BRSTP-700 (2)  
Rockingham County (**B-3509**)  
Bridge over Smith Creek and  
Approaches on NC-700.

**May 16, 2006 Letting**

To Whom It May Concern:

Reference is made to the proposal form recently furnished to you on this project.

The following revision has been made to the proposal form:

On Page No. 35, a new project special provision entitled "Permit Modification" has been added. Please void Page No. 35 in your proposal and staple the revised Page No.35 thereto.

On Page Nos. 154 and 155, the project special provision entitled "Construction, Maintenance and Removal of Temporary Access at Station 15+67.50-L-" has been revised. Please void Page Nos. 154 and 155 in your proposal and staple the revised Page Nos. 154 and 155 thereto.

New Page Nos. 250 thru 256 have been added to include the permit drawings. Please staple Page Nos. 250 thru 256 after Page No. 249 in your proposal. The Contract will be prepared accordingly.

The Table of Contents has been revised to reflect the above noted change. Please void the Table of Contents in your proposal and staple the revised Table of Contents thereto.

**MAILING ADDRESS:**  
NC DEPARTMENT OF TRANSPORTATION  
DESIGN SERVICES UNIT  
1591 MAIL SERVICE CENTER  
RALEIGH NC 27699-1591

TELEPHONE: 919-250-4128  
FAX: 919-250-4119  
WEBSITE: [WWW.DOH.DOT.STATE.NC.US](http://WWW.DOH.DOT.STATE.NC.US)

**LOCATION:**  
CENTURY CENTER COMPLEX  
ENTRANCE B2  
1020 BIRCH RIDGE DRIVE  
RALEIGH NC

Sincerely,

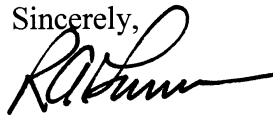

R. A. Garris, PE  
Contract Officer

RAG/jag/pa

cc: Mr. W. S. Varnedoe, PE  
Mr. S. D. DeWitt, PE  
Mr. E. C. Powell, PE  
Mr. J. M. Mills, PE  
Ms. D. M. Barbour, PE  
Mr. Art McMillan, PE  
Mr. Victor Barbour, PE  
Mr. Mark Staley (2)  
Mr. Robert Memory  
Mr. R. E. Davenport, Jr., PE  
Ms. Marsha Byrd  
Ms. Norma Smith  
Ms. Taylor Mishoe  
Project File (2)

CONTRACT: C201290 (B-3509)  
Rockingham County

TABLE OF CONTENTS

COVER SHEET	
PROPOSAL SHEETS	
PROJECT SPECIAL PROVISIONS (GREEN SHEETS)	PAGE NO.
Contract Time and Liquidated Damages.....	1
Intermediate Contract Time (s).....	1-3
Safety Index Rating.....	3-4
Major Contract Items.....	4
Specialty Items.....	4
Schedule of Estimated Completion Progress.....	4-5
Electronic Bidding.....	5-7
Disadvantaged Business Enterprise.....	7-16
Retainage and Prompt Payment.....	16-17
Certification for Federal-Aid Contracts.....	17-18
Contractor's License Requirements.....	18
Domestic Steel and Iron Products.....	18-19
U.S. Department of Transportation Hotline.....	19
Submission of Records - Federal-Aid Projects.....	19
Compensation and Record Keeping.....	20
Contractor Borrow Source.....	20-21
Subsurface Information.....	21
Borrow and Waste Site Reclamation Procedures.....	21
Plant and Pest Quarantines.....	21-22
Training Requirements.....	22
Safety Vests.....	22
Director of Construction in Lieu of Chief Engineer.....	22
Twelve Month Guarantee.....	23
Outsourcing Outside the USA.....	23
Disqualification of Bidders.....	24
Force Account Work.....	24-29
Control of Erosion, Siltation and Pollution.....	29
Rejection of Bids.....	30
Erosion & Sediment Control/Stormwater Certification.....	30-35
Permit Modification.....	35
Roadway.....	36-77
Utility Construction.....	78-84
Utility Conflicts.....	85-86
Erosion Control.....	87-100
Traffic Control.....	101-102
Project Special Provisions Structures.....	103-172
Project Special Provisions Signals & Intelligent Transportation Systems.....	173-190
Polyurea Pavement Marking Materials.....	191-193
Permits ( <b>WHITE SHEETS</b> ).....	194-256

Director of Construction  
1520 Mail Service Center  
Raleigh, NC 27699-1520

Failure to appeal within 10 calendar days will result in the proposed adverse action becoming effective on the date specified on the certified notice. Failure to appeal within the time specified will result in a waiver of all future appeal rights regarding the adverse action taken. The registrant will not be allowed to perform duties associated with the certification during the appeal process.

The Director of Construction will hear the appeal and make a decision within 7 days of hearing the appeal. Decision of the Director of Construction will be final and will be made in writing to the registrant.

If a certification is temporarily suspended, the registrant shall pass any applicable written examination and any proficiency examination, at the conclusion of the specified suspension period, prior to having the certification reinstated.

**VII. Measurement and Payment**

*Certified E&SC/SW Supervisor* is incidental to the project for which no direct compensation will be made.

*Certified Foremen* are incidental to the project for which no direct compensation will be made.  
SP1G180

**PERMIT MODIFICATION:**

The Contractor's attention is directed to the U.S. Army Corps of Engineers' permit contained elsewhere in this proposal. The Department will apply for a permit modification to increase the allowable temporary impacts from 0.001 to 0.05 acre. These temporary impacts are for the work associated with the foundations for the temporary work bridges and the temporary detour bridge. The Department anticipates receiving this permit modification prior to the date of availability of this project.

**CONSTRUCTION, MAINTENANCE AND REMOVAL  
OF TEMPORARY ACCESS AT STATION 15+67.50 – L-**

(SPECIAL)

**1.0 GENERAL**

Construct, maintain, and remove the temporary access required to provide the working area necessary to construct the proposed and temporary detour bridges and remove the existing bridge. Temporary access may include other methods than those outlined in this Special Provision; however, all types of temporary access are required to meet the requirements of all permits, the Standard Specifications, and this Special Provision.

**2.0 TEMPORARY WORK BRIDGE**

The construction of a temporary work bridge is permitted as shown on the plans. The temporary work bridge shall have a minimum span length of 20 feet. Due to the high rock elevation, a pile foundation may not be feasible. A precast concrete or steel A-frame foundation may be necessary. Submit details of the temporary work bridge to the Engineer prior to constructing the work bridge to ensure conformance with the plans and all permits. Make certain that the temporary work bridge satisfies all permits. Completely remove the temporary bridge prior to final acceptance or as otherwise required by the permits.

**3.0 BASIS OF PAYMENT**

The lump sum price bid for “Construction, Maintenance and Removal of Temporary Access at Station \_\_\_\_\_” will be full compensation for the above work, or other methods of access, including all material, work bridge components, equipment, tools, labor, disposal, and incidentals necessary to complete the work.

**ELASTOMERIC BEARINGS**

(10-03-02)

Use elastomeric bearings in accordance with Article 1079-2 of the Standard Specifications except as follows:

**TABLE 1079-2  
NATURAL RUBBER ELASTOMER REQUIREMENTS**

Grade (durometer)	50	60
PHYSICAL PROPERTIES		
Hardness ASTM D2240	50 +5 -5	60 +5 -5

**PRESTRESSED CONCRETE MEMBERS**

3-04-05

In Section 1078-12 of the Standard Specifications. After the first sentence of “5,” place the following:

“Conduit may be rigid one-piece or rigid two-piece (split sheathed). Do not use flexible conduit.”

In Section 1078-13 of the Standard Specifications, after the fourth paragraph add the following paragraph:

“When handling the prestressed concrete members, a temporary stress of  $5\sqrt{f_{ci}}$  is permitted, where  $f_{ci}$  is the strength of concrete at release, in psi.”

In Section 1078-5 of the Standard Specifications, place the following two sentences after the first paragraph:

“When casting holes through the top flange of Bulb Tee Girders for overhang or interior bay falsework hanger rods use rigid PVC conduits with a wall thickness of approximately 1/8 inch. Do not use thin wall material. Secure conduits in the forms so that they do not migrate out of the proper location. Other methods of forming holes may be proposed but are subject to the Engineer’s approval.”

# NORTH CAROLINA

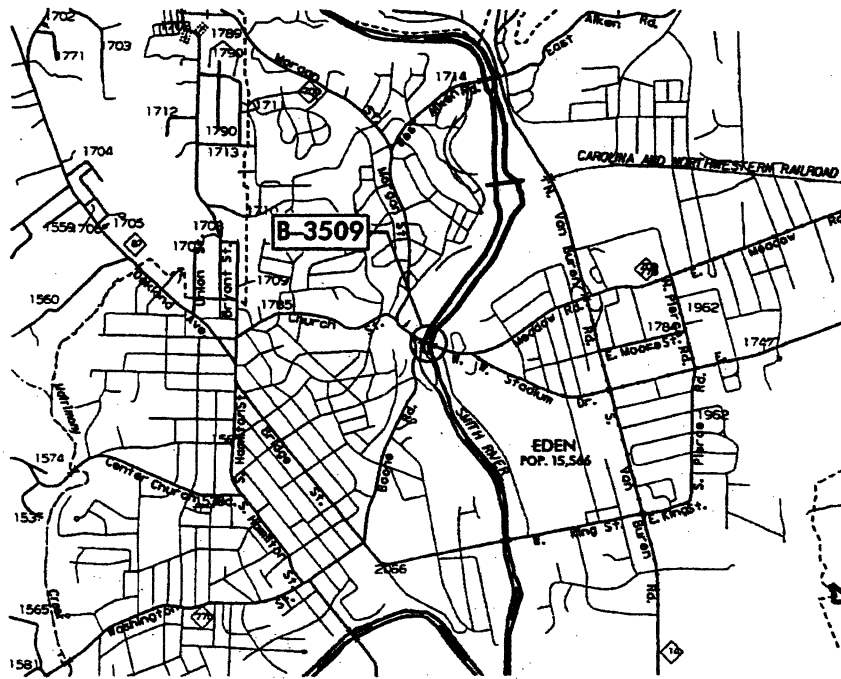
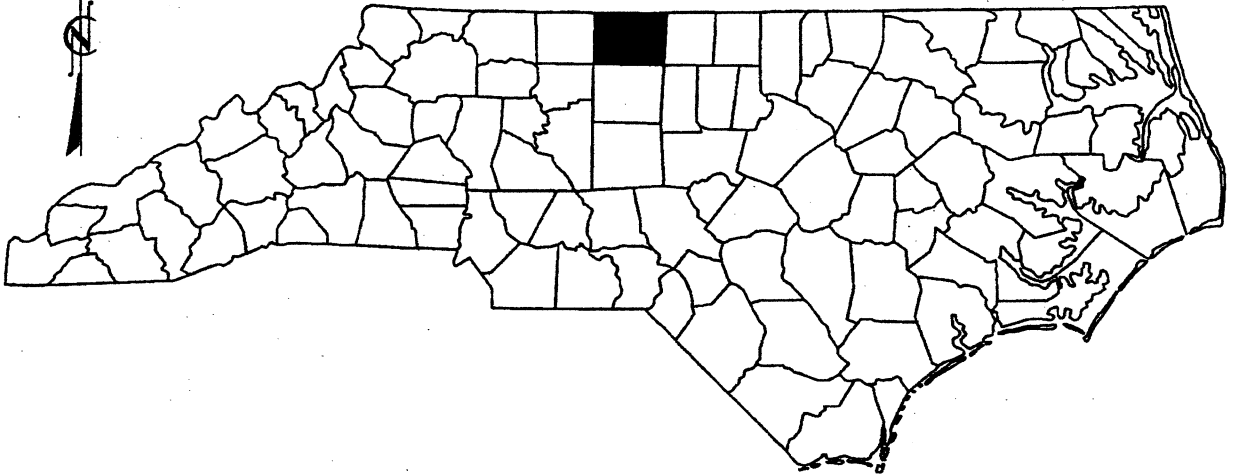

## VICINITY MAPS

### NCDOT

DIVISION OF HIGHWAYS  
ROCKINGHAM COUNTY  
PROJECT: 8.1511701 (B-3509)

BRIDGE NO. 75 ON SR 3003  
(MEADOW RD) OVER  
SMITH RIVER

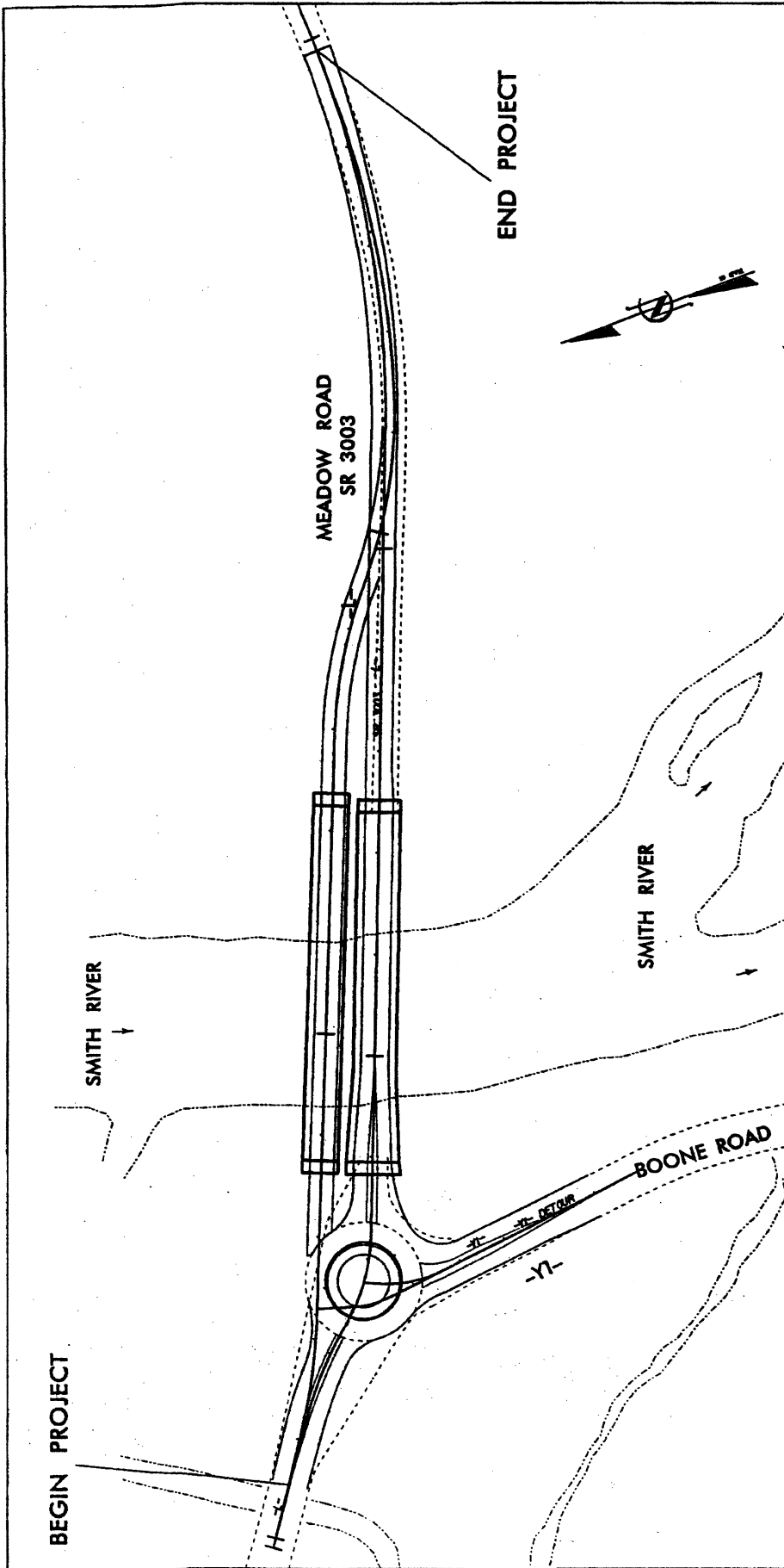

# SITE MAP

**NCDOT**  
 DIVISION OF HIGHWAYS  
 ROCKINGHAM COUNTY  
 PROJECT: 8.1511701 (B-3509)  
 BRIDGE NO. 75 ON SR 3003  
 (MEADOW RD.) OVER  
 SMITH RIVER

SHEET 2 OF 7 9/7/04



MATCHLINE TO -L- STA 24+00.00

PROJECT REFERENCE NO. B-1509 SHEET NO. 4

WINDMILLS ENGINEER HIGHWAY DESIGN ENGINEER

**PRELIMINARY PLANS**  
DO NOT USE FOR I/V ACQUISITION

**PRELIMINARY PLANS**  
DO NOT USE FOR CONSTRUCTION

30F7

**MULKEY**  
ENGINEERS & ARCHITECTS  
INCORPORATED

ENGLISH

**DITCH DETAIL 'A'**  
"V" DITCH W/ CLASS. OF IMP RAMP

LANE	STA. TO STA.	DOE (CU. YDS.)	PP PAP (LBS.)	FASTER FABRIC (SQ. YDS.)
L-DET	16+70 - 17+23 L.I.	20	20	58

GR. 1" MAX

NOTE: CENTER AND DOE CRANKS ARE ASSUMED TO BE CENTER FROM -L- STA 16+70 TO -L- STA 17+23 AND 17+23 TO -L- STA 19+33. ALL CRANKS WILL BE ACQUIRED FROM -L- STA 19+33 TO -L- STA 24+00. ALL CRANKS WILL BE ACQUIRED FROM -L- STA 24+00 TO -L- STA 25+00.

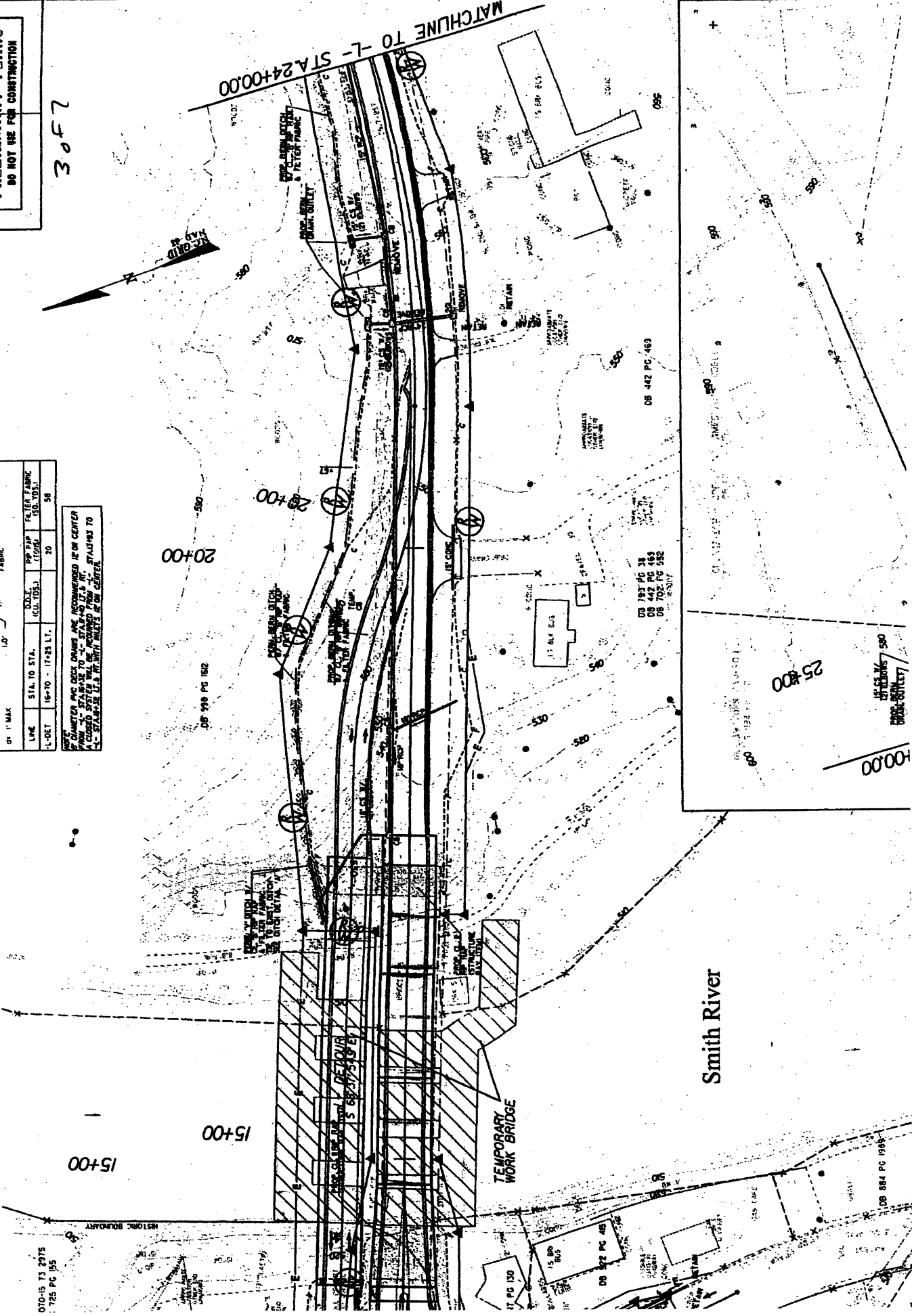

Smith River

100.00

DB 884 PG 095

25+00

DB 793 PG 38  
DB 442 PG 463  
DB 702 PG 532

DB 442 PG 463

070-15 TS 2975  
1725 PG 95

PROJECT REFERENCE NO. B-3509  
 SHEET NO. 4

PRELIMINARY PLANS  
 DO NOT USE FOR CONSTRUCTION  
 PRELIMINARY PLANS  
 DO NOT USE FOR CONSTRUCTION

MULKEY ENGINEERING  
 1000 W. 10TH ST. SUITE 100  
 DENVER, CO 80202

ENGLISH

DITCH DETAIL 'A'

STATION	PC	PT	PI	PT	PC
14+80	14+80.00	14+80.00	14+80.00	14+80.00	14+80.00
14+85	14+85.00	14+85.00	14+85.00	14+85.00	14+85.00
14+90	14+90.00	14+90.00	14+90.00	14+90.00	14+90.00
14+95	14+95.00	14+95.00	14+95.00	14+95.00	14+95.00
15+00	15+00.00	15+00.00	15+00.00	15+00.00	15+00.00

1:1 SLOPE  
 12" DEPTH  
 12" WIDE AT TOP

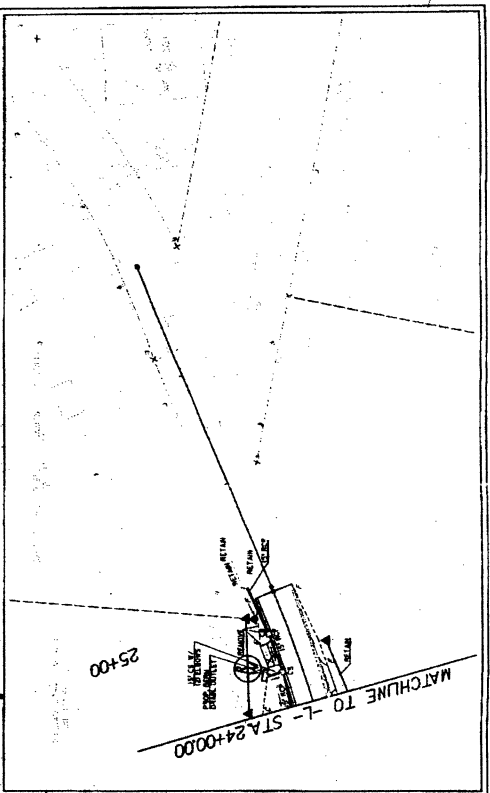
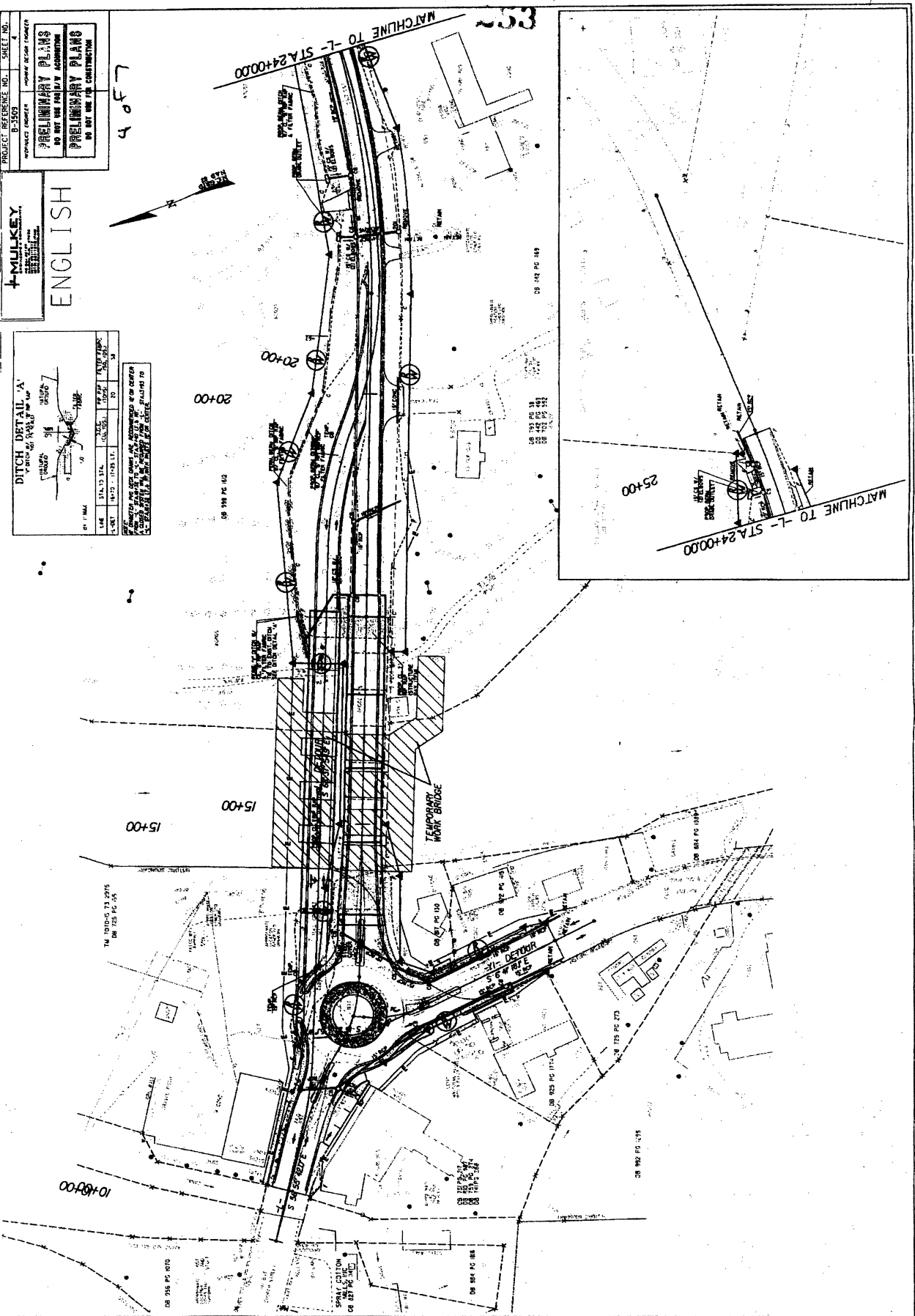

REVISIONS

**MULKEY**  
 ENGINEERS  
 1000 W. 10th St.  
 Grand Rapids, Mich.

PROJECT: STATE ST. IMPROVEMENTS  
 SHEET NO. 5  
 DATE: 10/15/03  
 DRAWN: J. J. JONES  
 CHECKED: J. J. JONES

**PRELIMINARY PLANS**  
 DO NOT USE FOR CONSTRUCTION

**PRELIMINARY PLANS**  
 DO NOT USE FOR CONSTRUCTION

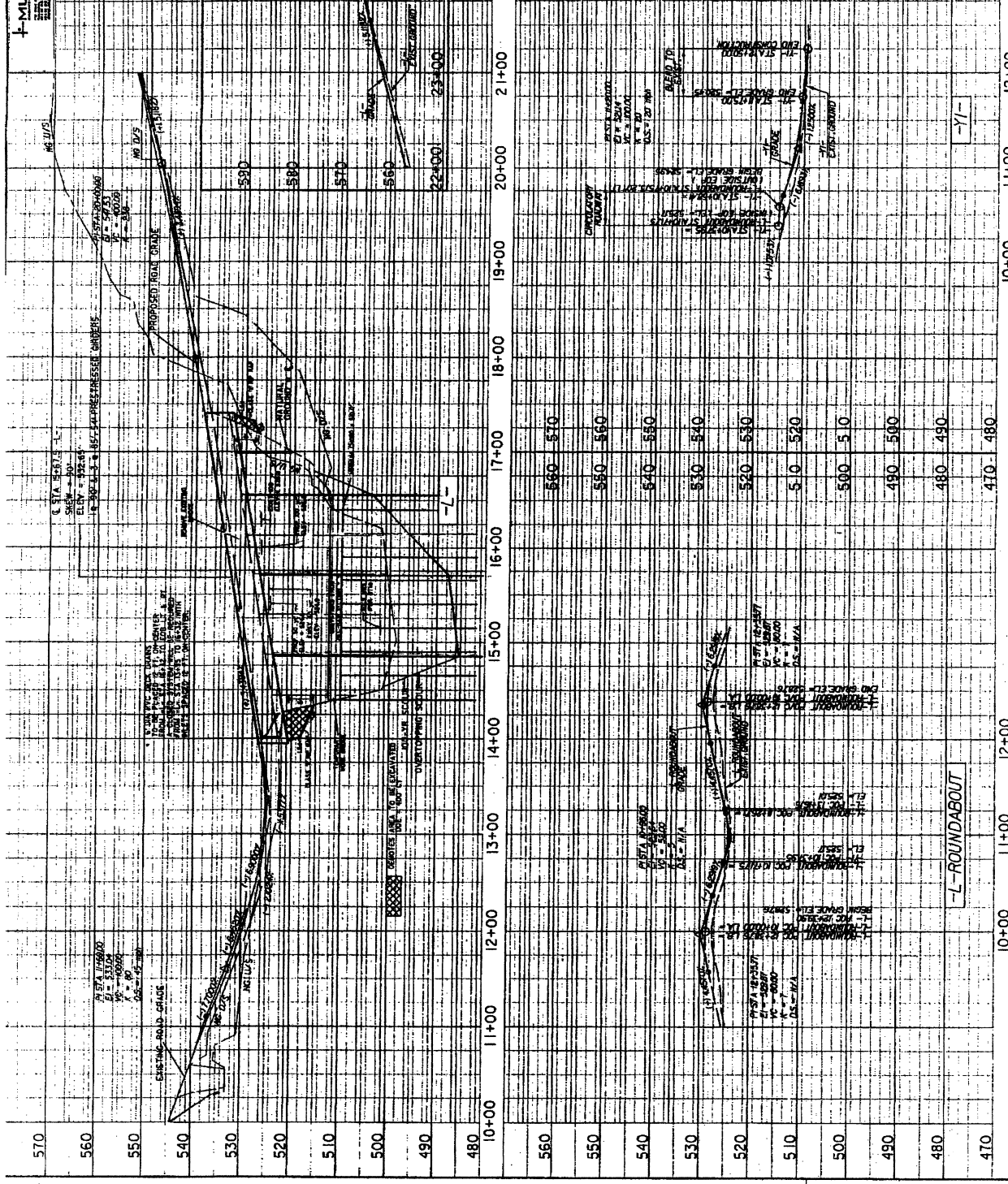

570	10+00	11+00	12+00	13+00	14+00	15+00	16+00	17+00	18+00	19+00	20+00	21+00	22+00	23+00	24+00	25+00
560																
550																
540																
530																
520																
510																
500																
490																
480																
560	10+00	11+00	12+00	13+00	14+00	15+00	16+00	17+00	18+00	19+00	20+00	21+00	22+00	23+00	24+00	25+00
550																
540																
530																
520																
510																
500																
490																
480																
470																

**L-ROUNDABOUT**

**-Y-**

REVISIONS

10/15/03 J. J. JONES

**PROPERTY OWNERS**  
NAMES AND ADDRESSES

<b>PARCEL NO.</b>	<b>NAMES</b>	<b>ADDRESSES</b>
3	CAMERON, WILLIAM JOHN	351 MEADOW RD. EDEN, NC 27288
4	SPRAY COTTON MILL	P. O. BOX 3207 EDEN, NC 27289

**NCDOT**

DIVISION OF HIGHWAYS  
ROCKINGHAM COUNTY  
PROJECT: 8.1511701 (B-3509)

BRIDGE NO. 75 ON SR 3003  
(MEADOW RD.) OVER  
SMITH RIVER

**WETLANDS IMPACT PERMIT SUMMARY**

Site No.	Station (From/To)	Structure Size / Type	Fill In Wetlands (ac)	Temp. Fill In Wetlands (ac)	Excavation In Wetlands (ac)	Mechanized Clearing (Method III) (ac)	Fill In SW (Natural) (ac)	Fill In SW (Pond) (ac)	Temp. Fill In SW (ac)	Existing Channel Impacted (ft)	Natural Stream Design (ft)
1	15+67 -L-	345' 54" PRESTRESSED GIRDER	0	0	0	0	0	0	0	0	0
<b>TOTALS:</b>			0	0	0	0	0	0	0	0	0

Bridge bents in - 86 ft<sup>2</sup>  
 Water  
 Temp Work Bridge/Detail - 0.001 Ac

**NCDOT**  
 DIVISION OF HIGHWAYS  
 ROCKINGHAM COUNTY  
 PROJECT 8.1511701 (B-3509)  
 BRIDGE NO.75 ON SR 3003  
 (MEADOW RD.) OVER  
 SMITH RIVER