

- Note:
- \*See RSD No. 1101.11 for L and Barrier Flare Rate
  - \*\*Remove/fill rumble strip, remove existing edgeline and place proposed removable tape.
  - For signs and locations, see TCP-11.

# PORTABLE CONCRETE BARRIER DETAIL

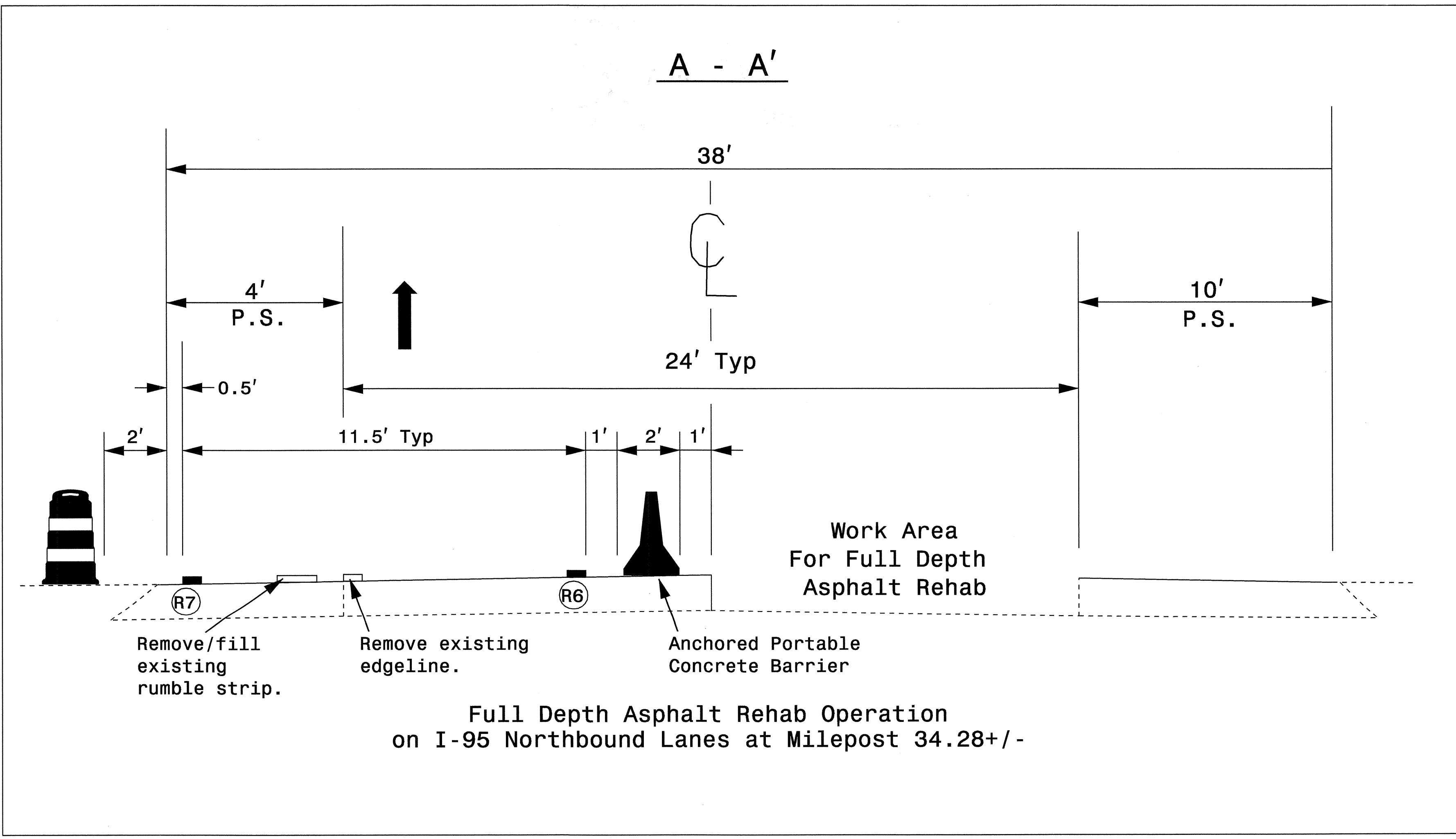
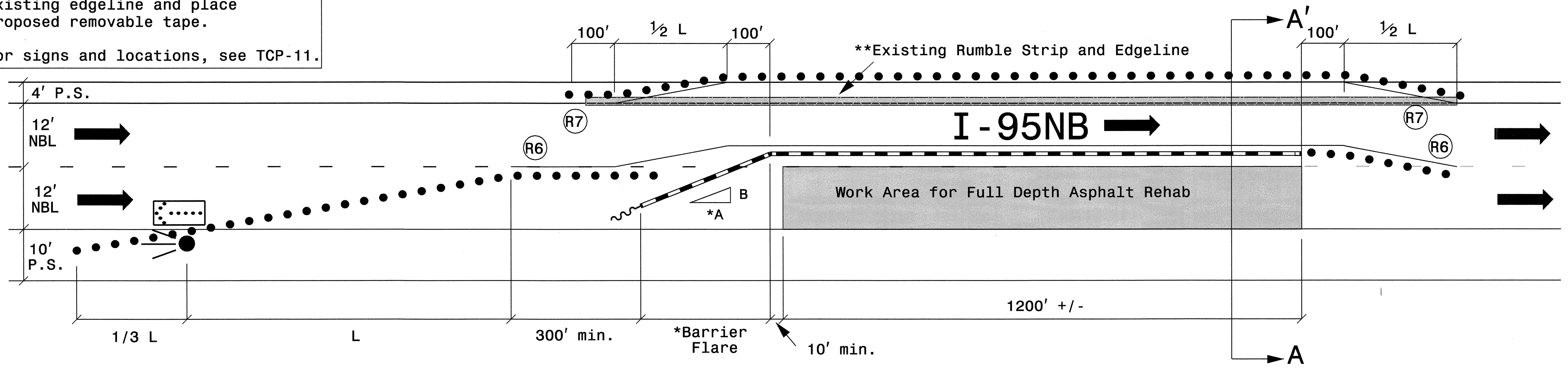

APPROVED:	DATE: 11/16/2005	<b>PORTABLE CONCRETE BARRIER DETAIL</b>	
	SCALE: NONE		REVISIONS
	DATE: 11-15-05		
	DWG. BY: PS		
	DESIGN BY: JPG		
	REVIEWED BY: MMM		

15-NOV-2005 10:27  
 \\efs-cctfso3\147118\Traffic\control\top\14711\_fc\_top12\_pcb.dgn  
 psey/more AT WZTC06427