

NOTE: STANDARD SHORING IS NOT ALLOWED. CONTRACTOR IS RESPONSIBLE FOR SUBMITTING SHORING DESIGN.

NOTE: FOR DESIGN OF TEMPORARY SHORING ABOVE THE DREDGE LINE, USE THE FOLLOWING SOIL PARAMETERS
 UNIT WEIGHT OF SOIL ABOVE WATER TABLE, $\gamma = 120$ PCF
 UNIT WEIGHT OF SOIL BELOW WATER TABLE, $\gamma' = 60$ PCF
 FRICTION ANGLE, $\phi = 27^\circ$
 COHESION, $c = 0$ PSF

NOTE: FOR DESIGN OF TEMPORARY SHORING BELOW THE DREDGE LINE, USE THE FOLLOWING SOIL PARAMETERS
 UNIT WEIGHT OF SOIL ABOVE WATER TABLE, $\gamma = 120$ PCF
 UNIT WEIGHT OF SOIL BELOW WATER TABLE, $\gamma' = 60$ PCF
 FRICTION ANGLE, $\phi = 30^\circ$
 COHESION, $c = 0$ PSF

SECTION B-B₁
 STA. 20+00 +/-

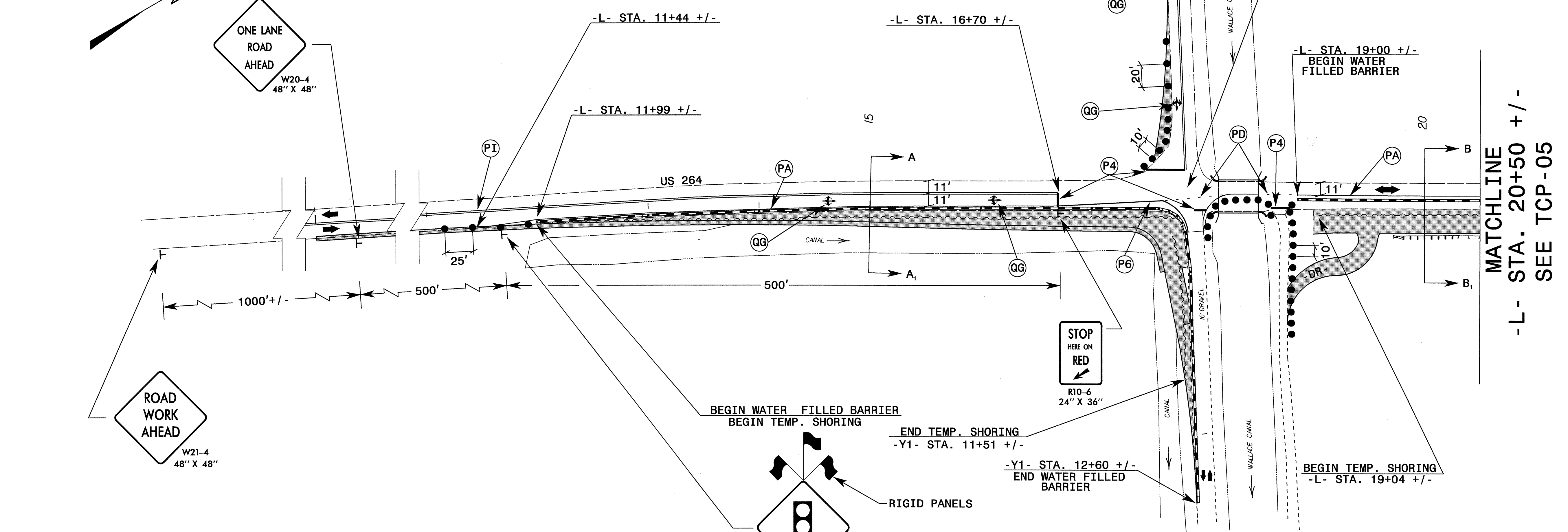
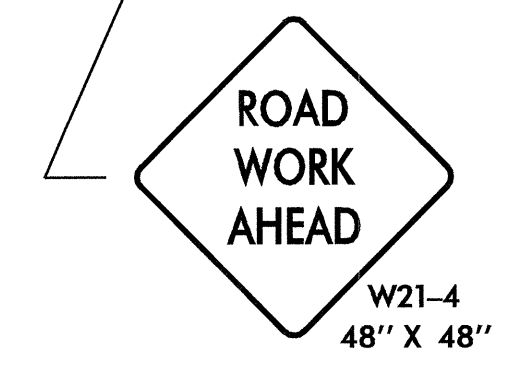
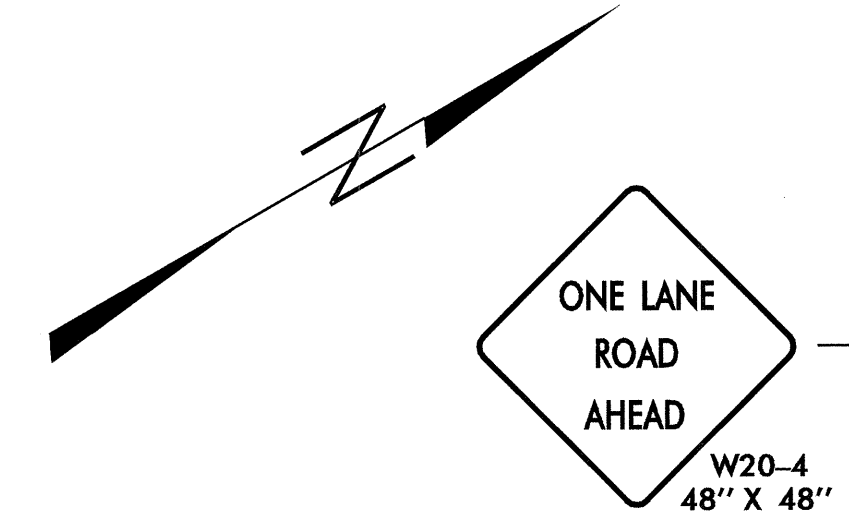
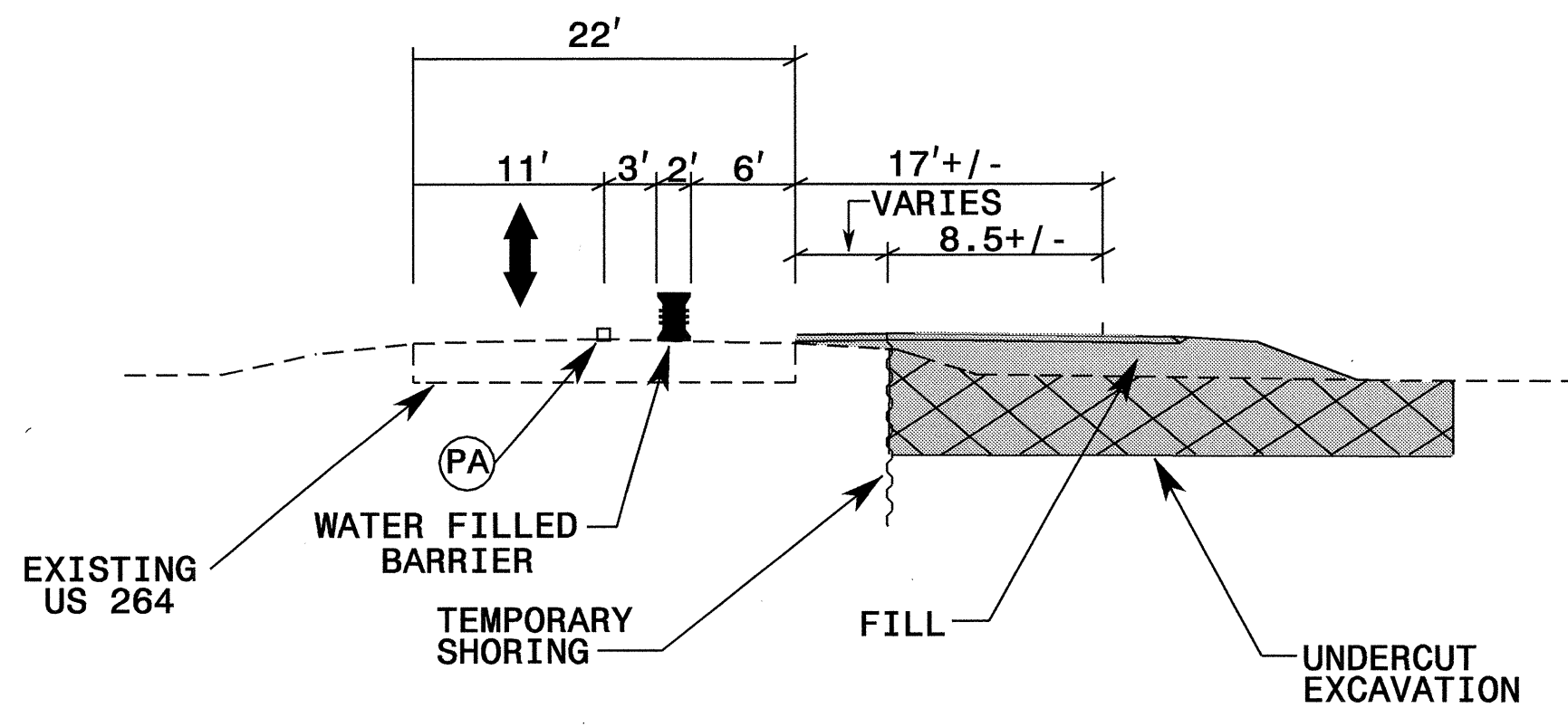

SECTION A-A₁
 STA. 15+00 +/-

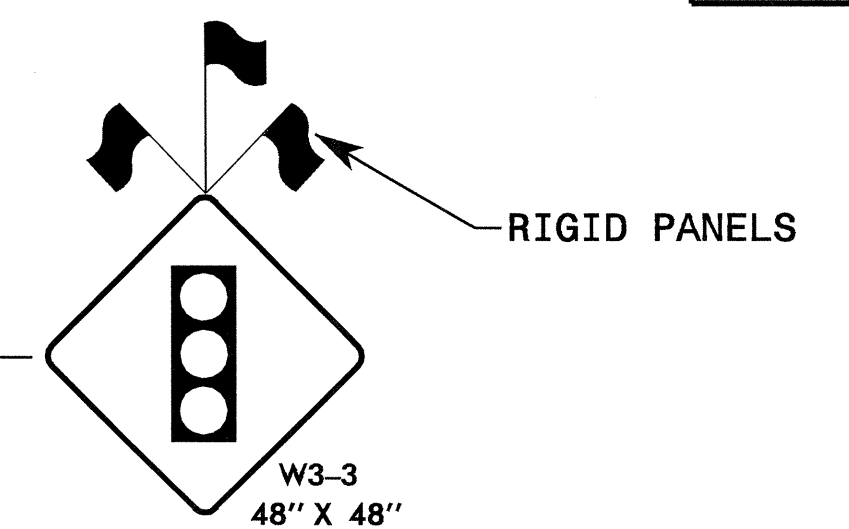
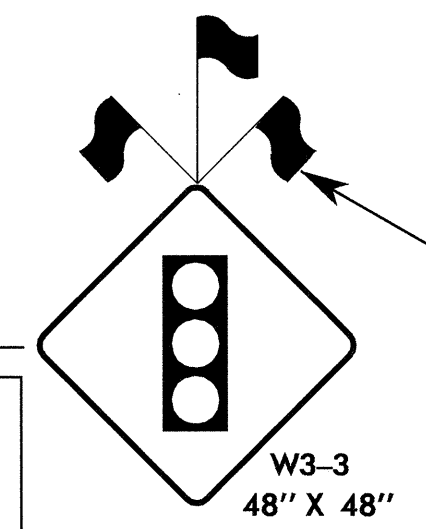
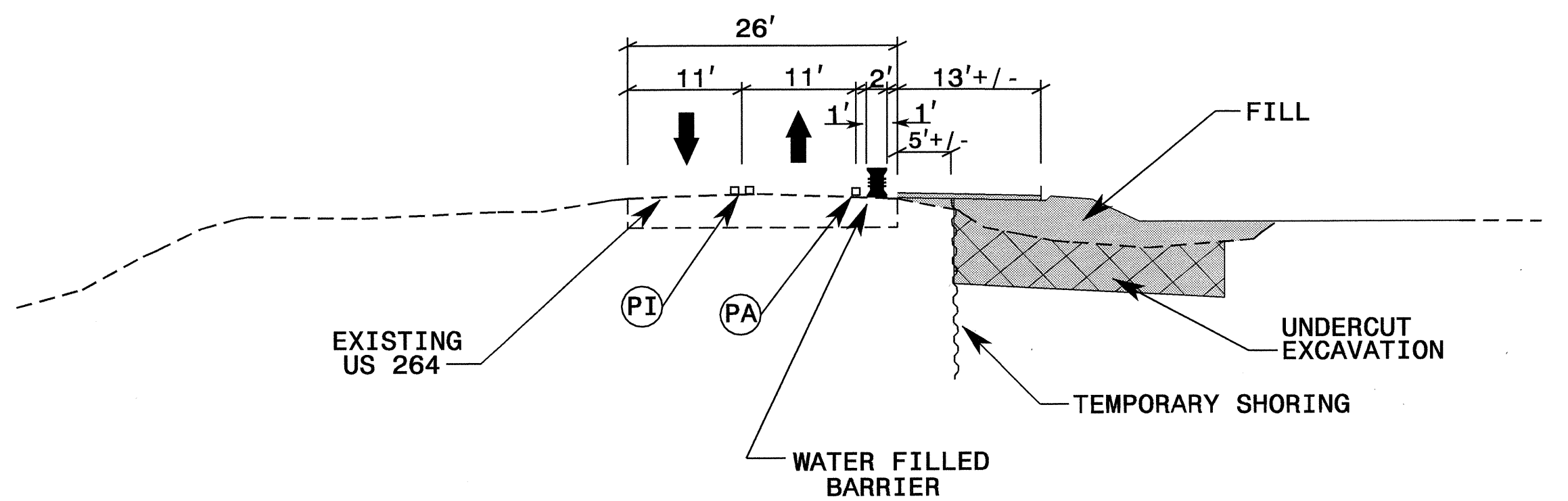

SEE TCP-03 FOR PAVEMENT MARKING SCHEDULE

MATCHLINE
 -L- STA. 20+50 +/-
 SEE TCP-05

19-APR-2004 11:52
 M:\TCP\B3348-TCP04.dgn
 SJS/ks AT TEL09653

APPROVED: *[Signature]* DATE: 4/9/04

SEAL

PROFESSIONAL ENGINEER
 SEAL 022104
 JOHN S. KITE, II

PHASE I

SCALE: NONE
 DATE: 05/03
 DWG. BY: SJS
 DESIGN BY: SJS
 REVIEWED BY: CLM

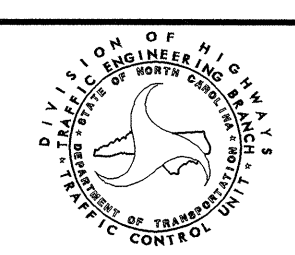

REVISIONS