

REVISIONS

W RALPH WHITEHEAD ASSOCIATES
CONSULTING ENGINEERS
P.O. BOX 35624
CHARLOTTE, NORTH CAROLINA 28235

| | |
|--------------------------------------|---------------------|
| PROJECT REFERENCE NO. 37613, ETC. | SHEET NO. 17 |
| RW SHEET NO. | |
| ROADWAY DESIGN ENGINEER | HYDRAULICS ENGINEER |

MAP #6 US 64 / SR 1382

BEGIN STATE PROJECT MA08013R
BEGIN GRADE

-L- POT STA.12+67.00

END STATE PROJECT MA08013R
END GRADE

-L- POT STA.17+28.00

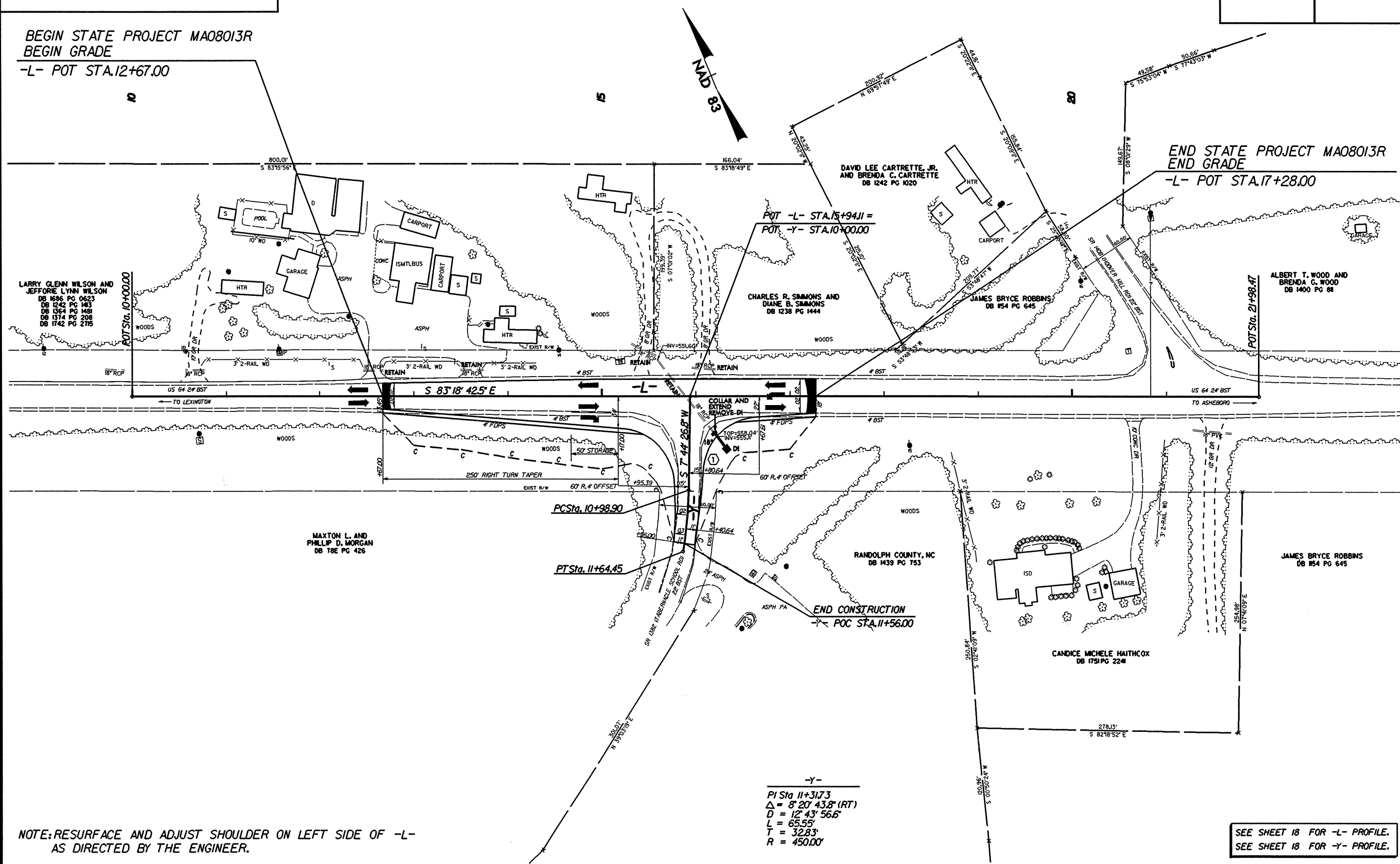

NOTE: RESURFACE AND ADJUST SHOULDER ON LEFT SIDE OF -L- AS DIRECTED BY THE ENGINEER.

SEE SHEET 18 FOR -L- PROFILE.
SEE SHEET 18 FOR -Y- PROFILE.

8/17/99
*****SYTIME*****
*****L*****
*****L*****