

5/28/99

W RALPH WHITEHEAD ASSOCIATES
CONSULTING ENGINEERS
P.O. BOX 35624
CHARLOTTE, NORTH CAROLINA 28235

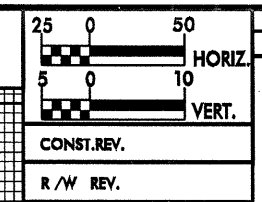

PROJECT REFERENCE NO. 37613, ETC.	SHEET NO. 24
ROADWAY DESIGN ENGINEER	HYDRAULICS ENGINEER

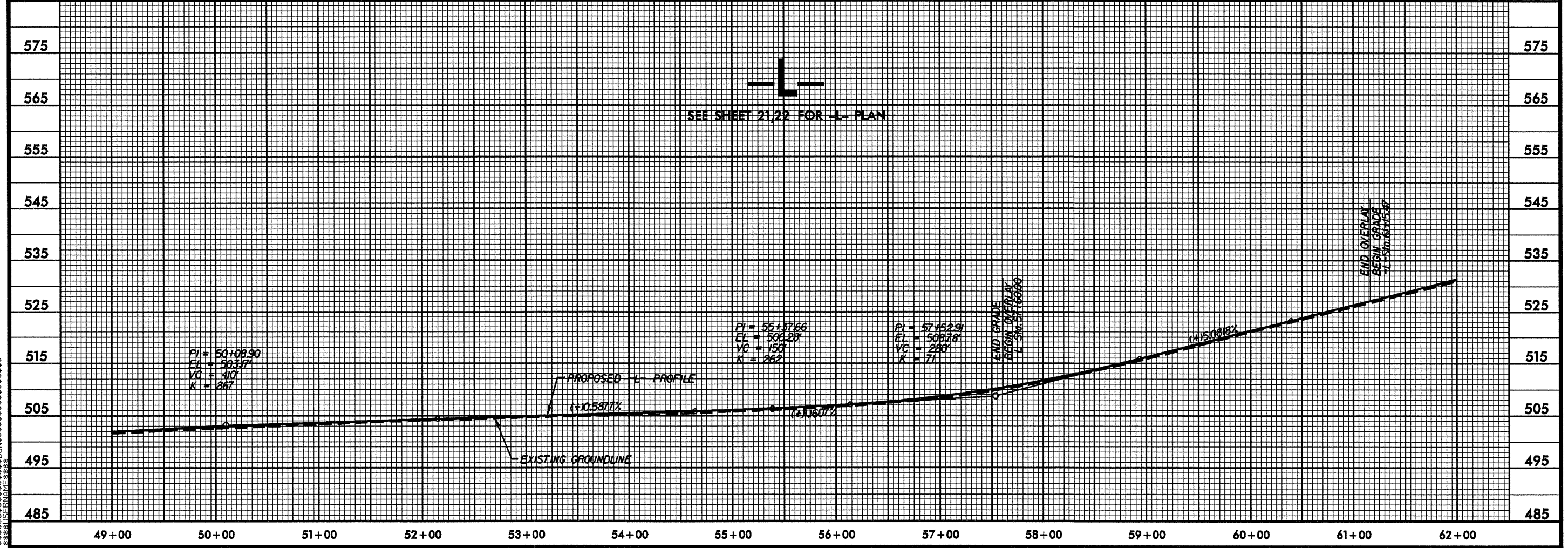
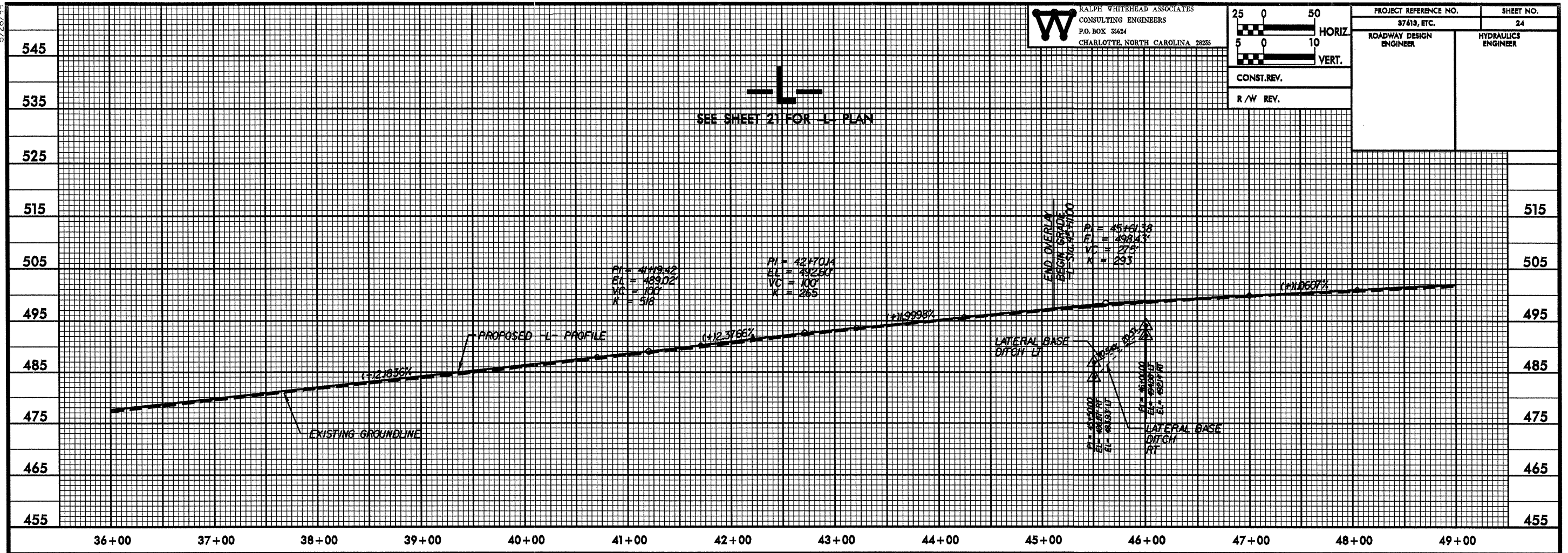

SYSTEMS ENGINEERING