

8/17/99

REVISIONS

MAP #11 US 64 / SR 1424

W RALPH WHITEHEAD ASSOCIATES
CONSULTING ENGINEERS
P.O. BOX 35624
CHARLOTTE, NORTH CAROLINA 28235

PROJECT REFERENCE NO.
37619, ETC.

SHEET NO.
EC-19

R/W SHEET NO.

ROADWAY DESIGN ENGINEER

HYDRAULICS ENGINEER

V&M
Vaughn & Melton
Consulting Engineers

Middlesboro, Kentucky 606-248-6600
Greeneville, Tennessee 423-639-0271
Asheville, North Carolina 828-253-2796

Copyright © 1994 Vaughn & Melton, Inc.
All Rights Reserved

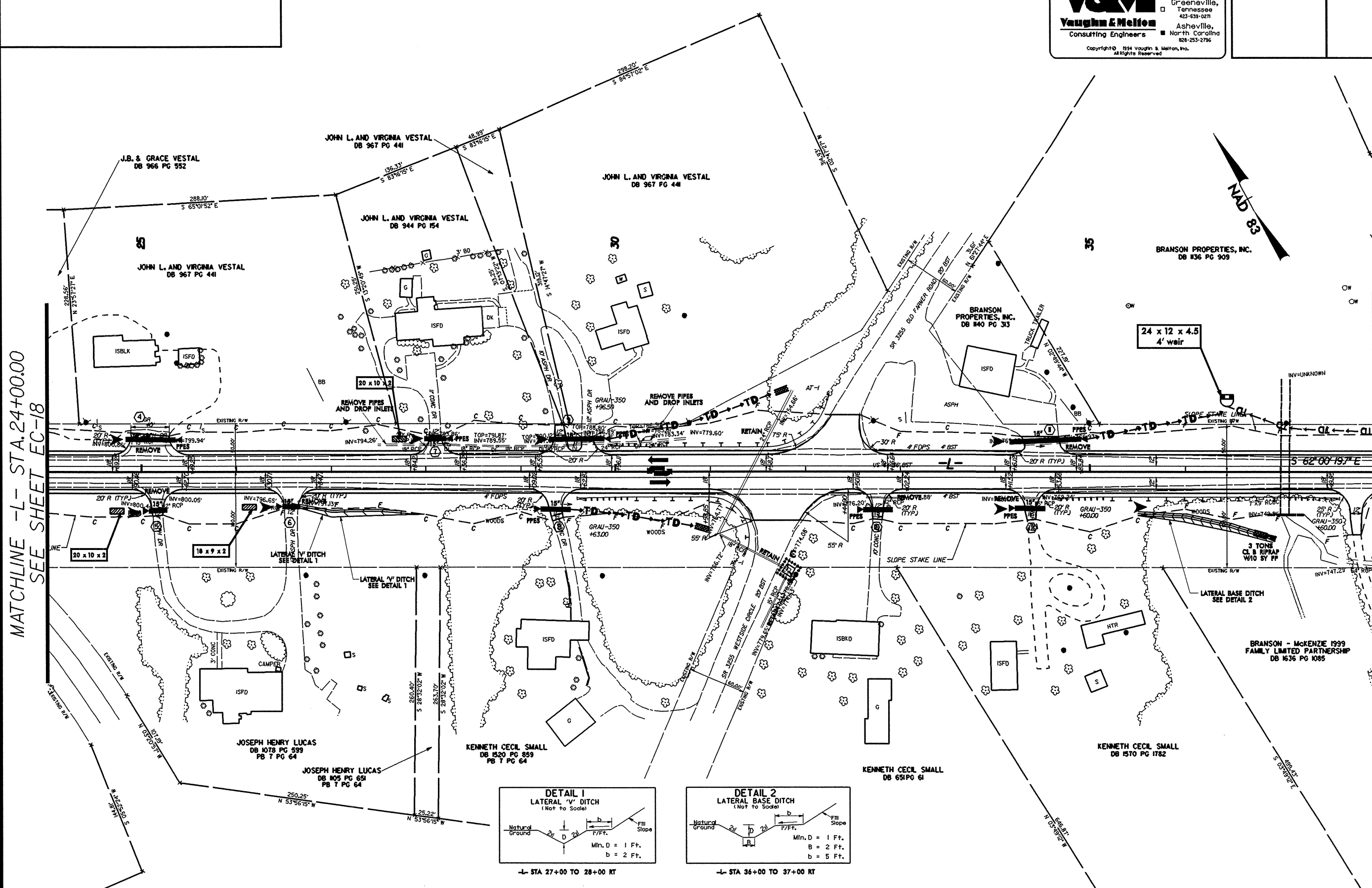

MATCHLINE -L- STA. 24+00.00
SEE SHEET EC-18

MATCHLINE -L- STA. 38+00.00
SEE SHEET EC-20

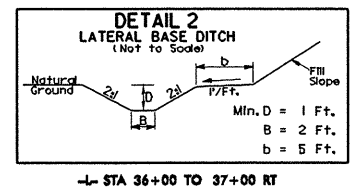
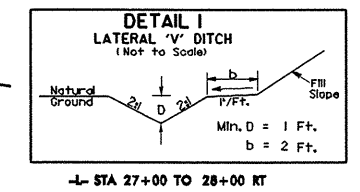
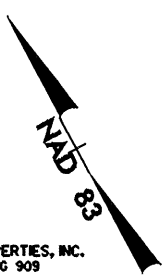

SYSTEMS TIME *****

