

PHASE TWO

PROJ. REFERENCE NO. B-3445	SHEET NO. TCP-4
-------------------------------	--------------------

FOR TEMPORARY SHORING, THE FOLLOWING SOIL PARAMETERS SHALL BE USED:
 FRICTION ANGLE, $\phi = 30$ degrees
 COHESION, $C = 0$ degrees
 UNIT WEIGHT OF SOIL, $\gamma = 120$ PCF ABOVE WTR
 UNIT WEIGHT OF SOIL, $\gamma = 60$ PCF BELOW WTR

STEP 1

- USING TEMPORARY LANE CLOSURES AND ROADWAY STANDARD DRAWING 1101.02, SHEET 1 OF 7, INSTALL TEMPORARY PAVEMENT MARKINGS AT THE FOLLOWING LOCATIONS:
 -L- STA. 17+85 +/- TO -L- STA. 30+50 +/-
- INSTALL PORTABLE CONCRETE BARRIER WHICH CAN BE PLACED AWAY FROM TRAFFIC. (SEE GENERAL NOTE Z, TCP-2)
- REMOVE CONFLICTING PAVEMENT MARKINGS AND SHIFT TRAFFIC INTO TEMPORARY TRAFFIC PATTERN OF ONE-LANE, TWO-WAY TRAFFIC. COMPLETE PLACEMENT OF PORTABLE CONCRETE BARRIER.

STEP 2

REMOVE THE SOUTH HALF OF EXISTING BRIDGE AT -L- STA. 23+67 +/- TO -L- STA. 24+63 +/- OVER COREYS DITCH

STEP 3

- CONSTRUCT THE SOUTHERN HALF OF PROPOSED BRIDGE OVER COREYS DITCH FROM -L- STA. 23+28 +/- TO -L- STA. 25+08 +/-
- CONSTRUCT ROADWAY, PAVED SHOULDER, GUARDRAIL AND PARKING AREA UP TO BUT NOT INCLUDING THE FINAL LAYER OF SURFACE COURSE, OF PROPOSED NC 615 (-L-) AS SHOWN BELOW.

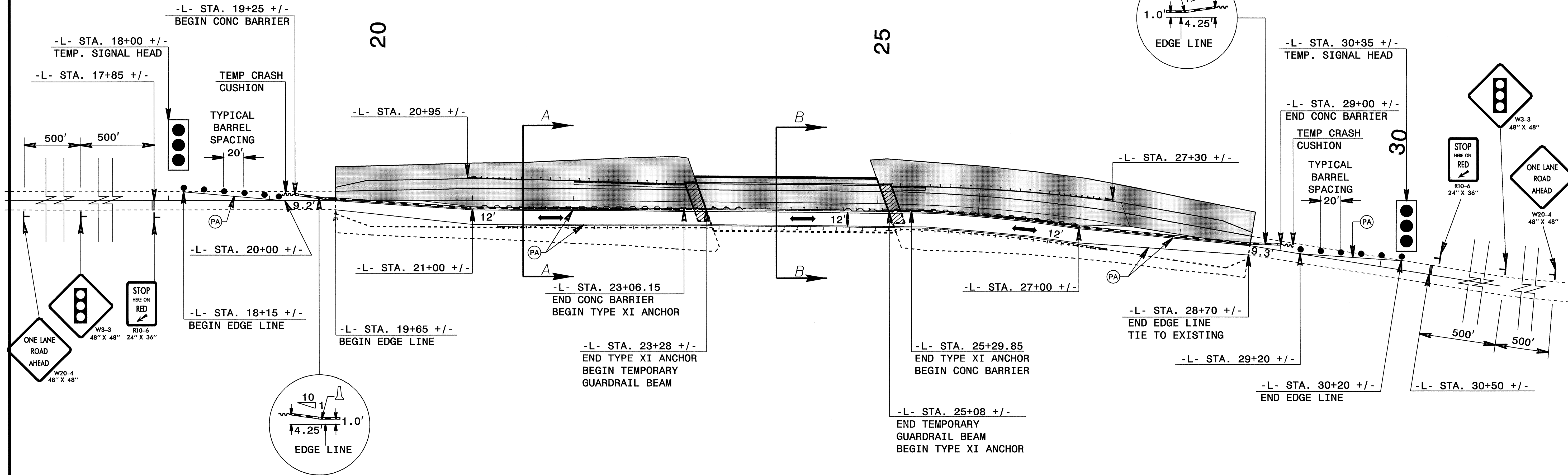

SECTION A-A
-L- STA. 21+50

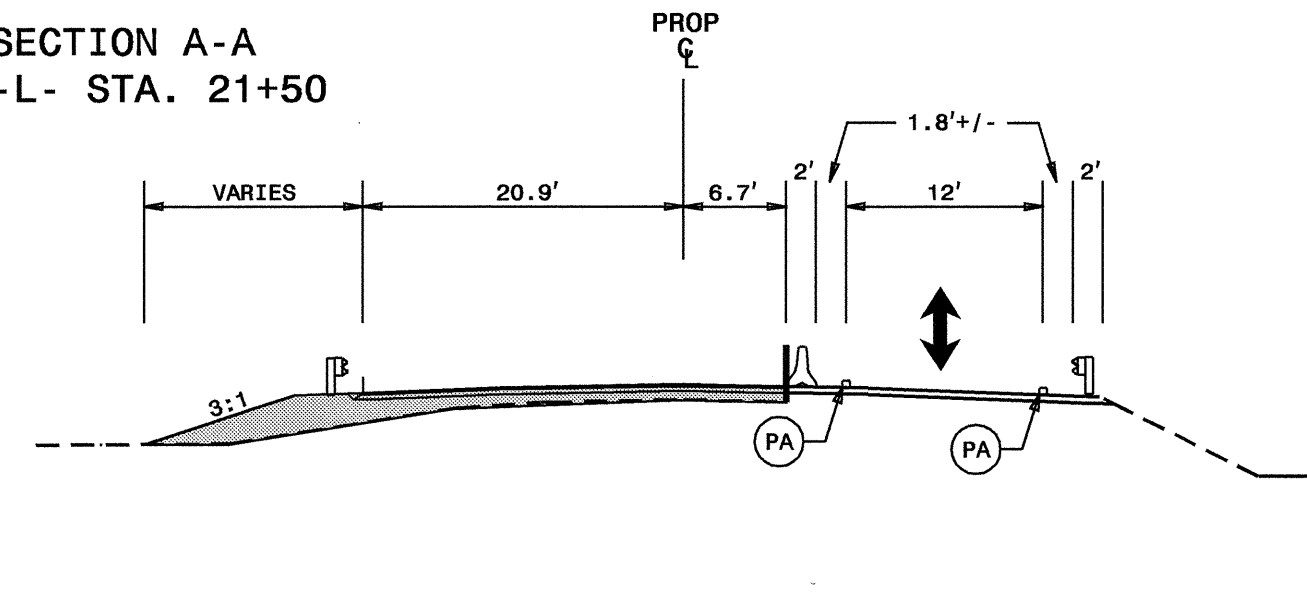

SECTION B-B
-L- STA. 24+00

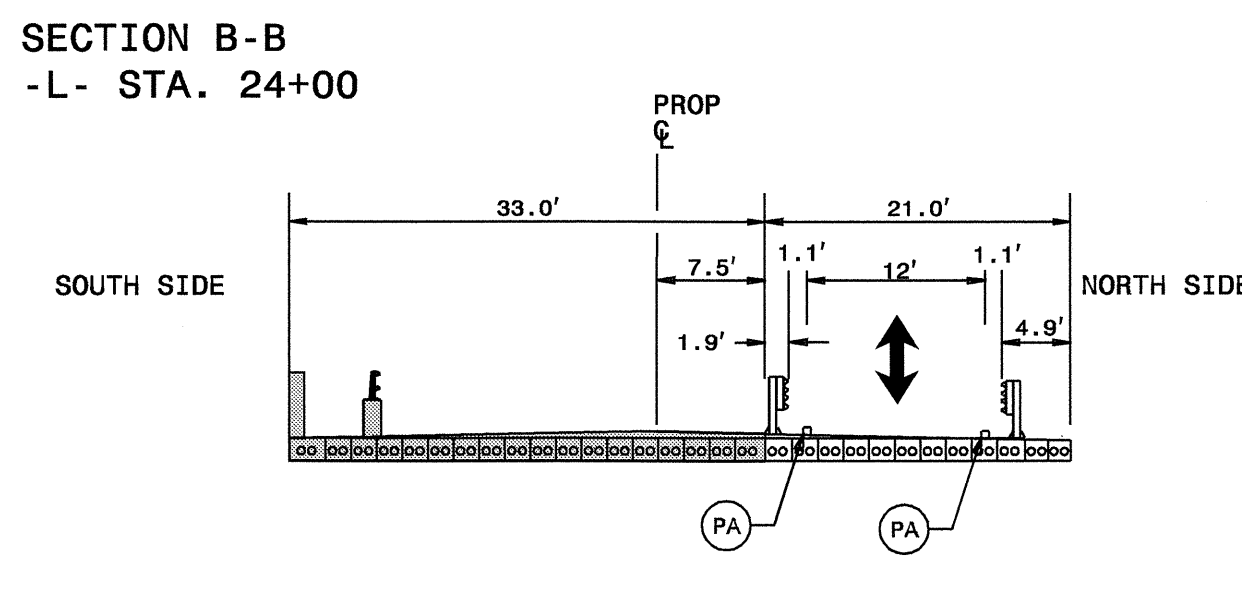

06 JAN 2006 16:50 \\c:\ls-ccf\303\303445\tr\afficoctrl\top\final_wz\top\plans\b3445\top4.dgn

APPROVED: <i>Jessica D. Kuss</i> DATE: 1/26/06	PHASE TWO								
	SCALE: N.A.								
	DATE: 1/05/06		<table border="1"> <thead> <tr> <th colspan="2">REVISIONS</th> </tr> </thead> <tbody> <tr> <td> </td> <td> </td> </tr> <tr> <td> </td> <td> </td> </tr> </tbody> </table>	REVISIONS					
	REVISIONS								
DESIGN BY: RMG	<table border="1"> <tr> <td>CADD FILE</td> </tr> </table>	CADD FILE							
CADD FILE									
REVIEWED BY: JDK									