

ELEVATION
PP 18 X 0.50 STEEL PILE
 (OPEN END)

NOTES

STEEL PIPE PILES SHALL BE OF UNIFORM DIAMETER AND MEET THE REQUIREMENTS OF ASTM A252, GRADE 3 MODIFIED (50,000 PSI YIELD STRENGTH).

GALVANIZE STEEL PIPE PILES IN ACCORDANCE WITH SECTION 1076 OF THE STANDARD SPECIFICATIONS UNLESS METALLIZING IS REQUIRED. GALVANIZING OR METALLIZING PIPE PILE PLATES IS NOT REQUIRED.

REMOVE AND REPLACE OR REPAIR TO THE SATISFACTION OF THE ENGINEER PILES THAT ARE DAMAGED, DEFORMED OR COLLAPSED DURING INSTALLATION OR DRIVING.

PILE SPLICES SHALL BE IN ACCORDANCE WITH THE STANDARD SPECIFICATIONS AND AWS D1.1.

FOR OPEN END PIPE PILES, REMOVE ENOUGH SOIL AND WATER FROM INSIDE THE PILES TO CONSTRUCT THE CONCRETE PLUG WITHOUT FOULING THE CONCRETE.

FORM THE CONCRETE PLUG SUCH THAT THE REINFORCING STEEL OR CONCRETE DOES NOT MOVE AND THE CLEARANCE FROM THE REINFORCING STEEL TO THE INSIDE OF THE PILE IS MAINTAINED AFTER CONCRETE PLACEMENT. DO NOT PLACE CONCRETE IN THE BENT CAP UNTIL THE CONCRETE PLUG HAS ATTAINED A MINIMUM COMPRESSIVE STRENGTH OF 1500 PSI.

THE REINFORCING STEEL, CLASS A CONCRETE, AND THE PIPE PILE PLATES, IF REQUIRED, ARE CONSIDERED INCIDENTAL TO THE CONTRACT UNIT PRICE BID PER LINEAR FOOT FOR PP 18 X 0.50 STEEL PILES.

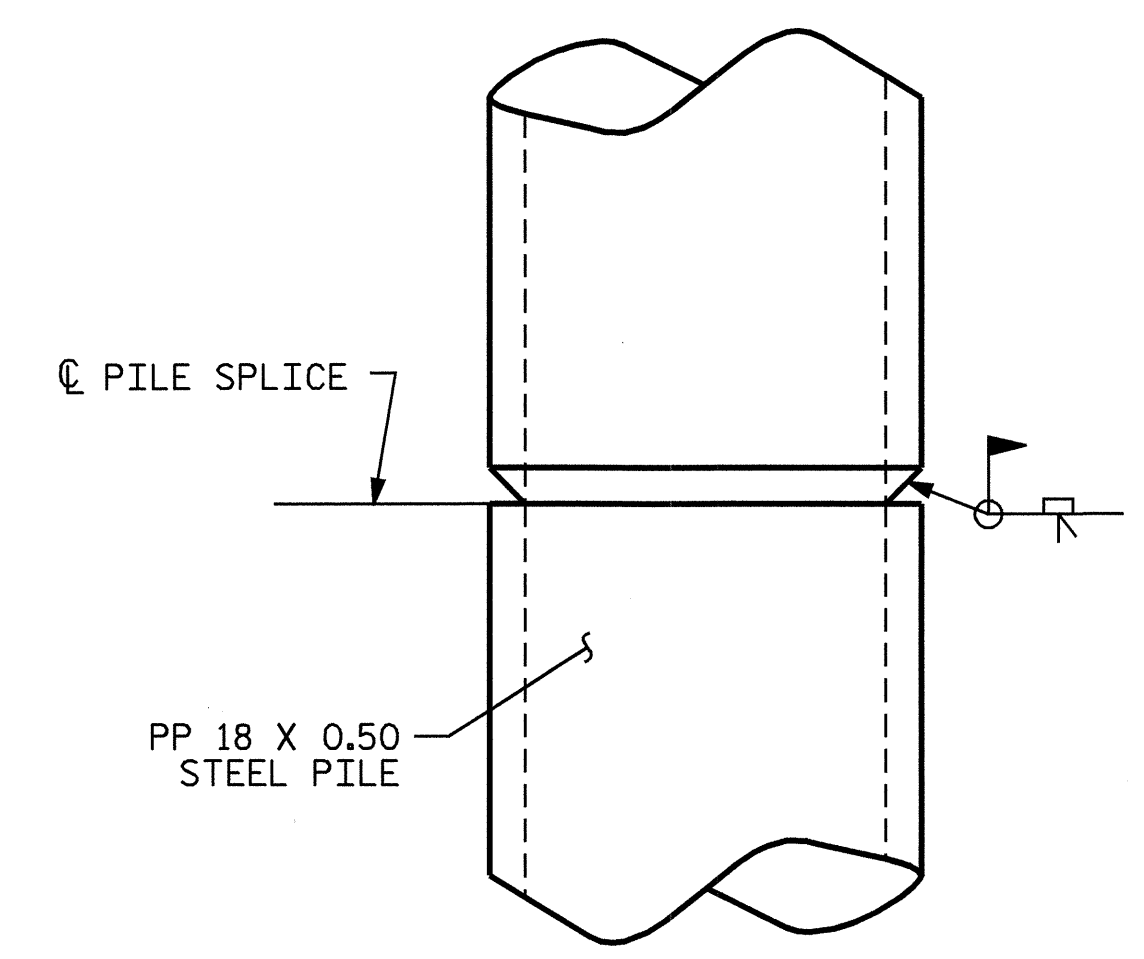

PIPE PILE SPLICE DETAIL

BILL OF MATERIAL FOR ONE PP 18 X 0.50 STEEL PILE

BAR	NO.	SIZE	TYPE	LENGTH	WEIGHT
S4	6	#4	3	4'-5"	18
V1	8	#5	6	6'-8"	56
REINFORCING STEEL =				74	lbs

CLASS A CONCRETE
 5'-0" MINIMUM PLUG 0.3 CY

BAR TYPES

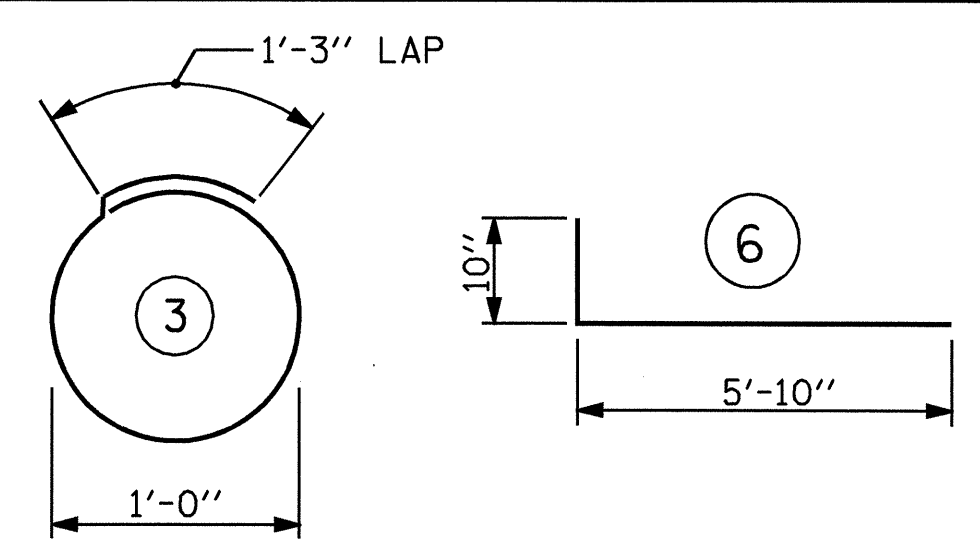

ALL BAR DIMENSIONS ARE OUT TO OUT.

PROJECT NO. B-3639
EDGEcombe COUNTY
 STATION: 17+59.40 -L-

SHEET 3 OF 3

STATE OF NORTH CAROLINA DEPARTMENT OF TRANSPORTATION RALEIGH					
STANDARD 18" STEEL PIPE PILE					
REVISIONS					
NO.	BY:	DATE:	NO.	BY:	DATE:
1			3		
2			4		

SHEET NO.	5-14
TOTAL SHEETS	20

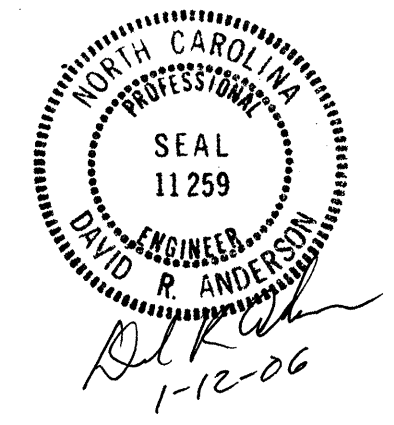

ASSEMBLED BY : W.K. FISCHER/MAA	DATE : 5/24/05
CHECKED BY : S.M. RASHIDI	DATE : 11/14/05
DRAWN BY : RWW	1/01
CHECKED BY : LES	1/01
REV. 7/10/01	RWW/LES
REV. 5/7/03	RWW/JTE
REV. 10/1/05	LBG/TLA