

PLAN OF INTERIOR CORED SLAB UNIT - SPAN C

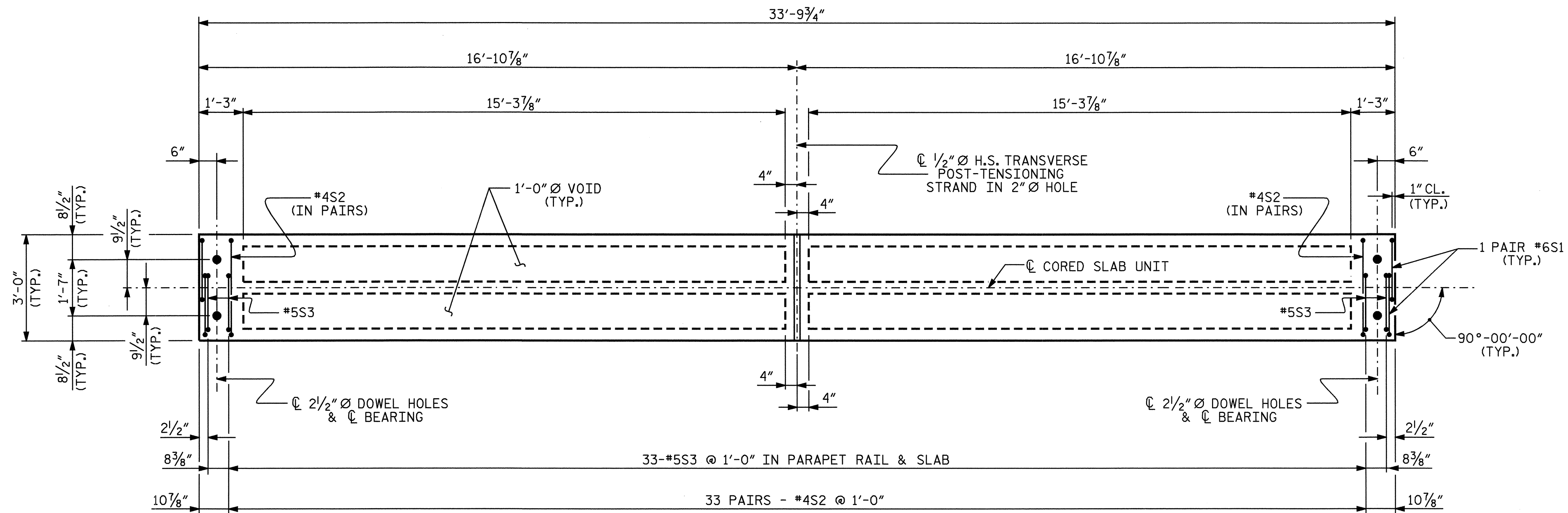

PLAN OF EXTERIOR CORED SLAB UNIT - SPAN C

PROJECT NO. B-4224
PENDER/DUPLIN COUNTY
 STATION: 17+62.50 -L-

SHEET 7 OF 8

STATE OF NORTH CAROLINA
 DEPARTMENT OF TRANSPORTATION
 RALEIGH

SUPERSTRUCTURE
 PLAN OF SPAN C
 CORED SLAB DETAILS

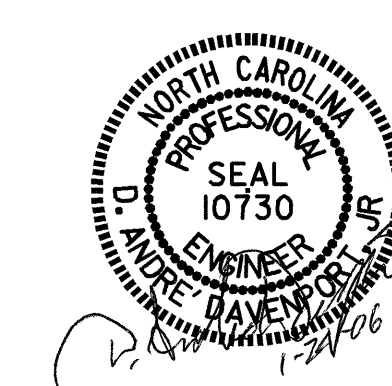

DRAWN BY : S. P. LAM DATE : 2/18/05
 CHECKED BY : A. SORSENGINH DATE : 9/05

23-JAN-2006 07:09
 R:\STRUCT\21slam\Microstation\Superstructure\B-4224_PS.dgn
 ddavenport

REVISIONS						SHEET NO.
NO.	BY:	DATE:	NO.	BY:	DATE:	S-10
1			3			TOTAL SHEETS
2			4			28