

STATE OF NORTH CAROLINA
DIVISION OF HIGHWAYS

WAKE COUNTY

LOCATION: BRIDGE NO. 133 ON SR 1930 STADIUM DRIVE
OVER RICHLAND CREEK

TYPE OF WORK: GRADING, PAVING, DRAINAGE, STRUCTURE,
AND GUARDRAIL

STATE	STATE PROJECT REFERENCE NO.	SHEET NO.	TOTAL SHEETS
N.C.	MA05001B	1	
STATE PROJ. NO.	F.A. PROJ. NO.	DESCRIPTION	

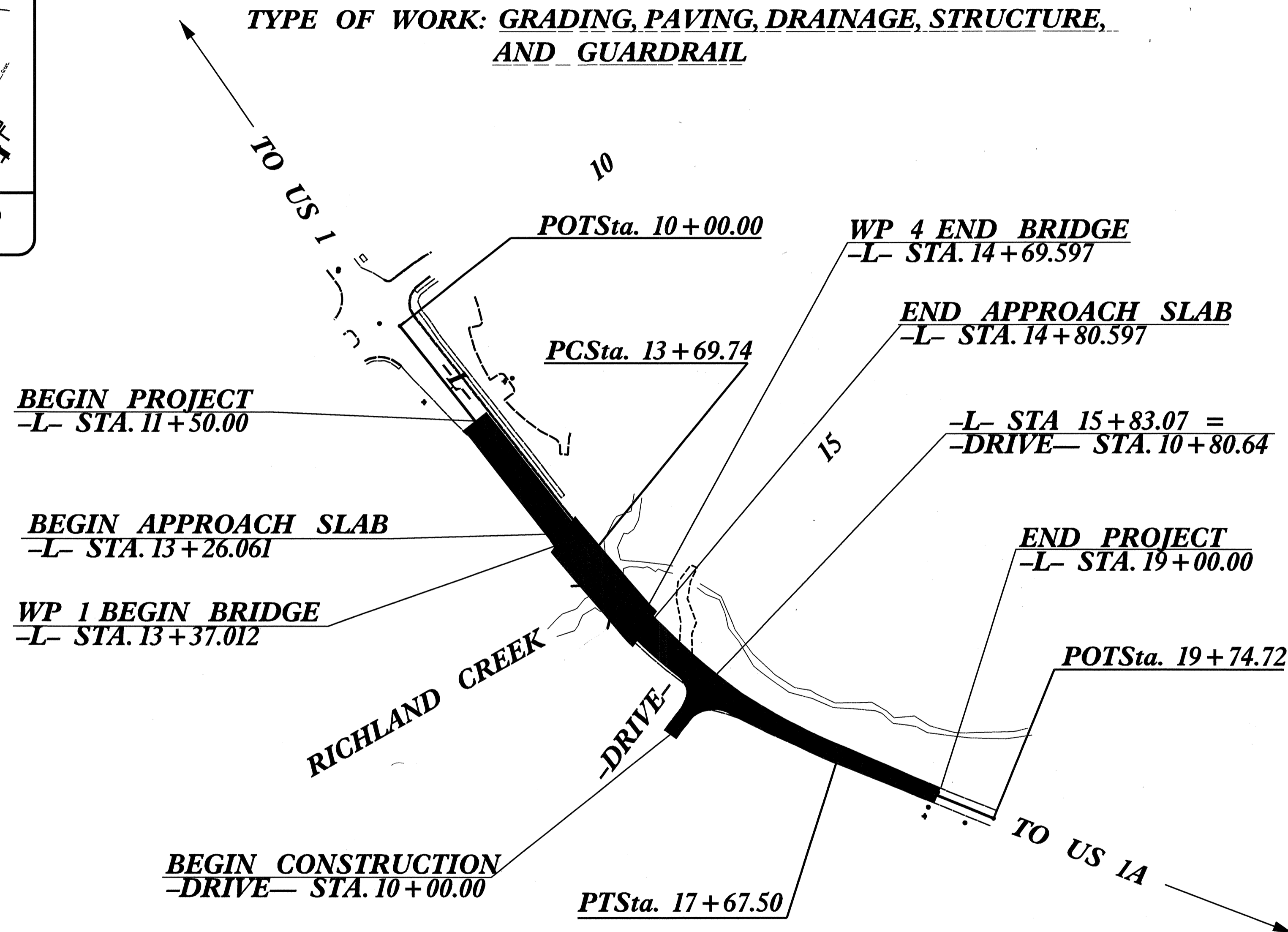
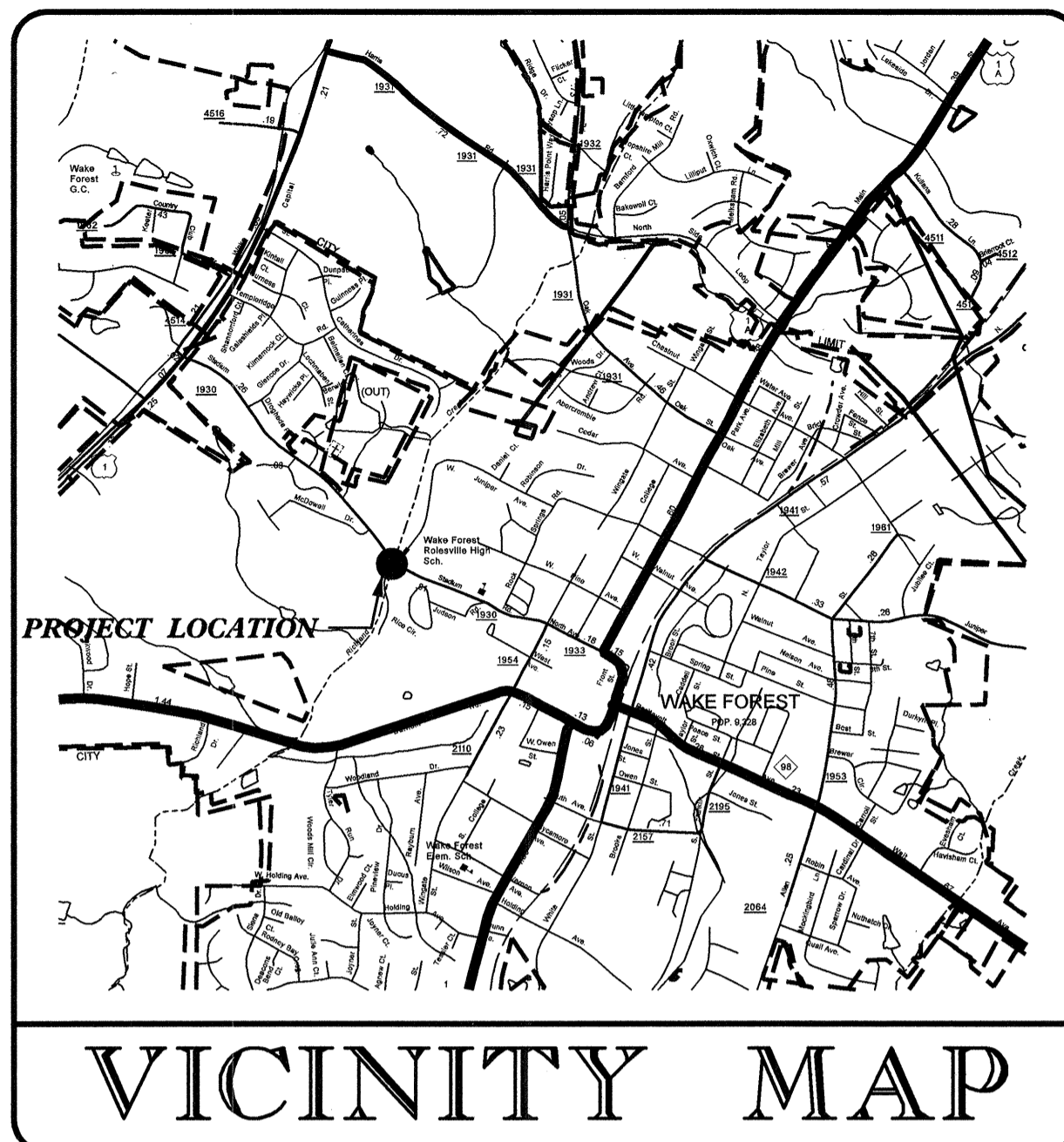

PROJECT: MA05001B

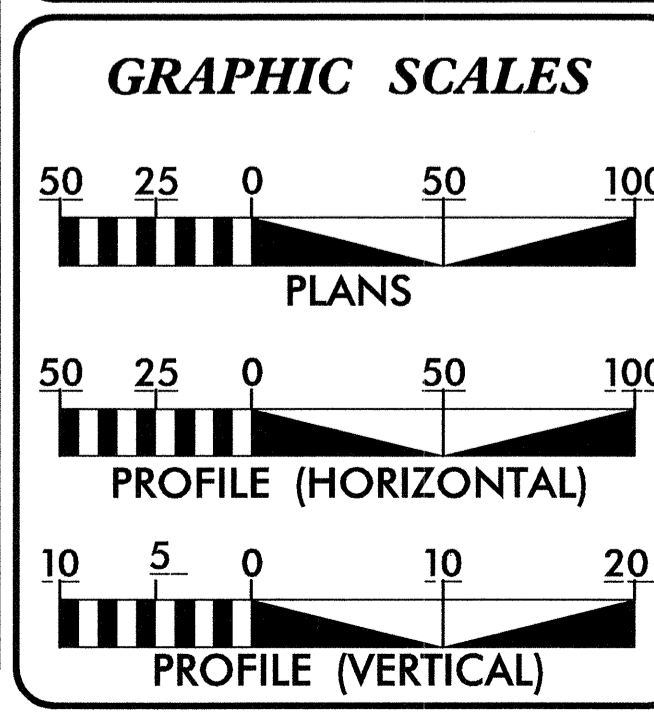

DESIGN DATA

ADT 2005 = 8650

ADT 2025 = 18850

T = 7 %

PROJECT LENGTH

LENGTH ROADWAY PROJECT	=	0.117 MILE
LENGTH STRUCTURES	=	0.025 MILE
TOTAL LENGTH STATE PROJECT	=	0.142 MILE

Prepared for the North Carolina Department Of Transportation In the Office of:

WETHERILL ENGINEERING
559 Jones Franklin Rd. Suite 164
Raleigh, N.C. 27606
Bus: 919 851 8077
Fax: 919 851 8107

TRANSPORTATION PLANNING/DESIGN
BRIDGE/STRUCTURE DESIGN
CIVIL/SITE DESIGN - GIS/GPS -
CONSTRUCTION OBSERVATION

2002 STANDARD SPECIFICATIONS

RIGHT OF WAY DATE: *Greg B. Shelton*
PROJECT ENGINEER

LETTING DATE: February 21, 2006
John A. Dilworth
PROJECT DESIGN ENGINEER

HYDRAULICS ENGINEER

Henry Wells, Jr.
11/1/06
SIGNATURE: P.E.

ROADWAY DESIGN ENGINEER

Greg B. Shelton
12/21/05
SIGNATURE: P.E.

**DIVISION OF HIGHWAYS
STATE OF NORTH CAROLINA**

STATE DESIGN ENGINEER P.E.

DEPARTMENT OF TRANSPORTATION
FEDERAL HIGHWAY ADMINISTRATION

APPROVED DIVISION ADMINISTRATOR DATE