

- Note:
- \*See RSD No. 1101.11 for L and Barrier Flare Rate
  - \*\*Remove/fill rumble strip, remove existing edgeline and place proposed removable tape.
  - For signs and locations, see TCP-11.

# PORTABLE CONCRETE BARRIER DETAIL

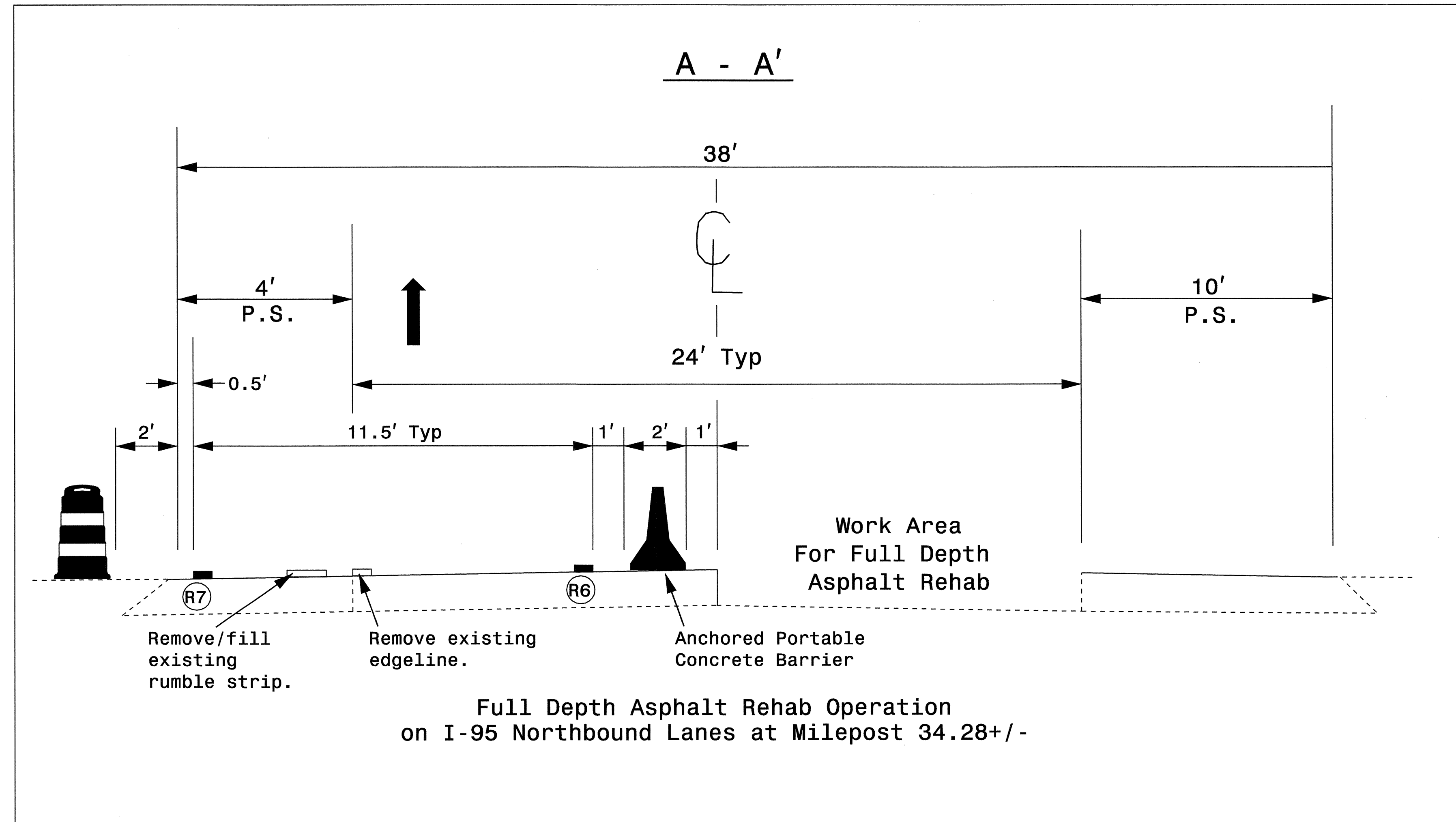
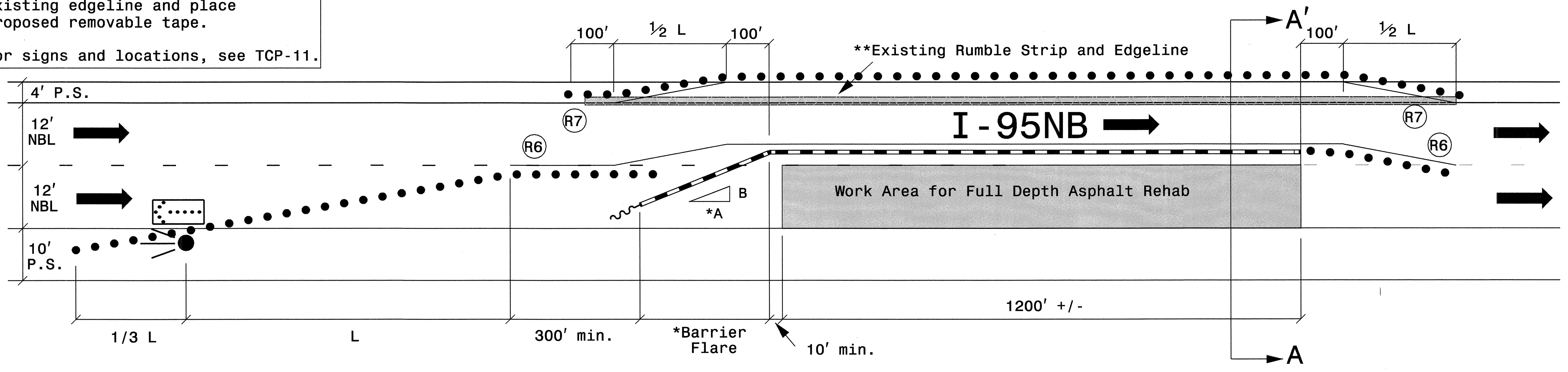

Full Depth Asphalt Rehab Operation on I-95 Northbound Lanes at Milepost 34.28 +/-

APPROVED:	DATE: 11/15/05	PORTABLE CONCRETE BARRIER DETAIL	
SEAL	SCALE: NONE		
	DATE: 11-15-05		REVISIONS
	DESIGN BY: PS		
	REVIEWED BY: MMM		

15-NOV-2005 10:27  
 \\efs-cc\fs03\147118\TrafficControl\Top\14711\_fc\_top12\_pcb.dgn  
 pseymore AT WZT0206427