

UTILITIES BY OTHERS

NOTE:
ALL PROPOSED UTILITY WORK SHOWN ON THIS SHEET WILL BE DONE BY OTHERS

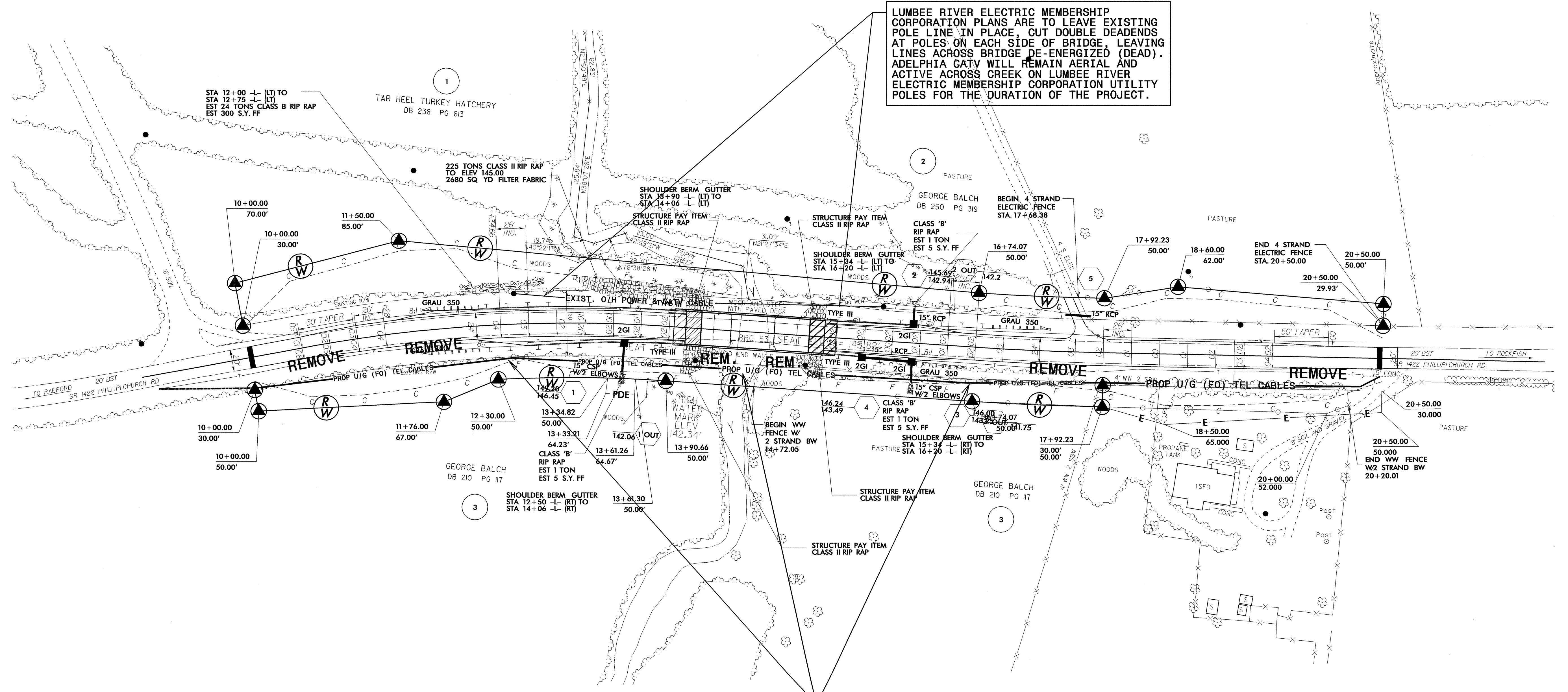

LUMBEE RIVER ELECTRIC MEMBERSHIP CORPORATION PLANS ARE TO LEAVE EXISTING POLE LINE IN PLACE, CUT DOUBLE DEADENDS AT POLES ON EACH SIDE OF BRIDGE, LEAVING LINES ACROSS BRIDGE DE-ENERGIZED (DEAD). ADELPHIA CATV WILL REMAIN AERIAL AND ACTIVE ACROSS CREEK ON LUMBEE RIVER ELECTRIC MEMBERSHIP CORPORATION UTILITY POLES FOR THE DURATION OF THE PROJECT.

SPRINT TELEPHONE SHALL DIRECTIONAL BORE THE ENTIRE LENGTH OF THE PROJECT AND MAINTAIN 15 FT. BELOW CUT AND CREEK

SE = 04 SE = 03
RO = 104' RO = 78'

5/14/99
SYSTEMS ENGINEERING
PLANNING & DESIGN
INCORPORATED
1422 PHILLIPS CHURCH RD
ROCKFISH, VA 22851
TEL: 540-883-8800
FAX: 540-883-8801
WWW: WWW.SPEDESIGN.COM