

**PHASING DIAGRAM**

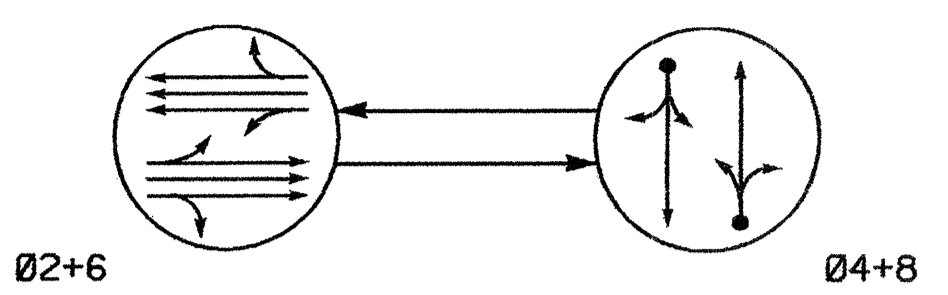

**PHASING DIAGRAM DETECTION LEGEND**

- ←● DETECTED MOVEMENT
- ← UNDETECTED MOVEMENT (OVERLAP)
- UNSIGNALIZED MOVEMENT
- ←--- PEDESTRIAN MOVEMENT

**TABLE OF OPERATION**

SIGNAL FACE	PHASE		
	02+6	04+8	FLIGHT
21, 22	G	R	Y
41, 42	R	G	R
61, 62	G	R	Y
81, 82	R	G	R

**SIGNAL FACE I.D.**

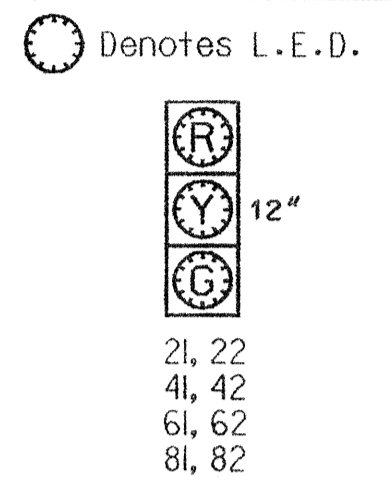

**2070L LOOP & DETECTOR INSTALLATION**

LOOP	SIZE (FT)	DISTANCE FROM STOPBAR (FT)	TURNS	NEW LOOP	DETECTOR PROGRAMMING				STRETCH TIME	DELAY TIME	SYSTEM LOOP	NEW CARD
					PHASE	CALLING	EXTENSION	PULL TIME DELAY				
4A	6X40	+5	2-4-2	-	4	Y	Y	-	-	10	-	Y
8A	6X40	+5	2-4-2	-	8	Y	Y	-	-	10	-	Y

**NOTES**

- Refer to "Roadway Standard Drawings NCDOT" dated January 2002 and "Standard Specifications for Roads and Structures" dated January 2002.
- Do not program signal for late night flashing operation unless otherwise directed by the Engineer.
- Set all detector units to presence mode.
- Locate new cabinet so as not to obstruct sight distance of vehicles turning right on red.
- Pavement markings are existing.
- Maximum times shown in timing chart are for free-run operation only. Coordinated signal system timing values supersede these values.
- City system data:  
Controller Asset #: 0045.

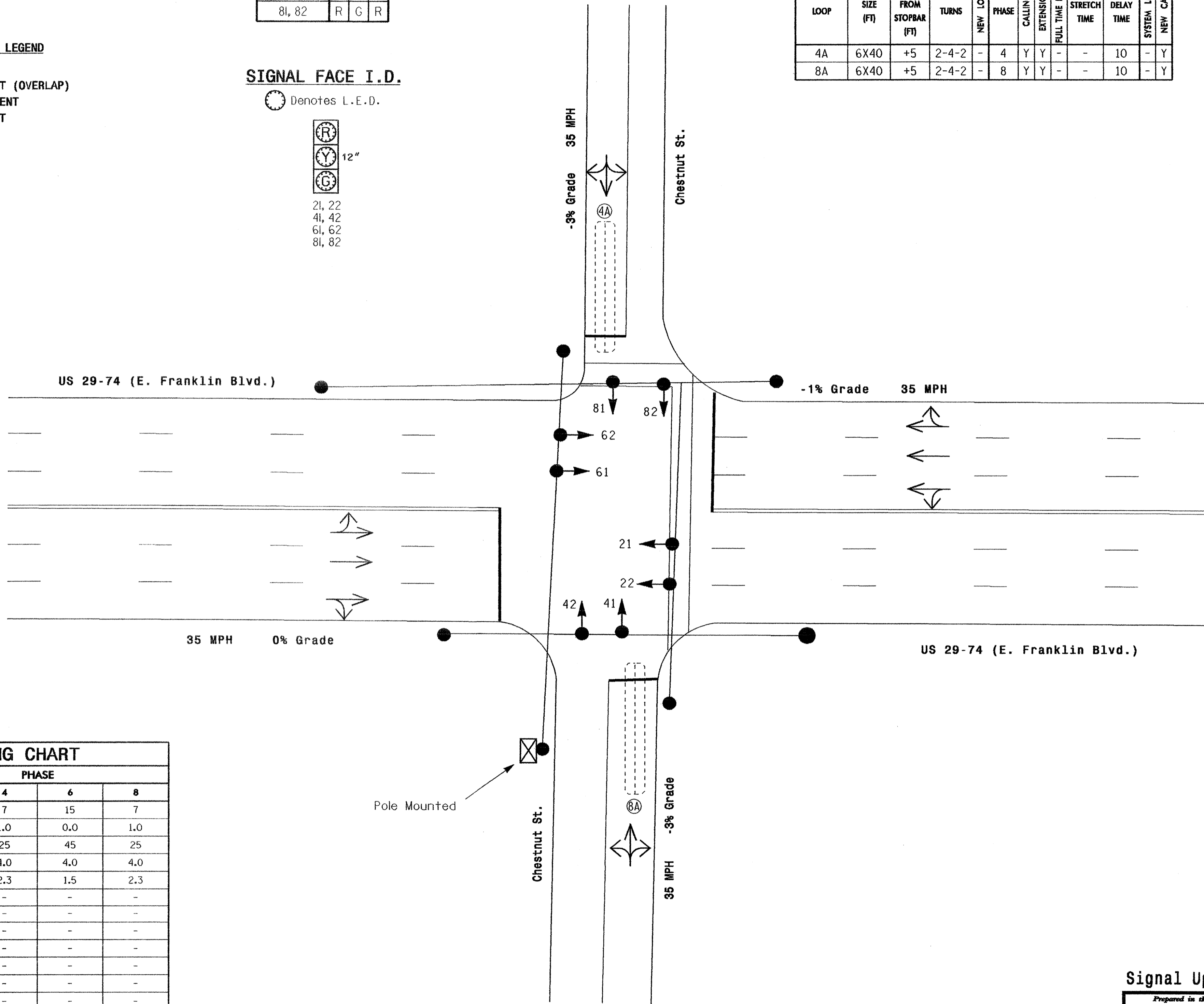

**2070L TIMING CHART**

FEATURE	PHASE			
	2	4	6	8
Min Green 1 *	15	7	15	7
Extension 1 *	0.0	1.0	0.0	1.0
Max Green 1 *	45	25	45	25
Yellow Clearance	4.0	4.0	4.0	4.0
Red Clearance	1.5	2.3	1.5	2.3
Walk 1 *	-	-	-	-
Don't Walk 1	-	-	-	-
Seconds Per Actuation *	-	-	-	-
Max Variable Initial *	-	-	-	-
Time Before Reduction *	-	-	-	-
Time To Reduce *	-	-	-	-
Minimum Gap	-	-	-	-
Recall Mode	MAX RECALL	-	MAX RECALL	-
Vehicle Call Memory	-	-	-	-
Dual Entry	-	ON	-	ON
Simultaneous Gap	ON	ON	ON	ON

\* These values may be field adjusted. Do not adjust Min Green and Extension times for phases 2 and 6 lower than what is shown. Min Green for all other phases should not be lower than 4 seconds.

**LEGEND**

PROPOSED	EXISTING
○ → Traffic Signal Head	● → N/A
● → Modified Signal Head	○ → N/A
⊥ Sign	⊥ Sign
⊥ Pedestrian Signal Head With Push Button & Sign	⊥ Sign
⊥ Signal Pole with Guy	⊥ Sign
⊥ Signal Pole with Sidewalk Guy	⊥ Sign
⊥ Inductive Loop Detector	⊥ Sign
⊥ Controller & Cabinet	⊥ Sign
⊥ Junction Box	⊥ Sign
⊥ 2-in Underground Conduit	⊥ Sign
→ N/A Right of Way	→ Right of Way
→ Directional Arrow	→ Directional Arrow
→ Pavement Marking Arrow	→ Pavement Marking Arrow

**Signal Upgrade**

Prepared in the Offices of:  
**US 29-74 (E. Franklin Boulevard) at Chestnut Street**  
 Division 12 Gaston County  
 PLAN DATE: January 2005 REVIEWED BY: D.Y. Ishak  
 PREPARED BY: L. Blount REVIEWED BY:  
 SCALE: 1"=20'  
 SIGNATURE: [Signature] DATE: 13 January 05  
 SIG. INVENTORY NO. 12-0045

12-may-2005 08:02  
 p:\projects\2005\12-0045\sig.dgn  
 12-0045.dgn