

2 Phase Pre-Timed
Gastonia City System

PHASING DIAGRAM

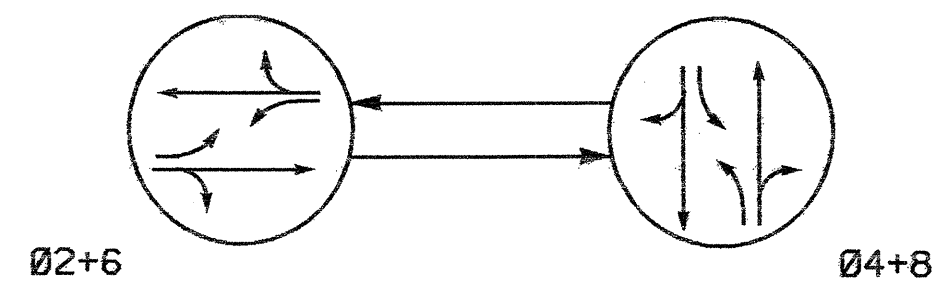

PHASING DIAGRAM DETECTION LEGEND

- ←● DETECTED MOVEMENT
- ← UNDETECTED MOVEMENT (OVERLAP)
- - - UNSIGNALIZED MOVEMENT
- ←- - PEDESTRIAN MOVEMENT

TABLE OF OPERATION

SIGNAL FACE	PHASE		
	Ø2+6	Ø4+8	FLASH
21,22	G	R	Y
41,42	R	G	R
61,62	G	R	Y
81,82	R	G	R

SIGNAL FACE I.D.

● Denotes L.E.D.

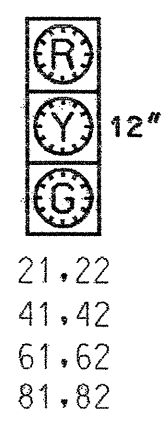

NOTES

1. Refer to "Roadway Standard Drawings NCDOT" dated January 2002 and "Standard Specifications for Roads and Structures" dated January 2002.
2. Do not program signal for late night flashing operation unless otherwise directed by the Engineer.
3. Pavement markings are existing.
4. Maximum times shown in timing chart are for free-run operation only. Coordinated signal system timing values supersede these values.
5. Locate new cabinet so as not to obstruct sight distance of vehicles turning right on red.
6. City loop system data: Controller Asset # 5005.

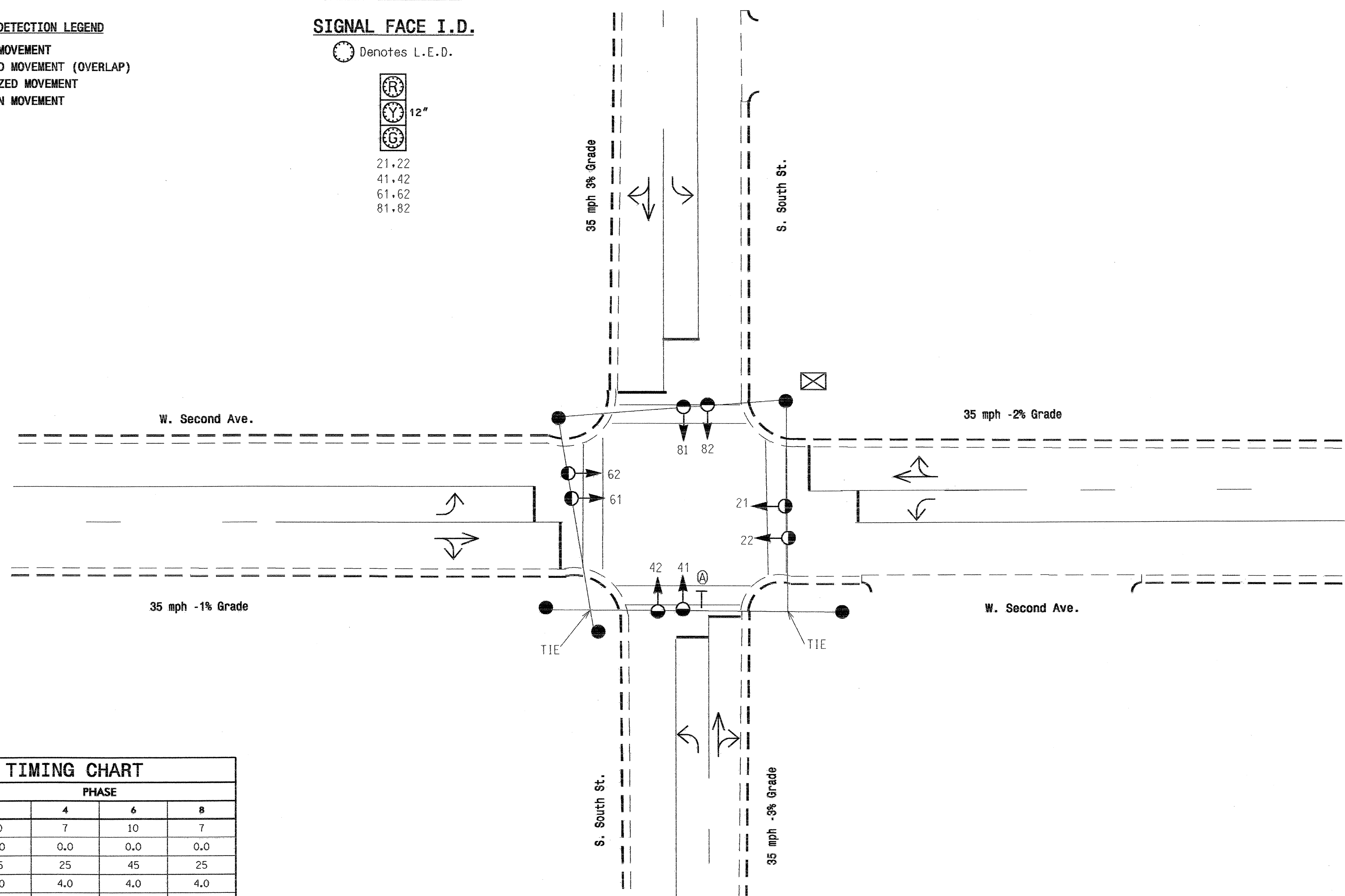

PROPOSED	EXISTING
○	○
○→	N/A
⊥	⊥
⊥	⊥
○	○
⊥	⊥
⊠	⊠
⊠	⊠
- - -	- - -
N/A	- - -
→	→
→	→
ⓐ	ⓐ

FEATURE	2070L TIMING CHART			
	PHASE			
	2	4	6	8
Min Green 1*	10	7	10	7
Extension 1*	0.0	0.0	0.0	0.0
Max Green 1*	45	25	45	25
Yellow Clearance	4.0	4.0	4.0	4.0
Red Clearance	1.7	1.7	1.7	1.7
Walk 1*	-	-	-	-
Don't Walk 1	-	-	-	-
Seconds Per Actuation*	-	-	-	-
Max Variable Initial*	-	-	-	-
Time Before Reduction*	-	-	-	-
Time To Reduce*	-	-	-	-
Minimum Gap	-	-	-	-
Recall Mode	MAX RECALL	MAX RECALL	MAX RECALL	MAX RECALL
Vehicle Call Memory	-	-	-	-
Dual Entry	-	-	-	-
Simultaneous Gap	ON	ON	ON	ON

* These values may be field adjusted. Do not adjust Min Green and Extension times for phases 2 and 6 lower than what is shown. Min Green for all other phases should not be lower than 4 seconds.

Signal Upgrade

	<p>W. Second Ave. at S. South St.</p> <p>Division 12 Gaston County</p> <p>PLAN DATE: February 2005 REVIEWED BY: D. Y. Ishak</p> <p>PREPARED BY: K. Maldonado REVIEWED BY:</p>	<p>SEAL</p>
		<p>SIGNATURE _____ DATE _____</p>
<p>1"=20'</p> <p>SIG. INVENTORY NO. City-03</p>		

16-MAY-2005 11:12
 w:\p\cd\18-un\14\wkg\groups\ip_proj\ct\18-un\14\wkg\2505.s1\g_dsn_20050222.dgn
 18/05/05