

12-SEP-2005 14:07 I:\projects\Special Details\ericward\stds\02\stds to Special Details\english\84806\084806.dgn
 ericward 11/25/05 11:52:23

STATE OF NORTH CAROLINA
 DEPT. OF TRANSPORTATION
 DIVISION OF HIGHWAYS
 RALEIGH, N.C.

ENGLISH DETAIL DRAWING FOR
WHEELCHAIR RAMP AND EXISTING SIDEWALK WITH GRASS STRIP
 CURB CUT

SHEET 1 OF 5
848D06

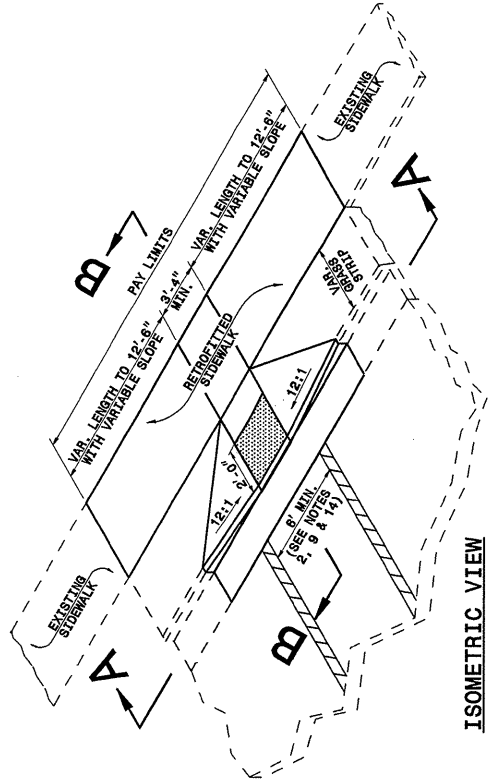

NOTES:
 1. DETECTABLE WARNING DOMES SHALL COVER 2'-0" LENGTH AND FULL WIDTH OF THE RAMP FLOOR AS SHOWN ON THE DETAILS.
 2. OBTAIN 70% CONTRAST VISIBILITY WITH ADJOINING SURFACE, EITHER LIGHT-ON-DARK, OR DARK-ON-LIGHT SEQUENCE COVERING THE ENTIRE RAMP.

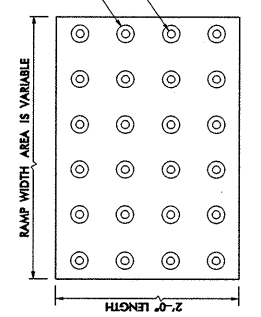

DETECTABLE WARNING DOMES

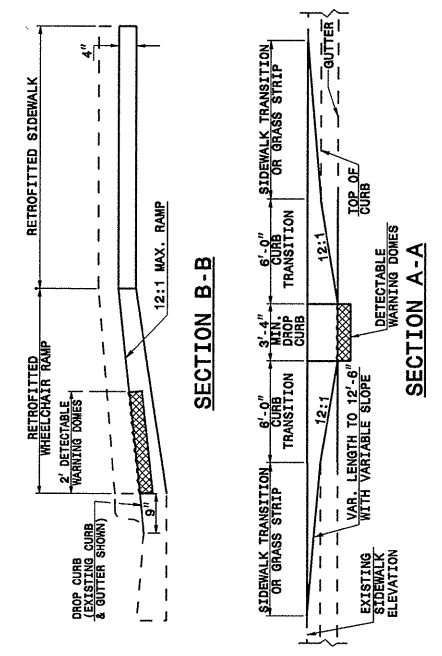

SECTION B-B

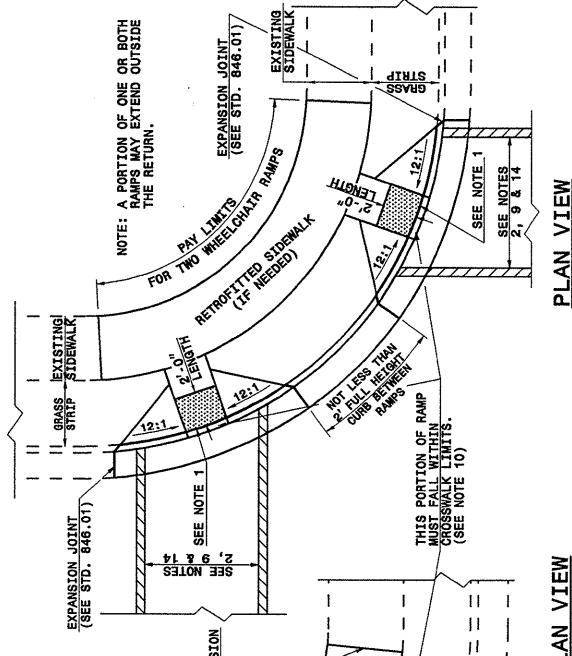

SECTION A-A

ENGLISH DETAIL DRAWING FOR
WHEELCHAIR RAMP AND EXISTING SIDEWALK WITH GRASS STRIP
 CURB CUT

SHEET 1 OF 5
848D06

STATE OF NORTH CAROLINA
 DEPT. OF TRANSPORTATION
 DIVISION OF HIGHWAYS
 RALEIGH, N.C.

STATE OF NORTH CAROLINA
 DEPT. OF TRANSPORTATION
 DIVISION OF HIGHWAYS
 RALEIGH, N.C.

ENGLISH DETAIL DRAWING FOR
WHEELCHAIR RAMP AND EXISTING SIDEWALK ADJACENT TO CURB
 CURB CUT

SHEET 2 OF 5
848D06

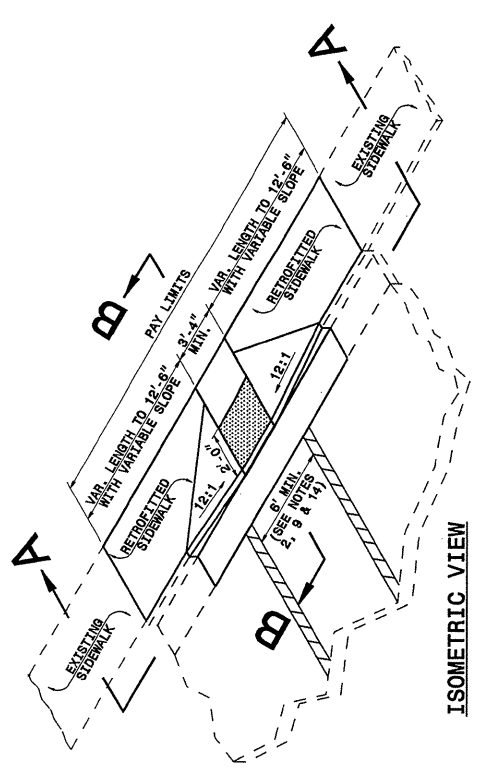

NOTES:
 1. DETECTABLE WARNING DOMES SHALL COVER 2'-0" LENGTH AND FULL WIDTH OF THE RAMP FLOOR AS SHOWN ON THE DETAILS.
 2. OBTAIN 70% CONTRAST VISIBILITY WITH ADJOINING SURFACE, EITHER LIGHT-ON-DARK, OR DARK-ON-LIGHT SEQUENCE COVERING THE ENTIRE RAMP.

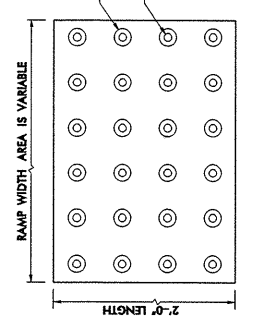

DETECTABLE WARNING DOMES

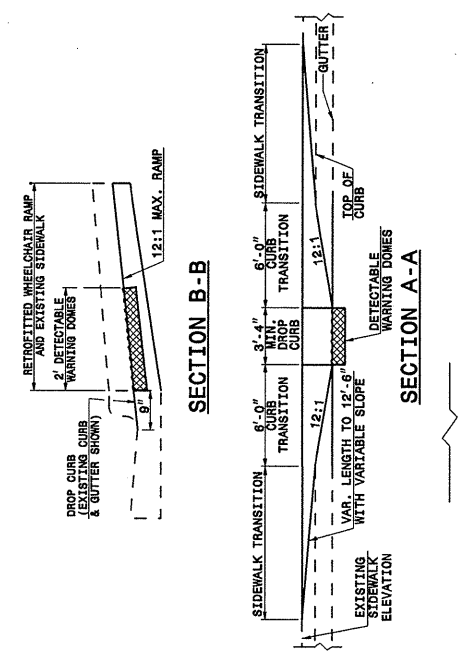

SECTION B-B

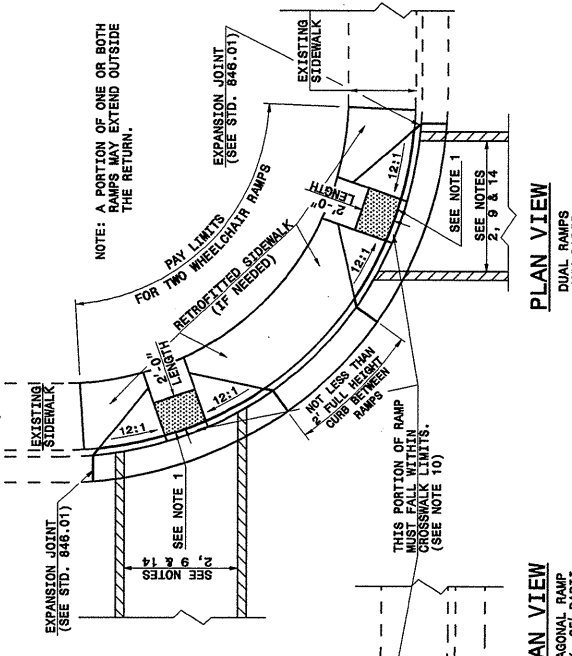

SECTION A-A

ENGLISH DETAIL DRAWING FOR
WHEELCHAIR RAMP AND EXISTING SIDEWALK ADJACENT TO CURB
 CURB CUT

SHEET 2 OF 5
848D06

STATE OF NORTH CAROLINA
 DEPT. OF TRANSPORTATION
 DIVISION OF HIGHWAYS
 RALEIGH, N.C.

PROJECT SERVICES UNIT
 STANDARDS AND SPECIAL DESIGN
 Office 919-250-4128 FAX 919-250-4119

SEE PLATE FOR TITLE

ORIGINAL BY: DETAIL 848D05 DATE:
 MODIFIED BY: E.E. WARD DATE: 09-06-05
 CHECKED BY: DATE:
 FILE SPEC.: /usr/stds/02todetail/english/84806/848d06.dgn