

PAY ITEM	SYMBOL	DESCRIPTION
PAVEMENT MARKING LEGEND		
PAVEMENT MARKING LINES		
THERMOPLASTIC (4", 90 mils)	TA	WHITE EDGELINE
THERMOPLASTIC (4", 120 mils)	TC	10 ft. WHITE SKIP
	TD	2 ft. WHITE MINISKIP
	TE	WHITE SOLID LANE LINE
	TF	10 ft. YELLOW SKIP
	TH	YELLOW SINGLE CENTER LINE
	TI	YELLOW DOUBLE CENTER LINE
THERMOPLASTIC (8", 90 mils)	TT	YELLOW DIAGONAL
THERMOPLASTIC (8", 120 mils)	TV	WHITE CROSSWALK LINE
THERMOPLASTIC (24", 120mils)	T3	WHITE STOP BAR
	T4	WHITE CROSSWALK LINE
PAVEMENT MARKING SYMBOLS		
THERMOPLASTIC SYMBOL (90 mils)	UA	LEFT TURN ARROW
	UB	RIGHT TURN ARROW
	UC	STRAIGHT ARROW
	UG	COMBINATION LEFT, RIGHT & STRAIGHT ARROW
THERMOPLASTIC CHARACTER (120mils)	UI	ALPHANUMERIC CHARACTER

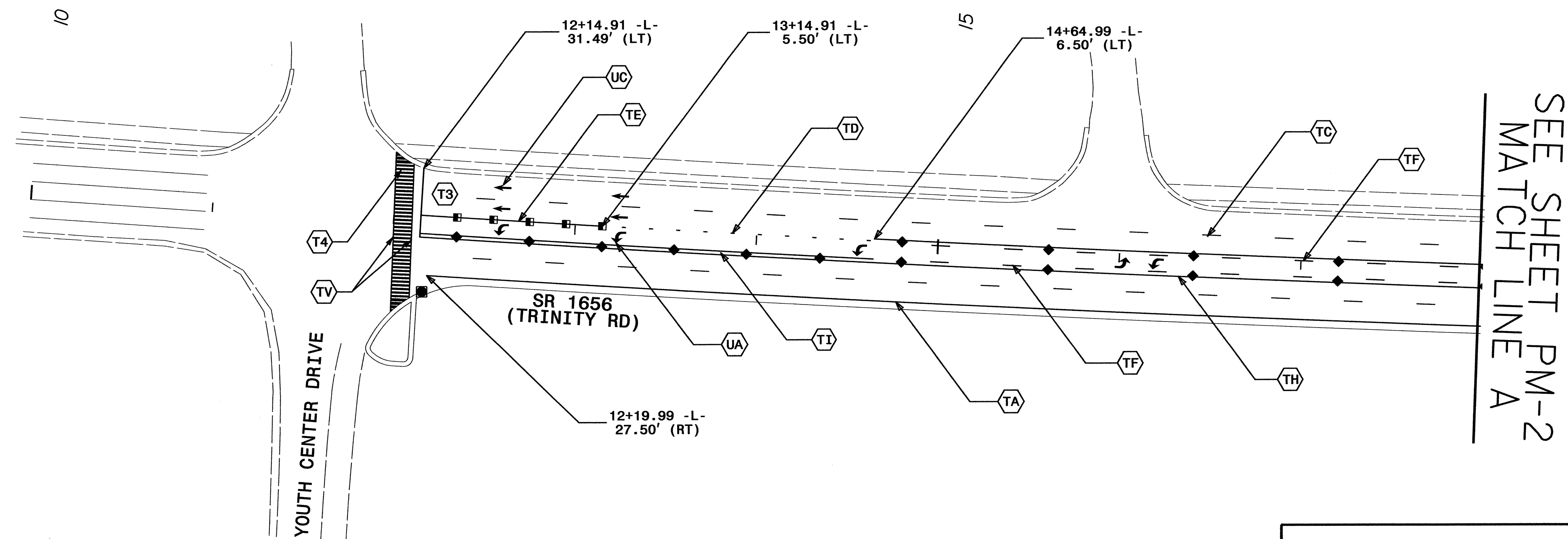

WIDEN FOR TURN LANES AT SR 1656 (TRINITY ROAD) AND SR 1664 (BLUE RIDGE ROAD)		
DIVISION 05	WAKE COUNTY	RALEIGH
REVISIONS	INIT.	DATE
		
N.C. DEPARTMENT of TRANSPORTATION DIVISION of HIGHWAYS DIVISION FIVE DESIGN UNIT		
SCALE:	DATE: 6/03	
PREPARED BY:	M. BRANDON	
REVIEWED BY:	B. UPSHAW	
REVIEWED BY:	B. JONES	

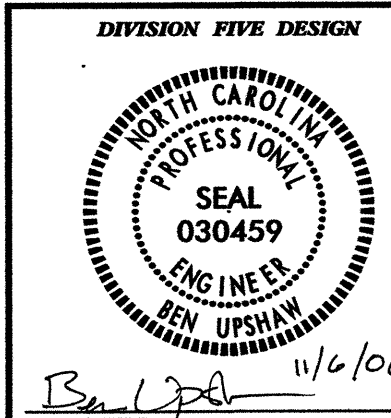

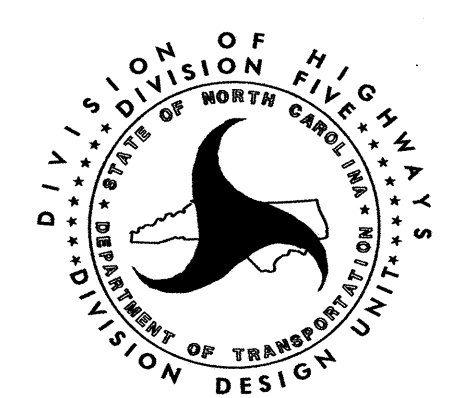
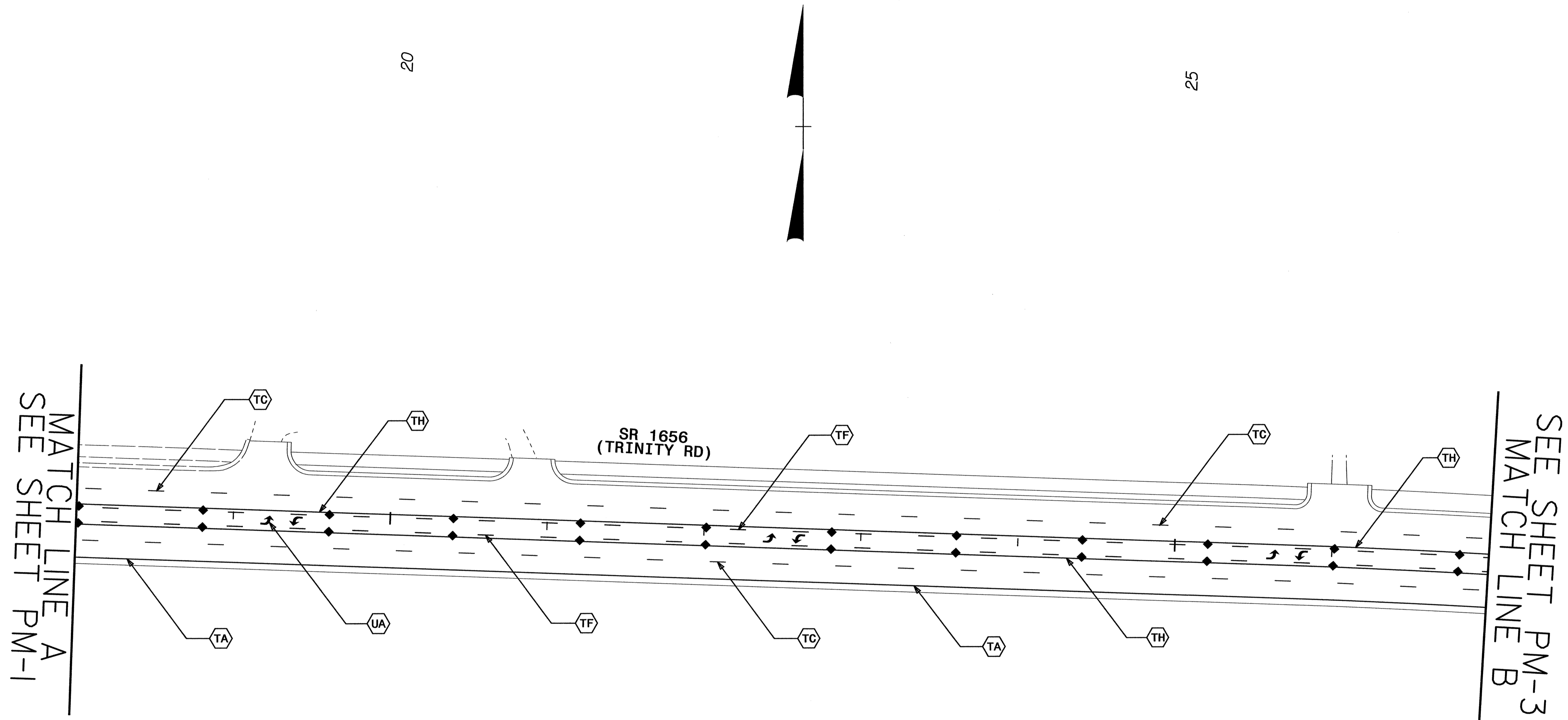

WIDEN FOR TURN LANES AT SR 1656 (TRINITY ROAD) AND SR 1664 (BLUE RIDGE ROAD)		
DIVISION 05	WAKE COUNTY	RALEIGH
REVISIONS	INIT.	DATE

DIVISION OF HIGHWAYS
STATE OF NORTH CAROLINA
DIVISION FIVE DESIGN UNIT

DIVISION FIVE DESIGN

NORTH CAROLINA
PROFESSIONAL
SEAL
030459
ENGINEER
BEN UPSHAW
10/25/06
P.E.

**N.C. DEPARTMENT of TRANSPORTATION
DIVISION of HIGHWAYS
DIVISION FIVE DESIGN UNIT**

SCALE:	DATE: 6/03
PREPARED BY:	M. BRANDON
REVIEWED BY:	B. UPSHAW
REVIEWED BY:	B. JONES

MATCH LINE B
SEE SHEET PM-2

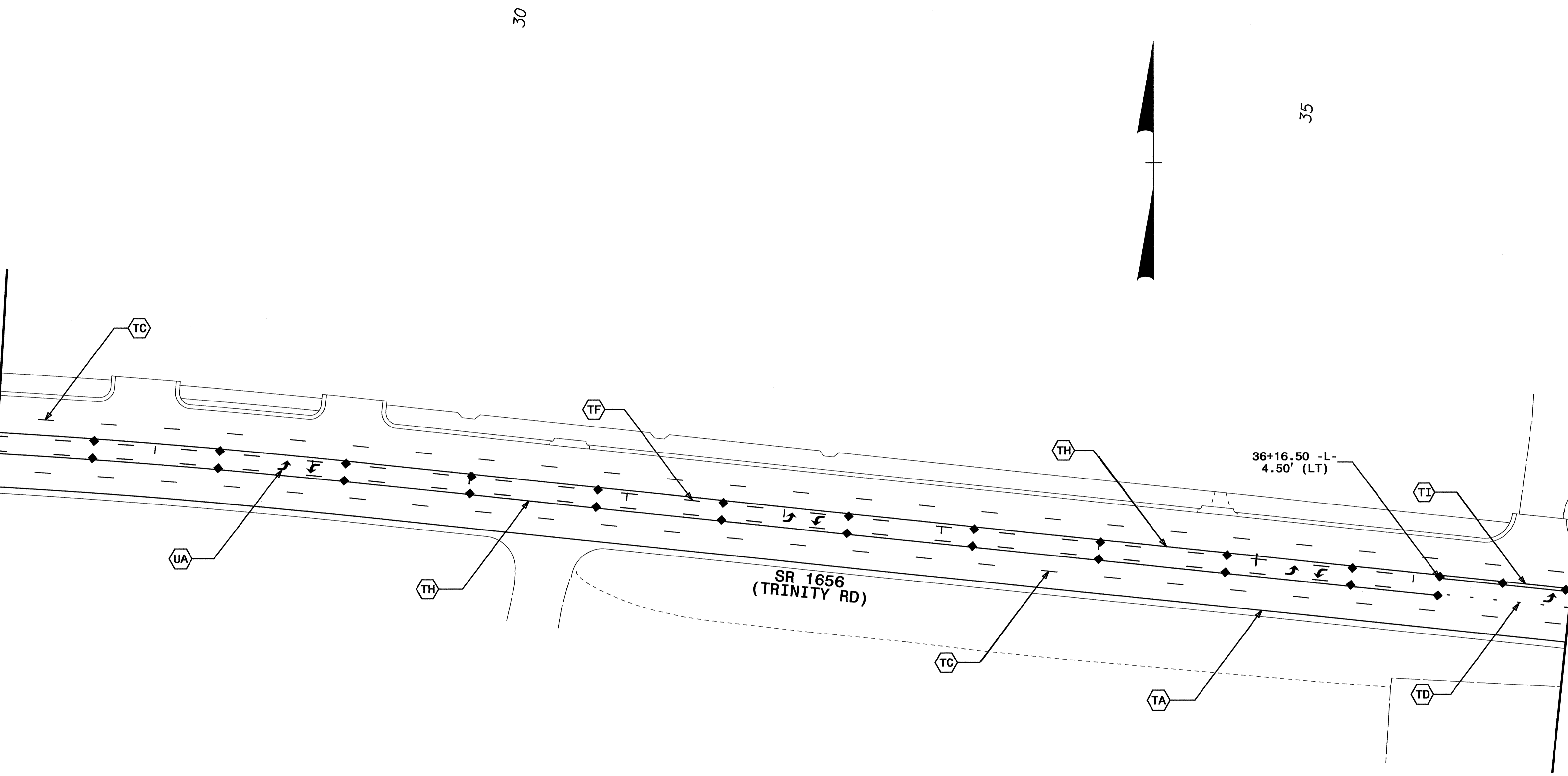

SEE SHEET PM-5
MATCH LINE C

WIDEN FOR TURN LANES AT SR 1656 (TRINITY ROAD) AND SR 1664 (BLUE RIDGE ROAD)		
DIVISION 05	WAKE COUNTY	RALEIGH
REVISIONS	INIT.	DATE

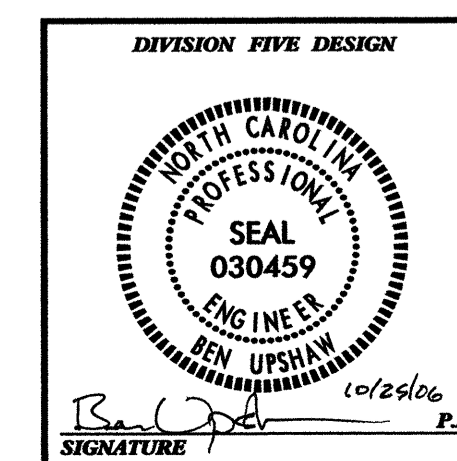
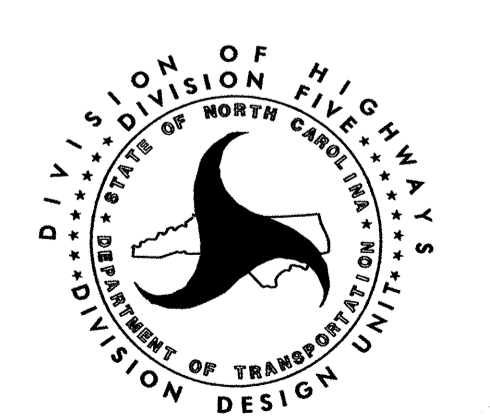

**N.C. DEPARTMENT of TRANSPORTATION
DIVISION of HIGHWAYS
DIVISION FIVE DESIGN UNIT**

SCALE:	DATE: 6/03
PREPARED BY:	M. BRANDON
REVIEWED BY:	B. UPSHAW
REVIEWED BY:	B. JONES

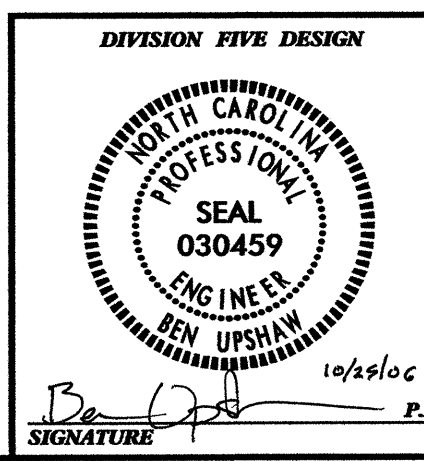
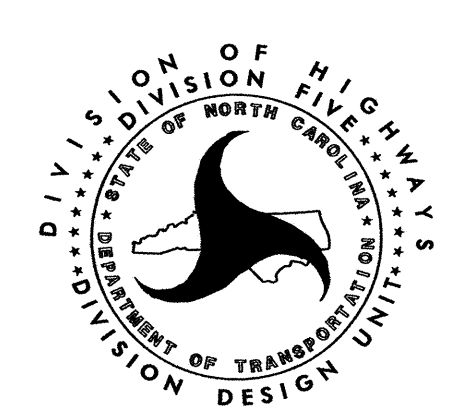
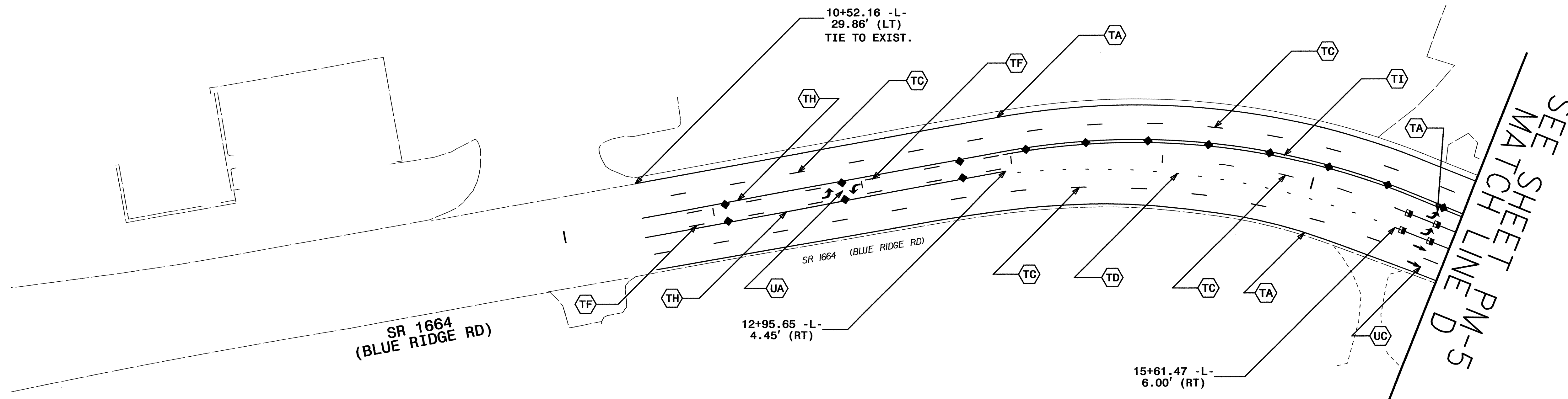
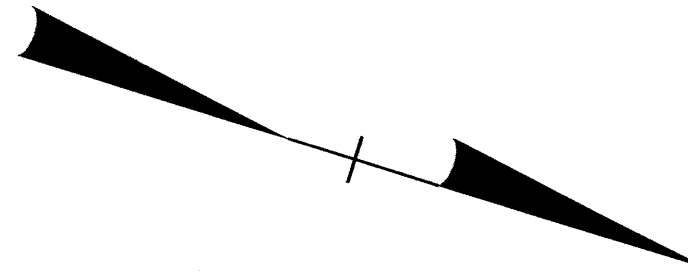

**N.C. DEPARTMENT of TRANSPORTATION
DIVISION of HIGHWAYS
DIVISION FIVE DESIGN UNIT**

SCALE:	DATE: 6/03
PREPARED BY: M. BRANDON	
REVIEWED BY: B. UPSHAW	
REVIEWED BY: B. JONES	

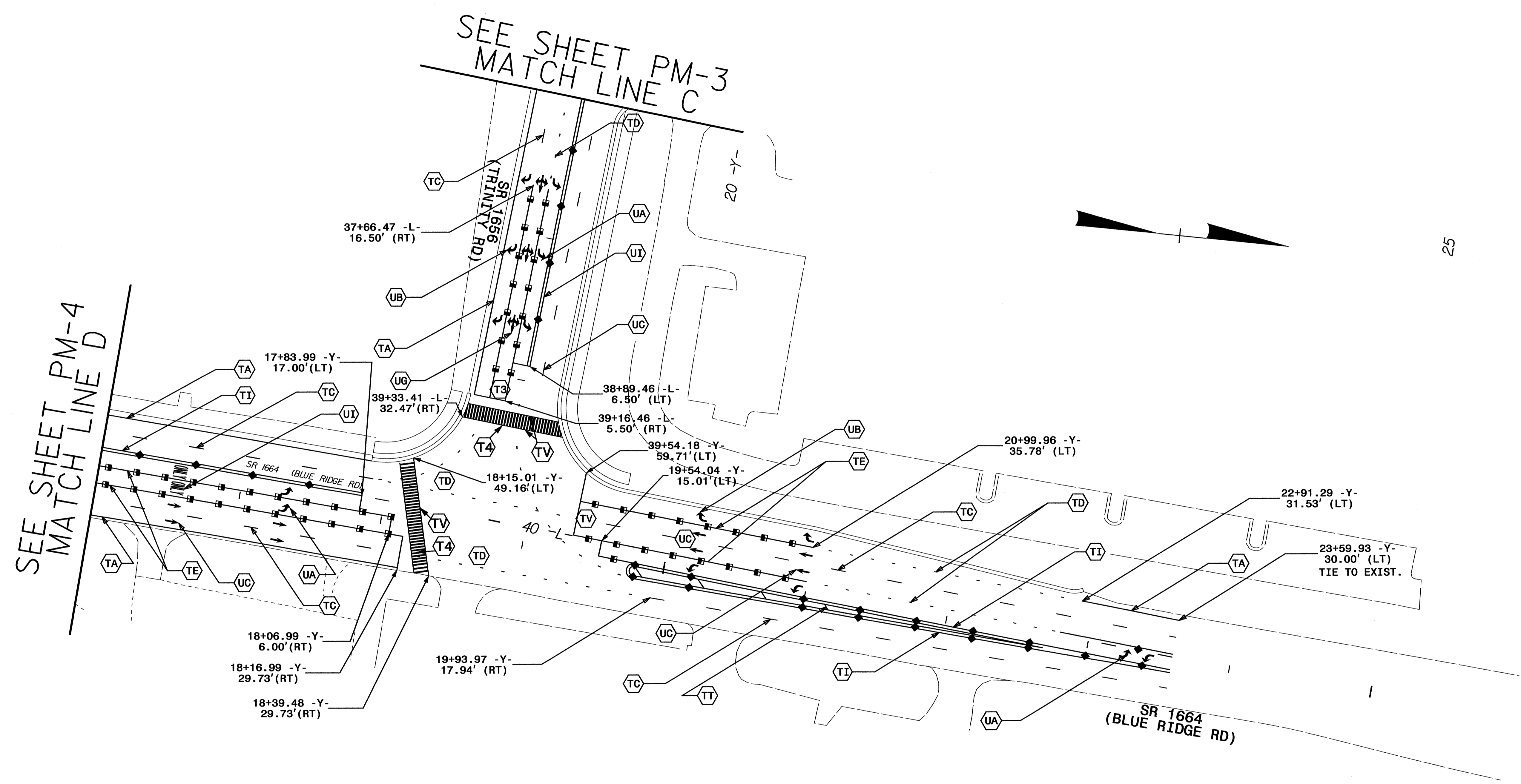

25

**WIDEN FOR TURN LANES AT
SR 1656 (TRINITY ROAD) AND
SR 1664 (BLUE RIDGE ROAD)**

DIVISION 05 WAKE COUNTY RALEIGH

REVISIONS	INT.	DATE

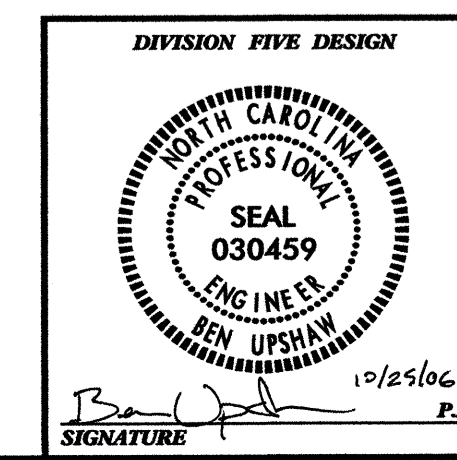
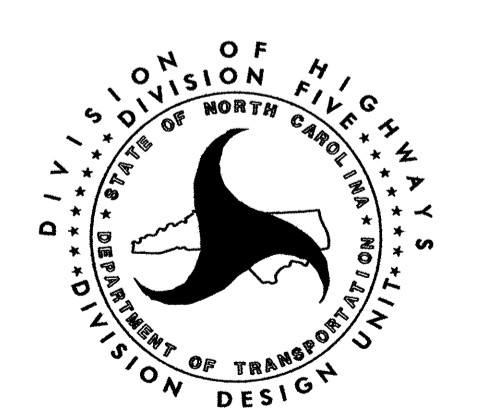

N.C. DEPARTMENT of TRANSPORTATION
DIVISION of HIGHWAYS
DIVISION FIVE DESIGN UNIT

SCALE: DATE: 6/03
PREPARED BY: M. BRANDON
REVIEWED BY: B. UPSHAW
REVIEWED BY: B. JONES