

**PROJECT SPECIAL PROVISION**

(10-18-95)

Z-1

**PERMITS**

The Contractor's attention is directed to the following permits which have been issued to the Department of Transportation by the authority granting the permit.

<b><u>PERMIT</u></b>	<b><u>AUTHORITY GRANTING THE PERMIT</u></b>
Dredge and Fill and/or Work in Navigable Waters (404)	U. S. Army Corps of Engineers
Water Quality (401)	Division of Environmental Management, DENR State of North Carolina

The Contractor shall comply with all applicable permit conditions during construction of this project. Those conditions marked by \* are the responsibility of the department and the Contractor has no responsibility in accomplishing those conditions.

Agents of the permitting authority will periodically inspect the project for adherence to the permits.

The Contractor's attention is also directed to Articles 107-10 and 107-14 of the *Standard Specifications* and the following:

Should the Contractor propose to utilize construction methods (such as temporary structures or fill in waters and/or wetlands for haul roads, work platforms, cofferdams, etc.) not specifically identified in the permit (individual, general, or nationwide) authorizing the project it shall be the Contractor's responsibility to coordinate with the Engineer to determine what, if any, additional permit action is required. The Contractor shall also be responsible for initiating the request for the authorization of such construction method by the permitting agency. The request shall be submitted through the Engineer. The Contractor shall not utilize the construction method until it is approved by the permitting agency. The request normally takes approximately 60 days to process; however, no extensions of time or additional compensation will be granted for delays resulting from the Contractor's request for approval of construction methods not specifically identified in the permit.

**Where construction moratoriums are contained in a permit condition which restricts the Contractor's activities to certain times of the year, those moratoriums will apply only to the portions of the work taking place in the waters or wetlands provided that activities outside those areas is done in such a manner as to not affect the waters or wetlands.**



RECEIVED 44

AUG 14 2006

DIVISION ENGINEER TENTH DIVISION

Const. \_\_\_\_\_ Maint. \_\_\_\_\_

Oper. \_\_\_\_\_ Plan. \_\_\_\_\_

Michael F. Easley, Governor  
William G. Ross Jr., Secretary  
North Carolina Department of Environment and Natural Resources

Alan W. Klimek, P.E. Director  
Division of Water Quality

August 11, 2006  
DWQ# 06-1142  
Union County

Mr. Barry Moose, P.E.  
NCDOT Division 10  
716 West Main Street  
Albemarle, NC 28001

**APPROVAL of 401 Water Quality Certification with Additional Conditions**

Dear Mr. Moose:

You have our approval, in accordance with the attached conditions and those listed below, to permanently impact a **total of 12 linear feet (lf)** of streams as listed in the table below:

Location/Station	Stream Name	Length of Stream Impact
Station 470+31	Unnamed tributary to Stewarts Creek*	4 linear feet
Station 475+81	Unnamed tributary to Stewarts Creek*	8 linear feet

The impacts will be for the purpose of widening the existing road by two (2) feet as described in your application received by the Division of Water Quality (DWQ) on July 18, 2006, and additional information received by the DWQ on July 27, 2006. The location of the project is State Road (SR) 1501 (Secrest Shortcut Road) in Union County. After reviewing your application, we have determined that this project is covered by Water Quality General Certification Number 3404. Please note that you should get any other federal, state or local permits before proceeding with your project, including those required by (but not limited to) Sediment and Erosion Control, Non-Discharge, and Water Supply Watershed regulations. This approval will expire with the associated 404 permit unless otherwise specified in the Water Quality Certification.

This approval is valid solely for the purpose and design that you described in your application (unless modified below). Should your project change, you must notify the DWQ in writing and you may be required to submit a new application. If the property is sold, the new owner must be given a copy of this Certification and approval letter and is thereby responsible for complying with all conditions. If total wetland fills for this project (now or in the future) exceed one acre, or if total impacts to streams (now or in the future) exceed 150 linear feet, compensatory mitigation may be required as described in 15A NCAC 2H.0506 (h)(6) and (7). For this approval to remain valid, you must adhere to the conditions listed in the attached certification and those listed below:

1. Placement of culverts and other structures in waters, streams and wetlands must be below the elevation of the streambed by one (1) foot for all culverts with a diameter greater than 48 inches, and 20 percent of the culvert diameter for culverts having a diameter less than 48 inches, to allow for low flow passage of water and aquatic life, as well as prevent headcutting of the streams.

\*No stream determination performed.



The design and placement of culverts and other structures including temporary erosion control measures shall be installed in such a manner that the original stream profiles are not altered (i.e., the depth of the channel must not be reduced by a widening of the streambed). Existing stream dimensions (including pattern and profile) are to be maintained above and below locations of each culvert. The applicant may be required to provide evidence that the equilibrium has been maintained, if requested in writing by the DWQ.

2. The use of riprap above the normal high water mark shall be minimized. Any riprap placed for stream stabilization shall be placed in stream channels in such a manner that it does not impede aquatic life passage. *In addition, riprap located immediately downstream of Station 470+31 shall be removed from the thalweg of the stream to allow for low flow passage of water and aquatic life.*
3. Heavy equipment shall be operated from the banks rather than in the stream channel in order minimize sedimentation and reduce the introduction of other pollutants into the stream.
4. No rock, sand or other materials shall be dredged from the stream channel except where authorized by this certification.
5. Temporary dewatering sites must be restored to pre-existing conditions unless more natural geomorphic conditions can be provided.
6. If concrete is used during construction, a dry work area should be maintained to prevent direct contact between curing concrete and stream water. Water that inadvertently contacts uncured concrete should not be discharged to surface waters due to the potential for elevated pH and possible aquatic life and fish kills.
7. All work in or adjacent to stream waters shall be conducted in a dry work area. Approved BMP measures from the most current version of the NCDOT Construction and Maintenance Activities manual such as sandbags, rock berms, cofferdams and other diversion structures shall be used to prevent excavation in flowing water.
8. The dimension, pattern and profile of the stream above and below the crossing should not be modified. Disturbed floodplains and streams should be restored to natural geomorphic conditions.
9. All mechanized equipment operated near surface waters must be regularly inspected and maintained to prevent contamination of stream waters from fuels, lubricants, hydraulic fluids, or other toxic materials.
10. All fill slopes located in jurisdictional wetlands shall be placed at slopes no flatter than 3:1, unless otherwise authorized by this certification.
11. Discharging hydroseed mixtures and washing out hydroseeders and other equipment in or adjacent to surface waters is prohibited.
12. A copy of this Water Quality Certification shall be posted on the construction site at all times. In addition, the Water Quality Certification and all subsequent modifications, if any, shall be maintained with the Division Engineer and the on-site project manager.
13. Native riparian vegetation must be re-established within the construction limits of the project by the end of the growing season following completion of construction.
14. Sediment and erosion control measures shall not be placed in wetlands or waters to the maximum extent practicable. If placement of sediment and erosion control devices in wetlands and waters is unavoidable, they shall be removed and the natural grade restored within 30 days after the Division of Land Resources has released the project.

15. Erosion and sediment control practices must be in full compliance with all specifications governing the proper design, installation and operation and maintenance of such Best Management Practices in order to protect surface waters standards:
  - a. The erosion and sediment control measures for the project must be designed, installed, operated, and maintained in accordance with the most recent version of the *North Carolina Sediment and Erosion Control Planning and Design Manual*.
  - b. The design, installation, operation, and maintenance of the sediment and erosion control measures must be such that they equal, or exceed, the requirements specified in the most recent version of the *North Carolina Sediment and Erosion Control Manual*. The devices shall be maintained on all construction sites, borrow sites, and waste pile (spoil) projects, including contractor-owned or leased borrow pits associated with the project.
  - c. For borrow pit sites, the erosion and sediment control measures must be designed, installed, operated, and maintained in accordance with the most recent version of the *North Carolina Surface Mining Manual*.
  - d. The reclamation measures and implementation must comply with the reclamation in accordance with the requirements of the Sedimentation Pollution Control Act.
16. The North Carolina Department of Transportation (NCDOT) and its contractors and/or agents shall not excavate, fill or perform mechanized land clearing at any time in the construction or maintenance of this project within waters and/or wetlands, except as authorized by this Certification, or any modification to this Certification (e.g., no work shall occur outside of the footprint of the plans provided). In addition, there shall be no excavation from or waste disposal into jurisdictional wetlands or waters associated with this Certification without appropriate modification. If this occurs, compensatory mitigation may be required since it is a direct impact from road construction activities.
- ✕17. Upon completion of the project, the NCDOT Division Engineer shall complete and return the enclosed "Certificate of Completion" form to notify DWQ when all work included in the 401 Certification has been completed. Please include photographs upstream and downstream of the structure to document correct installation.
18. Continuing Compliance. NCDOT shall conduct its activities in a manner so as not to contravene any state water quality standard [including any requirements for compliance with section 303(d) of the Clean Water Act] and any other appropriate requirements of state and federal law. If DWQ determines that such standards or laws are not being met (including the failure to sustain a designated or achieved use) or that state or federal law is being violated, or that further conditions are necessary to assure compliance, DWQ may reevaluate and modify this certification to include conditions appropriate to assure compliance with such standards and requirements in accordance with 15 A NCAC 2H.0507(d). Before codifying the certification, DWQ shall notify NCDOT and the USACE, provide public notice in accordance with 15A NCAC 2H.0503, and provide opportunity for public hearing in accordance with 15A NCAC 2H.0504. Any new or revised conditions shall be provided to NCDOT in writing, shall be provided to the USACE for reference in any permit issued pursuant to Section 404 of the Clean Water Act, and shall also become conditions of the 404 Permit for the project.

If you do not accept any of the conditions of this certification, you may ask for an adjudicatory hearing. You must act within 60 days of the date that you receive this letter. To ask for a hearing, send a written petition that conforms to Chapter 150B of the North Carolina General Statutes to the Office of Administrative Hearings, 6714 Mail Service Center, Raleigh, N.C. 27699-6714. This certification and its conditions are final and binding unless you ask for a hearing.

This letter completes the review by the Division of Water Quality under Section 401 of the Clean Water Act. If you have any questions, **please telephone Polly Lespinasse in the Mooresville Regional Office at 704-663-1699.**

Sincerely,



for Alan W. Klimek, P.E.

Attachments

cc: Steve Lund, USACE Asheville Field Office  
Sonia Gregory, DWQ Wetlands Unit  
File Copy

**GENERAL CERTIFICATION FOR PROJECTS ELIGIBLE FOR CORPS OF ENGINEERS  
NATIONWIDE PERMIT NUMBER 14 (ROAD CROSSINGS) AND REGIONAL GENERAL  
PERMIT 198200031 (WORK ASSOCIATED WITH BRIDGE CONSTRUCTION, MAINTENANCE  
OR REPAIR CONDUCTED BY NCDOT OR OTHER GOVERNMENT AGENCIES)  
AND RIPARIAN AREA PROTECTION RULES (BUFFER RULES)**

This General Certification is issued in conformity with the requirements of Section 401, Public Laws 92-500 and 95-217 of the United States and subject to the North Carolina Division of Water Quality (DWQ) Regulations in 15A NCAC 2H, Section .0500 and 15A NCAC 2B .0200 for the discharge of fill material to waters and adjacent wetland areas or to wetland areas that are not a part of the surface tributary system to interstate waters or navigable waters of the United States (i.e., isolated wetlands) as described in 33 CFR 330 Appendix A (B) (14) of the Corps of Engineers regulations (Nationwide Permit No. 14 and Regional General Permit 198200031) and for the Riparian Area Protection Rules (Buffer Rules) in 15A NCAC 2B .0200. The category of activities shall include any fill activity for road crossings and is limited to fill less than one-third acre in tidal waters and less than one-half acre in non-tidal waters. This Certification replaces Water Quality Certification Number 2177 issued on November 5, 1987, Water Quality Certification Number 2666 issued on January 21, 1992, Water Quality Certification Number 2732 issued on May 1, 1992, Water Quality Certification Number 3103 issued on February 11, 1997, Water Quality Certification Number 3289 issued on June 1, 2000 and Water Quality Certification Number 3375 issued March 18, 2002. This WQC is rescinded when the Corps of Engineers re-authorizes Nationwide Permit 14 or Regional General Permit 198200031 or when deemed appropriate by the Director of DWQ.

The State of North Carolina certifies that the specified category of activity will not violate applicable portions of Sections 301, 302, 303, 306 and 307 of the Public Laws 92-500 and 95-217 if conducted in accordance with the conditions hereinafter set forth.

Conditions of Certification:

1. Enumerating and Reporting of Impacts:

- Streams - Impacts to streams as determined by the Division of Water Quality shall be measured as length of the centerline of the normal flow channel. Permanent and/or temporary stream impacts shall be enumerated on the entire project for all impacts regardless of which 404 Nationwide Permits are used. Stream relocations and stream bed and/or bank hardening are considered to be permanent stream impacts. Any activity that results in a loss of use of stream functions including but not limited to filling, relocating, flooding, dredging and complete shading shall be considered stream impacts. Enumeration of impacts to streams shall include streams enclosed by bottomless culverts, bottomless arches or other spanning structures when a 404 Permit is used anywhere in a project unless the entire structure (including construction impacts) spans the entire bed and both banks of the stream, is only used for a road, driveway or path crossing, and is not mitered to follow the stream pattern. Impacts for dam footprints and flooding will count toward the threshold for stream impacts, but flooding upstream of the dam will not (as long as no filling, excavation, relocation or other modification of the existing stream dimension, pattern or profile occurs) count towards mitigation requirements.
- Wetlands - Impacts to wetlands as determined by the Division of Water Quality shall be measured as area. Permanent and/or temporary wetland impacts shall be enumerated on the entire project for all impacts regardless of which 404 Nationwide Permits are used. Any activity that results in a loss of use of wetland functions including but not limited to filling, draining, and flooding shall be considered wetland impacts. Enumeration of impacts to wetlands shall include activities that change the hydrology of a wetland when a 404 Permit is used anywhere in a project.

- Lakes and Ponds – Lake and Pond Impacts Enumeration- Impacts to waters other than streams and wetlands as determined by the Division of Water Quality shall be measured as area. Permanent and/or temporary water impacts shall be enumerated on the entire project for all impacts proposed regardless of which 404 Nationwide Permits are used. Any activity that results in a loss of use of aquatic functions including but not limited to filling and dredging shall be considered waters impacts;
2. Proposed fill or substantial modification of wetlands or waters (including streams) under this General Certification requires application to and prior written concurrence from the Division of Water Quality;
  3. Application to and payment of a fee to DWQ is not required for construction of a driveway to a single family lot as long as the driveway impacts less than 25 feet of stream channel including any in-stream stabilization needed for the crossing;
  4. Impacts to any stream length in the Neuse, Tar-Pamlico or Randleman River Basins (or any other major river basins with Riparian Area Protection Rules [Buffer Rules] in effect at the time of application) requires written concurrence for this Certification from DWQ in accordance with 15A NCAC 2B.0200. Activities listed as “exempt” from these rules do not need to apply for written concurrence under this Certification. New development activities located in the protected 50-foot wide riparian areas (whether jurisdictional wetlands or not) within the Neuse and Tar-Pamlico River Basins shall be limited to “uses” identified within and constructed in accordance with 15A NCAC 2B .0200. All new development shall be located, designed, constructed, and maintained to have minimal disturbance to protect water quality to the maximum extent practicable through the use of best management practices;
  5. Irrespective of other application thresholds in this General Certification, all impacts to perennial waters and their associated buffers require written approval from DWQ since such impacts are allowable as provided in 15A NCAC 2B. 0212 (WS-I), 2B .0213 (WS-II), 2B .0214 (WS-III) and 2B .0215 (WS-IV). Only water dependent activities, public projects and structures with diminimus increases in impervious surfaces will be allowed as outlined in those rules. All other activities require a variance from the delegated local government and/or the NC Environmental Management Commission before the 401 Water Quality Certification can be processed. In addition, a 30 foot wide vegetative buffer for low density development or a 100 foot wide vegetative buffer for high density development must be maintained adjacent to all perennial waters except for allowances as provided under the Water Supply Watershed Protection Rules. For the purposes of this condition, perennial waters are defined as those shown as perennial waters on the most recent USGS 1:24,000 topographic map or as otherwise determined by local government studies;
  6. Additional site-specific stormwater management requirements may be added to this Certification at DWQ's discretion on a case by case basis for projects that have or are anticipated to have impervious cover of greater than 30 percent. Site-specific stormwater management shall be designed to remove 85% TSS according to the latest version of DWQ's Stormwater Best Management Practices manual at a minimum.

Additionally, in watersheds within one mile and draining to 303(d) listed waters, as well as watersheds that are classified as nutrient sensitive waters (NSW), water supply waters (WS), trout waters (Tr), high quality waters (HQW), and outstanding resource waters (ORW), the Division shall require that extended detention wetlands, bio-retention areas, and ponds followed by forested filter strips (designed according to latest version of the NC DENR Stormwater Best Management Practices Manual) be constructed as part of the stormwater management plan when a site-specific stormwater management plan is required.

Alternative designs may be requested by the applicant and will be reviewed on a case-by-case basis by the Division of Water Quality.

Approval of stormwater management plans by the Division of Water Quality's other existing state stormwater programs including appropriate local programs are sufficient to satisfy this Condition as long as the stormwater management plans meet or exceed the design requirements specified in this condition. This condition applies unless more stringent requirements are in effect from other state water quality programs.

- Unless specified otherwise in the approval letter, the final, written stormwater management plan shall be approved in writing by the Division of Water Quality's Wetlands Unit before the impacts specified in this Certification occur.
  - The facilities must be designed to treat the runoff from the entire project, unless otherwise explicitly approved by the Division of Water Quality.
  - Also, before any permanent building or other structure is occupied at the subject site, the facilities (as approved by the Wetlands Unit) shall be constructed and operational, and the stormwater management plan (as approved by the Wetlands Unit) shall be implemented.
  - The structural stormwater practices as approved by the Wetlands Unit as well as drainage patterns must be maintained in perpetuity.
  - No changes to the structural stormwater practices shall be made without written authorization from the Division of Water Quality.
7. Compensatory stream mitigation shall be required at a 1:1 ratio for not only perennial but also intermittent stream impacts that require application to DWQ in watersheds classified as ORW, HQW, Tr, WS-I and WS-II unless the project is a linear, publicly-funded transportation project, which has a 150-foot per-stream impact allowance;
  8. In accordance with North Carolina General Statute Section 143-215.3D(e), any application for a 401 Water Quality Certification must include the appropriate fee. If a project also requires a CAMA Permit, one payment to both agencies shall be submitted through the Division of Coastal Management and will be the higher of the two fees;
  9. In accordance with 15A NCAC 2H .0506 (h) compensatory mitigation may be required for impacts to 150 linear feet or more of streams and/or one acre or more of wetlands. For linear public transportation projects, impacts equal to or exceeding 150 feet per stream may require mitigation. In addition, buffer mitigation may be required for any project with Buffer Rules in effect at the time of application for buffer impacts resulting from activities classified as "allowable with mitigation" within the "Table of Uses" section of the Buffer Rules or require a variance under the Buffer Rules. A determination of buffer, wetland and stream mitigation requirements shall be made for any Certification for this Nationwide Permit. The most current design and monitoring protocols from DWQ shall be followed and written plans submitted for DWQ approval as required in those protocols. When compensatory mitigation is required for a project, the mitigation plans must be approved by DWQ in writing before the impacts approved by the Certification occur, unless otherwise specified in the approval letter. The mitigation plan must be implemented and/or constructed before any permanent building or structure on site is occupied. In the case of public road projects, the mitigation plan must be implemented before the road is opened to the travelling public. Projects may also be implemented once payment is made to a private mitigation bank or other in-lieu fee program, as specified in the written concurrence of 401 Certification for a project. Please note that if a stream relocation is conducted as a stream restoration as defined in *The Internal Technical Guide for Stream Work in North Carolina*, April 2001, the restored length can be used as compensatory mitigation for the impacts resulting from the relocation;



10. For any project involving re-alignment of streams, a stream relocation plan must be included with the 401 application for written DWQ approval. Relocated stream designs should include the same dimensions, patterns and profiles as the existing channel, to the maximum extent practical. The new channel should be constructed in the dry and water shall not be turned into the new channel until the banks are stabilized. Vegetation used for bank stabilization shall be limited to native woody species, and should include establishment of a 30 foot wide wooded and an adjacent 20 foot wide vegetated buffer on both sides of the relocated channel to the maximum extent practical. A transitional phase incorporating coir fiber and seedling establishment is allowable. Also, rip-rap may be allowed if it is necessary to maintain the physical integrity of the stream, but the applicant must provide written justification and any calculations used to determine the extent of rip-rap coverage requested. If suitable stream mitigation is not practical on-site, then stream impact will need to be mitigated elsewhere;
11. Placement of culverts and other structures in waters, streams, and wetlands must be placed below the elevation of the streambed to allow low flow passage of water and aquatic life unless it can be shown to DWQ that providing passage would be impractical. Design and placement of culverts including open bottom or bottomless arch culverts and other structures including temporary erosion control measures shall not be conducted in a manner that may result in aggradation, degradation or significant changes in hydrology of wetlands or stream beds or banks, adjacent to or upstream and down stream of the above structures. The applicant is required to provide evidence that the equilibrium shall be maintained if requested to do so in writing by DWQ. Additionally, when roadways, causeways or other fill projects are constructed across FEMA-designated floodways or wetlands, openings such as culverts or bridges must be provided to maintain the natural hydrology of the system as well as prevent constriction of the floodway that may result in aggradation, degradation or significant changes in hydrology of streams or wetlands;
12. That appropriate sediment and erosion control practices which equal or exceed those outlined in the most recent version of the "North Carolina Sediment and Erosion Control Planning and Design Manual" or the "North Carolina Surface Mining Manual" whichever is more appropriate (available from the Division of Land Resources (DLR) in the DENR Regional or Central Offices) shall be in full compliance with all specifications governing the proper design, installation and operation and maintenance of such Best Management Practices in order to assure compliance with the appropriate turbidity water quality standard;
13. All sediment and erosion control measures placed in wetlands and waters shall be removed and the original grade restored within two months after the Division of Land Resources has released the project;
14. That additional site-specific conditions may be added to projects proposed under this Certification in order to ensure compliance with all applicable water quality and effluent standards;
15. Measures shall be taken to prevent live or fresh concrete from coming into contact with freshwaters of the state until the concrete has hardened;
16. If an environmental document is required, this Certification is not valid until a Finding of No Significant Impact (FONSI) or Record of Decision (ROD) is issued by the State Clearinghouse;
17. If this Certification is used to access building sites, all lots owned by the applicant must be buildable without additional fill beyond that explicitly allowed under other General

Certifications. For road construction purposes, this Certification shall only be utilized from natural high ground to natural high ground;

18. When written concurrence is required, the applicant is required to use the most recent version of the Certification of Completion form to notify DWQ when all work included in the 401 Certification has been completed;
19. Concurrence from DWQ that this Certification applies to an individual project shall expire three years from the date of the cover letter from DWQ or on the same day as the expiration date of the corresponding Nationwide Permit 14 or Regional General Permit 198200031, whichever is sooner.

Non-compliance with or violation of the conditions herein set forth by a specific fill project may result in revocation of this Certification for the project and may also result in criminal and/or civil penalties.

The Director of the North Carolina Division of Water Quality may require submission of a formal application for Individual Certification for any project in this category of activity that requires written concurrence under this certification, if it is determined that the project is likely to have a significant adverse effect upon water quality or degrade the waters so that existing uses of the wetland or downstream waters are precluded.

Public hearings may be held for specific applications or group of applications prior to a Certification decision if deemed in the public's best interest by the Director of the North Carolina Division of Water Quality.

Effective date: March 2003

DIVISION OF WATER QUALITY

By

Alan W. Klimek, P.E.

Director

**\* Certificate of Completion**

DWQ Project No. \_\_\_\_\_ County: \_\_\_\_\_

Applicant: \_\_\_\_\_

Project Name: \_\_\_\_\_

Date of Issuance of 401 Water Quality Certification: \_\_\_\_\_

Upon completion of all work approved within the 401 Water Quality Certification and Buffer Rules, and any subsequent modifications, the applicant is required to return this certificate to the 401/Wetlands Unit, North Carolina Division of Water Quality, 1621 Mail Service Center, Raleigh, NC, 27699-1621. This form may be returned to DWQ by the applicant, the applicant's authorized agent, or the project engineer. It is not necessary to send certificates from all of these.

***Applicant's Certification***

I, \_\_\_\_\_, hereby state that, to the best of my abilities, due care and diligence was used in the observation of the construction such that the construction was observed to built within substantial compliance and intent of the 401 Water Quality Certification and Buffer Rules, the approved plans and specifications, and other supporting materials.

Signature: \_\_\_\_\_ Date: \_\_\_\_\_

***Agent's Certification***

I, \_\_\_\_\_, hereby state that, to the best of my abilities, due care and diligence was used in the observation of the construction such that the construction was observed to built within substantial compliance and intent of the 401 Water Quality Certification and Buffer Rules, the approved plans and specifications, and other supporting materials.

Signature: \_\_\_\_\_ Date: \_\_\_\_\_

***If this project was designed by a Certified Professional***

I, \_\_\_\_\_, as a duly registered Professional \_\_\_\_\_ (i.e., Engineer, Landscape Architect, Surveyor, etc.) in the State of North Carolina, having been authorized to observe (periodically, weekly, full time) the construction of the project, for the Permittee hereby state that, to the best of my abilities, due care and diligence was used in the observation of the construction such that the construction was observed to built within substantial compliance and intent of the 401 Water Quality Certification and Buffer Rules, the approved plans and specifications, and other supporting materials.

Signature: \_\_\_\_\_ Registration No.: \_\_\_\_\_ Date: \_\_\_\_\_

**NATIONWIDE PERMIT 14**  
**DEPARTMENT OF THE ARMY**  
**CORPS OF ENGINEERS**  
**FINAL NOTICE OF ISSUANCE AND MODIFICATION OF NATIONWIDE PERMITS**  
**FEDERAL REGISTER**  
**AUTHORIZED MARCH 18, 2002**

**Linear Transportation Projects.** Activities required for the construction, expansion, modification, or improvement of linear transportation crossings (e.g., highways, railways, trails, and airport runways and taxiways) in waters of the United States, including wetlands, if the activity meets the following criteria:

1. This nationwide permit is subject to the following acreage and linear limits:
  - a. For linear transportation projects in non-tidal waters, provided the discharge does not cause the loss of greater than  $\frac{1}{2}$  acre of waters of the United States; or
  - b. For linear transportation projects in tidal waters, provided the discharge does not cause the loss of greater than  $\frac{1}{3}$  acre of waters of the United States.
2. The permittee must notify the District Engineer in accordance with General Condition 13 if any of the following criteria are met:
  - a. The discharge causes the loss of greater than  $\frac{1}{10}$  acre of waters of the United States;  
or
  - b. There is a discharge in a special aquatic site, including wetlands;
  - c. The notification must include a compensatory mitigation proposal to offset permanent losses of waters of the United States to ensure that those losses result only in minimal adverse effects to the aquatic environment and a statement describing how temporary losses of waters will be minimized to the maximum extent practicable;
  - d. For discharges in special aquatic sites, including wetlands and stream riffle and pool complexes, the notification must include a delineation of the affected special aquatic sites;
  - e. The width of the fill is limited to the minimum necessary for the crossing;
  - f. This permit does not authorize stream channelization, and the authorized activities must not cause more than minimal changes to the hydraulic flow characteristics of the stream, increase flooding, or cause more than minimal degradation of water quality of any stream (see General Conditions 9 and 21);

g. This permit cannot be used to authorize non-linear features commonly associated with transportation projects, such as vehicle maintenance or storage buildings, parking lots, train stations, or aircraft hangars; and

h. The crossing is a single and complete project for crossing a water of the United States. Where a road segment (i.e., the shortest segment of a road with independent utility that is part of a larger project) has multiple crossings of streams (several single and complete projects) the Corps will consider whether it should use its discretionary authority to require an individual permit. (Sections 10 and 404)

**Note:** Some discharges for the construction of farm roads, forest roads, or temporary roads for moving mining equipment may be eligible for an exemption from the need for a Section 404 permit (see 33 CFR 323.4).

## NATIONWIDE PERMIT GENERAL CONDITIONS

The following General Conditions must be followed in order for any authorization by a NWP to be valid:

1. **Navigation.** No activity may cause more than a minimal adverse effect on navigation.
2. **Proper Maintenance.** Any structure or fill authorized shall be properly maintained, including maintenance to ensure public safety.
3. **Soil Erosion and Sediment Controls.** Appropriate soil erosion and sediment controls must be used and maintained in effective operating condition during construction, and all exposed soil and other fills, as well as any work below the ordinary high water mark or high tide line, must be permanently stabilized at the earliest practicable date. Permittees are encouraged to perform work within waters of the United States during periods of low-flow or no-flow.
4. **Aquatic Life Movements.** No activity may substantially disrupt the necessary life-cycle movements of those species of aquatic life indigenous to the waterbody, including those species that normally migrate through the area, unless the activity's primary purpose is to impound water. Culverts placed in streams must be installed to maintain low flow conditions.
5. **Equipment.** Heavy equipment working in wetlands must be placed on mats, or other measures must be taken to minimize soil disturbance.
6. **Regional and Case-By-Case Conditions.** The activity must comply with any regional conditions that may have been added by the Division Engineer (see 33 CFR 330.4(e)) and with any case specific conditions added by the Corps or by the state or tribe in its Section 401 Water Quality Certification and Coastal Zone Management Act consistency determination.
7. **Wild and Scenic Rivers.** No activity may occur in a component of the National Wild and Scenic River System; or in a river officially designated by Congress as a 'study river' for possible inclusion in the system, while the river is in an official study status; unless the appropriate Federal agency, with direct management responsibility for such river, has determined in writing that the proposed activity will not adversely affect the Wild and Scenic River designation, or study status. Information on Wild and Scenic Rivers may be obtained from the appropriate Federal land management agency in the area (e.g., National Park Service, U.S. Forest Service, Bureau of Land Management, U.S. Fish and Wildlife Service).
8. **Tribal Rights.** No activity or its operation may impair reserved tribal rights, including, but not limited to, reserved water rights and treaty fishing and hunting rights.
9. **Water Quality.**
  - a. In certain states and tribal lands an individual 401 Water Quality Certification must be obtained or waived (See 33 CFR 330.4(c)).

b. For NWP 12, 14, 17, 18, 32, 39, 40, 42, 43, and 44, where the state or tribal 401 certification (either generically or individually) does not require or approve water quality management measures, the permittee must provide water quality management measures that will ensure that the authorized work does not result in more than minimal degradation of water quality (or the Corps determines that compliance with state or local standards, where applicable, will ensure no more than minimal adverse effect on water quality). An important component of water quality management includes stormwater management that minimizes degradation of the downstream aquatic system, including water quality (refer to General Condition 21 for stormwater management requirements). Another important component of water quality management is the establishment and maintenance of vegetated buffers next to open waters, including streams (refer to General Condition 19 for vegetated buffer requirements for the NWPs).

This condition is only applicable to projects that have the potential to affect water quality. While appropriate measures must be taken, in most cases it is not necessary to conduct detailed studies to identify such measures or to require monitoring.

10. Coastal Zone Management. In certain states, an individual state coastal zone management consistency concurrence must be obtained or waived (see 33 CFR 330.4(d)).

#### 11. Endangered Species.

a. No activity is authorized under any NWP which is likely to jeopardize the continued existence of a threatened or endangered species or a species proposed for such designation, as identified under the Federal Endangered Species Act (ESA), or which will destroy or adversely modify the critical habitat of such species. Non-federal permittees shall notify the District Engineer if any listed species or designated critical habitat might be affected or is in the vicinity of the project, or is located in the designated critical habitat and shall not begin work on the activity until notified by the District Engineer that the requirements of the ESA have been satisfied and that the activity is authorized. For activities that may affect Federally-listed endangered or threatened species or designated critical habitat, the notification must include the name(s) of the endangered or threatened species that may be affected by the proposed work or that utilize the designated critical habitat that may be affected by the proposed work. As a result of formal or informal consultation with the FWS or NMFS the District Engineer may add species-specific regional endangered species conditions to the NWPs.

b. Authorization of an activity by a NWP does not authorize the "take" of a threatened or endangered species as defined under the ESA. In the absence of separate authorization (e.g., an ESA Section 10 Permit, a Biological Opinion with "incidental take" provisions, etc.) from the USFWS or the NMFS, both lethal and non-lethal "takes" of protected species are in violation of the ESA. Information on the location of threatened and endangered species and their critical habitat can be obtained directly from the offices of the USFWS and NMFS or their World Wide Web pages at <http://www.fws.gov/r9endspp/endspp.html> and <http://www.nfms.noaa.gov/protres/overview/es.html> respectively.

12. Historic Properties. No activity that may affect historic properties listed, or eligible for listing, in the National Register of Historic Places is authorized, until the District Engineer has complied with the provisions of 33 CFR part 325, Appendix C. The prospective permittee must notify the District Engineer if the authorized activity may affect any historic properties listed, determined to be eligible, or which the prospective permittee has reason to believe may be eligible for listing on the National Register of Historic Places, and shall not begin the activity until notified by the District Engineer that the requirements of the National Historic Preservation Act have been satisfied and that the activity is authorized. Information on the location and existence of historic resources can be obtained from the State Historic Preservation Office and the National Register of Historic Places (see 33 CFR 330.4(g)). For activities that may affect historic properties listed in, or eligible for listing in, the National Register of Historic Places, the notification must state which historic property may be affected by the proposed work or include a vicinity map indicating the location of the historic property.

13. Notification.

a. Timing; where required by the terms of the NWP, the prospective permittee must notify the District Engineer with a preconstruction notification (PCN) as early as possible. The District Engineer must determine if the notification is complete within 30 days of the date of receipt and can request additional information necessary to make the PCN complete only once. However, if the prospective permittee does not provide all of the requested information, then the District Engineer will notify the prospective permittee that the notification is still incomplete and the PCN review process will not commence until all of the requested information has been received by the District Engineer. The prospective permittee shall not begin the activity:

1. Until notified in writing by the District Engineer that the activity may proceed under the NWP with any special conditions imposed by the District or Division Engineer; or

2. If notified in writing by the District or Division Engineer that an Individual Permit is required; or

3. Unless 45 days have passed from the District Engineer's receipt of the complete notification and the prospective permittee has not received written notice from the District or Division Engineer. Subsequently, the permittee's right to proceed under the NWP may be modified, suspended, or revoked only in accordance with the procedure set forth in 33 CFR 330.5(d)(2).

b. Contents of Notification: The notification must be in writing and include the following information:

1. Name, address and telephone numbers of the prospective permittee;

2. Location of the proposed project;



3. Brief description of the proposed project; the project's purpose; direct and indirect adverse environmental effects the project would cause; any other NWP(s), Regional General Permit(s), or Individual Permit(s) used or intended to be used to authorize any part of the proposed project or any related activity. Sketches should be provided when necessary to show that the activity complies with the terms of the NWP (Sketches usually clarify the project and when provided result in a quicker decision.);

4. For NWPs 7, 12, 14, 18, 21, 34, 38, 39, 40, 41, 42, and 43, the PCN must also include a delineation of affected special aquatic sites, including wetlands, vegetated shallows (e.g., submerged aquatic vegetation, seagrass beds), and riffle and pool complexes (see paragraph 13(f));

5. For NWP 7 (Cutfall Structures and Maintenance), the PCN must include information regarding the original design capacities and configurations of those areas of the facility where maintenance dredging or excavation is proposed;

6. For NWP 14 (Linear Transportation Projects), the PCN must include a compensatory mitigation proposal to offset permanent losses of waters of the US and a statement describing how temporary losses of waters of the US will be minimized to the maximum extent practicable;

7. For NWP 21 (Surface Coal Mining Activities), the PCN must include an Office of Surface Mining (OSM) or state-approved mitigation plan, if applicable. To be authorized by this NWP, the District Engineer must determine that the activity complies with the terms and conditions of the NWP and that the adverse environmental effects are minimal both individually and cumulatively and must notify the project sponsor of this determination in writing;

8. For NWP 27 (Stream and Wetland Restoration Activities), the PCN must include documentation of the prior condition of the site that will be reverted by the permittee;

9. For NWP 29 (Single-Family Housing), the PCN must also include:

i. Any past use of this NWP by the Individual Permittee and/or the permittee's spouse;

ii. A statement that the single-family housing activity is for a personal residence of the permittee;

iii. A description of the entire parcel, including its size, and a delineation of wetlands. For the purpose of this NWP, parcels of land measuring  $\frac{1}{4}$ -acre or less will not require a formal on-site delineation. However, the applicant shall provide an indication of where the wetlands are and the amount of wetlands that exists on the property. For parcels greater than  $\frac{1}{4}$ -acre in size, formal wetland delineation must be prepared in accordance with the current method required by the Corps. (See paragraph 13(f));

iv. A written description of all land (including, if available, legal descriptions) owned by the prospective permittee and/or the prospective permittee's spouse, within a one mile radius of the parcel, in any form of ownership (including any land owned as a partner, corporation, joint tenant, co-tenant, or as a tenant-by-the-entirety) and any land on which a purchase and sale agreement or other contract for sale or purchase has been executed;

10. For NWP 31 (Maintenance of Existing Flood Control Facilities), the prospective permittee must either notify the District Engineer with a PCN prior to each maintenance activity or submit a five-year (or less) maintenance plan. In addition, the PCN must include all of the following:

i. Sufficient baseline information identifying the approved channel depths and configurations and existing facilities. Minor deviations are authorized, provided the approved flood control protection or drainage is not increased;

ii. A delineation of any affected special aquatic sites, including wetlands; and,

iii. Location of the dredged material disposal site;

11. For NWP 33 (Temporary Construction, Access, and Dewatering), the PCN must also include a restoration plan of reasonable measures to avoid and minimize adverse effects to aquatic resources;

12. For NWPs 39, 43 and 44, the PCN must also include a written statement to the District Engineer explaining how avoidance and minimization for losses of waters of the US were achieved on the project site;

13. For NWP 39 and NWP 42, the PCN must include a compensatory mitigation proposal to offset losses of waters of the US or justification explaining why compensatory mitigation should not be required. For discharges that cause the loss of greater than 300 linear feet of an intermittent stream bed, to be authorized, the District Engineer must determine that the activity complies with the other terms and conditions of the NWP, determine adverse environmental effects are minimal both individually and cumulatively, and waive the limitation on stream impacts in writing before the permittee may proceed;

14. For NWP 40 (Agricultural Activities), the PCN must include a compensatory mitigation proposal to offset losses of waters of the US. This NWP does not authorize the relocation of greater than 300 linear feet of existing serviceable drainage ditches constructed in non-tidal streams unless, for drainage ditches constructed in intermittent nontidal streams, the District Engineer waives this criterion in writing, and the District Engineer has determined that the project complies with all terms and conditions of this NWP, and that any adverse impacts of the project on the aquatic environment are minimal, both individually and cumulatively;

15. For NWP 43 (Stormwater Management Facilities), the PCN must include, for the construction of new stormwater management facilities, a maintenance plan (in accordance

with state and local requirements, if applicable) and a compensatory mitigation proposal to offset losses of waters of the US. For discharges that cause the loss of greater than 300 linear feet of an intermittent stream bed, to be authorized, the District Engineer must determine that the activity complies with the other terms and conditions of the NWP, determine adverse environmental effects are minimal both individually and cumulatively, and waive the limitation on stream impacts in writing before the permittee may proceed;

16. For NWP 44 (Mining Activities), the PCN must include a description of all waters of the US adversely affected by the project, a description of measures taken to minimize adverse effects to waters of the US, a description of measures taken to comply with the criteria of the NWP, and a reclamation plan (for all aggregate mining activities in isolated waters and non-tidal wetlands adjacent to headwaters and any hard rock/mineral mining activities);

17. For activities that may adversely affect Federally-listed endangered or threatened species, the PCN must include the name(s) of those endangered or threatened species that may be affected by the proposed work or utilize the designated critical habitat that may be affected by the proposed work; and

18. For activities that may affect historic properties listed in, or eligible for listing in, the National Register of Historic Places, the PCN must state which historic property may be affected by the proposed work or include a vicinity map indicating the location of the historic property.

c. Form of Notification: The standard Individual Permit application form (Form ENG 4345) may be used as the notification but must clearly indicate that it is a PCN and must include all of the information required in (b) (1)-(18) of General Condition 13. A letter containing the requisite information may also be used.

d. District Engineer's Decision: In reviewing the PCN for the proposed activity, the District Engineer will determine whether the activity authorized by the NWP will result in more than minimal individual or cumulative adverse environmental effects or may be contrary to the public interest. The prospective permittee may submit a proposed mitigation plan with the PCN to expedite the process. The District Engineer will consider any proposed compensatory mitigation the applicant has included in the proposal in determining whether the net adverse environmental effects to the aquatic environment of the proposed work are minimal. If the District Engineer determines that the activity complies with the terms and conditions of the NWP and that the adverse effects on the aquatic environment are minimal, after considering mitigation, the District Engineer will notify the permittee and include any conditions the District Engineer deems necessary. The District Engineer must approve any compensatory mitigation proposal before the permittee commences work. If the prospective permittee is required to submit a compensatory mitigation proposal with the PCN, the proposal may be either conceptual or detailed. If the prospective permittee elects to submit a compensatory mitigation plan with the PCN, the District Engineer will expeditiously review the proposed compensatory mitigation plan. The District Engineer must review the plan within 45 days of receiving a complete PCN and determine whether the conceptual or specific proposed mitigation would ensure no more

than minimal adverse effects on the aquatic environment. If the net adverse effects of the project on the aquatic environment (after consideration of the compensatory mitigation proposal) are determined by the District Engineer to be minimal, the District Engineer will provide a timely written response to the applicant. The response will state that the project can proceed under the terms and conditions of the NWP.

If the District Engineer determines that the adverse effects of the proposed work are more than minimal, then the District Engineer will notify the applicant either:

1. That the project does not qualify for authorization under the NWP and instruct the applicant on the procedures to seek authorization under an Individual Permit;
2. that the project is authorized under the NWP subject to the applicant's submission of a mitigation proposal that would reduce the adverse effects on the aquatic environment to the minimal level; or
3. that the project is authorized under the NWP with specific modifications or conditions. Where the District Engineer determines that mitigation is required to ensure no more than minimal adverse effects occur to the aquatic environment, the activity will be authorized within the 45-day PCN period. The authorization will include the necessary conceptual or specific mitigation or a requirement that the applicant submit a mitigation proposal that would reduce the adverse effects on the aquatic environment to the minimal level. When conceptual mitigation is included, or a mitigation plan is required under item (2) above, no work in waters of the US will occur until the District Engineer has approved a specific mitigation plan.

e. Agency Coordination: The District Engineer will consider any comments from Federal and state agencies concerning the proposed activity's compliance with the terms and conditions of the NWPs and the need for mitigation to reduce the project's adverse environmental effects to a minimal level.

For activities requiring notification to the District Engineer that result in the loss of greater than  $\frac{1}{2}$ -acre of waters of the US, the District Engineer will provide immediately (e.g., via facsimile transmission, overnight mail, or other expeditious manner) a copy to the appropriate Federal or state offices (USFWS, state natural resource or water quality agency, EPA, State Historic Preservation Officer (SHPO), and, if appropriate, the NMFS). With the exception of NWP 37, these agencies will then have 10 calendar days from the date the material is transmitted to telephone or fax the District Engineer notice that they intend to provide substantive, site-specific comments. If so contacted by an agency, the District Engineer will wait an additional 15 calendar days before making a decision on the notification. The District Engineer will fully consider agency comments received within the specified time frame, but will provide no response to the resource agency, except as provided below. The District Engineer will indicate in the administrative record associated with each notification that the resource agencies' concerns were considered. As required by section 305(b)(4)(B) of the Magnuson-Stevens Fishery Conservation and Management Act, the District Engineer will provide a response to NMFS within 30 days of receipt of any Essential Fish Habitat conservation recommendations.

Applicants are encouraged to provide the Corps multiple copies of notifications to expedite agency notification.

f. Wetland Delineations: Wetland delineations must be prepared in accordance with the current method required by the Corps (For NWP 29 see paragraph (b)(9)(iii) for parcels less than  $\frac{1}{4}$ -acre in size). The permittee may ask the Corps to delineate the special aquatic site. There may be some delay if the Corps does the delineation. Furthermore, the 45-day period will not start until the wetland delineation has been completed and submitted to the Corps, where appropriate.

✕14. Compliance Certification. Every permittee who has received NWP verification from the Corps will submit a signed certification regarding the completed work and any required mitigation. The certification will be forwarded by the Corps with the authorization letter and will include:

a. A statement that the authorized work was done in accordance with the Corps authorization, including any general or specific conditions;

b. A statement that any required mitigation was completed in accordance with the permit conditions; and

c. The signature of the permittee certifying the completion of the work and mitigation.

15. Use of Multiple Nationwide Permits. The use of more than one NWP for a single and complete project is prohibited, except when the acreage loss of waters of the US authorized by the NWPs does not exceed the acreage limit of the NWP with the highest specified acreage limit (e.g. if a road crossing over tidal waters is constructed under NWP 14, with associated bank stabilization authorized by NWP 13, the maximum acreage loss of waters of the US for the total project cannot exceed  $\frac{1}{3}$ -acre).

16. Water Supply Intakes. No activity, including structures and work in navigable waters of the US or discharges of dredged or fill material, may occur in the proximity of a public water supply intake except where the activity is for repair of the public water supply intake structures or adjacent bank stabilization.

17. Shellfish Beds. No activity, including structures and work in navigable waters of the US or discharges of dredged or fill material, may occur in areas of concentrated shellfish populations, unless the activity is directly related to a shellfish harvesting activity authorized by NWP 4.

18. Suitable Material. No activity, including structures and work in navigable waters of the US or discharges of dredged or fill material, may consist of unsuitable material (e.g., trash, debris, car bodies, asphalt, etc.) and material used for construction or discharged must be free from toxic pollutants in toxic amounts (see section 307 of the CWA).

19. Mitigation. The District Engineer will consider the factors discussed below when determining the acceptability of appropriate and practicable mitigation necessary to offset adverse effects on the aquatic environment that are more than minimal.

a. The project must be designed and constructed to avoid and minimize adverse effects to waters of the US to the maximum extent practicable at the project site (i.e., on site).

b. Mitigation in all its forms (avoiding, minimizing, rectifying, reducing or compensating) will be required to the extent necessary to ensure that the adverse effects to the aquatic environment are minimal.

c. Compensatory mitigation at a minimum one-for-one ratio will be required for all wetland impacts requiring a PCN, unless the District Engineer determines in writing that some other form of mitigation would be more environmentally appropriate and provides a project-specific waiver of this requirement. Consistent with National policy, the District Engineer will establish a preference for restoration of wetlands as compensatory mitigation, with preservation used only in exceptional circumstances.

d. Compensatory mitigation (i.e., replacement or substitution of aquatic resources for those impacted) will not be used to increase the acreage losses allowed by the acreage limits of some of the NWPs. For example,  $\frac{1}{4}$ -acre of wetlands cannot be created to change a  $\frac{3}{4}$ -acre loss of wetlands to a  $\frac{1}{2}$ -acre loss associated with NWP 39 verification. However,  $\frac{1}{2}$ -acre of created wetlands can be used to reduce the impacts of a  $\frac{1}{2}$ -acre loss of wetlands to the minimum impact level in order to meet the minimal impact requirement associated with NWPs.

e. To be practicable, the mitigation must be available and capable of being done considering costs, existing technology, and logistics in light of the overall project purposes. Examples of mitigation that may be appropriate and practicable include, but are not limited to: reducing the size of the project; establishing and maintaining wetland or upland vegetated buffers to protect open waters such as streams; and replacing losses of aquatic resource functions and values by creating, restoring, enhancing, or preserving similar functions and values, preferably in the same watershed.

f. Compensatory mitigation plans for projects in or near streams or other open waters will normally include a requirement for the establishment, maintenance, and legal protection (e.g., easements, deed restrictions) of vegetated buffers to open waters. In many cases, vegetated buffers will be the only compensatory mitigation required. Vegetated buffers should consist of native species. The width of the vegetated buffers required will address documented water quality or aquatic habitat loss concerns. Normally, the vegetated buffer will be 25 to 50 feet wide on each side of the stream, but the District Engineers may require slightly wider vegetated buffers to address documented water quality or habitat loss concerns. Where both wetlands and open waters exist on the project site, the Corps will determine the appropriate compensatory mitigation (e.g., stream buffers or wetlands compensation) based on what is best for the aquatic environment or, a watershed basis. In cases where vegetated buffers are determined to be the most appropriate form of compensatory mitigation, the District Engineer may waive or reduce

the requirement to provide wetland compensatory mitigation for wetland impacts.

g. Compensatory mitigation proposals submitted with the " notification" may be either conceptual or detailed. If conceptual plans are approved under the verification, then the Corps will condition the verification to require detailed plans be submitted and approved by the Corps prior to construction of the authorized activity in waters of the US.

h. Permittees may propose the use of mitigation banks, in-lieu fee arrangements or separate activity-specific compensatory mitigation. In all cases that require compensatory mitigation, the mitigation provisions will specify the party responsible for accomplishing and/or complying with the mitigation plan.

20. Spawning Areas. Activities, including structures and work in navigable waters of the US or discharges of dredged or fill material, in spawning areas during spawning seasons must be avoided to the maximum extent practicable. Activities that result in the physical destruction (e.g., excavate, fill, or smother downstream by substantial turbidity) of an important spawning area are not authorized.

21. Management of Water Flows. To the maximum extent practicable, the activity must be designed to maintain preconstruction downstream flow conditions (e.g., location, capacity, and flow rates). Furthermore, the activity must not permanently restrict or impede the passage of normal or expected high flows (unless the primary purpose of the fill is to impound waters) and the structure or discharge of dredged or fill material must withstand expected high flows. The activity must, to the maximum extent practicable, provide for retaining excess flows from the site, provide for maintaining surface flow rates from the site similar to preconstruction conditions, and provide for not increasing water flows from the project site, relocating water, or redirecting water flow beyond preconstruction conditions. Stream channelizing will be reduced to the minimal amount necessary, and the activity must, to the maximum extent practicable, reduce adverse effects such as flooding or erosion downstream and upstream of the project site, unless the activity is part of a larger system designed to manage water flows. In most cases, it will not be a requirement to conduct detailed studies and monitoring of water flow.

This condition is only applicable to projects that have the potential to affect waterflows. While appropriate measures must be taken, it is not necessary to conduct detailed studies to identify such measures or require monitoring to ensure their effectiveness. Normally, the Corps will defer to state and local authorities regarding management of water flow.

22. Adverse Effects From Impoundments. If the activity creates an impoundment of water, adverse effects to the aquatic system due to the acceleration of the passage of water, and/or the restricting its flow shall be minimized to the maximum extent practicable. This includes structures and work in navigable waters of the US, or discharges of dredged or fill material.

23. Waterfowl Breeding Areas. Activities, including structures and work in navigable waters of the US or discharges of dredged or fill material, into breeding areas for migratory waterfowl must be avoided to the maximum extent practicable.

24. Removal of Temporary Fills. Any temporary fills must be removed in their entirety and the affected areas returned to their preexisting elevation.

25. Designated Critical Resource Waters. Critical resource waters include, NOAA-designated marine sanctuaries, National Estuarine Research Reserves, National Wild and Scenic Rivers, critical habitat for Federally listed threatened and endangered species, coral reefs, state natural heritage sites, and outstanding national resource waters or other waters officially designated by a state as having particular environmental or ecological significance and identified by the District Engineer after notice and opportunity for public comment. The District Engineer may also designate additional critical resource waters after notice and opportunity for comment.

a. Except as noted below, discharges of dredged or fill material into waters of the US are not authorized by NWPs 7, 12, 14, 16, 17, 21, 29, 31, 35, 39, 40, 42, 43, and 44 for any activity within, or directly affecting, critical resource waters, including wetlands adjacent to such waters. Discharges of dredged or fill materials into waters of the US may be authorized by the above NWPs in National Wild and Scenic Rivers if the activity complies with General Condition 7. Further, such discharges may be authorized in designated critical habitat for Federally listed threatened or endangered species if the activity complies with General Condition 11 and the USFWS or the NMFS has concurred in a determination of compliance with this condition.

b. For NWPs 3, 8, 10, 13, 15, 18, 19, 22, 23, 25, 27, 28, 30, 33, 34, 36, 37, and 38, notification is required in accordance with General Condition 13, for any activity proposed in the designated critical resource waters including wetlands adjacent to those waters. The District Engineer may authorize activities under these NWPs only after it is determined that the impacts to the critical resource waters will be no more than minimal.

26. Fills Within 100-Year Floodplains. For purposes of this General Condition, 100-year floodplains will be identified through the existing Federal Emergency Management Agency's (FEMA) Flood Insurance Rate Maps or FEMA-approved local floodplain maps.

a. Discharges in Floodplain; Below Headwaters. Discharges of dredged or fill material into waters of the US within the mapped 100-year floodplain, below headwaters (i.e. five cfs), resulting in permanent above-grade fills, are not authorized by NWPs 39, 40, 42, 43, and 44.

b. Discharges in Floodway; Above Headwaters. Discharges of dredged or fill material into waters of the US within the FEMA or locally mapped floodway, resulting in permanent above-grade fills, are not authorized by NWPs 39, 40, 42, and 44.

c. The permittee must comply with any applicable FEMA-approved state or local floodplain management requirements.

27. Construction Period. For activities that have not been verified by the Corps and the project was commenced or under contract to commence by the expiration date of the NWP (or modification or revocation date), the work must be completed within 12-months after such date



(including any modification that affects the project).

For activities that have been verified and the project was commenced or under contract to commence within the verification period, the work must be completed by the date determined by the Corps.

For projects that have been verified by the Corps, an extension of a Corps approved completion date maybe requested. This request must be submitted at least one month before the previously approved completion date.

### **FURTHER INFORMATION**

1. District Engineers have authority to determine if an activity complies with the terms and conditions of a NWP.
2. NWPs do not obviate the need to obtain other Federal, State, or local permits, approvals, or authorizations required by law.
3. NWPs do not grant any property rights or exclusive privileges.
4. NWPs do not authorize any injury to the property or rights of others.
5. NWPs do not authorize interference with any existing or proposed Federal project.

### **DEFINITIONS**

**Best Management Practices (BMPs):** BMPs are policies, practices, procedures, or structures implemented to mitigate the adverse environmental effects on surface water quality resulting from development. BMPs are categorized as structural or nonstructural. A BMP policy may affect the limits on a development.

**Compensatory Mitigation:** For purposes of Section 10/404, compensatory mitigation is the restoration, creation, enhancement, or in exceptional circumstances, preservation of wetlands and/or other aquatic resources for the purpose of compensating for unavoidable adverse impacts, which remain, after all appropriate and practicable avoidance and minimization has been achieved.

**Creation:** The establishment of a wetland or other aquatic resource where one did not formerly exist.

**Enhancement:** Activities conducted in existing wetlands or other aquatic resources that increase one or more aquatic functions.

**Ephemeral Stream:** An ephemeral stream has *flowing* water only during and for a short duration after, precipitation events in a typical year. Ephemeral stream beds are located above the water

table year-round. Groundwater is not a source of water for the stream. Runoff from rainfall is the primary source of water for stream flow.

Farm Tract: A unit of contiguous land under one ownership that is operated as a farm or part of a farm.

Flood Fringe: That portion of the 100-year floodplain outside of the floodway (often referred to as “floodway fringe”).

Floodway: The area regulated by Federal, state, or local requirements to provide for the discharge of the base flood so the cumulative increase in water surface elevation is no more than a designated amount (not to exceed one foot as set by the National Flood Insurance Program) within the 100-year floodplain.

Independent Utility: A test to determine what constitutes a single and complete project in the Corps regulatory program. A project is considered to have independent utility if it would be constructed absent the construction of other projects in the project area. Portions of a multi-phase project that depend upon other phases of the project do not have independent utility. Phases of a project that would be constructed even if the other phases were not built can be considered as separate single and complete projects with independent utility.

Intermittent Stream: An intermittent stream has flowing water during certain times of the year, when groundwater provides water for stream flow. During dry periods, intermittent streams may not have flowing water. Runoff from rainfall is a supplemental source of water for stream flow.

Loss of waters of the US: Waters of the US that include the filled area and other waters that are permanently adversely affected by flooding, excavation, or drainage because of the regulated activity. Permanent adverse effects include permanent above-grade, at-grade, or below-grade fills that change an aquatic area to dry land, increase the bottom elevation of a waterbody, or change the use of a waterbody. The acreage of loss of waters of the US is the threshold measurement of the impact to existing waters for determining whether a project may qualify for a NWP; it is not a net threshold that is calculated after considering compensatory mitigation that may be used to offset losses of aquatic functions and values. The loss of stream bed includes the linear feet of stream bed that is filled or excavated. Waters of the US temporarily filled, flooded, excavated, or drained, but restored to preconstruction contours and elevations after construction, are not included in the measurement of loss of waters of the US. Impacts to ephemeral waters are only not included in the acreage or linear foot measurements of loss of waters of the US or loss of stream bed, for the purpose of determining compliance with the threshold limits of the NWPs.

Non-tidal Wetland: An area that, during a year with normal patterns of precipitation has standing or flowing water for sufficient duration to establish an ordinary high water mark. Aquatic vegetation within the area of standing or flowing water is either non-emergent, sparse, or absent. Vegetated shallows are considered to be open waters. The term “open water” includes rivers, streams, lakes, and ponds. For the purposes of the NWPs, this term does not

include ephemeral waters.

Perennial Stream: A perennial stream has flowing water year-round during a typical year. The water table is located above the stream bed for the most of the year. Groundwater is the primary source of water for stream flow. Runoff from rainfall is a supplemental source of water for stream flow.

Permanent Above-grade Fill: A discharge of dredged or fill material into waters of the US, including wetlands, that results in a substantial increase in ground elevation and permanently converts part or all of the waterbody to dry land. Structural fills authorized by NWP 3, 25, 36, etc. are not included.

Preservation: The protection of ecologically important wetlands or other aquatic resources in perpetuity through the implementation of appropriate legal and physical mechanisms. Preservation may include protection of upland areas adjacent to wetlands as necessary to ensure protection and/or enhancement of the overall aquatic ecosystem.

Restoration: Re-establishment of wetland and/or other aquatic resource characteristics and function(s) at a site where they have ceased to exist, or exist in a substantially degraded state.

Riffle and Pool Complex: Riffle and pool complexes are special aquatic sites under the 404(b)(1) Guidelines. Riffle and pool complexes sometimes characterize steep gradient sections of streams. Such stream sections are recognizable by their hydraulic characteristics. The rapid movement of water over a coarse substrate in riffles results in a rough flow, a turbulent surface and high dissolved oxygen levels in the water. Pools are deeper areas associated with riffles. A slower stream velocity, a streaming flow, a smooth surface, and a finer substrate characterize pools.

Single and Complete Project: The term “single and complete project” is defined at 33 CFR 330.2(i) as the total project proposed or accomplished by one owner/developer or partnership or other association of owners/developers (see definition of independent utility). For linear projects, the “single and complete project” (i.e., a single and complete crossing) will apply to each crossing of a separate water of the US (i.e., a single waterbody) at that location. An exception is for linear projects crossing a single waterbody several times at separate and distant locations; each crossing is considered a single and complete project. However, individual channels in a braided stream or river, or individual arms of a large, irregularly shaped wetland or lake, etc., are not separate waterbodies.

Stormwater Management: Stormwater management is the mechanism for controlling stormwater runoff for the purposes of reducing downstream erosion, water quality degradation, and flooding and mitigating the adverse effects of changes in land use on the aquatic environment.

Stormwater Management Facilities: Stormwater management facilities are those facilities, including but not limited to, stormwater retention and detention ponds and BMPs, which retain water for a period of time to control runoff and/or improve the quality (i.e., by reducing the

concentration of nutrients, sediments, hazardous substances and other pollutants) of stormwater runoff.

*Stream Channelization:* The manipulation of a stream channel to increase the rate of water flow through the stream channel. Manipulation may include deepening, widening, straightening, armoring, or other activities that change the stream cross-section or other aspects of stream channel geometry to increase the rate of water flow through the stream channel. A channelized stream remains a water of the US, despite the modifications to increase the rate of water flow.

*Tidal Wetland:* A tidal wetland is a wetland (i.e., water of the US) that is inundated by tidal waters. The definitions of a wetland and tidal waters can be found at 33 CFR 328.3(b) and 33 CFR 328.3(f), respectively. Tidal waters rise and fall in a predictable and measurable rhythm or cycle due to the gravitational pulls of the moon and sun. Tidal waters end where the rise and fall of the water surface can no longer be practically measured in a predictable rhythm due to masking by other waters, wind, or other effects. Tidal wetlands are located channelward of the high tide line (i.e., spring high tide line) and are inundated by tidal waters two times per lunar month, during spring high tides.

*Vegetated Buffer:* A vegetated upland or wetland area next to rivers, streams, lakes, or other open waters, which separates the open water from developed areas, including agricultural land. Vegetated buffers provide a variety of aquatic habitat functions and values (e.g., aquatic habitat for fish and other aquatic organisms, moderation of water temperature changes, and detritus for aquatic food webs) and help improve or maintain local water quality. A vegetated buffer can be established by maintaining an existing vegetated area or planting native trees, shrubs, and herbaceous plants on land next to openwaters. Mowed lawns are not considered vegetated buffers because they provide little or no aquatic habitat functions and values. The establishment and maintenance of vegetated buffers is a method of compensatory mitigation that can be used in conjunction with the restoration, creation, enhancement or preservation of aquatic habitats to ensure that activities authorized by NWP result in minimal adverse effects to the aquatic environment. (See General Condition 19.)

*Vegetated Shallows:* Vegetated shallows are special aquatic sites under the 404(b)(1) Guidelines. They are areas that are permanently inundated and under normal circumstances have rooted aquatic vegetation, such as seagrasses in marine and estuarine systems and a variety of vascular rooted plants in freshwater systems.

*Waterbody:* A waterbody is any area that in a normal year has water flowing or standing above ground to the extent that evidence of an ordinary high water mark is established. Wetlands contiguous to the waterbody are considered part of the waterbody.

## **FINAL REGIONAL CONDITIONS FOR NATIONWIDE PERMITS IN THE WILMINGTON DISTRICT**

### 1. Waters Excluded from NWP or Subject to Additional Notification Requirements:

a. The Corps identified waters that will be excluded from use of this NWP. These waters are:

1. Discharges into Waters of the United States designated by either the North Carolina Division of Marine Fisheries (NCDMF) or the North Carolina Wildlife Resources Commission (NCWRC) as anadromous fish spawning area are prohibited during the period between February 15 and June 30, without prior written approval from NCDMF or NCWRC and the Corps.

2. Discharges into Waters of the United States designated as sturgeon spawning areas are prohibited during the period between February 1 and June 30, without prior written approval from the National Marine Fisheries Service (NMFS).

b. The Corps identified waters that will be subject to additional notification requirements for activities authorized by this NWP. These waters are:

1. Prior to the use of any NWP in any of the following North Carolina *designated waters*, applicants must comply with Nationwide Permit General Condition 13. In addition, the applicant must furnish a written statement of compliance with all of the conditions of the applicable Nationwide Permit. The North Carolina *designated waters* that require additional notification requirements are "Outstanding Resource Waters" (ORW) and "High Quality Waters" (HQW) (as defined by the North Carolina Division of Water Quality), or "Inland Primary Nursery Areas" (IPNA) (as defined by the North Carolina Wildlife Resources Commission), or contiguous wetlands (as defined by the North Carolina Division of Water Quality), or "Primary Nursery Areas" (PNA) (as defined by the North Carolina Division of Marine Fisheries).

2. Applicants for any NWP in a designated "Area of Environmental Concern" (AEC) in the twenty (20) coastal counties of Eastern North Carolina covered by the North Carolina Coastal Area Management Act (CAMA), must also obtain the required CAMA permit. Construction activities may not commence until a copy of the approved CAMA permit is furnished to the appropriate Wilmington District Regulatory Field Office (Wilmington Field Office – P.O. Box 1890, Wilmington, NC 28402 or Washington Field Office – P.O. Box 1000, Washington, NC 27889) for authorization to begin work.

3. Prior to the use of any NWP on a Barrier Island of North Carolina, applicants must comply with Nationwide Permit General Condition 13. In addition, the applicant shall furnish a written statement of compliance with all of the conditions listed of the applicable Nationwide Permit.

4. Prior to the use of any NWP in a "Mountain or Piedmont Bog" of North Carolina, applicants shall comply with Nationwide Permit General Condition 13. In addition, the applicant shall furnish a written statement of compliance with all of the conditions listed of the applicable NWP.

Note: The following wetland community types identified in the N.C. Natural Heritage Program document, "Classification of Natural communities of North Carolina (Michael P. Schafale and Alan S. Weakley, 1990), are subject to this regional condition.

Mountain Bogs

Swamp Forest-Bog Complex  
 Swamp Forest-Bog Complex (Spruce Subtype)  
 Southern Appalachian Bog (Northern Subtype)  
 Southern Appalachian Bog (Southern Subtype)  
 Southern Appalachian Fen

Piedmont Bogs

Upland Depression Swamp Forest

5. Prior to the use of any NWP in Mountain Trout Waters within twenty-five (25) designated counties of North Carolina, applicants shall comply with Nationwide General Condition 13. In addition, the applicant shall furnish a written statement of compliance with all of the conditions listed of the applicable NWP. Notification will include a letter of comments and recommendations from the North Carolina Wildlife Resources Commission (NCWRC), the location of work, a delineation of wetlands, a discussion of alternatives to working in the Mountain Trout Waters, why other alternatives were not selected, and a plan to provide compensatory mitigation for all unavoidable adverse impacts to the Mountain Trout Waters. To facilitate coordination with the NCWRC, the proponent may provide a copy of the notification to the NCWRC concurrent with the notification to the District Engineer. The NCWRC will respond both to the proponent and directly to the Corps of Engineers.

The twenty-five (25) designated counties are:

Alleghany	Ashe	Avery	Yancey
Buncombe	Burke	Caldwell	Wilkes
Cherokee	Clay	Graham	Swain
Haywood	Henderson	Jackson	Surry
Macon	Madison	McDowell	Stokes
Mitchell	Polk	Rutherford	
Transylvania	Watauga		

6. Applicants shall notify the NCDENR Shellfish Sanitation Section prior to dredging in or removing sediment from an area closed to shell fishing where the effluent may be released to an area open for shell fishing or swimming in order to avoid contamination of the disposal area and allow a temporary shellfish closure to be made. Any disposal of sand to the beach should occur between November 1 and April 30 when recreational usage is low. Only clean sand should be used and no dredged sand from closed shell fishing areas. If beach disposal was to occur at times other than stated above or if sand from a closed shell fishing area is to be used, a swim advisory shall be posted and a press release shall be made. NCDENR Shellfish Sanitation Section must be notified before commencing this activity.

## 2. List of Final Corps Regional Modifications and Conditions for All Nationwide Permits

a. Individual or multiple NWP's may not be used for activities that result in the cumulative loss or degradation of greater than 300 total linear feet of perennial streambed or intermittent streambed that exhibits important aquatic function(s).

b. Prior to the use of any NWP (except 13, 27, and 39) for any activity that has more than a total of 150 total linear feet of perennial streambed impacts or intermittent streambed impacts (if the intermittent stream has important aquatic function), the applicant must comply with Nationwide Permit General Condition 13. In addition, the applicant shall furnish a written statement of compliance with all of the conditions listed of the applicable NWP. Compensatory mitigation is typically required for any impact that requires such notification. [Note: The Corps uses the Intermittent Channel Evaluation Form, located with Permit Information on the Regulatory Program Web Site, to aid in the determination of the intermittent channel stream status. Also, NWP's 13, 27 and 39 have specific reporting requirements.]

c. For all Nationwide Permits which allow the use of concrete as a building material, measures will be taken to prevent live or fresh concrete, including bags of uncured concrete, from coming into contact with waters of the state until the concrete has hardened.

d. For all Nationwide Permits that allow for the use of riprap material for bank stabilization, filter cloth must be placed underneath the riprap as an additional requirement of its use in North Carolina waters.

e. For all NWP's that involve the construction of culverts, measures will be included in the construction that will promote the safe passage of fish and other aquatic organisms. All culverts in the 20 CAMA coastal counties must be buried to a depth of one foot below the

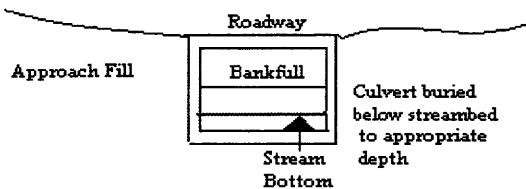

bed of the stream or wetland. For all culvert construction activities, the dimension, pattern, and profile of the stream, (above and below a pipe or culvert), should not be modified by widening the stream channel or by reducing the depth of the stream. Culvert inverts will be buried at least one foot below the bed of the stream for culverts greater than 48 inches in diameter. For culverts 48 inches in diameter or smaller, culverts must be buried below the bed of the stream to a depth equal to or greater than 20 percent of the diameter of the culvert. Bottomless arch culverts will satisfy this condition. A waiver from the depth specifications in this Regional Condition may be requested in writing. The waiver will only be issued if it can be demonstrated that the impacts of complying with this Regional Condition would result in more adverse impacts to the aquatic environment.

### 3. Additional Regional Conditions Applicable to this Specific Nationwide Permit.

a. Natural channel design must be applied to the maximum extent practicable for stream relocations. The N.C. Wildlife Resources Commission and the N.C. Division of Water Quality provides Guidelines that are available to assist in the planning and design.

b. Bank-full flows (or less) shall be accommodated through maintenance of the

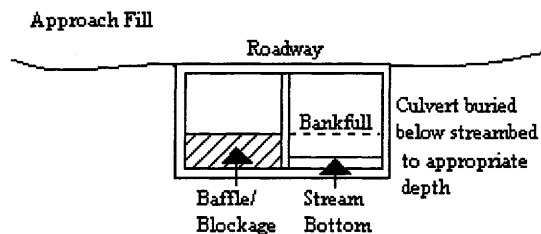

existing bank-full channel cross sectional area. Additional culverts at such crossings shall be allowed only to receive flows exceeding bank-full.

c. Flows exceeding bank-full shall be accommodated by installing culverts at the floodplain elevation where adjacent floodplain is available.

d. NWP 14 cannot be used for private projects located in tidal waters or tidal wetlands.

e. The activities associated with NWP 14 require a pre-construction notification if they will result in the loss of greater than 150 total linear feet of perennial streambed or intermittent stream that exhibits important aquatic function(s).

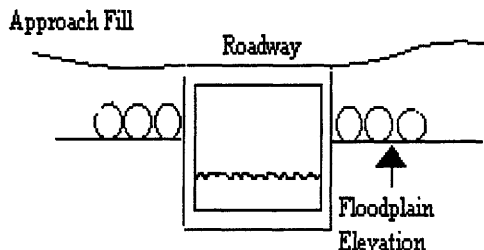

## NORTH CAROLINA DIVISION OF WATER QUALITY GENERAL CERTIFICATION CONDITIONS

GC3375

### 1. Enumerating and Reporting of Impacts:

a. Streams - Impacts to streams as determined by the Division of Water Quality shall be measured as length of the centerline of the normal flow channel. Permanent and/or temporary



stream impacts shall be enumerated on the entire project for all impacts regardless of which 404 Nationwide Permits are used. Stream relocations and streambed and/or bank hardening are considered to be permanent stream impacts. Any activity that results in a loss of use of stream functions including but not limited to filling, relocating, flooding, dredging and complete shading shall be considered stream impacts. Enumeration of impacts to streams shall include streams enclosed by bottomless culverts, bottomless arches or other spanning structures when a 404 Permit is used anywhere in a project unless the entire structure (including construction impacts) spans the entire bed and both banks of the stream, is only used for a road, driveway or path crossing, and is not mitered to follow the stream pattern. Impacts for dam footprints and flooding will count toward the threshold for stream impacts, but flooding upstream of the dam will not (as long as no filling, excavation, relocation or other modification of the existing stream dimension, pattern or profile occurs) count towards mitigation.

b. Wetlands - Impacts to wetlands as determined by the Division of Water Quality shall be measured as area. Permanent and/or temporary wetland impacts shall be enumerated on the entire project for all impacts regardless of which 404 Nationwide Permits are used. Any activity that results in a loss of use of wetland functions including but not limited to filling, draining, and flooding shall be considered wetland impacts. Enumeration of impacts to wetlands shall include activities that change the hydrology of a wetland when a 404 Permit is used anywhere in a project.

c. Lakes and Ponds – Lake and Pond Impacts Enumeration- Impacts to waters other than streams and wetlands as determined by the Division of Water Quality shall be measured as area. Permanent and/or temporary water impacts shall be enumerated on the entire project for all impacts proposed regardless of which 404 Nationwide Permits are used. Any activity that results in a loss of use of aquatic functions including but not limited to filling and dredging shall be considered waters impacts;

2. Proposed fill or substantial modification of wetlands or waters (including streams) under this General Certification requires application to and prior written concurrence from the Division of Water Quality;

3. Impacts to any stream length in the Neuse, Tar-Pamlico or Randleman River Basins (or any other major river basins with Riparian Area Protection Rules [Buffer Rules] in effect at the time of application) requires written concurrence for this Certification from DWQ in accordance with 15A NCAC 2B.0200. Activities listed as “exempt” from these rules do not need to apply for written concurrence under this Certification. New development activities located in the protected 50-foot wide riparian areas (whether jurisdictional wetlands or not) within the Neuse and Tar-Pamlico River Basins shall be limited to “uses” identified within and constructed in accordance with 15A NCAC 2B .0200. All new development shall be located, designed, constructed, and maintained to have minimal disturbance to protect water quality to the maximum extent practicable through the use of best management practices;

4. Additional site-specific stormwater management requirements may be added to this Certification at DWQ's discretion on a case-by-case basis for projects that have or are anticipated

to have impervious cover of greater than 30 percent. Site-specific stormwater management shall be designed to remove 85% TSS according to the latest version of DWQ's Stormwater Best Management Practices manual at a minimum. Additionally, in watersheds within one mile and draining to 303(d) listed waters, as well as watersheds that are classified as nutrient sensitive waters (NSW), water supply waters (WS), trout waters (Tr), high quality waters (HQW), and outstanding resource waters (ORW), the Division shall require that extended detention wetlands, bio-retention areas, and ponds followed by forested filter strips (designed according to latest version of the NC DENR Stormwater Best Management Practices Manual) be constructed as part of the stormwater management plan when a site-specific stormwater management plan is required. Alternative designs may be requested by the applicant and will be reviewed on a case-by-case basis by the Division of Water Quality. Approval of stormwater management plans by the Division of Water Quality's other existing state stormwater programs including appropriate local programs are sufficient to satisfy this Condition as long as the stormwater management plans meet or exceed the design requirements specified in this condition. This condition applies unless more stringent requirements are in effect from other state water quality programs.

a. Unless specified otherwise in the approval letter, the final, written stormwater management plan shall be approved in writing by the Division of Water Quality's Wetlands Unit before the impacts specified in this Certification occur.

b. The facilities must be designed to treat the runoff from the entire project, unless otherwise explicitly approved by the Division of Water Quality.

c. Also, before any permanent building or other structure is occupied at the subject site, the facilities (as approved by the Wetlands Unit) shall be constructed and operational, and the stormwater management plan (as approved by the Wetlands Unit) shall be implemented.

d. The structural stormwater practices as approved by the Wetlands Unit as well as drainage patterns must be maintained in perpetuity.

e. No changes to the structural stormwater practices shall be made without written authorization from the Division of Water Quality.

5. Compensatory stream mitigation shall be required at a 1:1 ratio for all perennial and intermittent stream impacts equal to or exceeding 150 feet and that require application to DWQ in watersheds classified as ORW, HQW, Tr, WS-I and WS-II;

6. In accordance with North Carolina General Statute Section 143-215.3D(e), any application for a 401 Water Quality Certification must include the appropriate fee. If a project also requires a CAMA Permit, one payment to both agencies shall be submitted and will be the higher of the two fees;

7. In accordance with 15A NCAC 2H .0506 (h) compensatory mitigation may be required for impacts to 150 linear feet or more of streams and/or one acre or more of wetlands. For linear public transportation projects, impacts equal to or exceeding 150 feet per stream may require

mitigation. In addition, buffer mitigation may be required for any project with Buffer Rules in effect at the time of application for buffer impacts resulting from activities classified as "allowable with mitigation" within the "Table of Uses" section of the Buffer Rules or require a variance under the Buffer Rules. A determination of buffer, wetland and stream mitigation requirements shall be made for any Certification for this Nationwide Permit. The most current design and monitoring protocols from DWQ shall be followed and written plans submitted for DWQ approval as required in those protocols. When compensatory mitigation is required for a project, the mitigation plans must be approved by DWQ in writing before the impacts approved by the Certification occur, unless otherwise specified in the approval letter. The mitigation plan must be implemented and/or constructed before any permanent building or structure on site is occupied. In the case of public road projects, the mitigation plan must be implemented before the road is opened to the traveling public. Projects may also be implemented once payment is made to a private mitigation bank or other in-lieu fee program, as specified in the written concurrence of 401 Certification for a project. Please note that if a stream relocation is conducted as a stream restoration as defined in *The Internal Technical Guide for Stream Work in North Carolina*, April 2001, the restored length can be used as compensatory mitigation for the impacts resulting from the relocation;

8. For any project involving re-alignment of streams, a stream relocation plan must be included with the 401 application for written DWQ approval. Relocated stream designs should include the same dimensions, patterns and profiles as the existing channel, to the maximum extent practical. The new channel should be constructed in the dry and water shall not be turned into the new channel until the banks are stabilized. Vegetation used for bank stabilization shall be limited to native woody species, and should include establishment of a 30 foot wide wooded and an adjacent 20 foot wide vegetated buffer on both sides of the relocated channel to the maximum extent practical. A transitional phase incorporating coir fiber and seedling establishment is allowable. Also, riprap may be allowed if it is necessary to maintain the physical integrity of the stream, but the applicant must provide written justification and any calculations used to determine the extent of riprap coverage requested. If suitable stream mitigation is not practical on-site, then stream impact will need to be mitigated elsewhere;

9. Placement of culverts and other structures in waters, streams, and wetlands must be placed below the elevation of the streambed to allow low flow passage of water and aquatic life unless it can be shown to DWQ that providing passage would be impractical. Design and placement of culverts including open bottom or bottomless arch culverts and other structures including temporary erosion control measures shall not be conducted in a manner that may result in aggradation, degradation or significant changes in hydrology of wetlands or stream beds or banks, adjacent to or upstream and down stream of the above structures. The applicant is required to provide evidence that the equilibrium shall be maintained if requested to do so in writing by DWQ. Additionally, when roadways, causeways or other fill projects are constructed across FEMA-designated floodways or wetlands, openings such as culverts or bridges must be provided to maintain the natural hydrology of the system as well as prevent constriction of the floodway that may result in aggradation, degradation or significant changes in hydrology of streams or wetlands;

10. That appropriate sediment and erosion control practices which equal or exceed those outlined in the most recent version of the "North Carolina Sediment and Erosion Control Planning and Design Manual" or the "North Carolina Surface Mining Manual" whichever is more appropriate (available from the Division of Land Resources (DLR) in the DENR Regional or Central Offices) shall be in full compliance with all specifications governing the proper design, installation and operation and maintenance of such Best Management Practices in order to assure compliance with the appropriate turbidity water quality standard;
11. All sediment and erosion control measures placed in wetlands and waters shall be removed and the original grade restored within two months after the Division of Land Resources has released the project;
12. That additional site-specific conditions may be added to projects proposed under this Certification in order to ensure compliance with all applicable water quality and effluent standards;
13. Measures shall be taken to prevent live or fresh concrete from coming into contact with waters of the state until the concrete has hardened;
14. If an environmental document is required, this Certification is not valid until a Finding of No Significant Impact (FONSI) or Record of Decision (ROD) is issued by the State Clearinghouse;
15. If this Certification is used to access building sites, all lots owned by the applicant must be buildable without additional fill beyond that explicitly allowed under other General Certifications. For road construction purposes, this Certification shall only be utilized from natural high ground to natural high ground;
16. When written concurrence is required, the applicant is required to use the most recent version of the Certification of Completion form to notify DWQ when all work included in the 401 Certification has been completed;
17. Concurrence from DWQ that this Certification applies to an individual project shall expire three years from the date of the cover letter from DWQ or on the same day as the expiration date of the corresponding Nationwide Permit 14, whichever is sooner.

**NORTH CAROLINA DIVISION OF COASTAL MANAGEMENT**  
**STATE CONSISTENCY**

Consistent.

Citations:

2002 Nationwide Permits - Federal Register Notice 15 Jan 2002  
2002 Nationwide Permits Corrections - Federal Register Notice 13 Feb 2002  
2002 Regional Conditions – Authorized 17 May 2002



STATE OF NORTH CAROLINA  
DEPARTMENT OF TRANSPORTATION

MICHAEL F. EASLEY  
GOVERNOR

DIVISION OF HIGHWAYS

W. LYNDY TIPPETT  
SECRETARY

June 28, 2006

North Carolina Division of Water Quality  
401 Wetlands Certification Unit  
2321 Crabtree Boulevard  
Raleigh, NC 27604-2260

Subject: NC Moving Ahead Project No. MA10121R (Section B), Union County.  
**WBS Element No. 37687 (DWQ Minor Permit Fee \$200.00).**

Dear Sir or Madam:

The North Carolina Department of Transportation (NCDOT) proposes to widen SR 1501 (Secret Shortcut Road) from its intersection with SR 1504 (Rocky River Road) to US 74 by two feet, on the north side of the existing roadway, as part of the North Carolina Moving Ahead program. The total project length is 4.4 miles.

### **Protected Species**

The subject project has been reviewed for the presence of listed threatened and endangered species. It has been determined that the construction of this project will have no effect on any federally listed plant or animal species.

### **Impacts to Waters of the United States**

This project cannot be completed without impacts to waters of the United States. The project is located within the Yadkin River Basin (Hydrologic Unit # 03040105), affecting the drainage of unnamed tributaries to Stewarts Creek. There will be approximately 12 linear feet of permanent impacts to the existing stream channels as a result of the proposed construction. There are no wetland impacts that will result from the construction of this project.

### Stream Impacts

There will be two stream impacts as a result of this project being constructed. Table 1 includes information related to site number, stream name, existing pipe length (ft), existing pipe width (in), proposed replacement or extended pipe length (ft) and width (in).



**Table 1. Impacts to Streams due to the construction of MA10121R (Section B)**

Site No.	Stream Name	Existing Length (feet)	Existing Width (inches)	Proposed Length (feet)	Proposed Width (inches)
470+31	UT to Stewarts Creek	46' RCP	24"	50'	24"
475+81	UT to Stewarts Creek	34' RCP	15"	48'	15"

Note: "UT" refers to unnamed tributary.

The NCDOT believes that the pipe replacement can be authorized under a Section 404 Nationwide Permit 14.

### **Avoidance/Minimization**

Any wetlands or surface waters not affected by the project will be protected from unnecessary encroachment. No staging of construction equipment or storage of construction supplies will be allowed in or near jurisdictional areas.

Sediment and erosion control Best Management Practices for the protection of wetlands and surface waters will be enforced during project construction. Continued coordination will occur between maintenance forces and the Division Environmental Officer during construction in an effort to minimize impacts to jurisdictional sites.

### **Summary**

The purpose of this letter is to request authorization to construct the proposed project under a Section 401 Water Quality Certificate (WQC) No. GC3404. Enclosed you will find seven copies of the pre-construction notification form.

If you have any questions or need any additional information concerning this project, please feel free to contact Larry Thompson, Division Environmental Supervisor, at (704) 982-0101.

Sincerely,



Barry S. Moose, PE  
Division Engineer

BGP/LBT

Enclosures

cc: Polly Lespinesse, NCDWQ  
Marella Buncick, USFWS  
Marla Chambers, NCWRC  
Larry Thompson, DES  
Phil Suggs, REFOE  
File

SR 1501 (Secret Shortcut Road)  
Union County

Office Use Only:

Form Version March 05

USACE Action ID No. \_\_\_\_\_

DWQ No. \_\_\_\_\_

(If any particular item is not applicable to this project, please enter "Not Applicable" or "N/A".)

**I. Processing**

1. Check all of the approval(s) requested for this project:

- |   |  |
|---|--|
| <input checked="" type="checkbox"/> Section 404 Permit              | <input type="checkbox"/> Riparian or Watershed Buffer Rules      |
| <input type="checkbox"/> Section 10 Permit                          | <input type="checkbox"/> Isolated Wetland Permit from DWQ        |
| <input checked="" type="checkbox"/> 401 Water Quality Certification | <input type="checkbox"/> Express 401 Water Quality Certification |

2. Nationwide, Regional or General Permit Number(s) Requested: Nationwide 14

3. If this notification is solely a courtesy copy because written approval for the 401 Certification is not required, check here:

4. If payment into the North Carolina Ecosystem Enhancement Program (NCEEP) is proposed for mitigation of impacts, attach the acceptance letter from NCEEP, complete section VIII, and check here:

5. If your project is located in any of North Carolina's twenty coastal counties (listed on page 4), and the project is within a North Carolina Division of Coastal Management Area of Environmental Concern (see the top of page 2 for further details), check here:

**II. Applicant Information**

1. Owner/Applicant Information

Name: N.C. Department of Transportation

Mailing Address: 10<sup>th</sup> Highway Division

716 West Main Street

Albemarle N.C. 28001

Telephone Number: (704) 982-0101 Fax Number: (704) 982-3146

E-mail Address: \_\_\_\_\_

2. Agent/Consultant Information (A signed and dated copy of the Agent Authorization letter must be attached if the Agent has signatory authority for the owner/applicant.)

Name: Barry Moose

Company Affiliation: N.C. Department of Transportation

Mailing Address: 10<sup>th</sup> Highway Division

716 West Main Street

Albemarle N.C. 28001

Telephone Number: (704) 982-0101 Fax Number: (704) 982-3146

E-mail Address: bmoose@dot.state.nc.us

SR 1501 (Secrest Shortcut Road)  
Union County

### III. Project Information

Attach a **vicinity map** clearly showing the location of the property with respect to local landmarks such as towns, rivers, and roads. Also provide a detailed **site plan** showing property boundaries and development plans in relation to surrounding properties. Both the vicinity map and site plan must include a scale and north arrow. The specific footprints of all buildings, impervious surfaces, or other facilities must be included. If possible, the maps and plans should include the appropriate USGS Topographic Quad Map and NRCS Soil Survey with the property boundaries outlined. Plan drawings, or other maps may be included at the applicant's discretion, so long as the property is clearly defined. For administrative and distribution purposes, the USACE requires information to be submitted on sheets no larger than 11 by 17-inch format; however, DWQ may accept paperwork of any size. DWQ prefers full-size construction drawings rather than a sequential sheet version of the full-size plans. If full-size plans are reduced to a small scale such that the final version is illegible, the applicant will be informed that the project has been placed on hold until decipherable maps are provided.

1. Name of project: SR 1501 (Secrest Shortcut Road)
2. T.I.P. Project Number or State Project Number (NCDOT Only): \_\_\_\_\_
3. Property Identification Number (Tax PIN): \_\_\_\_\_
4. Location  
 County: Union County Nearest Town: Monroe  
 Subdivision name (include phase/lot number): \_\_\_\_\_  
 Directions to site (include road numbers/names, landmarks, etc.): From the intersection of US 74 and US 601 travel .6 miles west on US 74 to the intersection of US 74 and SR 1501 (Secrest Shortcut Road), turn right onto Secrest Shortcut Road. The project begins at SR 1514 (Rocky River Road) and Secrest Shortcut Road and ends at the intersection of US 74 and Secrest Shortcut Road.
5. Site coordinates (For linear projects, such as a road or utility line, attach a sheet that separately lists the coordinates for each crossing of a distinct waterbody.)  
 Decimal Degrees (6 digits minimum): 34° 59' 54.90" N 80° 32' 53.00" W
6. Property size (acres): NA
7. Name of nearest receiving body of water: Stewarts Creek
8. River Basin: Yadkin (Hydrologic Unit 03040105)  
 (Note – this must be one of North Carolina's seventeen designated major river basins. The River Basin map is available at <http://h2o.enr.state.nc.us/admin/maps/>.)
9. Describe the existing conditions on the site and general land use in the vicinity of the project at the time of this application: Secrest Shortcut Road is a secondary road in Union County that has experienced a significant increase in traffic volume as well as accident rates over the



SR 1501 (Secret Shortcut Road)  
Union County

past three years. The land use is mixed with both residential and commercial properties located along the project. The largest land use is for single family residences.

10. Describe the overall project in detail, including the type of equipment to be used: The proposed project involves the widening and resurfacing of Secret Shortcut Road. The widening will be limited to two feet on the northeast side of the road. The total project length is 4.4 miles. There are two perennial stream crossing that will be impacted by the proposed widening. The first crossing is located at 470+31 (4 feet of impacts) and the second at Sta. 475+81 (8 feet of impacts). The proposed work will be completed utilizing typical construction equipment such as a track hoe, dump truck, paving machine and roller. Erosion and sediment control devices will be installed accordingly.
11. Explain the purpose of the proposed work: The purpose of the proposed work is to improve the safety of SR 1501 between Rocky River Road and US 74 by increasing the pavement width and driver recovery area.

#### **IV. Prior Project History**

If jurisdictional determinations and/or permits have been requested and/or obtained for this project (including all prior phases of the same subdivision) in the past, please explain. Include the USACE Action ID Number, DWQ Project Number, application date, and date permits and certifications were issued or withdrawn. Provide photocopies of previously issued permits, certifications or other useful information. Describe previously approved wetland, stream and buffer impacts, along with associated mitigation (where applicable). If this is a NCDOT project, list and describe permits issued for prior segments of the same T.I.P. project, along with construction schedules. N/A

#### **V. Future Project Plans**

Are any future permit requests anticipated for this project? If so, describe the anticipated work, and provide justification for the exclusion of this work from the current application. There are no future permit requests anticipated for this project.

#### **VI. Proposed Impacts to Waters of the United States/Waters of the State**

It is the applicant's (or agent's) responsibility to determine, delineate and map all impacts to wetlands, open water, and stream channels associated with the project. Each impact must be listed separately in the tables below (e.g., culvert installation should be listed separately from riprap dissipater pads). Be sure to indicate if an impact is temporary. All proposed impacts, permanent and temporary, must be listed, and must be labeled and clearly identifiable on an accompanying site plan. All wetlands and waters, and all streams (intermittent and perennial) should be shown on a delineation map, whether or not impacts are proposed to these systems. Wetland and stream evaluation and delineation forms should be included as appropriate. Photographs may be included at the applicant's discretion. If this proposed impact is strictly for

wetland or stream mitigation, list and describe the impact in Section VIII below. If additional space is needed for listing or description, please attach a separate sheet.

1. Provide a written description of the proposed impacts: There will be 12 feet of permanent impacts associated with this project.
2. Individually list wetland impacts. Types of impacts include, but are not limited to mechanized clearing, grading, fill, excavation, flooding, ditching/drainage, etc. For dams, separately list impacts due to both structure and flooding.

Wetland Impact Site Number (indicate on map)	Type of Impact	Type of Wetland (e.g., forested, marsh, herbaceous, bog, etc.)	Located within 100-year Floodplain (yes/no)	Distance to Nearest Stream (linear feet)	Area of Impact (acres)
Total Wetland Impact (acres)					

3. List the total acreage (estimated) of all existing wetlands on the property: N/A
4. Individually list all intermittent and perennial stream impacts. Be sure to identify temporary impacts. Stream impacts include, but are not limited to placement of fill or culverts, dam construction, flooding, relocation, stabilization activities (e.g., cement walls, rip-rap, crib walls, gabions, etc.), excavation, ditching/straightening, etc. If stream relocation is proposed, plans and profiles showing the linear footprint for both the original and relocated streams must be included. To calculate acreage, multiply length X width, then divide by 43,560.

Stream Impact Number (indicate on map)	Stream Name	Type of Impact	Perennial or Intermittent?	Average Stream Width Before Impact	Impact Length (linear feet)	Area of Impact (acres)
470+31	UT to Stewart's Creek	RCP Extension	Perennial	2.0	4'	.0001
475+81	UT to Stewart's Creek	RCP Extension	Perennial	1.5	8'	.0003
Total Stream Impact (by length and acreage)						.0004

SR 1501 (Secret Shortcut Road)  
Union County

5. Individually list all open water impacts (including lakes, ponds, estuaries, sounds, Atlantic Ocean and any other water of the U.S.). Open water impacts include, but are not limited to fill, excavation, dredging, flooding, drainage, bulkheads, etc

Open Water Impact Site Number (indicate on map)	Name of Waterbody (if applicable)	Type of Impact	Type of Waterbody (lake, pond, estuary, sound, bay, ocean, etc.)	Area of Impact (acres)
				N/A
Total Open Water Impact (acres)				

6. List the cumulative impact to all Waters of the U.S. resulting from the project:

Stream Impact (acres):	.0004
Wetland Impact (acres):	N/A
Open Water Impact (acres):	N/A
Total Impact to Waters of the U.S. (acres)	.0004
Total Stream Impact (linear feet):	12

7. Isolated Waters

Do any isolated waters exist on the property?  Yes  No

Describe all impacts to isolated waters, and include the type of water (wetland or stream) and the size of the proposed impact (acres or linear feet). Please note that this section only applies to waters that have specifically been determined to be isolated by the USACE.

\_\_\_\_\_

\_\_\_\_\_

8. Pond Creation

If construction of a pond is proposed, associated wetland and stream impacts should be included above in the wetland and stream impact sections. Also, the proposed pond should be described here and illustrated on any maps included with this application.

Pond to be created in (check all that apply):  uplands  stream  wetlands

Describe the method of construction (e.g., dam/embankment, excavation, installation of draw-down valve or spillway, etc.): \_\_\_\_\_

Proposed use or purpose of pond (e.g., livestock watering, irrigation, aesthetic, trout pond, local stormwater requirement, etc.): \_\_\_\_\_

Current land use in the vicinity of the pond: \_\_\_\_\_

Size of watershed draining to pond: \_\_\_\_\_ Expected pond surface area: \_\_\_\_\_

**VII. Impact Justification (Avoidance and Minimization)**

Specifically describe measures taken to avoid the proposed impacts. It may be useful to provide information related to site constraints such as topography, building ordinances, accessibility, and financial viability of the project. The applicant may attach drawings of alternative, lower-impact site layouts, and explain why these design options were not feasible. Also discuss how impacts were minimized once the desired site plan was developed. If applicable, discuss construction techniques to be followed during construction to reduce impacts. The proposed widening has been limited to two feet and shifted to the northeast side of the road to avoid additional impacts. The staging of construction equipment will not be allowed in or near the streams and wetland located on this project. Strict enforcement of the sedimentation and erosion control best management practices for the protection of wetlands and surface waters will be enforced during all phases of project construction.

There is a large scour hole located at the outlet end of the pipe located at Sta. 470+31. The proposed pipe extension will eliminate most of the scour hole and any remnants of the hole will be filled in using the rock that has been pushed out in front of the existing pipe.

**VIII. Mitigation**

DWQ - In accordance with 15A NCAC 2H .0500, mitigation may be required by the NC Division of Water Quality for projects involving greater than or equal to one acre of impacts to freshwater wetlands or greater than or equal to 150 linear feet of total impacts to perennial streams.

USACE – In accordance with the Final Notice of Issuance and Modification of Nationwide Permits, published in the Federal Register on January 15, 2002, mitigation will be required when necessary to ensure that adverse effects to the aquatic environment are minimal. Factors including size and type of proposed impact and function and relative value of the impacted aquatic resource will be considered in determining acceptability of appropriate and practicable mitigation as proposed. Examples of mitigation that may be appropriate and practicable include, but are not limited to: reducing the size of the project; establishing and maintaining wetland and/or upland vegetated buffers to protect open waters such as streams; and replacing losses of aquatic resource functions and values by creating, restoring, enhancing, or preserving similar functions and values, preferable in the same watershed.

If mitigation is required for this project, a copy of the mitigation plan must be attached in order for USACE or DWQ to consider the application complete for processing. Any application lacking a required mitigation plan or NCEEP concurrence shall be placed on hold as incomplete. An applicant may also choose to review the current guidelines for stream restoration in DWQ's Draft Technical Guide for Stream Work in North Carolina, available at <http://h2o.enr.state.nc.us/ncwetlands/strmgide.html>.

1. Provide a brief description of the proposed mitigation plan. The description should provide as much information as possible, including, but not limited to: site location (attach directions and/or map, if offsite), affected stream and river basin, type and amount (acreage/linear feet)

SR 1501 (Secret Shortcut Road)  
Union County

of mitigation proposed (restoration, enhancement, creation, or preservation), a plan view, preservation mechanism (e.g., deed restrictions, conservation easement, etc.), and a description of the current site conditions and proposed method of construction. Please attach a separate sheet if more space is needed.

Any requests received for mitigation will be routed through the NC Ecosystem Enhancement Program.

2. Mitigation may also be made by payment into the North Carolina Ecosystem Enhancement Program (NCEEP). Please note it is the applicant's responsibility to contact the NCEEP at (919) 715-0476 to determine availability, and written approval from the NCEEP indicating that they are will to accept payment for the mitigation must be attached to this form. For additional information regarding the application process for the NCEEP, check the NCEEP website at <http://h2o.enr.state.nc.us/wrp/index.htm>. If use of the NCEEP is proposed, please check the appropriate box on page five and provide the following information:

Amount of stream mitigation requested (linear feet): \_\_\_\_\_  
 Amount of buffer mitigation requested (square feet): \_\_\_\_\_  
 Amount of Riparian wetland mitigation requested (acres): \_\_\_\_\_  
 Amount of Non-riparian wetland mitigation requested (acres): \_\_\_\_\_  
 Amount of Coastal wetland mitigation requested (acres): \_\_\_\_\_

**IX. Environmental Documentation (required by DWQ)**

1. Does the project involve an expenditure of public (federal/state/local) funds or the use of public (federal/state) land? Yes  No
2. If yes, does the project require preparation of an environmental document pursuant to the requirements of the National or North Carolina Environmental Policy Act (NEPA/SEPA)?  
 Note: If you are not sure whether a NEPA/SEPA document is required, call the SEPA coordinator at (919) 733-5083 to review current thresholds for environmental documentation.  
 Yes  No
3. If yes, has the document review been finalized by the State Clearinghouse? If so, please attach a copy of the NEPA or SEPA final approval letter. Yes  No

**X. Proposed Impacts on Riparian and Watershed Buffers (required by DWQ)**

It is the applicant's (or agent's) responsibility to determine, delineate and map all impacts to required state and local buffers associated with the project. The applicant must also provide justification for these impacts in Section VII above. All proposed impacts must be listed herein, and must be clearly identifiable on the accompanying site plan. All buffers must be shown on a map, whether or not impacts are proposed to the buffers. Correspondence from the DWQ Regional Office may be included as appropriate. Photographs may also be included at the applicant's discretion.

SR 1501 (Secrest Shortcut Road)  
Union County

1. Will the project impact protected riparian buffers identified within 15A NCAC 2B .0233 (Neuse), 15A NCAC 2B .0259 (Tar-Pamlico), 15A NCAC 02B .0243 (Catawba) 15A NCAC 2B .0250 (Randleman Rules and Water Supply Buffer Requirements), or other (please identify \_\_\_\_\_)? Yes  No
2. If "yes", identify the square feet and acreage of impact to each zone of the riparian buffers. If buffer mitigation is required calculate the required amount of mitigation by applying the buffer multipliers.

Zone*	Impact (square feet)	Multiplier	Required Mitigation
1		3 (2 for Catawba)	
2		1.5	
Total			

\* Zone 1 extends out 30 feet perpendicular from the top of the near bank of channel; Zone 2 extends an additional 20 feet from the edge of Zone 1.

3. If buffer mitigation is required, please discuss what type of mitigation is proposed (i.e., Donation of Property, Riparian Buffer Restoration / Enhancement, or Payment into the Riparian Buffer Restoration Fund). Please attach all appropriate information as identified within 15A NCAC 2B .0242 or .0244, or .0260. \_\_\_\_\_

**XI. Stormwater (required by DWQ)**

Describe impervious acreage (existing and proposed) versus total acreage on the site. Discuss stormwater controls proposed in order to protect surface waters and wetlands downstream from the property. If percent impervious surface exceeds 20%, please provide calculations demonstrating total proposed impervious level. \_\_\_\_\_  
The existing pavement width is 20 feet, with a proposed new width of 22 feet. There will an increase of 1.7 acres of impervious area as a result of this project being constructed.

**XII. Sewage Disposal (required by DWQ)**

Clearly detail the ultimate treatment methods and disposition (non-discharge or discharge) of wastewater generated from the proposed project, or available capacity of the subject facility. \_\_\_\_\_

**XIII. Violations (required by DWQ)**

Is this site in violation of DWQ Wetland Rules (15A NCAC 2H .0500) or any Buffer Rules?  
 Yes  No

Is this an after-the-fact permit application? Yes  No

SR 1501 (Secret Shortcut Road)  
Union County

**XIV. Cumulative Impacts (required by DWQ)**

Will this project (based on past and reasonably anticipated future impacts) result in additional development, which could impact nearby downstream water quality? Yes  No

If yes, please submit a qualitative or quantitative cumulative impact analysis in accordance with the most recent North Carolina Division of Water Quality policy posted on our website at <http://h2o.enr.state.nc.us/ncwetlands>. If no, please provide a short narrative description:

This project will have no direct affect on development

**XV. Other Circumstances (Optional):**

It is the applicant's responsibility to submit the application sufficiently in advance of desired construction dates to allow processing time for these permits. However, an applicant may choose to list constraints associated with construction or sequencing that may impose limits on work schedules (e.g., draw-down schedules for lakes, dates associated with Endangered and Threatened Species, accessibility problems, or other issues outside of the applicant's control).

*Bany S. Moore, Jr.*

7/13/06

**Applicant/Agent's Signature**

**Date**

(Agent's signature is valid only if an authorization letter from the applicant is provided.)

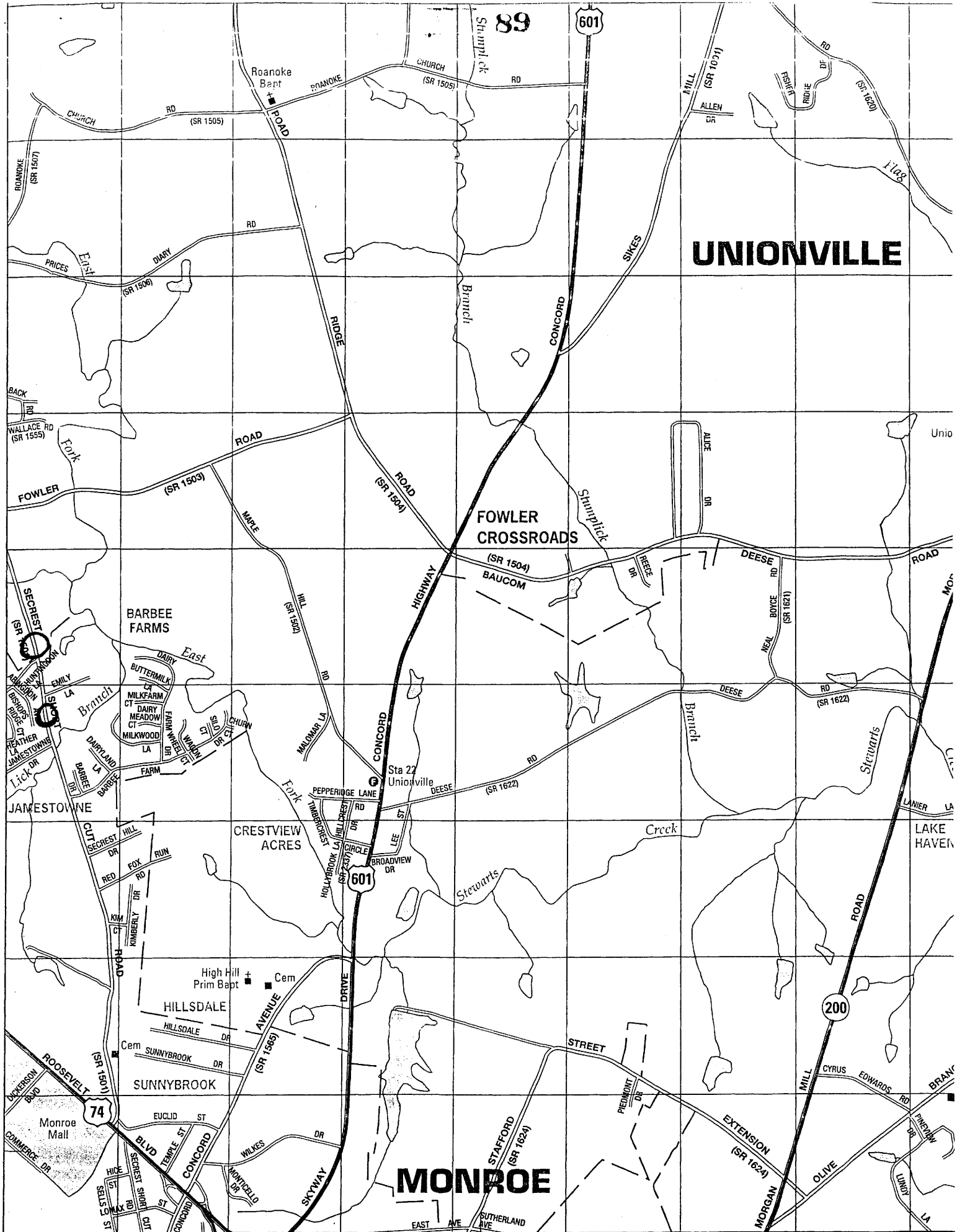

**UNIONVILLE**

**FOWLER CROSSROADS**

**MONROE**



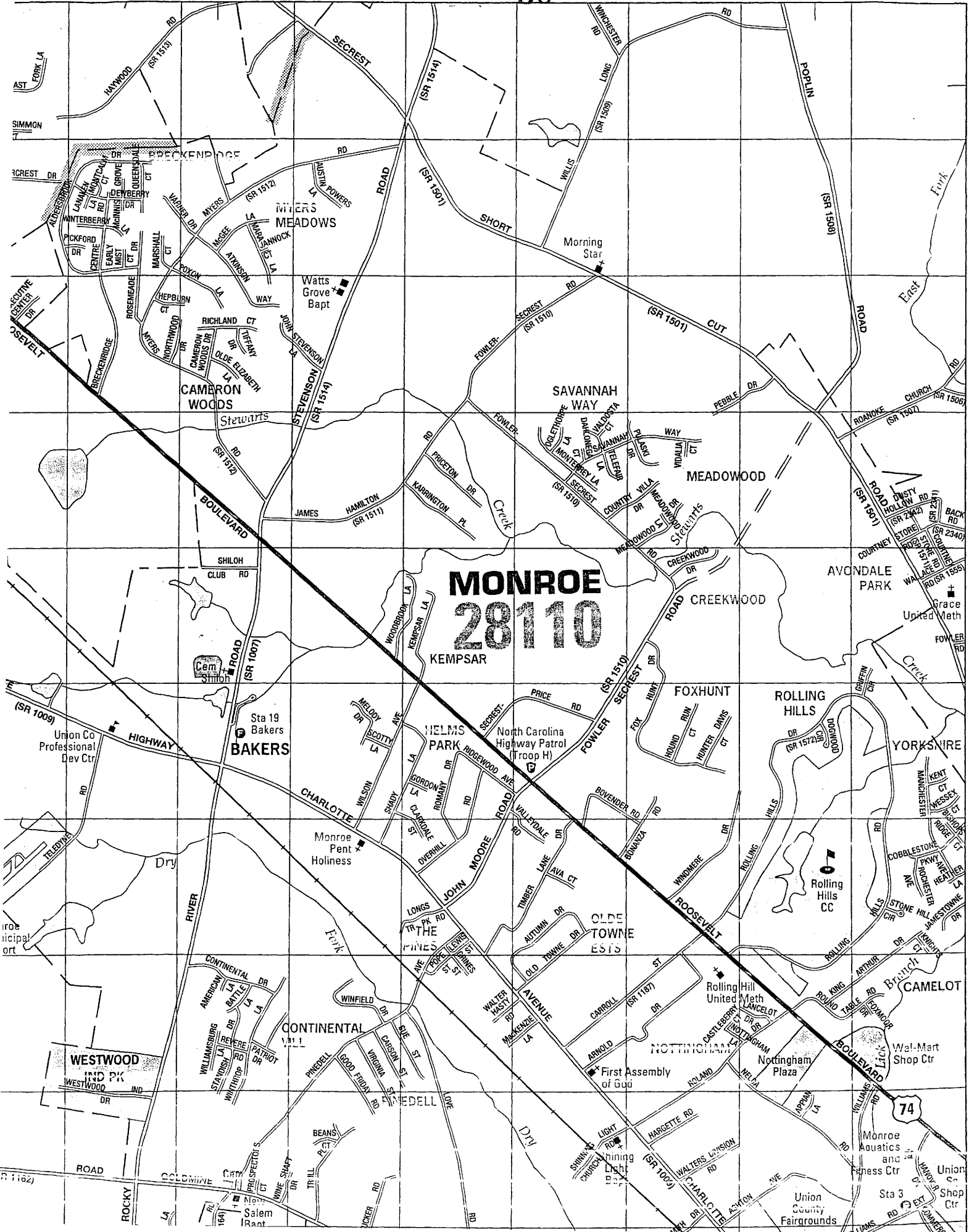

# MONROE 28110

KEMPSAR

BAKERS

CHARLOTTE

HELMS PARK

North Carolina Highway Patrol (Troop H)

FOXHUNT

ROLLING HILLS

YORKSHIRE

Rolling Hills CC

CAMELOT

WESTWOOD

CONTINENTAL

NOTTINGHAM

Nottingham Plaza

74

Monroe Aquatics and Fitness Ctr

Union County Fairgrounds

Sta 3

Union Shop Ctr

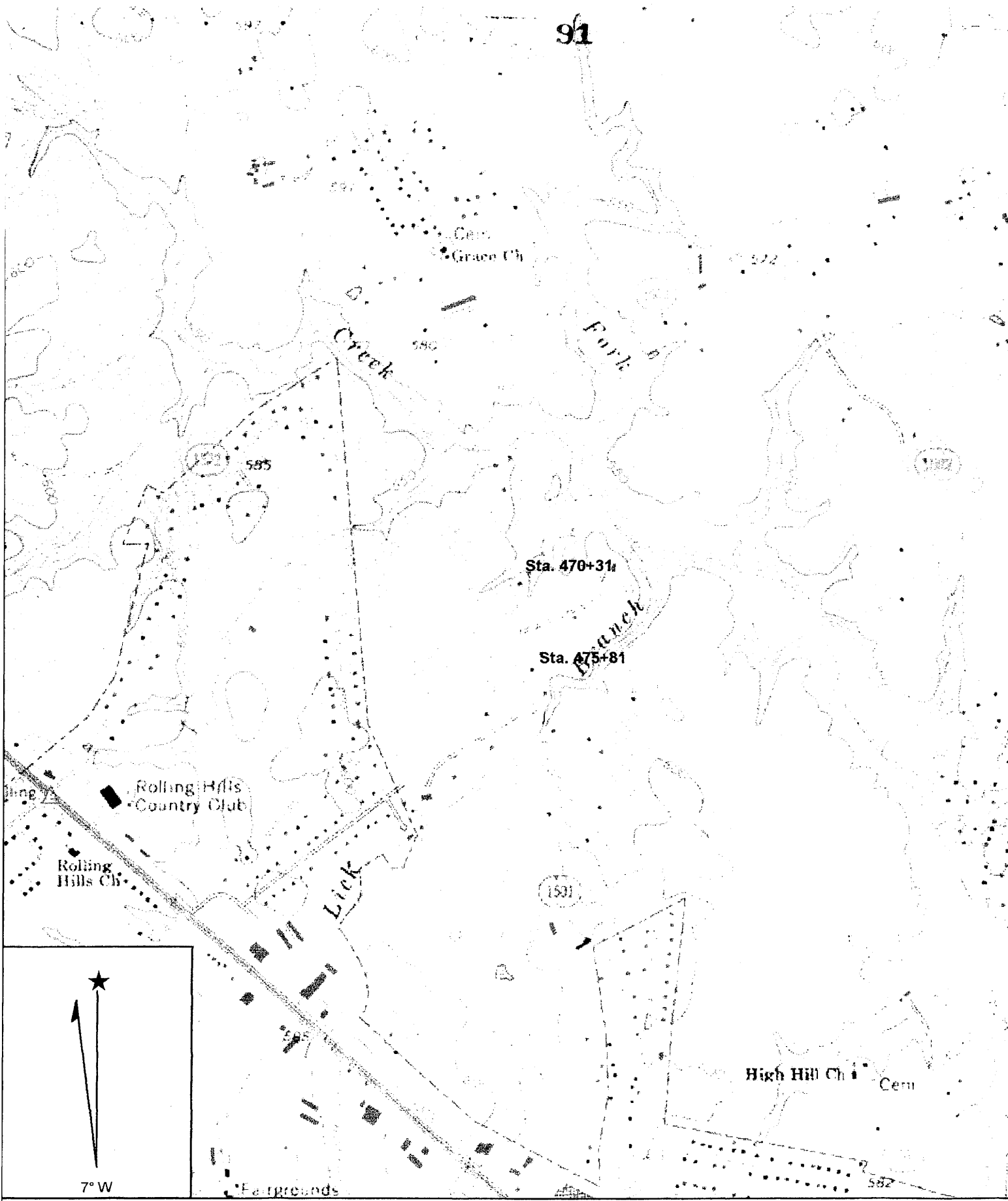

Name: BAKERS  
 Date: 7/3/2006  
 Scale: 1 inch equals 1333 feet

Location: 035° 01' 30.98" N 080° 33' 40.13" W  
 Caption: Union County  
 SR1501 (Secrest Shortcut Rd.)  
 MA 10121R

92

# Union County

## SR 1501 (Secret Shortcut Road)

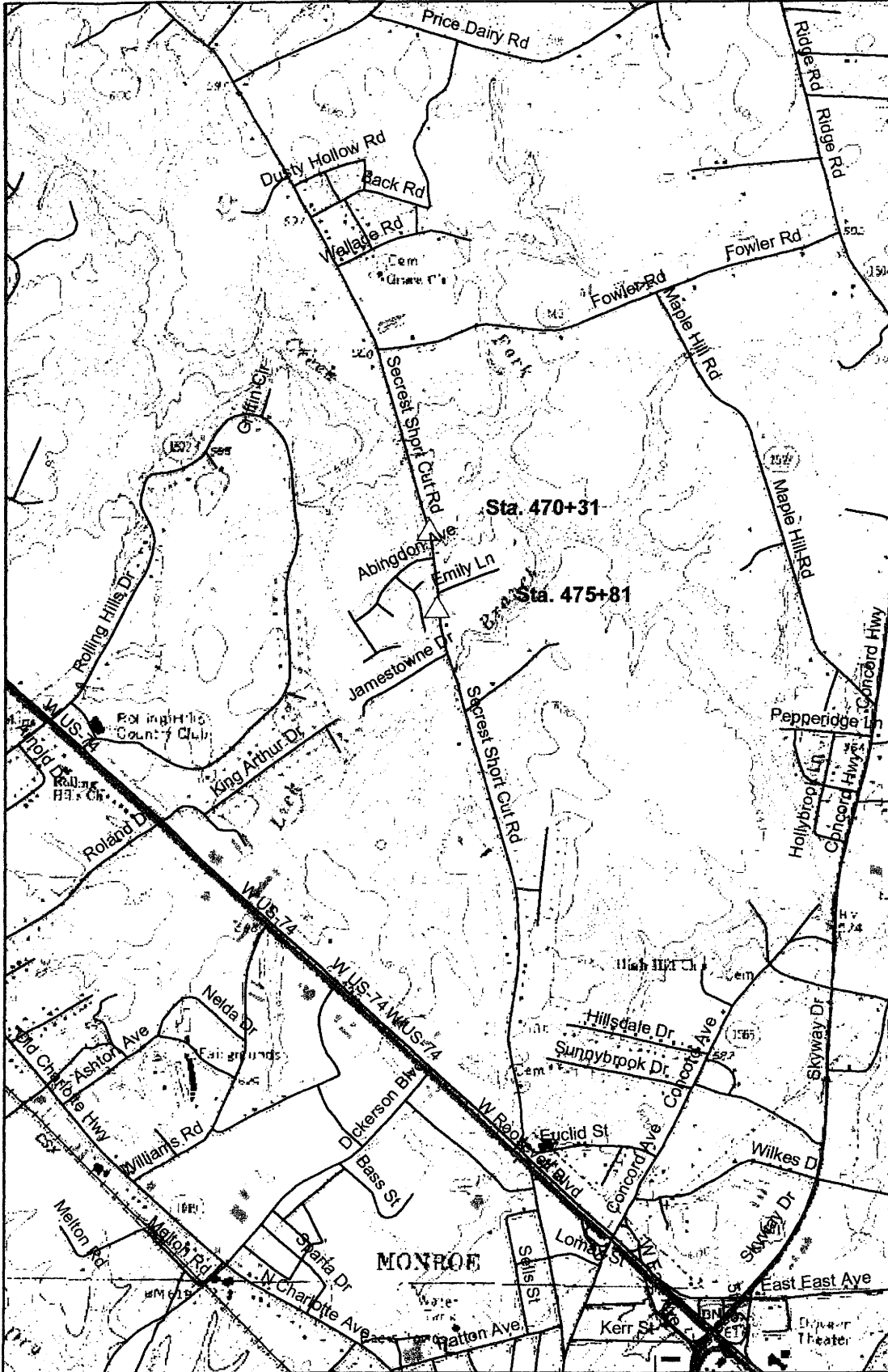

### Legend

△ permit site



Prepared by:  
 North Carolina  
 Department of Transportation  
 L. B. Thompson  
 Environmental Unit, Division 10  
 Date: December 2, 2005

This map is intended for internal DOT use only. For all other uses, no warranties of any sort, including accuracy, fitness, or merchantability accompany this product.

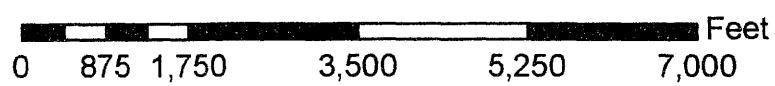

SR 1501 Secret Shortcut Road  
Union County

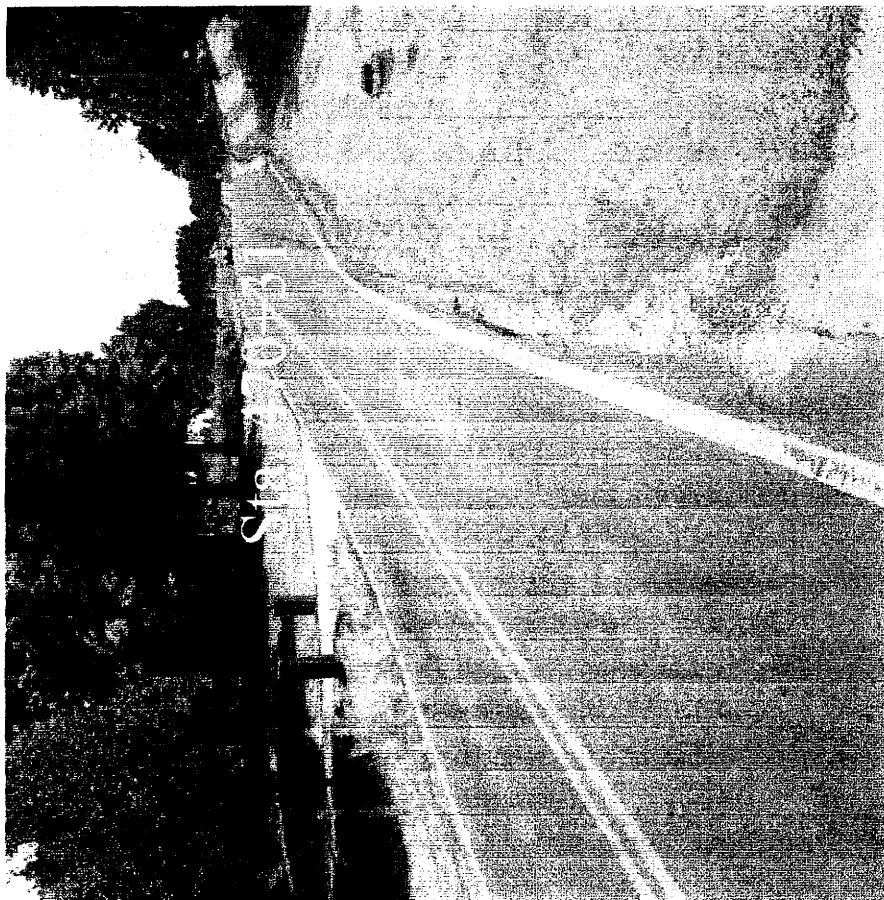

SR 1501 Secrest Shortcut Road  
Union County

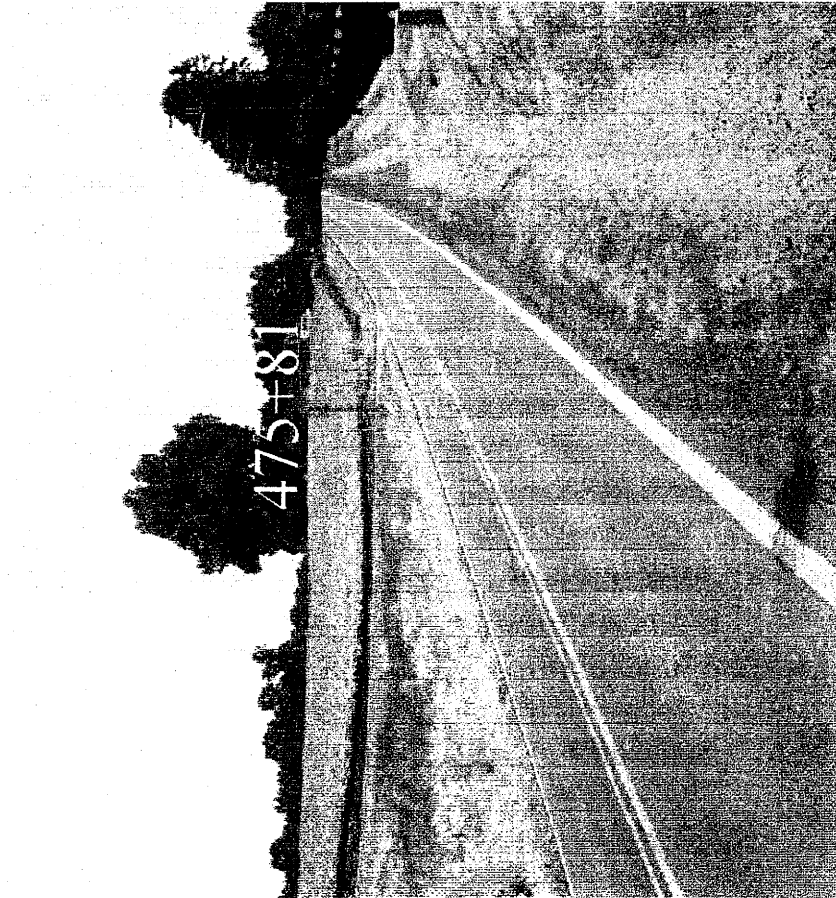
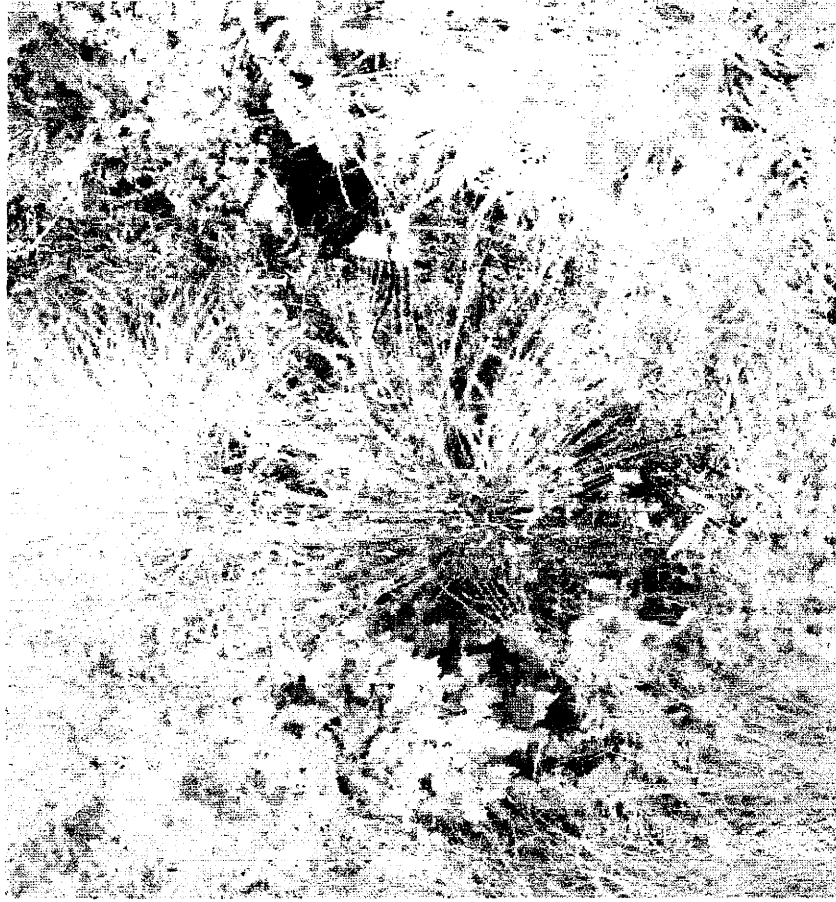



95

STATE OF NORTH CAROLINA  
DEPARTMENT OF TRANSPORTATION  
DIVISION OF HIGHWAYS

MICHAEL F. EASLEY  
GOVERNOR

W. LYNDO TIPPETT  
SECRETARY

July 25, 2006

Polly Lespinasse  
Dept. of Environment and Natural Resources  
Division of Water Quality  
610 East Center Avenue, Suite 301  
Mooresville, NC 28115

Subject: NC Moving Ahead Project No. MA10121R (Section B), SR 1501 (Secrest  
Shortcut Road from SR 1504 to US 74), Union County.

Dear Mrs. Lepinasse:

Per your request, we are providing additional information regarding the proposed pipe extension at Sta. 470+31 for the MA10121R project located on SR 1501 (Secrest Shortcut Road) in Union County.

The proposed pipe extension will be approximately .29 feet higher than the existing stream bed elevation. After extending the 24" x 46' RCP an additional 4 feet, we will remove any remnants of the existing scour hole by using the rip rap that is currently blocking the thalweg of the downstream channel. The stream bed elevation will be raised to that of the pipe. Any excess rip rap that is removed from the stream channel will be disposed of in a upland location.

If you have any questions or should you require any additional information concerning this project, please feel free to contact Larry Thompson, Division Environmental Supervisor, at (704) 982-0101.

Sincerely,

A handwritten signature in cursive script that reads "Barry S. Moose, PE".

Barry S. Moose, PE  
Division Engineer

BSM/LBT

Enclosures



96

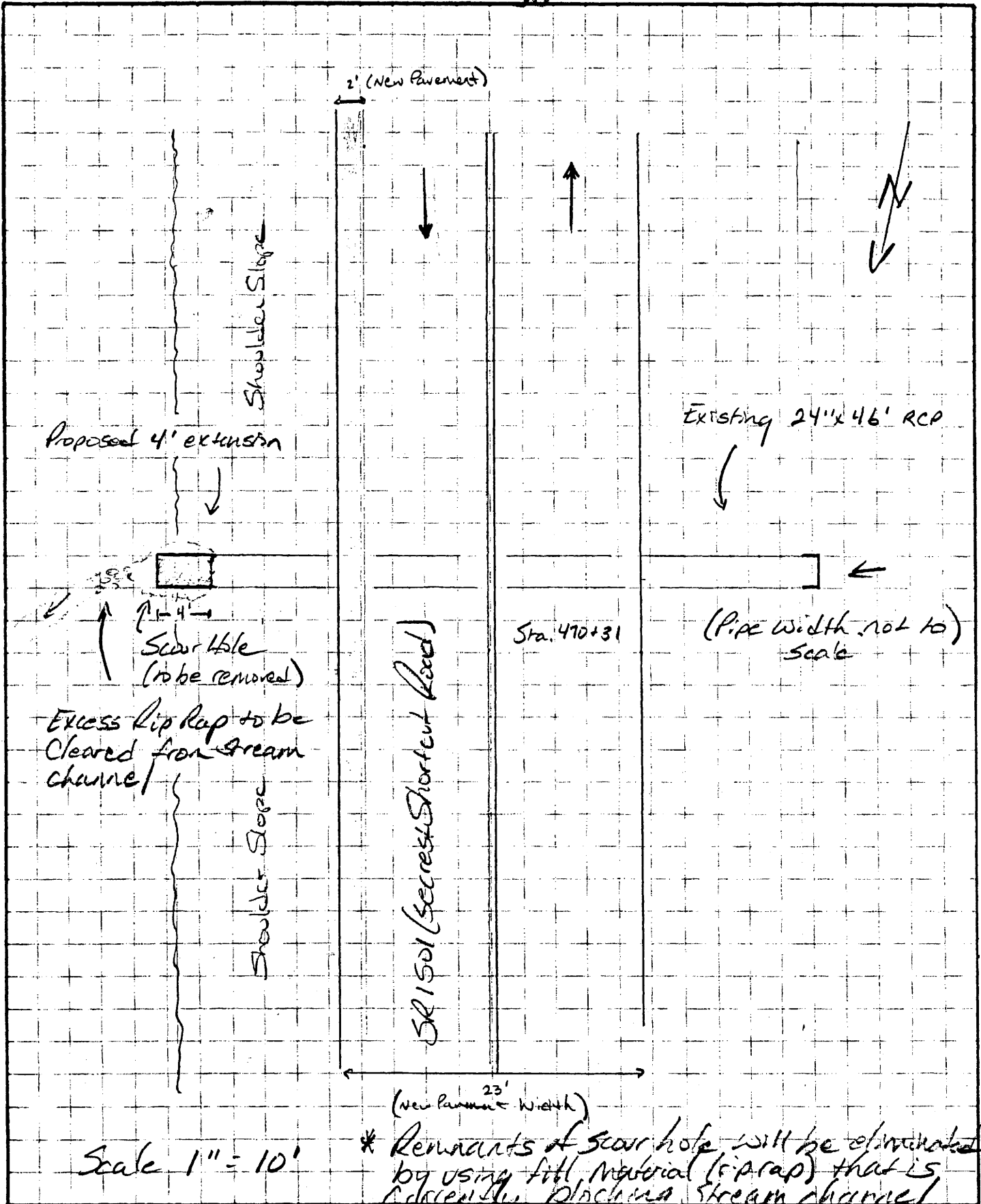

STATE	PROJECT NO.	SHEET NO.	TOT SHEET
M.C.	MA 10121R		
F.A. PROJECT NO.			

MA10121R PART B  
SECRET SHORTCUT RD. (SR 1501)  
FROM ROCKY RIVER RD. TO US 74

TYPICAL SECTION NO. 1

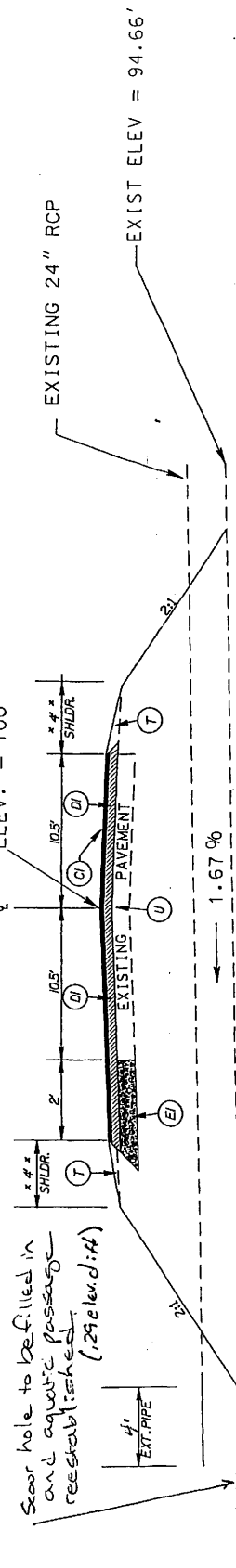

Scow hole to be filled in and aquatic passages reestablished. (29 elev. diff.)

PAVEMENT SCHEDULE

(C1)	PROP. APPROX. 1.5" ASPHALT CONC. SURFACE COURSE, TYPE S9.5C, AT AN AVERAGE RATE OF 168 LBS. PER SQ. YD.
(D1)	PROP. APPROX. 2.5" ASPHALT CONC. BINDER COURSE, TYPE I19.0C, AT AN AVERAGE RATE OF 285 LBS. PER SQ. YD.
(E1)	PROP. APPROX. 6" ASPHALT CONC. BASE COURSE, TYPE B25.0C, AT AN AVERAGE RATE OF 342 LBS. PER SQ. YD. IN EACH OF TWO LAYERS.
(T)	EARTH MATERIAL
(U)	EXISTING PAVEMENT

STA. 470+31

EXIST FLOWLINE = 93.91'  
FLOWLINE @ CREEK = 93.49'  
NEW PIPE INVERT = 93.78'

Flow will be reestablished to the center of channel by removing rip rap from a previous utility project.

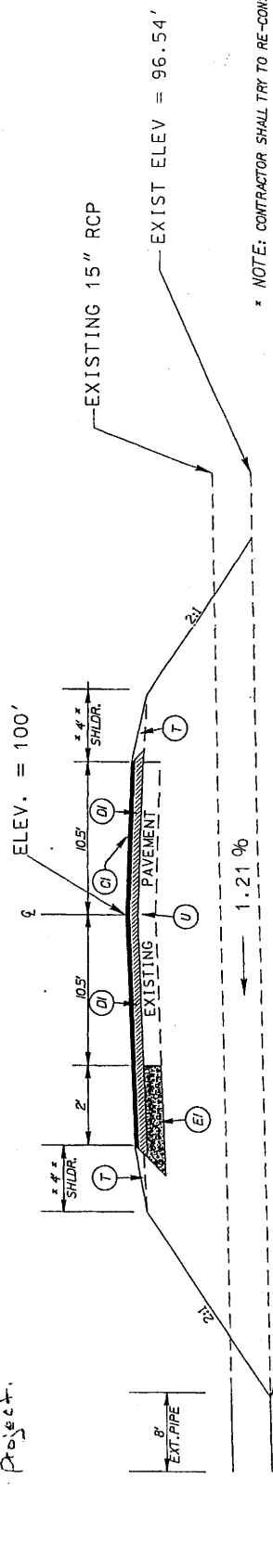

EXIST FLOWLINE = 96.14

STA. 475+81

FLOWLINE @ CREEK = 96.28'  
NEW PIPE INVERT = 96.04'

\* NOTE: CONTRACTOR SHALL TRY TO RE-CONSTRUCT 40' SHOULDER WHEN POSSIBLE.

SCALE	DATE	DESIGNED BY	CHECKED BY	APPROVED BY	REVISIONS

SECRET SHORTCUT RD. (SR 1501)  
IN UNION CO. (PART B)