

**STATE OF NORTH CAROLINA  
DEPARTMENT OF TRANSPORTATION**

**SIGNING PLANS  
PITT COUNTY**

**LOCATION: GREENVILLE - SR 1708 (FIRE TOWER ROAD) FROM WEST OF  
NC 11-903 TO EAST OF SR 1709 (COREY RD)**

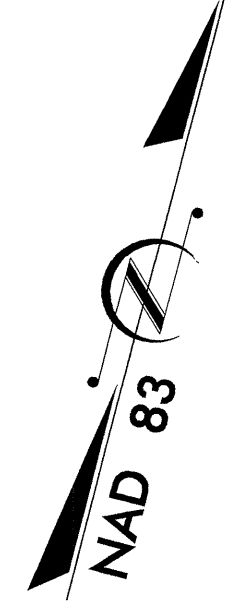

8/17/99

**CONTRACT: C201449 T.I.P.: U-3613B**

**END STATE SIGNING PROJECT  
U-3613B -L- STA. 151+70.00**

**BEGIN STATE SIGNING PROJECT  
U-3613B -L- STA. 11+98.70**

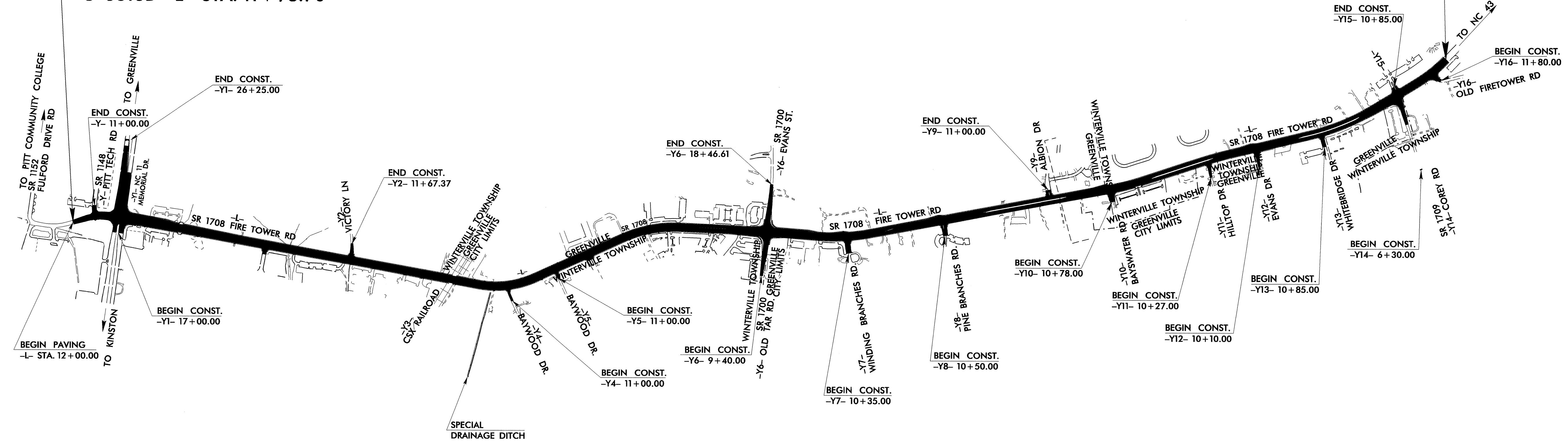

**INDEX**

SHEET NO.	DESCRIPTION
1	TITLE SHEET
2	SUMMARY OF QUANTITIES & NOTES
3	E & F SHEETS
4-10	SIGN ROADWAY SHEETS

PLAN PREPARED BY: N.C.D.O.T. SIGNING SECTION	SEAL
<p>_____ RON KING, P.E. SIGNING ENGINEER</p> <p>_____ AYMAN ALOUQWAH, P.E. SIGNING PROJECT ENGINEER</p> <p>_____ MITCH EATON SIGNING PROJECT DESIGN ENGINEER</p> <p>_____ STACEY JOHNS SIGNING DESIGNER</p>	



## SIGNS SUMMARY OF QUANTITIES

ITEM NO.		ITEM DESCRIPTION	QUANTITY	UNIT
DESC. NO.	SECT. NO.			
4072000000	903	SUPPORTS, 3 LB STEEL U-CHANNEL .....	927	L.F.
4096000000	904	SIGN ERECTION, TYPE D .....	3	EA.
4102000000	904	SIGN ERECTION, TYPE E .....	73	EA.
4108000000	904	SIGN ERECTION, TYPE F .....	5	EA.
4129000000	906	RELOCATE SIGN, TYPE E .....	2	EA.
4155000000	907	DISPOSAL OF SIGN SYSTEM, U-CHANNEL .....	41	EA.
4192000000	907	DISPOSAL OF SUPPORT, U-CHANNEL .....	2	EA.

**ROADWAY STANDARD DRAWINGS  
APPLICABLE TO THESE SIGNING PLANS**

904.10  
904.50

## NOTES

### Pay Item Notes:

- |   |                                     |
|---|-------------------------------------|
| 1 | RELOCATE SIGN, TYPE E               |
| 2 | DISPOSAL OF SIGN SYSTEM, U-CHANNEL  |
| 3 | DISPOSAL OF SIGN SUPPORT, U-CHANNEL |

### Project Notes:

ERECT RELOCATED SIGNS ON NEW U-CHANNEL POSTS.

### General Notes:

- . SIGNS FURNISHED BY STATE
- . ALL TYPE 'D' SIGNS SHALL BE MOUNTED ON TWO U-CHANNEL POSTS UNLESS OTHERWISE INDICATED ON THE PLANS.
- . IF REMOVAL OR RELOCATION OF SIGNS ON PRIVATE STREET (NON-STATE MAINTAINED) IS REQUIRED DUE TO CONSTRUCTION, THE CONTRACTOR SHALL INFORM THE ENGINEER. THE WORK WILL BE COMPLETED BY OTHERS.
- . SIGNING PLANS DO NOT INCLUDE TEMPORARY CONSTRUCTION SIGNING OR PAVEMENT MARKINGS. SEE TRAFFIC CONTROL PLANS.
- . WHEN NOT STATIONED OR DIMENSIONED ON PLANS, ALL 'E' AND 'F' SIGNS SHALL BE FIELD LOCATED BY THE ENGINEER
- . WHEN EXISTING SIGNS ARE REMOVED AND INSTALLED ON NEW SUPPORTS, THE RE-ERECTION SHALL IMMEDIATELY FOLLOW THE REMOVAL.
- . THE BACKGROUND FOR TYPE E & F SIGNS SHALL BE TYPE III REFLECTIVE SHEETING.

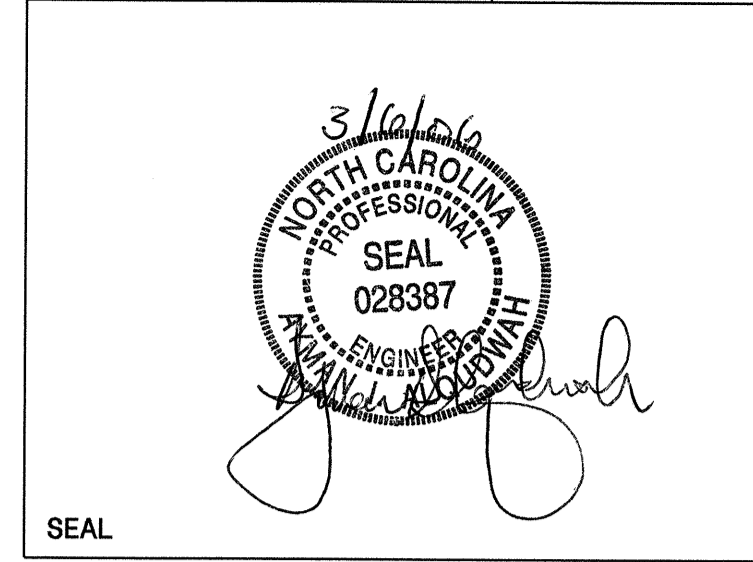

403 QUANTITY REQ'D 12

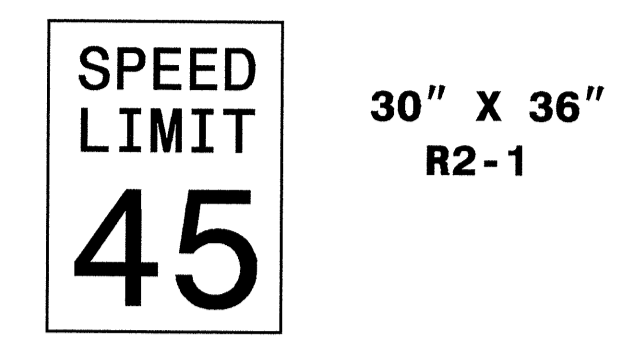

ONE "U" POST PER SIGN

454 QUANTITY REQ'D 2

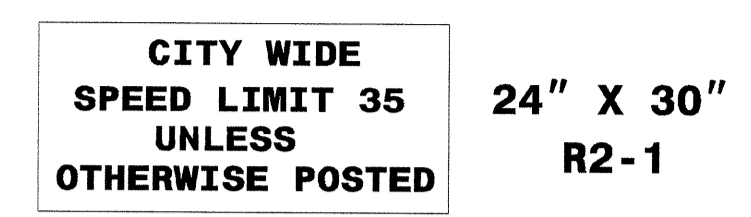

MOUNT BELOW SIGN 302 IN 1 INSTALLATIONS  
MOUNT BELOW SIGN 303 IN 1 INSTALLATIONS

466 QUANTITY REQ'D 2

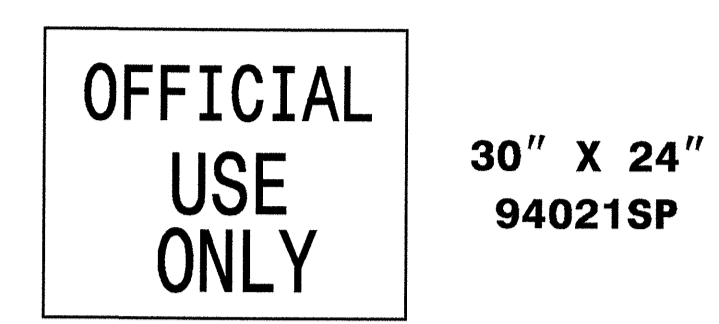

MOUNT BACK TO BACK ONE "U" POST

501 QUANTITY REQ'D 1

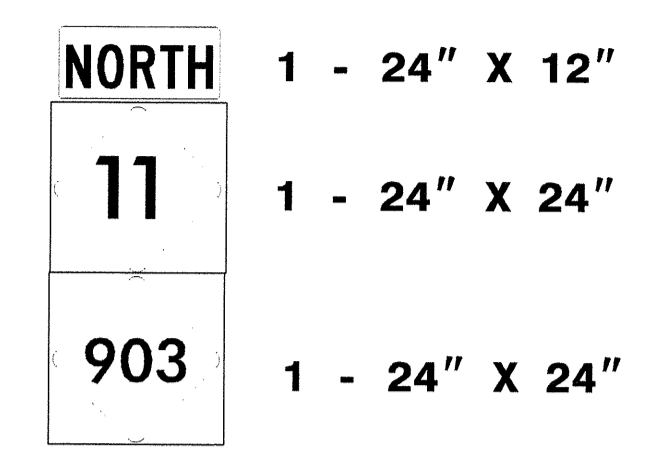

ONE "U" POST PER SIGN

404 QUANTITY REQ'D 1

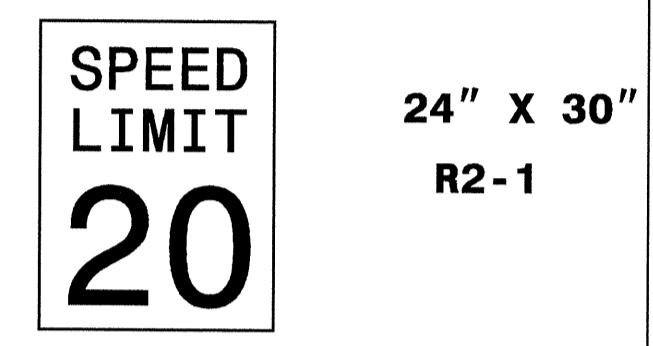

ONE "U" POST PER SIGN

462 QUANTITY REQ'D 2



ONE "U" POST PER SIGN

502 QUANTITY REQ'D 1

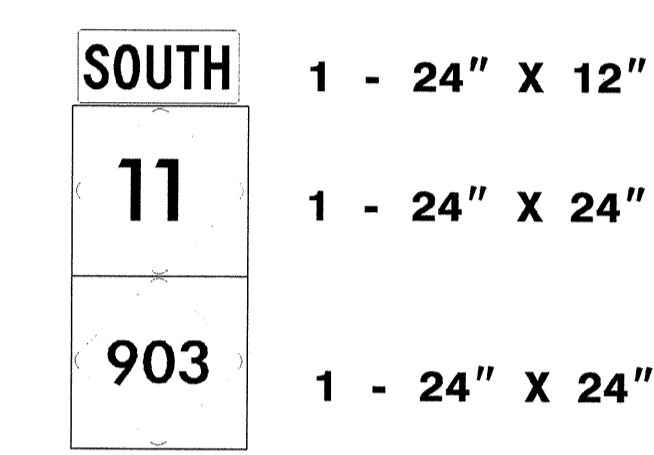

ONE "U" POST PER SIGN

408 QUANTITY REQ'D 6

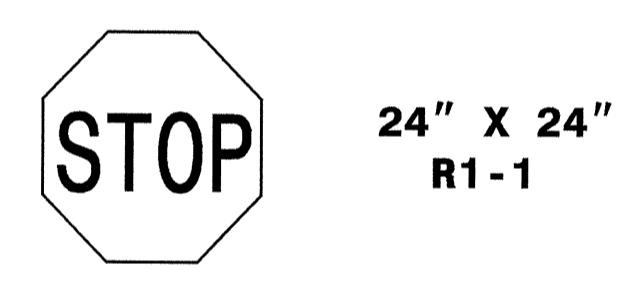

ONE "U" POST PER SIGN

463 QUANTITY REQ'D 2

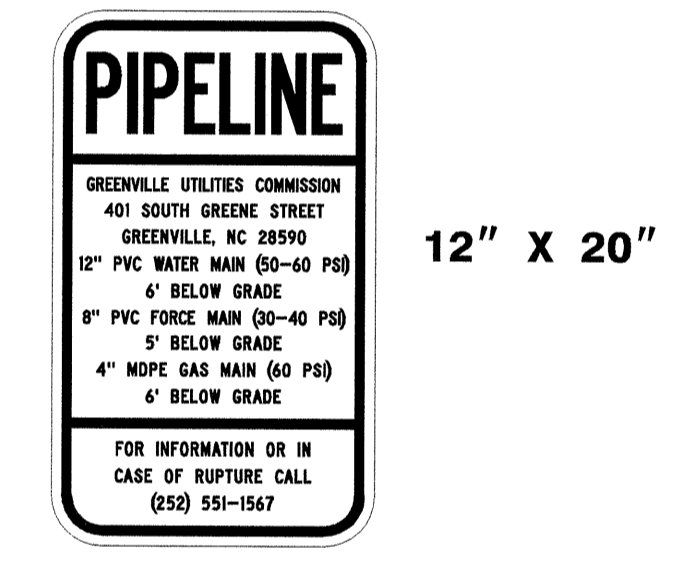

ONE "U" POST PER SIGN

503 QUANTITY REQ'D 1

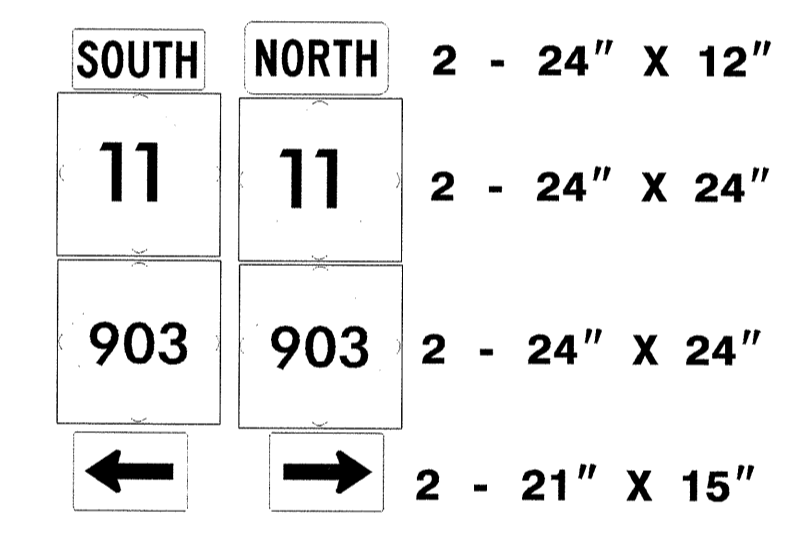

TWO "U" POSTS PER SIGN

416 QUANTITY REQ'D 21

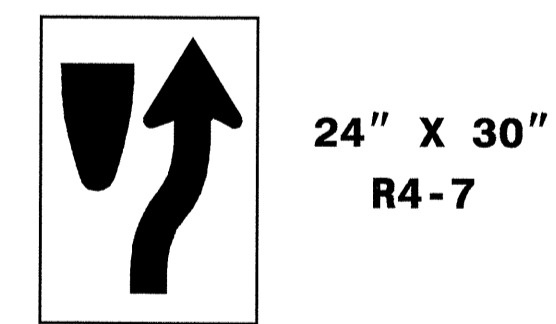

ONE "U" POST PER SIGN

464 QUANTITY REQ'D 1

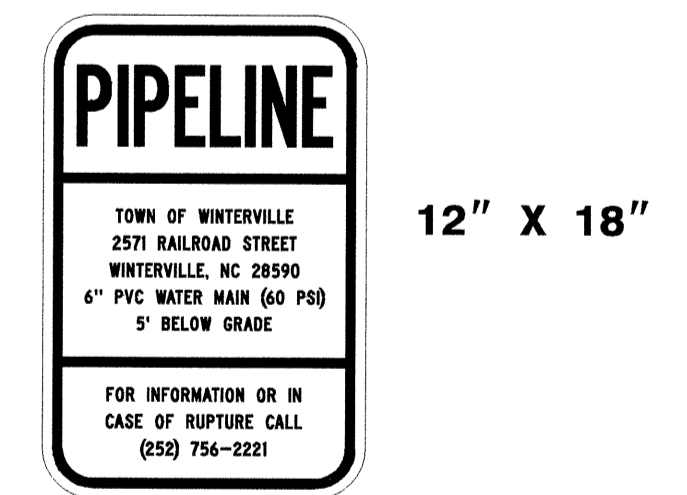

ONE "U" POST PER SIGN

504 QUANTITY REQ'D 1

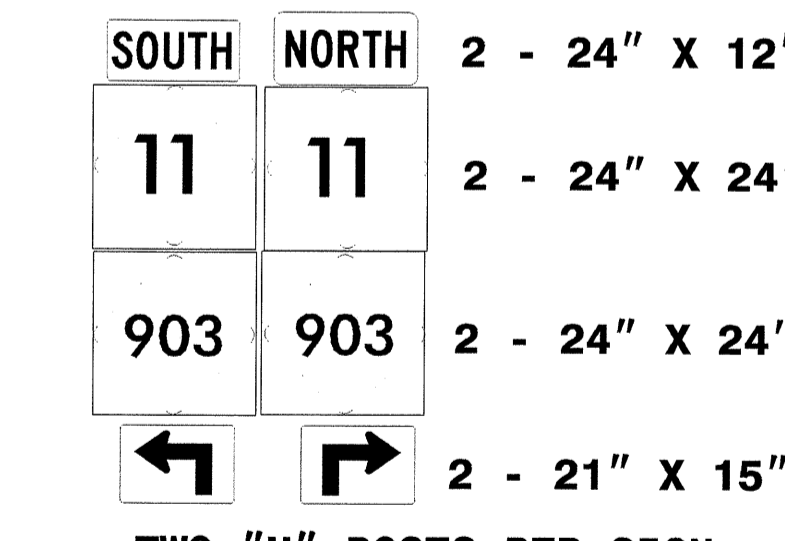

TWO "U" POSTS PER SIGN

417 QUANTITY REQ'D 22

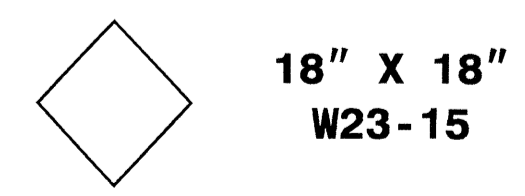

MOUNT BELOW SIGN 416 IN 21 INSTALLATIONS

465 QUANTITY REQ'D 1

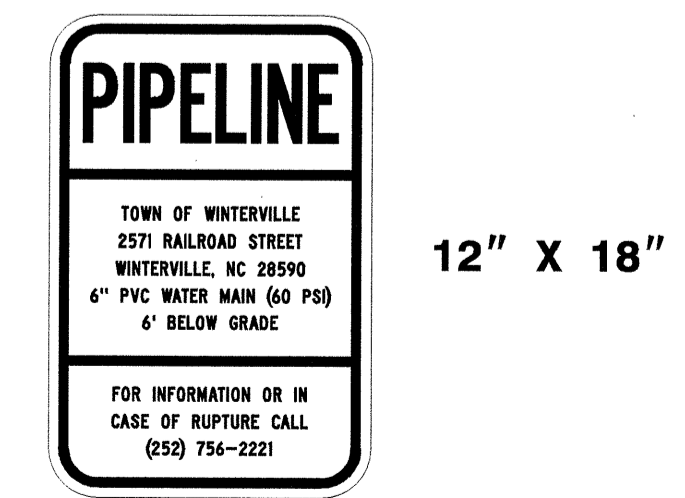

ONE "U" POST PER SIGN

505 QUANTITY REQ'D 1

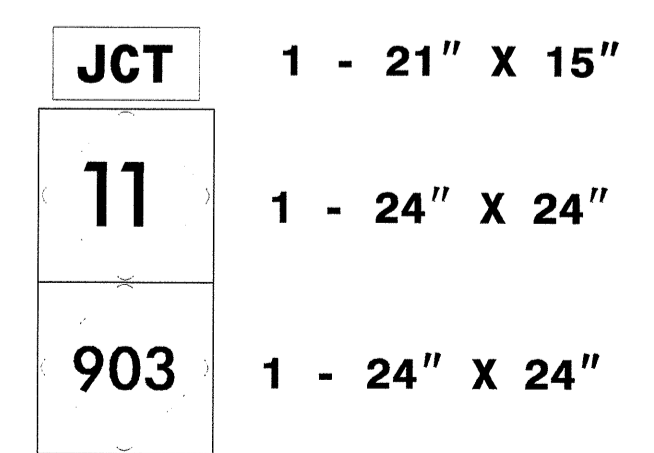

ONE "U" POST PER SIGN

NOTE: THIS DRAWING IS DIMENSIONED IN MILLIMETERS UNLESS OTHERWISE DEPICTED WITHIN THE DRAWING.

# TYPE "E" & "F" SIGNS

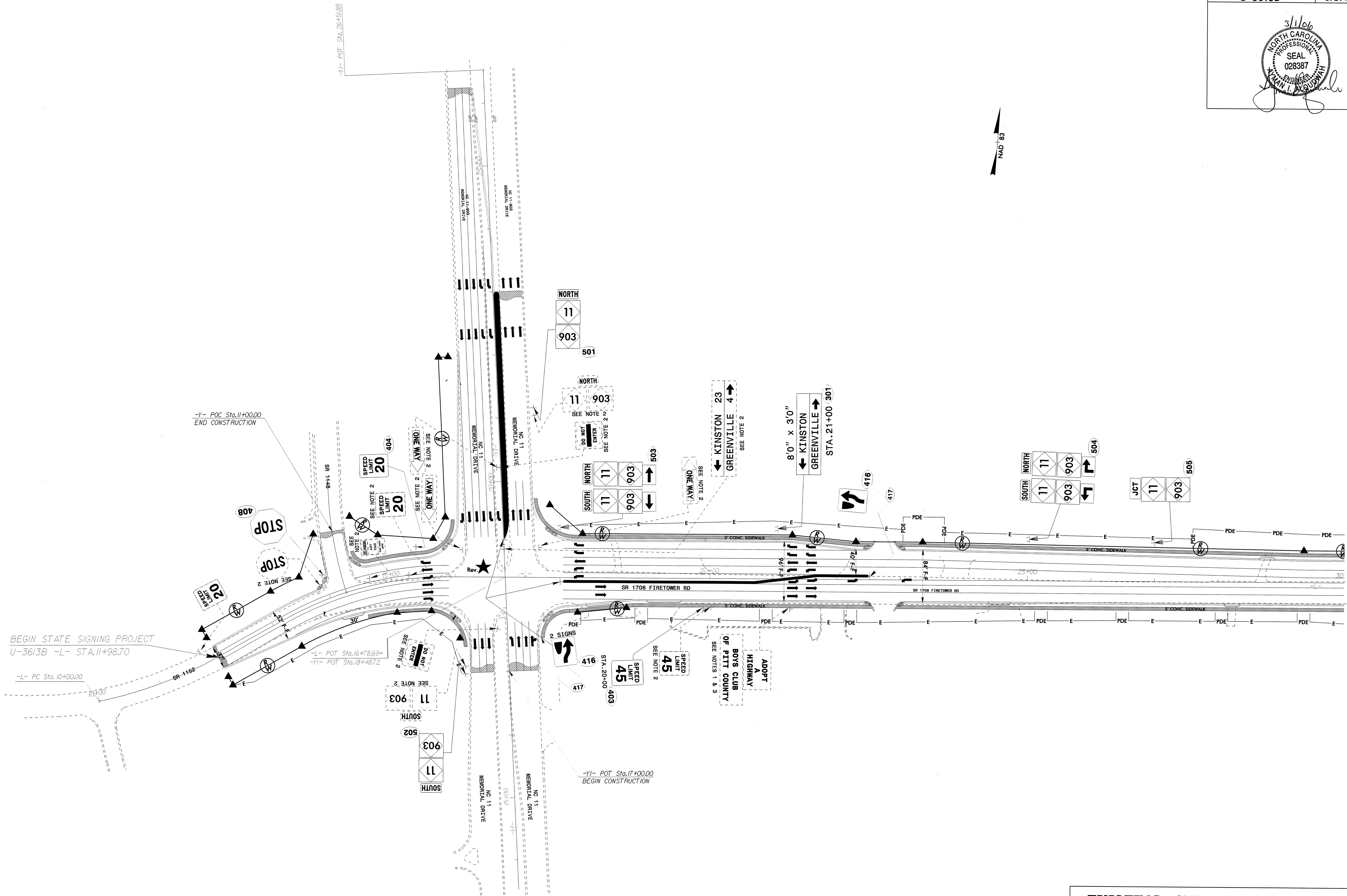

**EXISTING AND PROPOSED SIGNS  
 STA. 11+98.70 TO STA. 30+00  
 SR 1708 (FIRE TOWER ROAD)**

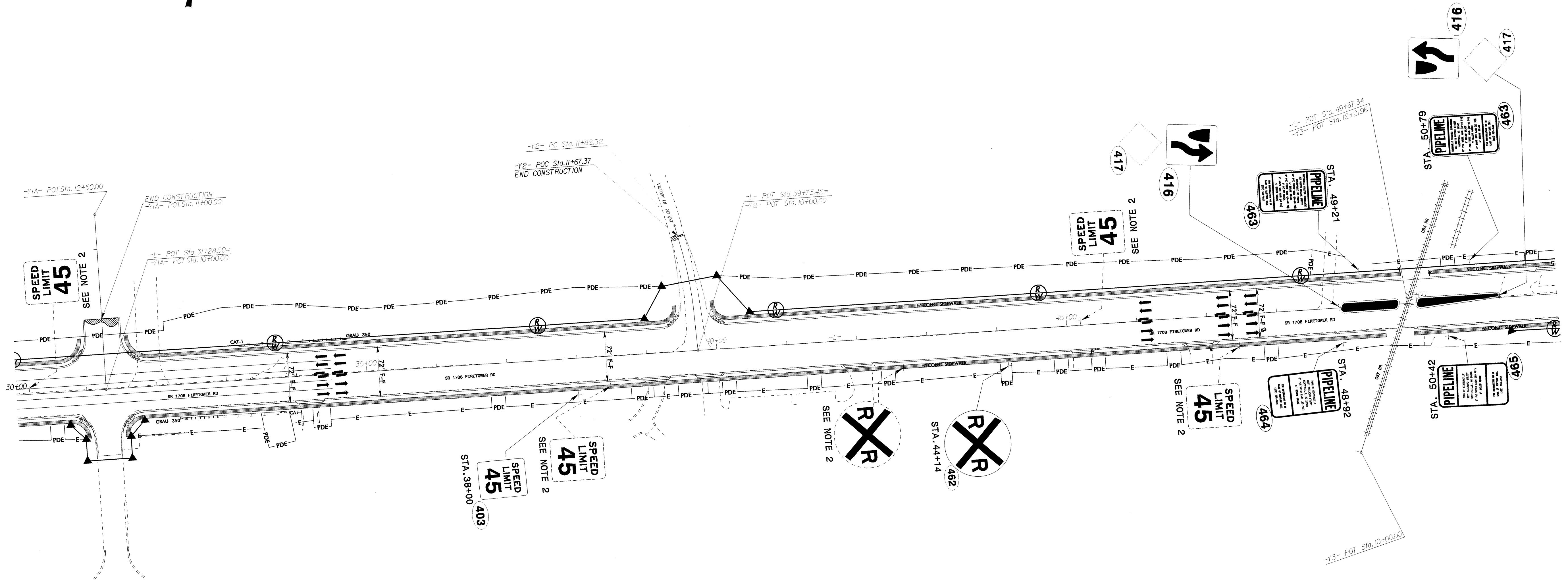
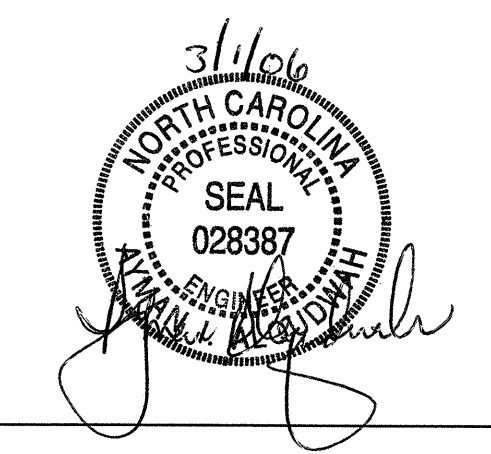

**EXISTING AND PROPOSED SIGNS  
STA. 30+00 TO STA. 53+00  
SR 1708 (FIRE TOWER ROAD)**

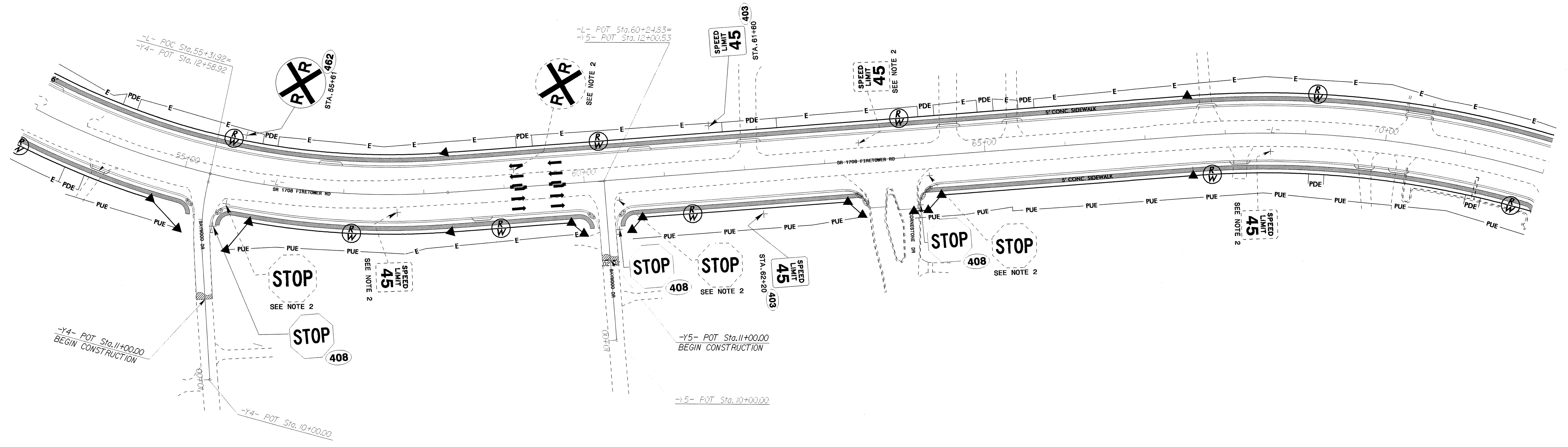
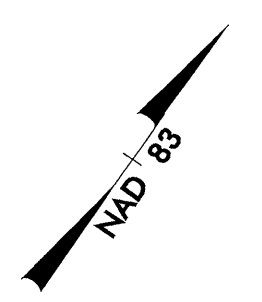
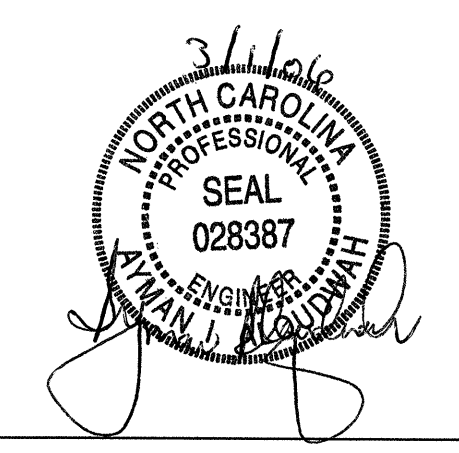

**EXISTING AND PROPOSED SIGNS  
STA. 53+00 TO STA. 72+00  
SR 1708 (FIRE TOWER ROAD)**

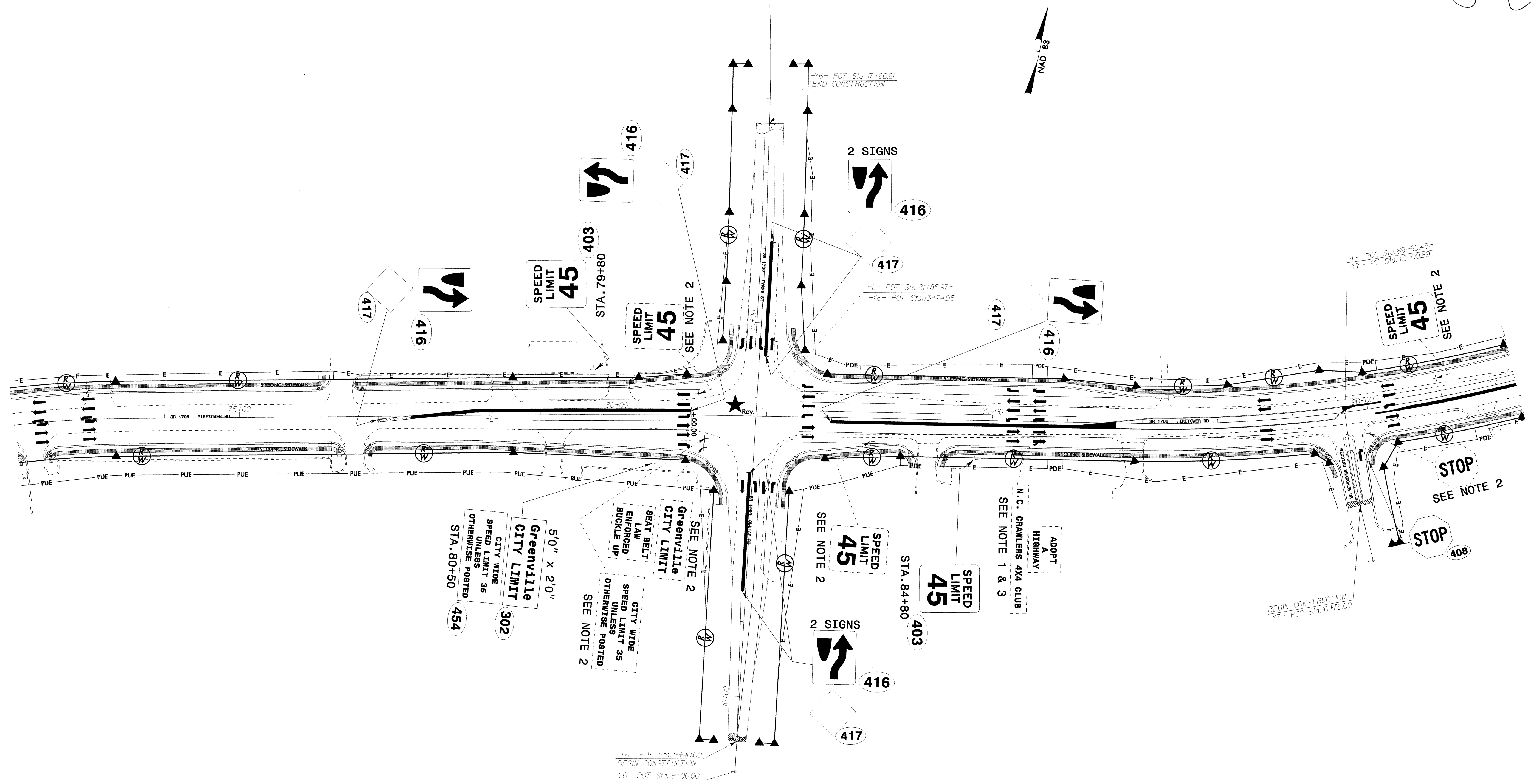

**EXISTING AND PROPOSED SIGNS  
 STA. 72+00 TO STA. 92+00  
 SR 1708 (FIRE TOWER ROAD)**

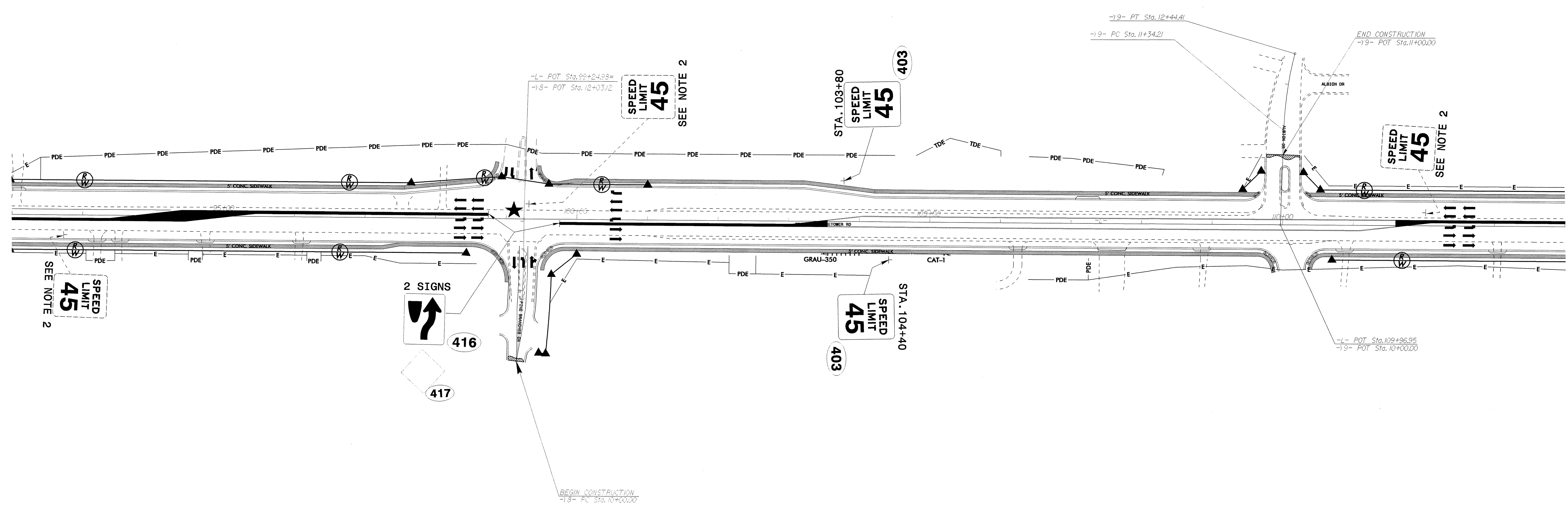
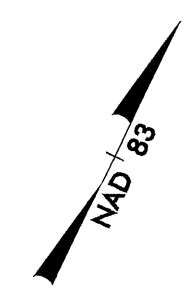
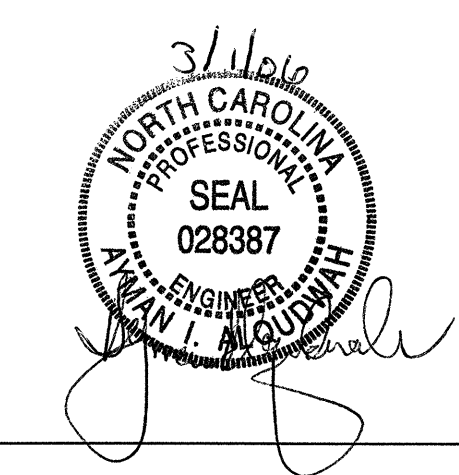

**EXISTING AND PROPOSED SIGNS  
STA. 92+00 TO STA. 114+00  
SR 1708 (FIRE TOWER ROAD)**



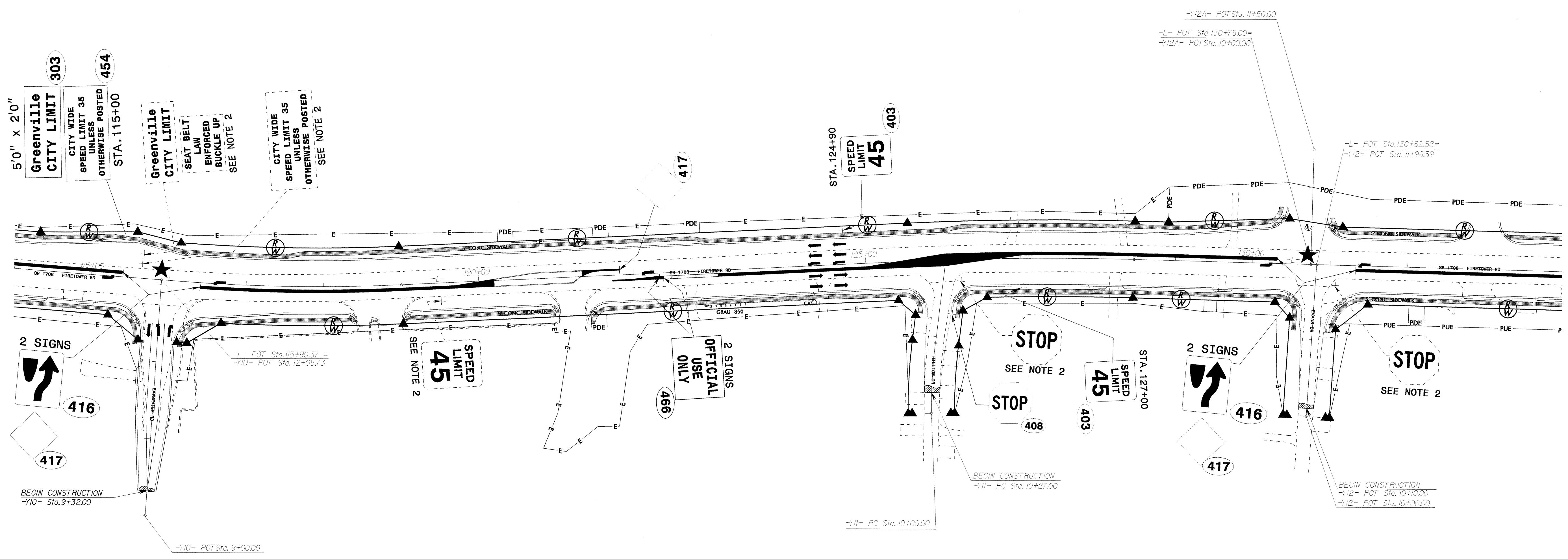
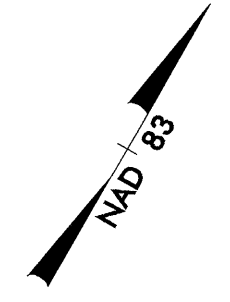
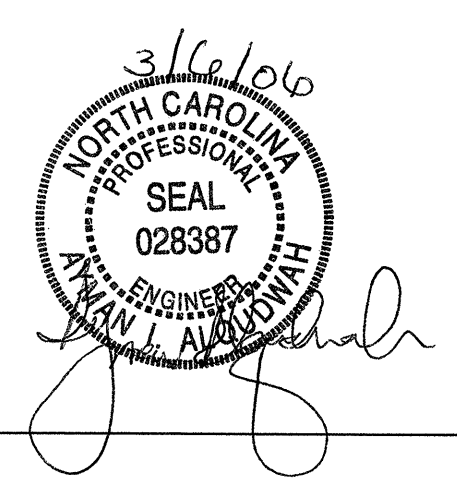

**EXISTING AND PROPOSED SIGNS  
STA. 114+00 TO STA. 134+00  
SR 1708 (FIRE TOWER ROAD)**

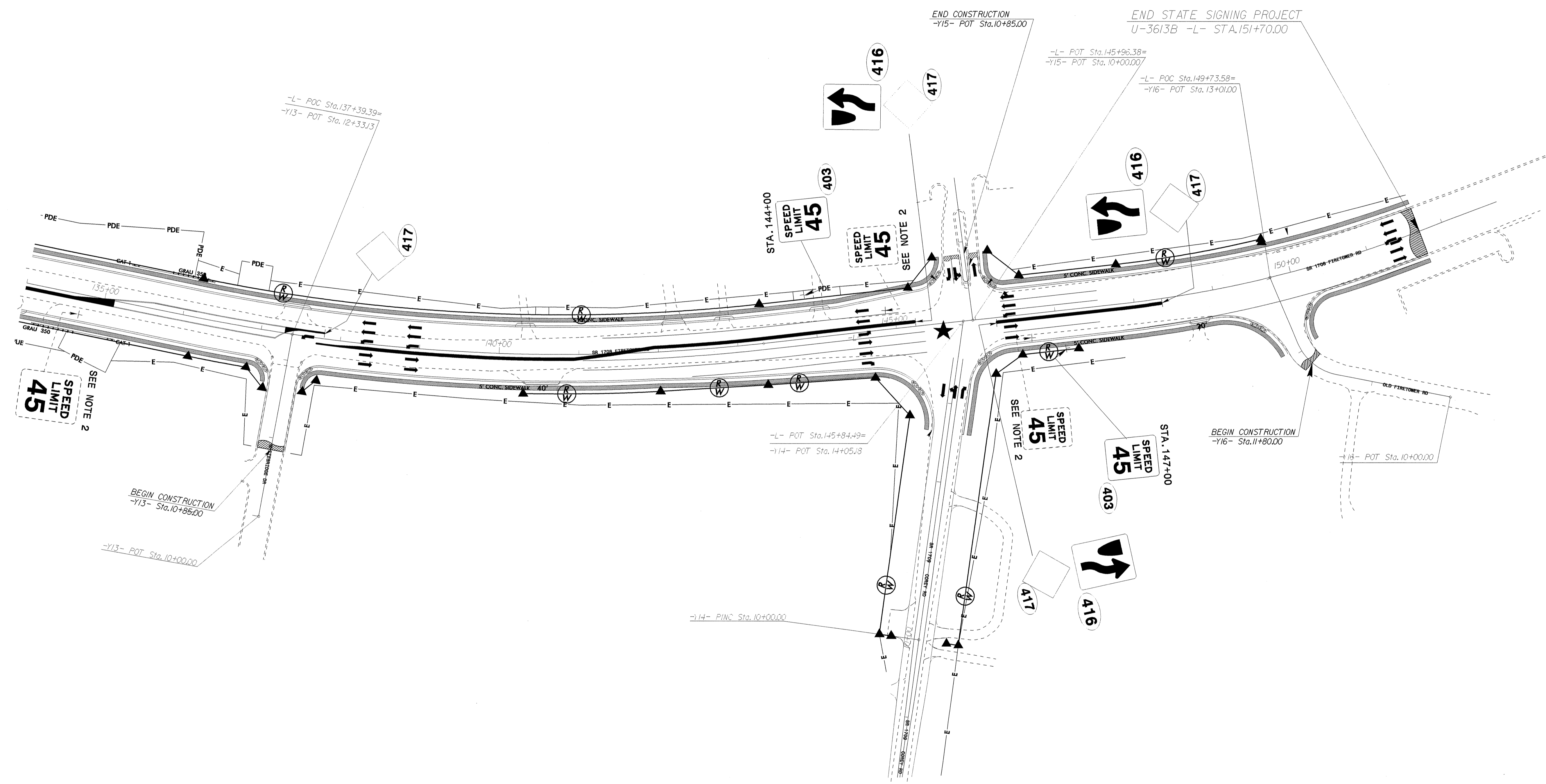
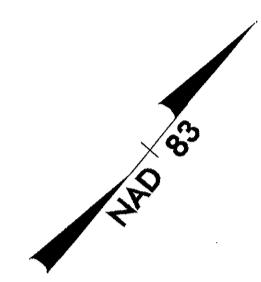
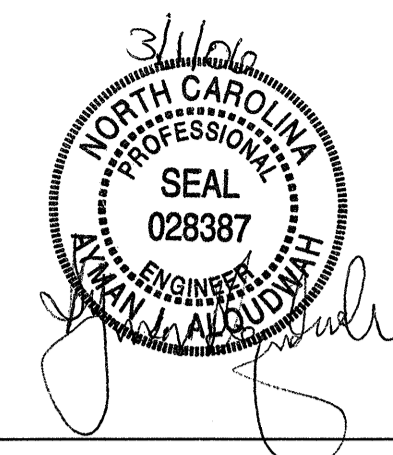

**EXISTING AND PROPOSED SIGNS  
STA. 134+00 TO STA. 151+70.00  
SR 1708 (FIRE TOWER ROAD)**