

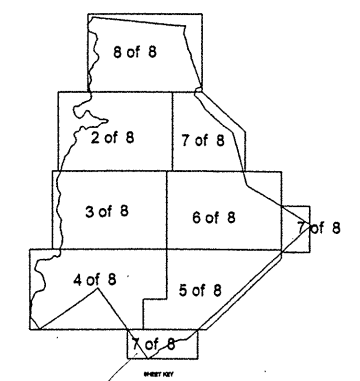

MAP #	ROUTE	DESCRIPTION
1	NC 160 (STEELE CREEK RD)	FROM ERWIN RD. (SR 1120) TO THE PVT JOINT @ NC 49
2	NC 180 (STEELE CREEK RD)	FROM PVT JOINT @ SHOPTON RD. W. (SR 1116) TO WESTINGHOUSE BLVD. (SR 1410)
3	NC 180 (STEELE CREEK RD)	FROM WESTINGHOUSE BLVD. (SR 1410) TO ERWIN RD. (SR 1120)
4	RAMAH CH RD. (SR 2439)	FROM NC 115 TO ECL HUNTERSVILLE
5	NC 24 WB (ALBEMARLE RD.)	FROM REGAL OAKS DR. TO REDDMAN RD.
6	E. 7TH ST. (SR 3300)	FROM US 74 TO LAUREL AVE.
7	SLEDGE RD. (SR 1119)	FROM WINGET RD. (SR 1117) TO NC 160 (STEELE CREEK RD.)
8	CAPP HILL MINE RD. (SR 2050)	FROM BEATTIES FORD RD. (SR 2074) TO NCL CHARLOTTE
9	E. JOHN ST. (SR 1010)	FROM PVT JOINT @ I-485 TO UNION CO. LINE

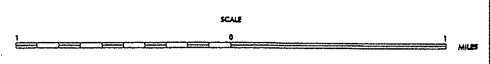

ENLARGED MUNICIPAL AND SUBURBAN AREAS
MECKLENBURG COUNTY
 NORTH CAROLINA
 PREPARED BY THE
 NORTH CAROLINA DEPARTMENT OF TRANSPORTATION
 DIVISION OF HIGHWAYS - GIS UNIT
 IN COOPERATION WITH THE
 U.S. DEPARTMENT OF TRANSPORTATION
 FEDERAL HIGHWAY ADMINISTRATION



COPIES OF THIS MAP ARE AVAILABLE
 FROM THE
 DIVISION OF HIGHWAYS
 DIVISION OF TRANSPORTATION
 ADDRESS:
 RALEIGH, NORTH CAROLINA 27611

REVISED	DATE
8/15/08	JOT
4/18/08	ECM
7/15/05	LM