

MAP #	ROUTE	DESCRIPTION
1	NC 160 (STEELE CREEK RD)	FROM ERWIN RD. (SR 1120) TO THE PVT JOINT @ NC 49
2	NC 160 (STEELE CREEK RD)	FROM PVT JOINT @ SHOPTON RD. W. (SR 1118) TO WESTINGHOUSE BLVD. (SR 1410)
3	NC 160 (STEELE CREEK RD)	FROM WESTINGHOUSE BLVD. (SR 1410) TO ERWIN RD. (SR 1120)
4	RAMAH CH RD. (SR 2439)	FROM NC 115 TO ECL HUNTERSVILLE
5	NC 24 WB (ALBEMARLE RD.)	FROM REGAL OAKS DR. TO REDDMAN RD.
6	E. 7TH ST. (SR 3300)	FROM US 74 TO LAUREL AVE.
7	SLEDGE RD. (SR 1119)	FROM WINGET RD. (SR 1117) TO NC 160 (STEELE CREEK RD.)
8	CAPP HILL MINE RD. (SR 2050)	FROM BEATTIES FORD RD. (SR 2074) TO NCL CHARLOTTE
9	E. JOHN ST. (SR 1010)	FROM PVT JOINT @ I-485 TO UNION CO. LINE

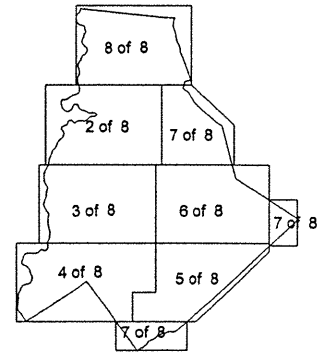

ENLARGED MUNICIPAL AND SUBURBAN AREAS  
**MECKLENBURG COUNTY**  
 NORTH CAROLINA  
 PREPARED BY THE  
 NORTH CAROLINA DEPARTMENT OF TRANSPORTATION  
 DIVISION OF HIGHWAYS - GIS UNIT  
 IN COOPERATION WITH THE  
 U.S. DEPARTMENT OF TRANSPORTATION  
 FEDERAL HIGHWAY ADMINISTRATION

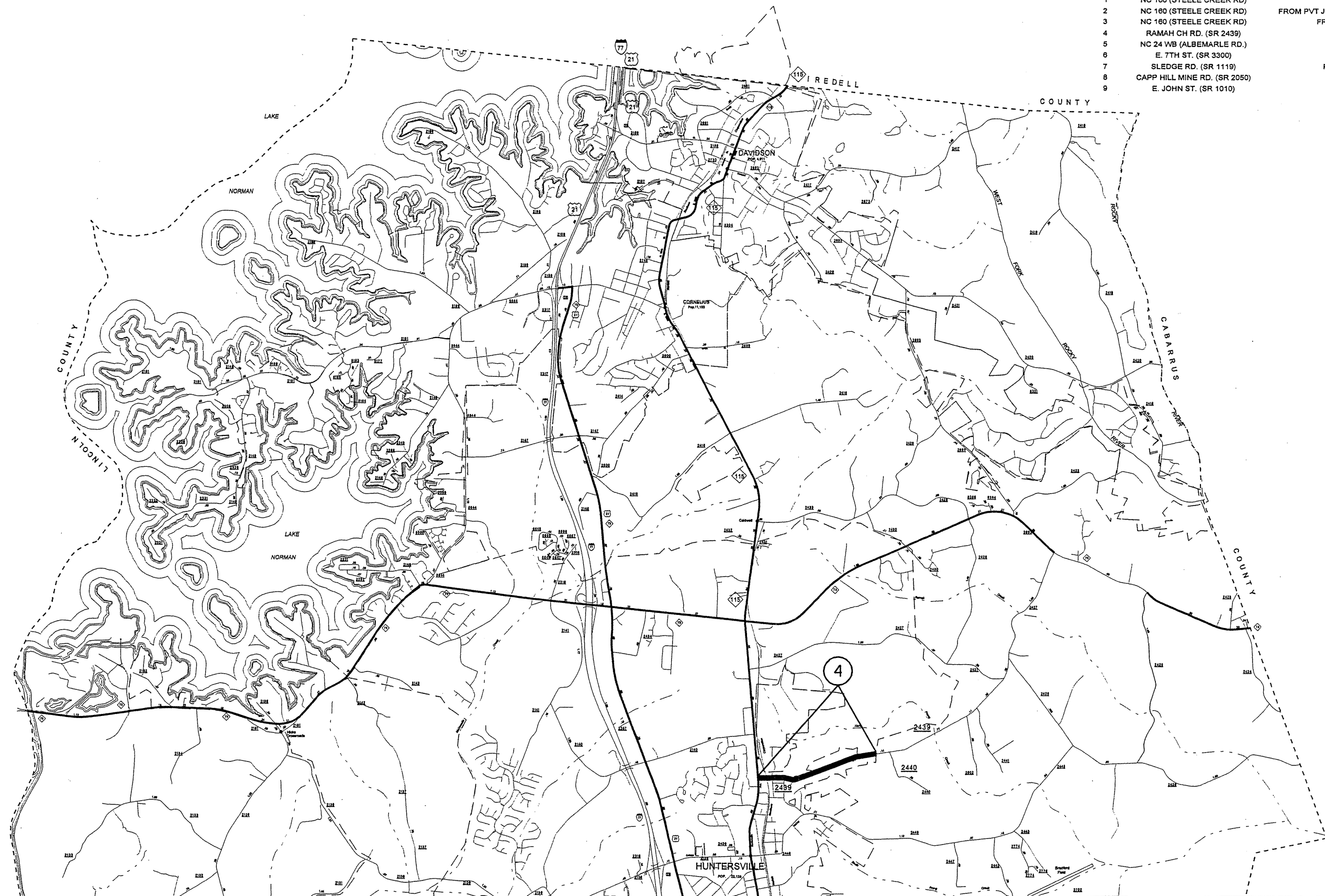
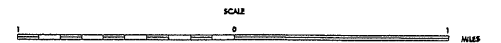

COPIES OF THIS MAP ARE AVAILABLE  
 TO THE PUBLIC AT A MINIMAL COST.  
 ADDRESS:  
 MAPS, N.C. DEPARTMENT OF TRANSPORTATION  
 DIVISION OF HIGHWAYS  
 RALPH, NORTH CAROLINA, 27611

REVISION  
 8/15/98 JST  
 4/10/99 FOR  
 7/2/99 LM