

5/28/99

-L-

PROJECT REFERENCE NO. B-3662	SHEET NO. 5
ROADWAY DESIGN ENGINEER 	HYDRAULICS ENGINEER

BM *1 EL. = 2095.95
8" SPIKE IN BASE OF 2" PINE
FROM -L- STA. 12+29.23, 30.73 RT.

BM *2 EL. = 2075.45
8" SPIKE IN BASE OF 2" PINE
FROM -L- STA. 19+68.79, 65.85 LT.

CULVERT HYDRAULIC DATA

DESIGN DISCHARGE	= 1500 CFS
DESIGN FREQUENCY	= 50 YRS
DESIGN HW ELEVATION	= 2070.40FT
BASE DISCHARGE	= 1800 CFS
BASE FREQUENCY	= 100 YRS
BASE HW ELEVATION	= 2071.29FT
OVERTOPPING DISCHARGE	= 2280 CFS
OVERTOPPING FREQUENCY	= 200+ YRS
OVERTOPPING ELEVATION	= 2072.39FT

DITCH DETAIL:
LEFT DITCH -----
RIGHT DITCH -----

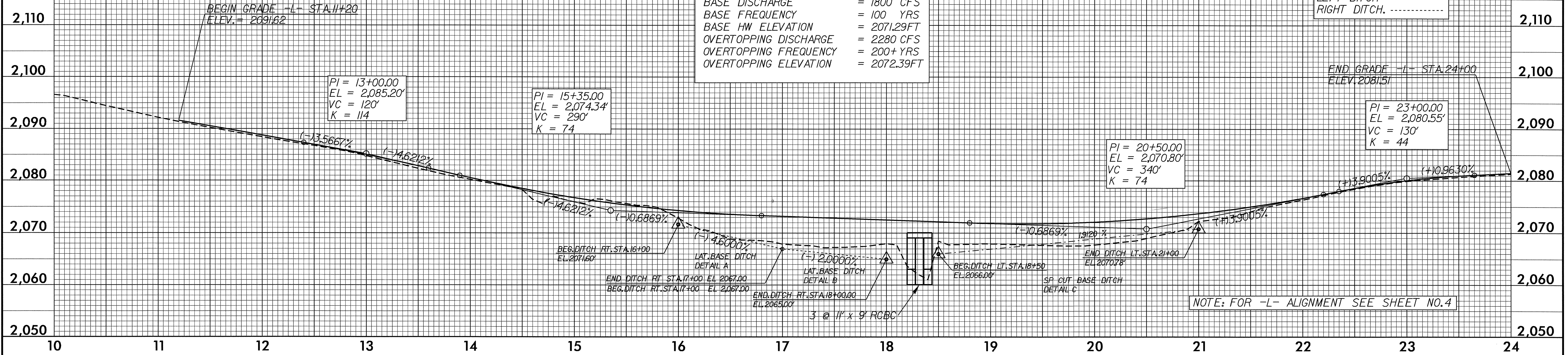

21-JAN-2005 09:35
C:\Roadway\PROJECTS\B3662-p1
S:\shu\A1_5172454