

NOTE:
PERIMETER EROSION CONTROL MEASURES SHALL BE INSTALLED DURING CLEARING AND GRUBBING PHASE.

NOTE:
UTILIZE SPECIAL STILLING BASIN AS STILLING BASIN WHERE APPLICABLE.

STA -L- 11+41 LT D.A. 0.14 AC C = 0.90 Q10 = 0.504 CFS RIM = 772.32 FT INV OUT = 769.57	STA -L- 9+50 RT D.A. 0.00 AC C = 0.00 Q10 = 0.000 CFS RIM = 771.28 FT INV IN = 767.63	STA -L- 11+41 RT D.A. 0.14 AC C = 0.90 Q10 = 0.504 CFS RIM = 772.32 FT INV IN = 769.45
--	--	---

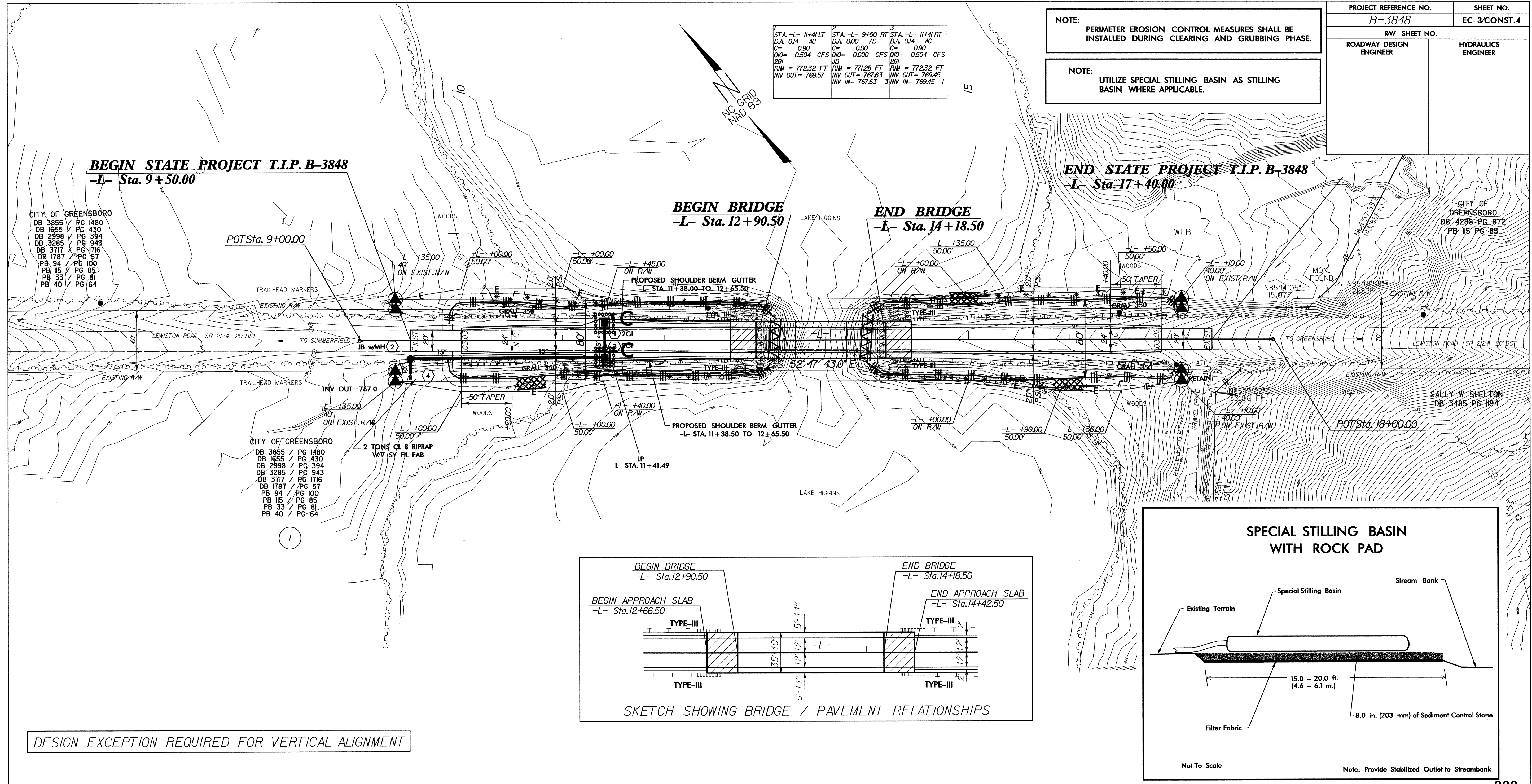

CITY OF GREENSBORO
DB 3855 / PG 1480
DB 1655 / PG 430
DB 2998 / PG 394
DB 3285 / PG 943
DB 3717 / PG 1716
DB 1787 / PG 57
PB 94 / PG 100
PB 115 / PG 85
PB 33 / PG 81
PB 40 / PG 64

POT Sta. 9+00.00

CITY OF GREENSBORO
DB 3855 / PG 1480
DB 1655 / PG 430
DB 2998 / PG 394
DB 3285 / PG 943
DB 3717 / PG 1716
DB 1787 / PG 57
PB 94 / PG 100
PB 115 / PG 85
PB 33 / PG 81
PB 40 / PG 64

END STATE PROJECT T.I.P. B-3848
-L- Sta. 17+40.00

BEGIN BRIDGE
-L- Sta. 12+90.50

END BRIDGE
-L- Sta. 14+18.50

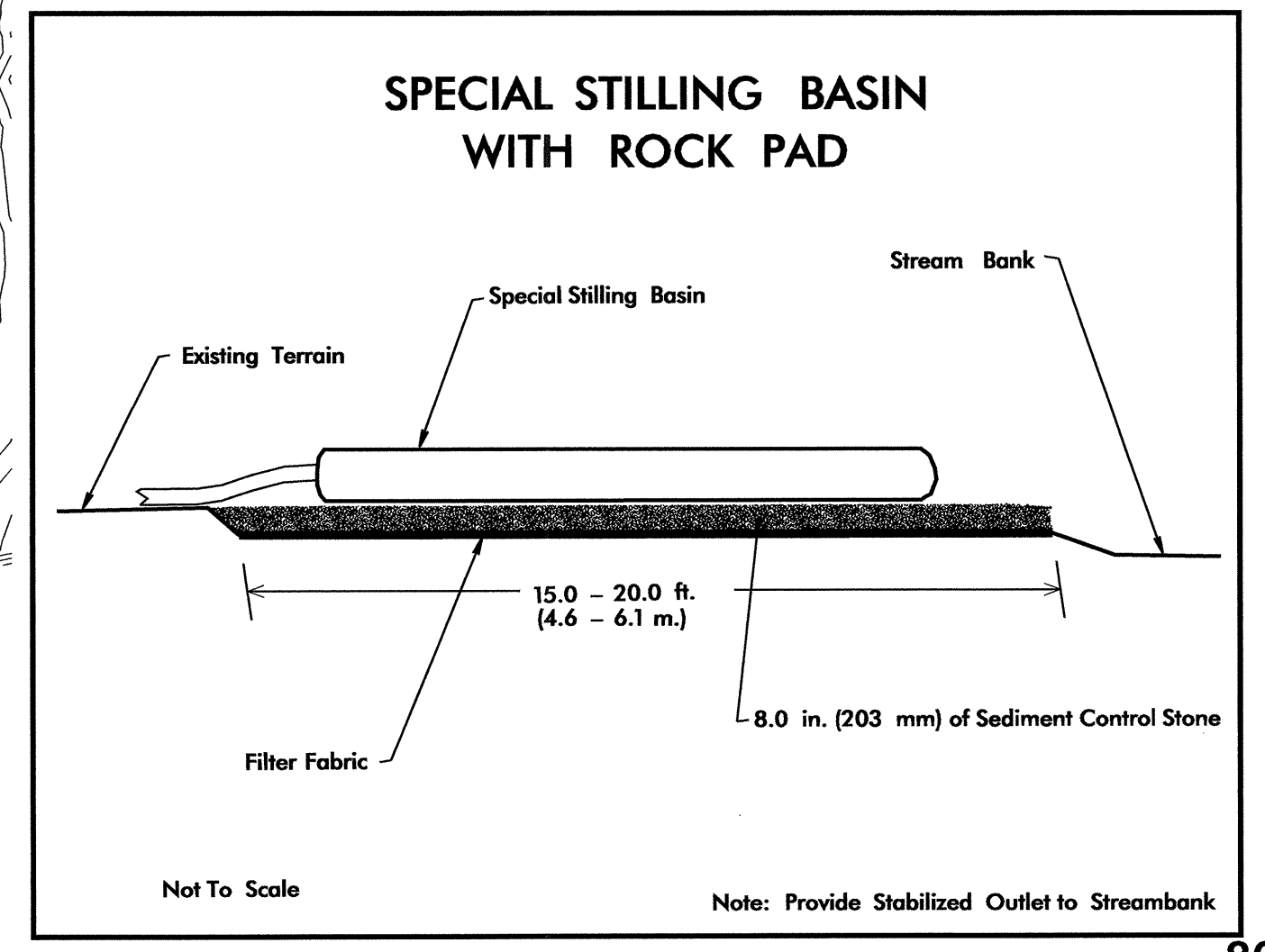
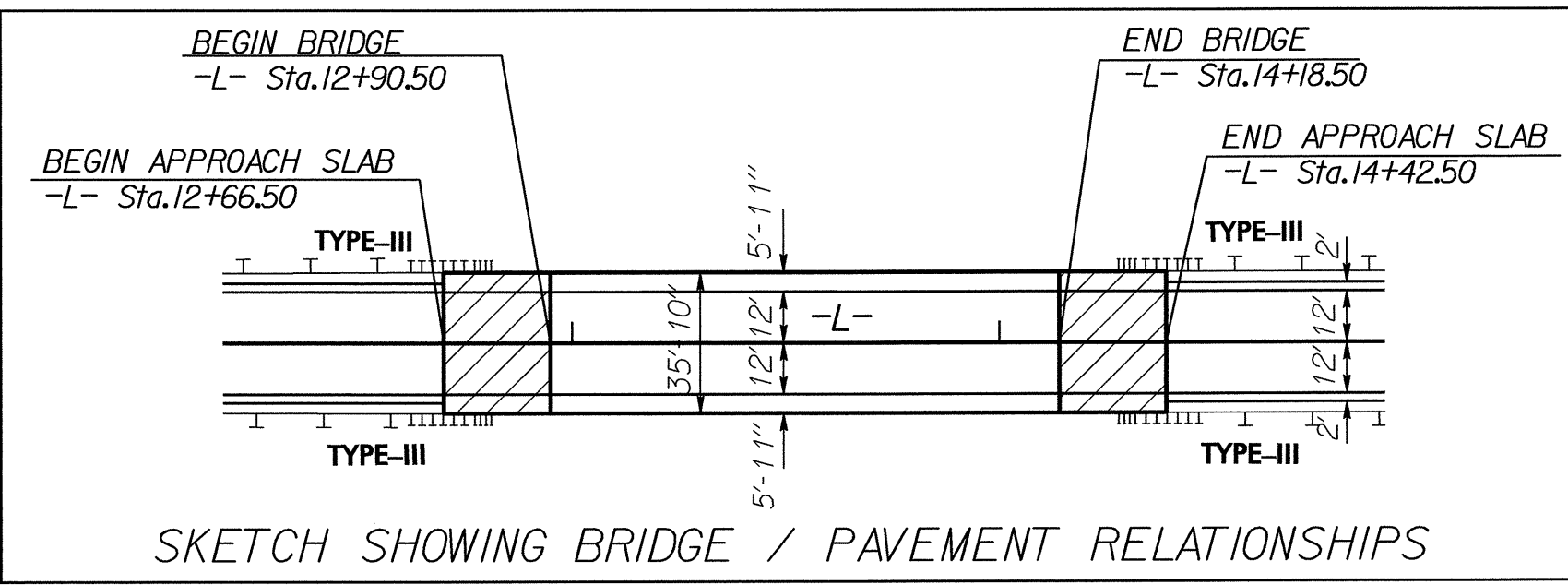

DESIGN EXCEPTION REQUIRED FOR VERTICAL ALIGNMENT

