

5/28/99

PROJECT REFERENCE NO. U-4719	SHEET NO. 13
ROADWAY DESIGN ENGINEER	HYDRAULICS ENGINEER

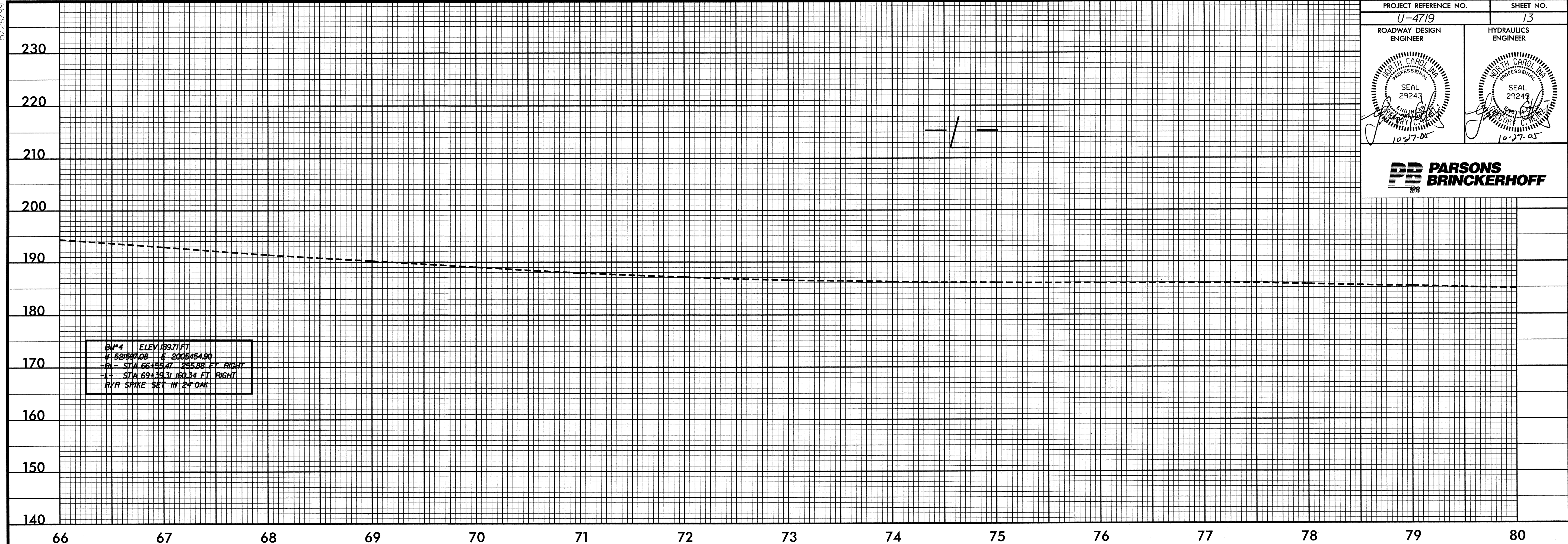

BM#4 ELEV: 169.71 FT
 N 521597.08 E 2005454.90
 -BL- STA 66+55.47 1255.88 FT RIGHT
 -L- STA 69+39.31 160.34 FT RIGHT
 R/R SPIKE SET IN 2" OAK

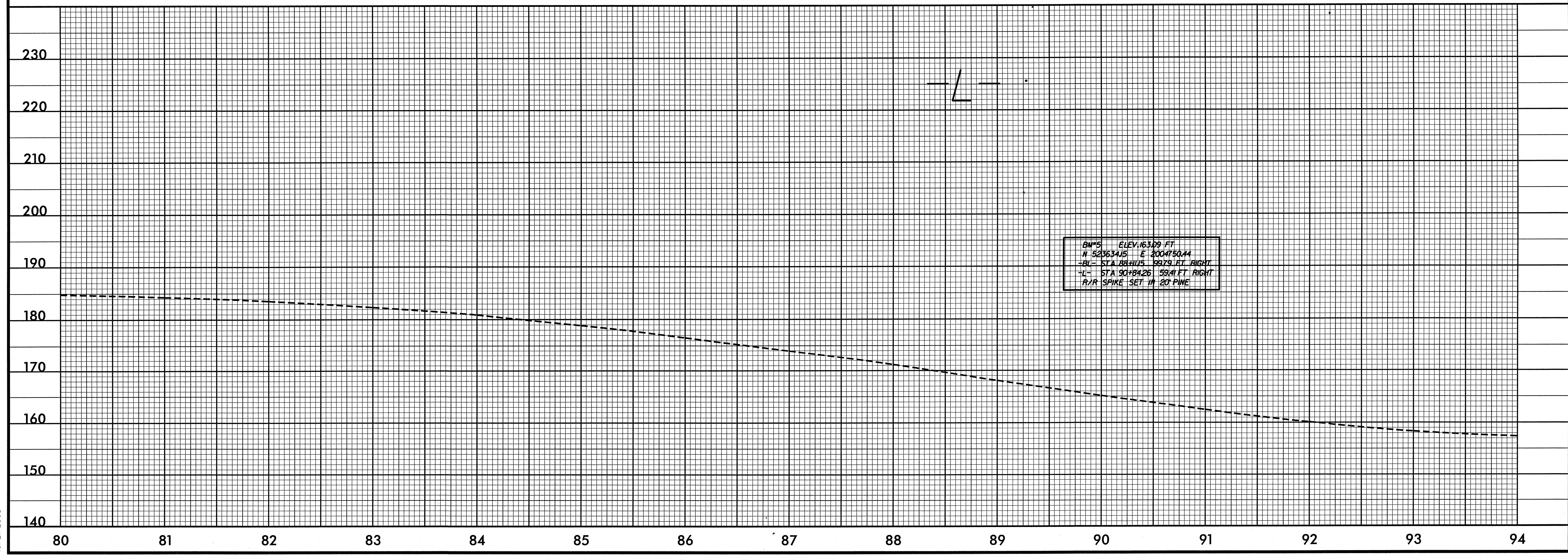

BM#5 ELEV: 163.09 FT
 N 523634.15 E 2004750.44
 -BL- STA 88+11.5 997.9 FT RIGHT
 -L- STA 90+84.26 59.41 FT RIGHT
 R/R SPIKE SET IN 2" PINE

C:\PROJECTS\203444\Brcog_Biv\Design\U4719_RDY_PFL.dgn
 C:\PLOTS\XEROX825\X34\U4719_RDY_PFL3.dpr
 10/21/2005