

BEGIN CROSSOVER DETOUR 1  
 PC STA. 22+81.56 -DET--  
 POC STA. 22+81.56 -L-

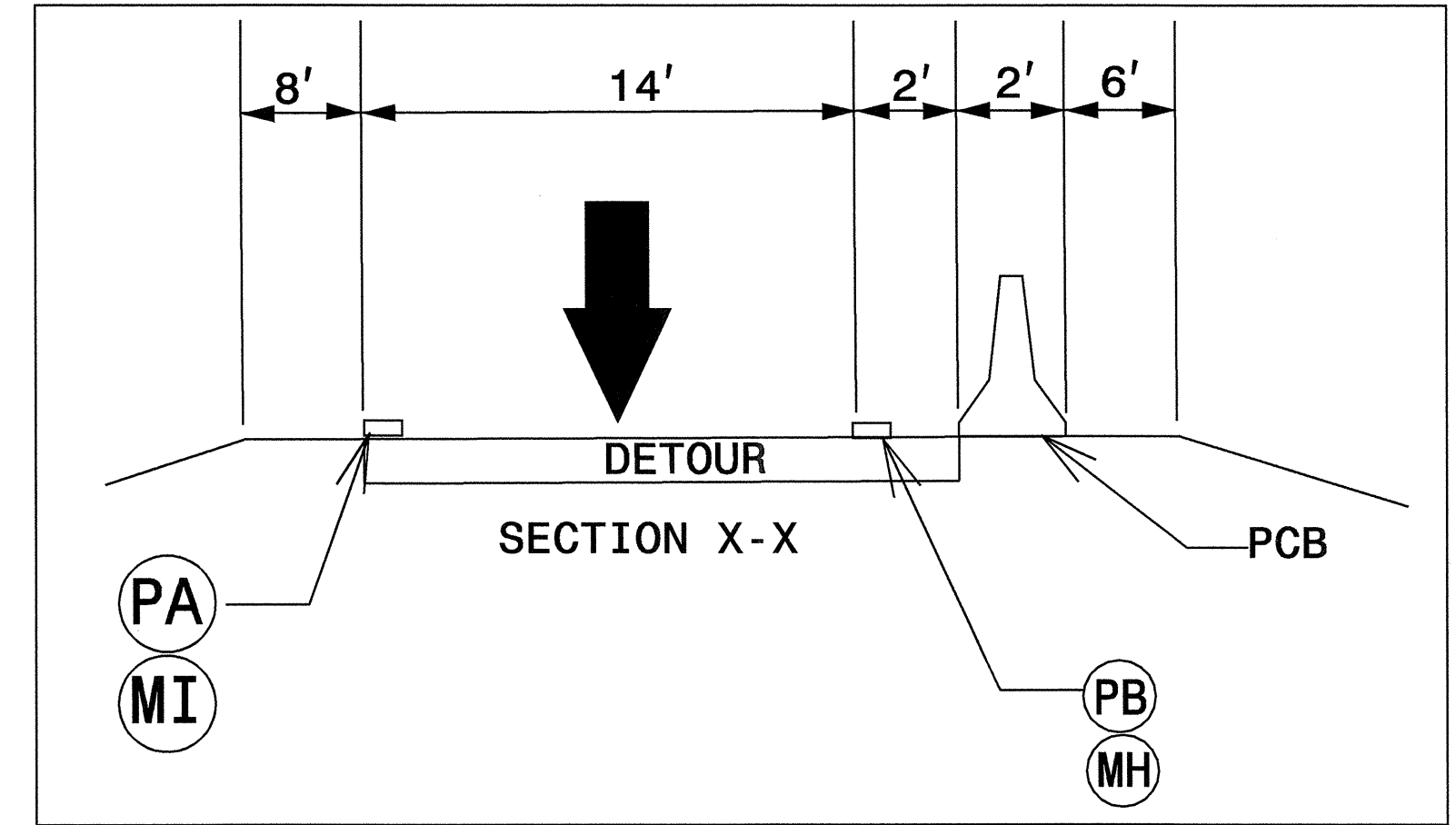

ALL SIGNS ARE BLACK ON ORANGE  
 \* SEE SHEET TCP-12B FOR SIGN DESIGN

- PA = 4" WHITE EDGELINE (PAINT)
- PB = 4" YELLOW EDGELINE (PAINT)
- RA = 4" WHITE EDGELINE (TAPE)
- RB = 4" YELLOW EDGELINE (TAPE)
- MI = TEMPORARY RAISED CRYSTAL AND RED MARKER (20' SPACING)
- MH = TEMPORARY RAISED YELLOW/YELLOW MARKER (20' SPACING)

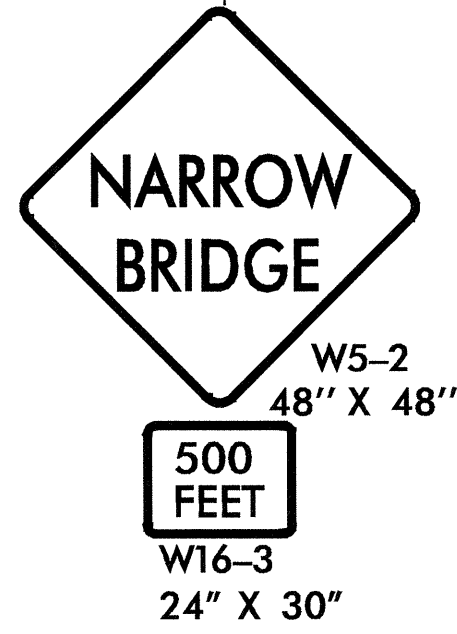
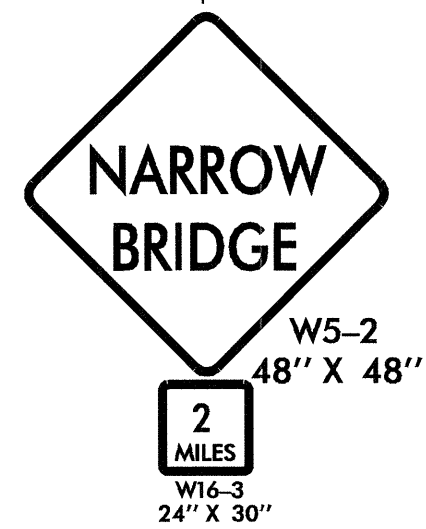
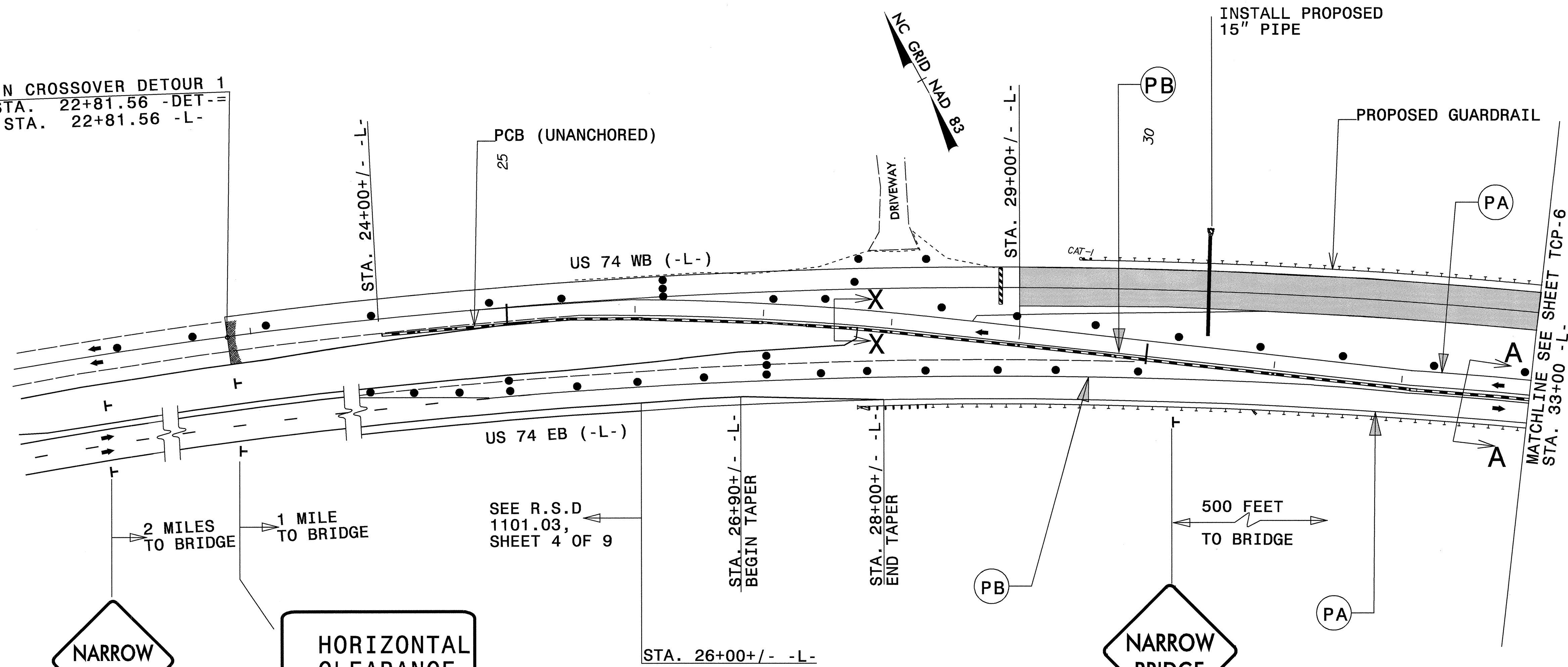
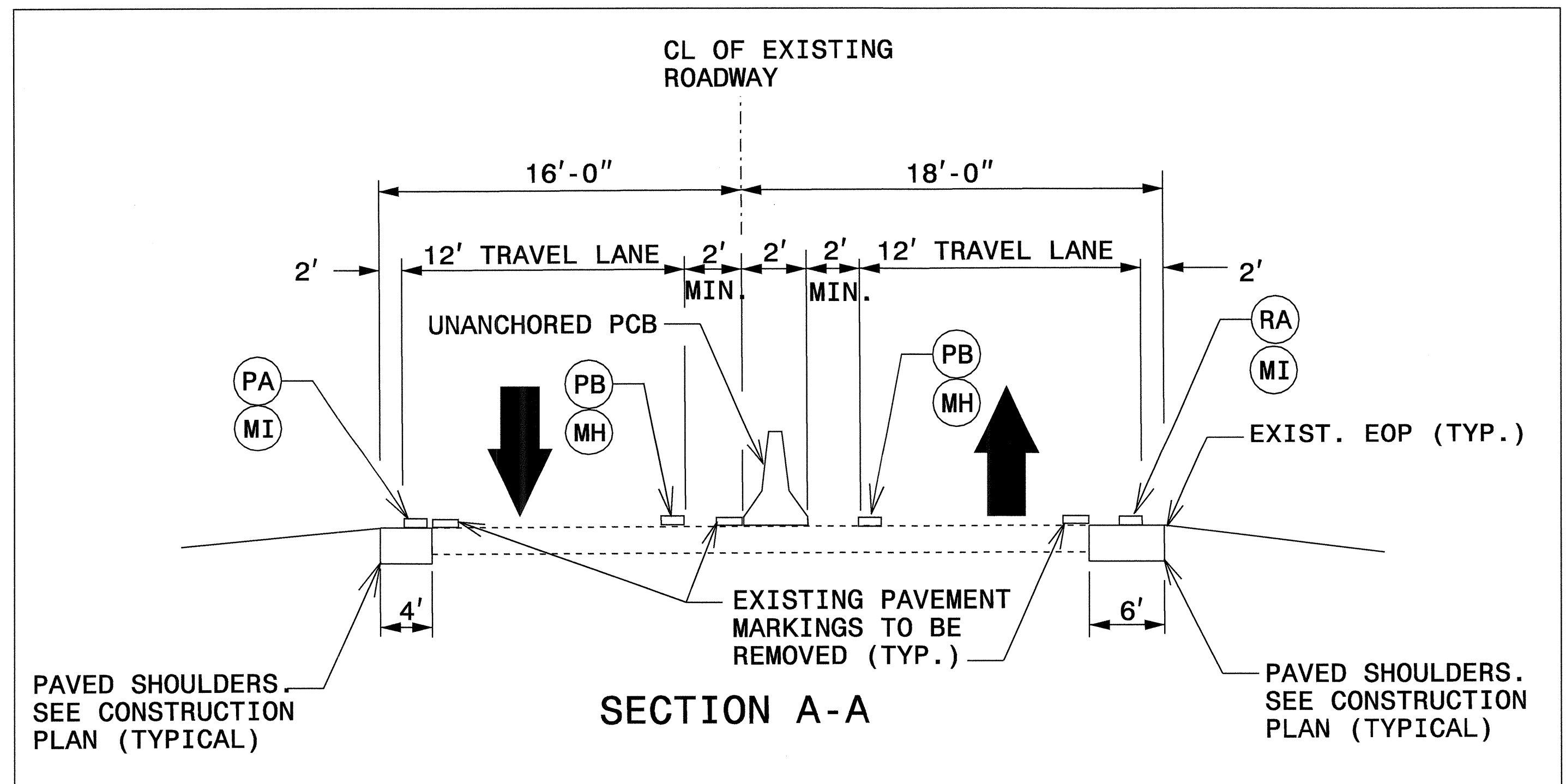

APPROVED:	DATE: 29 July 2005	<h3>PHASE I, STEPS 2, 3, 4 &amp; 5</h3>
SCALE: NONE		REVISIONS
DATE: 7-05		
DWG. BY: MW		
DESIGN BY: JWG		
REVIEWED BY:		

29-JUL-2005 07:43  
 \\GIS-cct\so5\p1\757224168  
 mwg\m3y.dwg AT: WZTC224168