

PROJECT REFERENCE NO.		SHEET NO.	
B-4009		4	
ROADWAY DESIGN ENGINEER	HYDRAULICS ENGINEER		
PRELIMINARY PLANS DO NOT USE FOR CONSTRUCTION			
INCOMPLETE PLANS DO NOT USE FOR R/W ACQUISITION			

NC GRID, NAD 83

PI Sta 21+93.76 Pls Sta 33+71.63
 $\Delta = 29^\circ 11' 43.4''$ (RT) $\Theta_s = 0^\circ 40' 30.0''$
 $D = 115' 00.0''$ $L_s = 108.00'$
 $L = 2,335.63'$ $LT = 72.00'$
 $T = 1,193.76'$ $ST = 36.00'$
 $R = 4,583.66'$ $SE = 04'$
 $DS = 60$ $DS = 60$ MPH
 ANNE T. BRICKER
 P.I.N. 6445-00-37-1108.00
 DB. 175, PG. 100

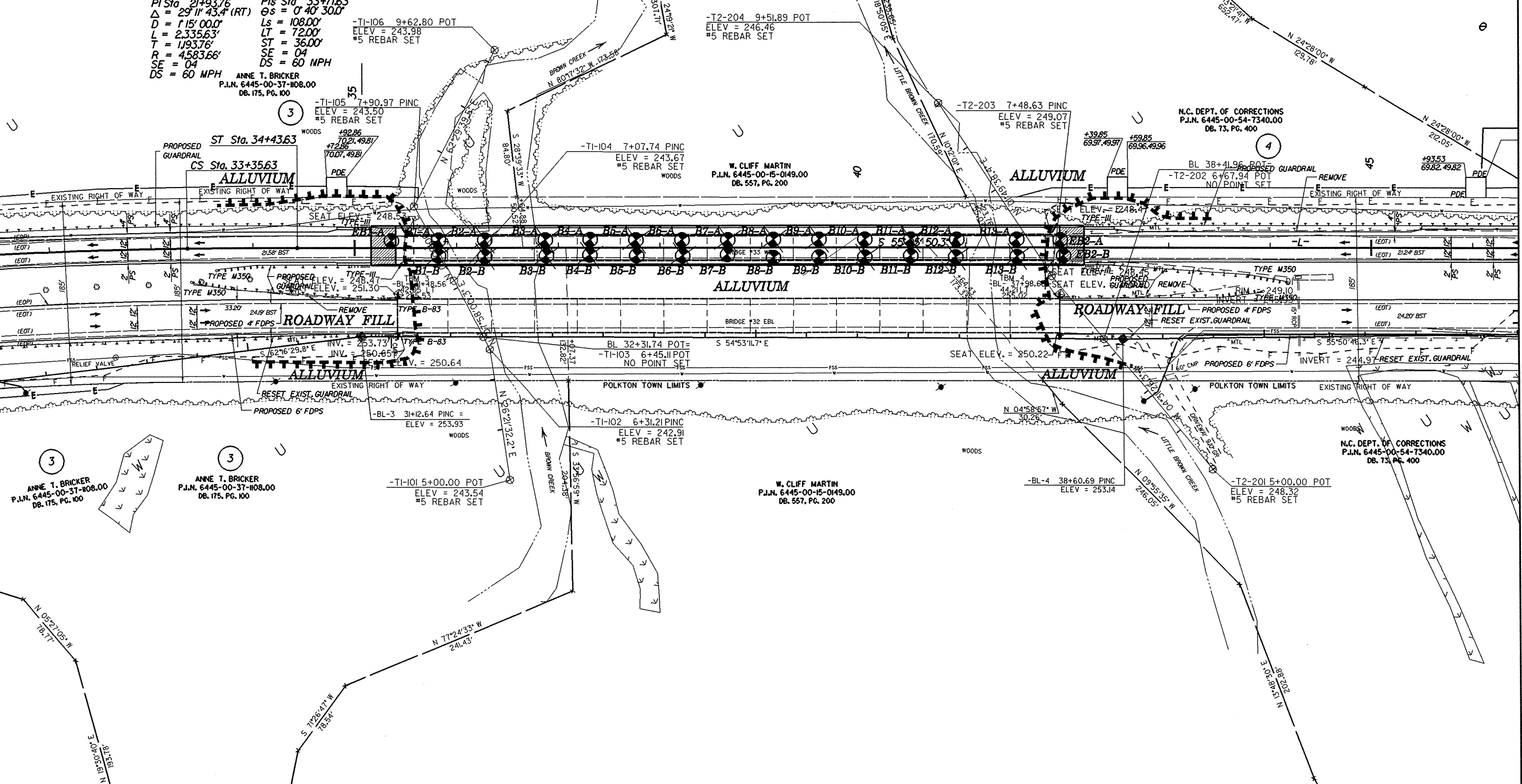

3
 ANNE T. BRICKER
 P.I.N. 6445-00-37-1108.00
 DB. 175, PG. 100

3
 ANNE T. BRICKER
 P.I.N. 6445-00-37-1108.00
 DB. 175, PG. 100

-TI-101 5+00.00 POT
 ELEV = 243.54
 #5 REBAR SET

W. CLIFF MARTIN
 P.I.N. 6445-00-15-0149.00
 DB. 557, PG. 200

-BL-4 38+60.69 PINC
 ELEV = 253.14

-T2-201 5+00.00 POT
 ELEV = 248.32
 #5 REBAR SET

N.C. DEPT. OF CORRECTIONS
 P.I.N. 6445-00-54-7340.00
 DB. 73, PG. 400

N.C. DEPT. OF CORRECTIONS
 P.I.N. 6445-00-54-7340.00
 DB. 73, PG. 400