

CONTRACT: C201294 TIP PROJECT: B-4266

STATE	STATE PROJECT REFERENCE NO.	SHEET NO.	TOTAL SHEETS
N.C.	B-4266		
STATE PROJ. NO.	F.A. PROJ. NO.	DESCRIPTION	
33608.1.1	BRZ-1991 (8)	P.E.	
33608.2.1	BRZ-1991 (8)	R/W, UTIL	
33608.3.1	BRZ-1991 (8)	CONST.	

STATE OF NORTH CAROLINA
DIVISION OF HIGHWAYS

RUTHERFORD COUNTY

**LOCATION: BRIDGE NO. 110 OVER HILLS CREEK
ON SR 1991**

TYPE OF WORK: PAVING, DRAINAGE, GRADING, AND STRUCTURE

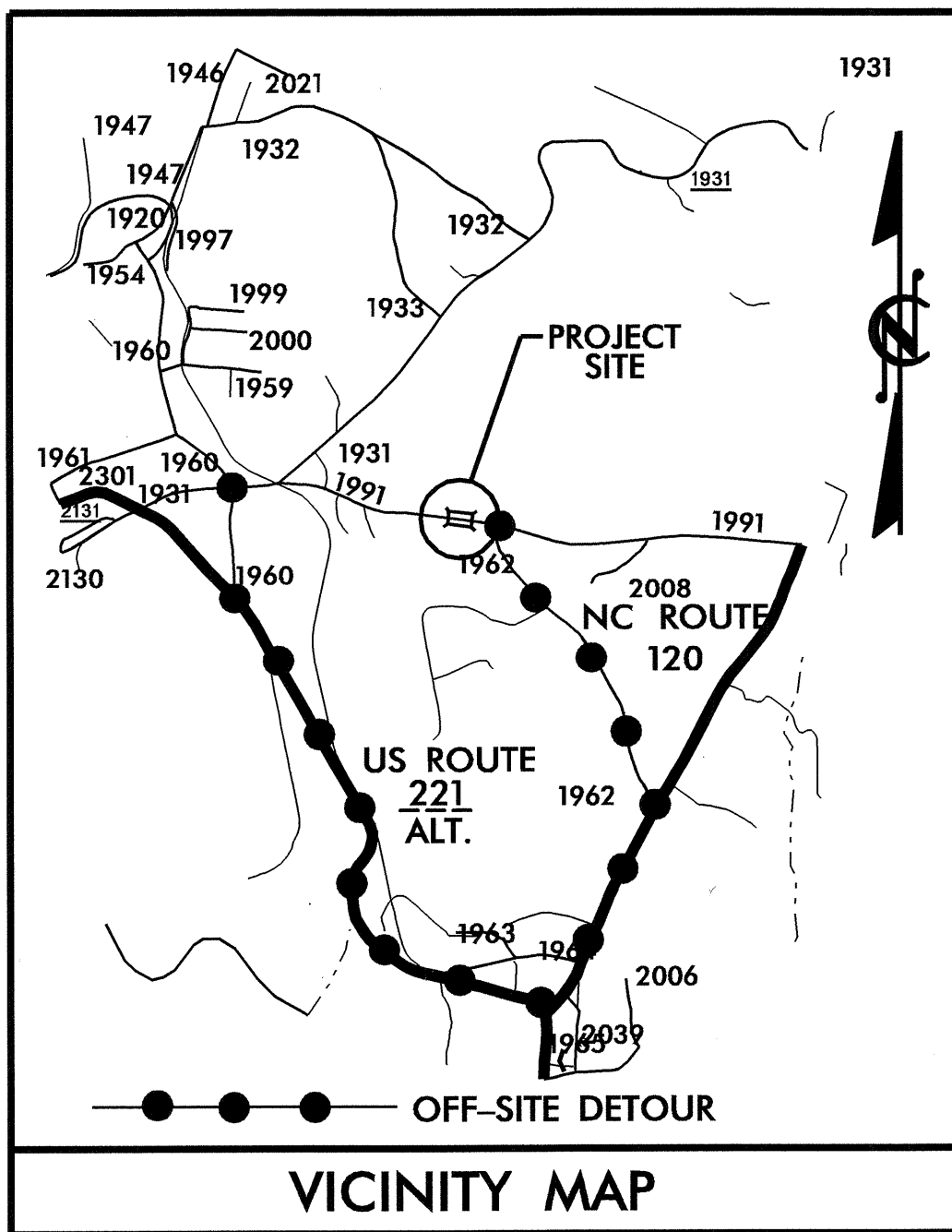

NEAREST SHIPPING POINT: HENRIETTA ON CSX RAILROAD 4.0± MILES FROM BRIDGE

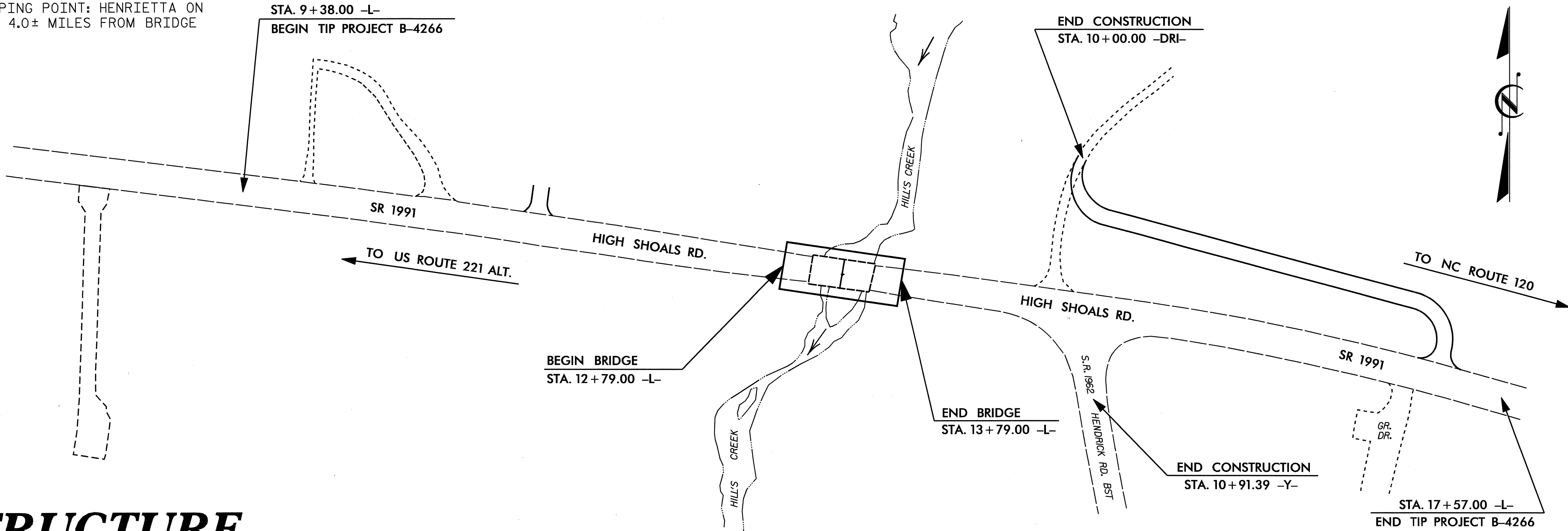

STRUCTURE

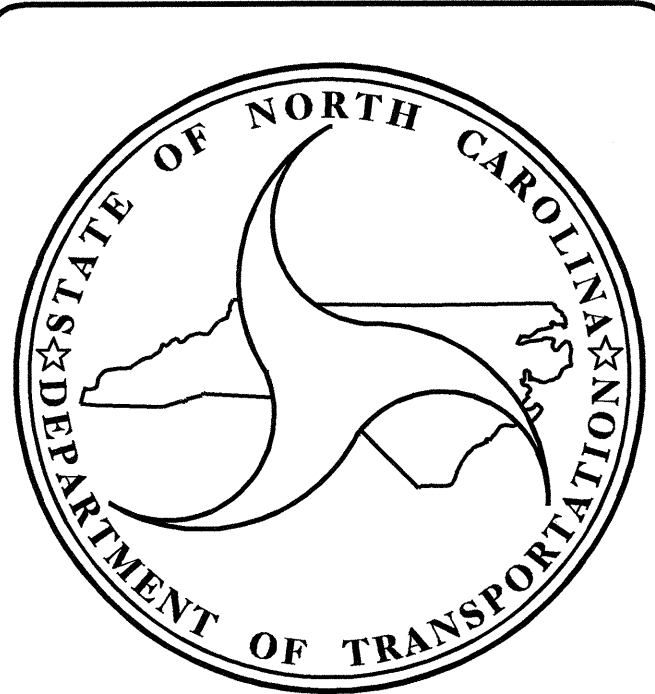

DESIGN DATA

ADT 2002 =	1000
ADT 2025 =	1600
DHV =	10 %
D =	60 %
T =	3 % *
V =	60 MPH
* TTST 1%	DUAL 2%
FUNC. CLASS. =	LOCAL

PROJECT LENGTH

LENGTH ROADWAY OF TIP PROJECT B-4266 =	0.136 MILES
LENGTH STRUCTURE OF TIP PROJECT B-4266 =	0.019 MILES
TOTAL LENGTH OF TIP PROJECT B-4266 =	0.155 MILES

Prepared In the Office of:
DIVISION OF HIGHWAYS
1000 BIRCH RIDGE DR., RALEIGH, N.C. 27610

2002 STANDARD SPECIFICATIONS

<p>LETTING DATE: SEPTEMBER 20, 2005</p>	<p>J. M. BAILEY, P.E. PROJECT ENGINEER</p> <hr/> <p>D. A. DAVENPORT, JR., P.E. PROJECT DESIGN ENGINEER</p>
--	--

STATE BRIDGE DESIGN ENGINEER
STRUCTURE DESIGN UNIT
1000 BIRCH RIDGE DRIVE
RALEIGH, N.C. 27610

Gregory R. Perpetti
8-5-05

**DIVISION OF HIGHWAYS
STATE OF NORTH CAROLINA**

STATE DESIGN ENGINEER _____ P.E.
**DEPARTMENT OF TRANSPORTATION
FEDERAL HIGHWAY ADMINISTRATION**

APPROVED _____ DATE _____
DIVISION ADMINISTRATOR