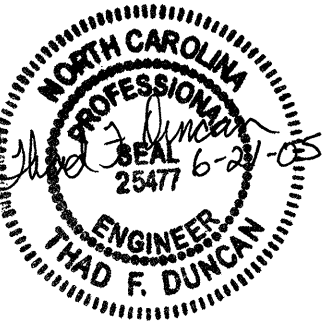
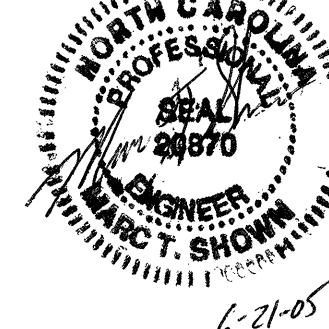

5/28/99

PROJECT REFERENCE NO. B-1303	SHEET NO. 5
ROADWAY DESIGN ENGINEER 	HYDRAULICS ENGINEER 

BM6: RR SPIKE IN BASE OF POWER POLE
TAGGED NCP *M1345611, NORTH SIDE OF US 258
ELEV = 44.64'
COORDINATES: N 911603.9, E 249032.1

STRUCTURE HYDRAULIC DATA

DESIGN DISCHARGE	= 35,000 CFS
DESIGN FREQUENCY	= 50 YR
DESIGN HW ELEVATION	= 35.8 FT
BASE DISCHARGE	= 61,000 CFS
BASE FREQUENCY	= 100 YR
BASE HW ELEVATION	= 39.8 FT
OVERTOPPING DISCHARGE	= N/A CFS
OVERTOPPING FREQUENCY	= 500 YR
OVERTOPPING HW ELEVATION	= N/A FT

BM5: RR SPIKE IN BASE OF POWER POLE
TAGGED NCP *M134567, NORTH SIDE OF US 258
ELEV = 74.50'
COORDINATES: N 912966.3, E 2492438.6

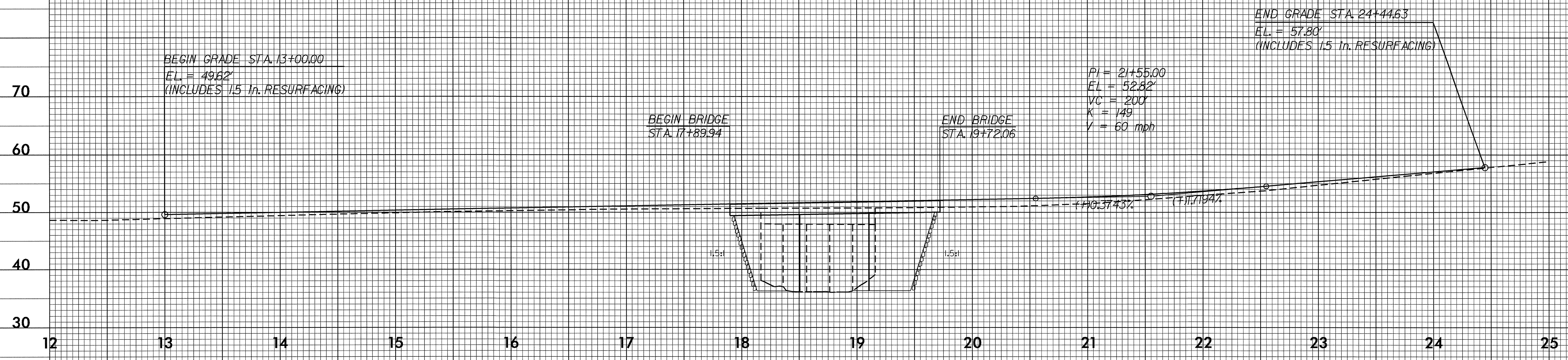
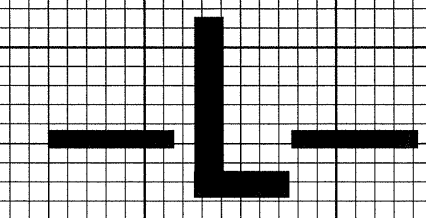

-DET-

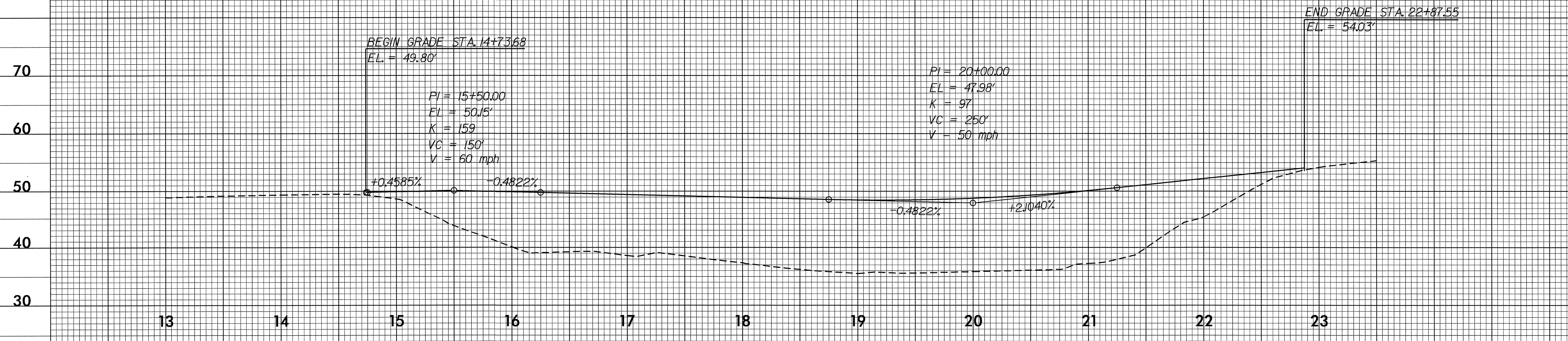

09-JUN-2005 15:08
\\srm\p1\303_rdy_pfl.dgn