

WIDENING OF HANES MALL BLVD.

ALL MARKINGS ARE EXISTING

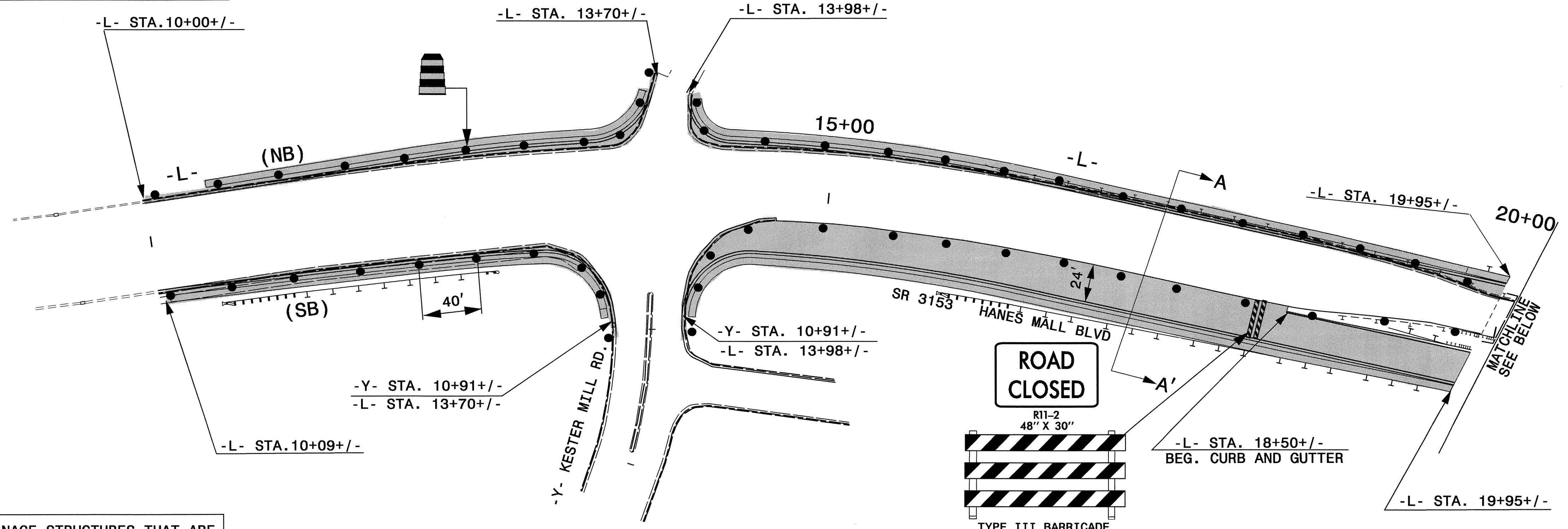

CONSTRUCT DRAINAGE STRUCTURES THAT ARE LOCATED IN THE EXISTING PAVEMENT UP TO THE EXISTING ELEVATION AND COVER WITH A TRAFFIC BEARING STEEL PLATE, AS NEEDED. (SEE ROADWAY PLANS)

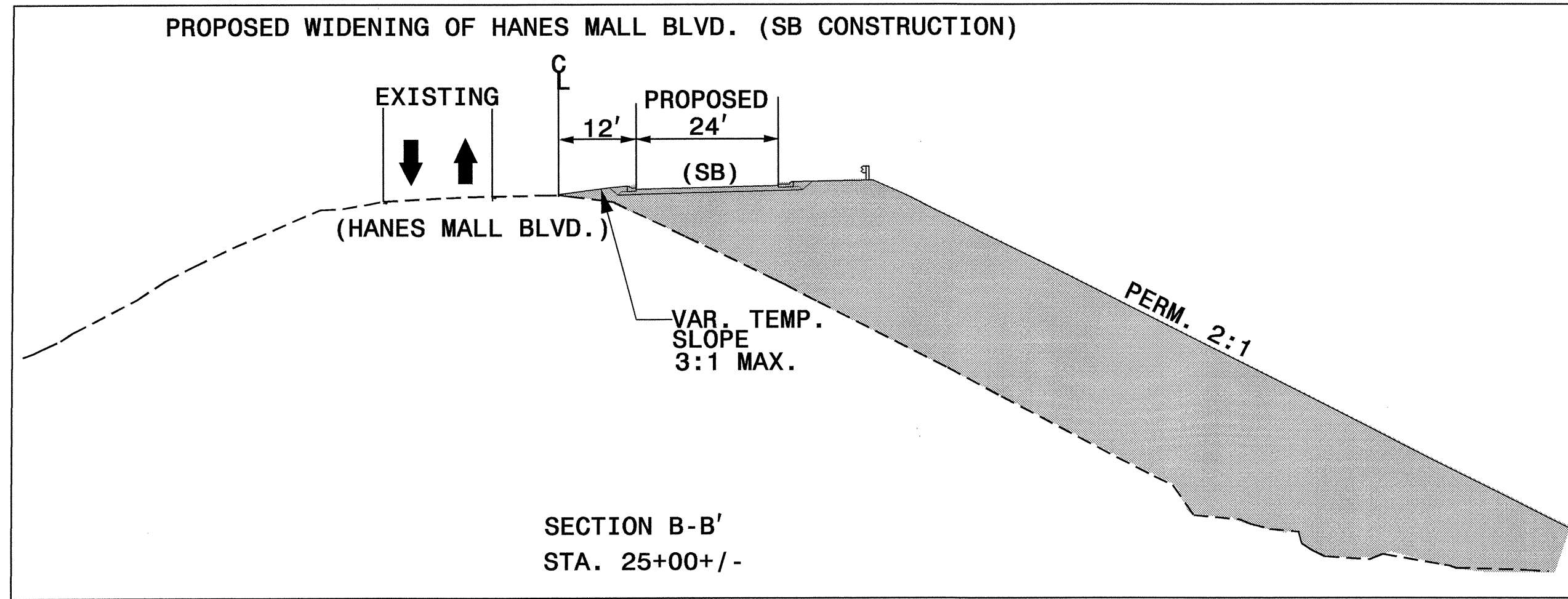
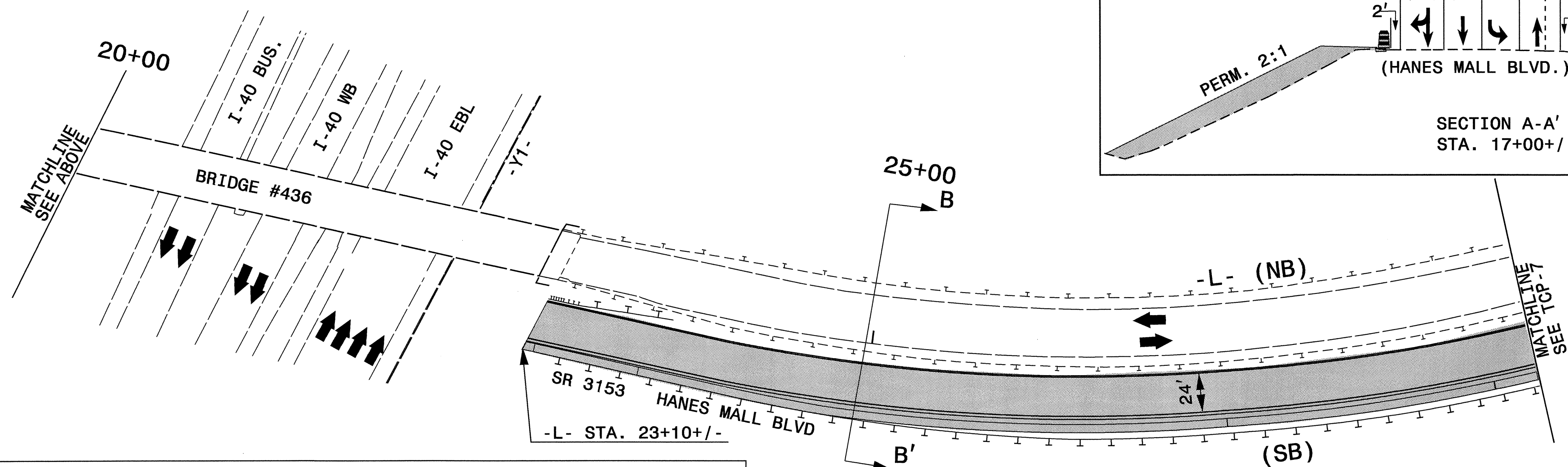
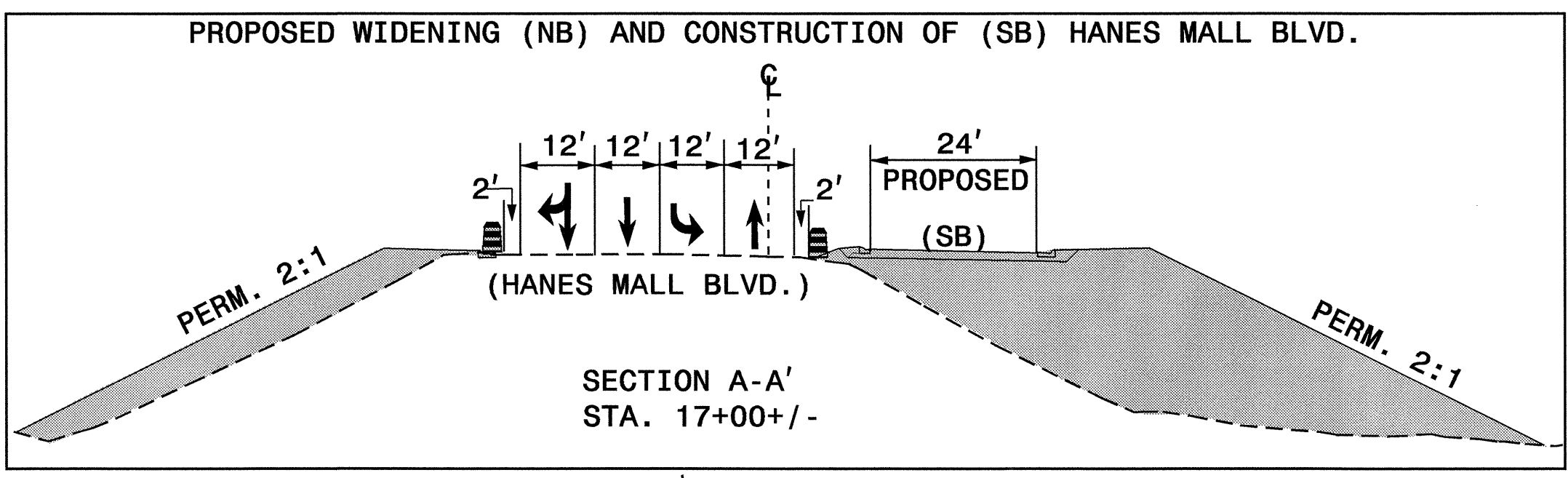

APPROVED: <i>Joseph Ishak</i> DATE: 1/26/05	PHASE I, DETAIL 1	
	SCALE: NONE	
	DATE: NOV 03	
	DWG. BY: MM	
	DESIGN BY: MM	
REVIEWED BY: JI	REVISIONS	

25-JAN-2005 08:48
 e:\s-c\150\N\150374\TCP\TCP+cp-6.dgn
 mmckoy AT 1/10/05 3:45