

WIDENING OF HANES MALL BLVD.

PROJ. REFERENCE NO. U-3837	SHEET NO. TCP-8
-------------------------------	--------------------

ALL MARKINGS ARE EXISTING

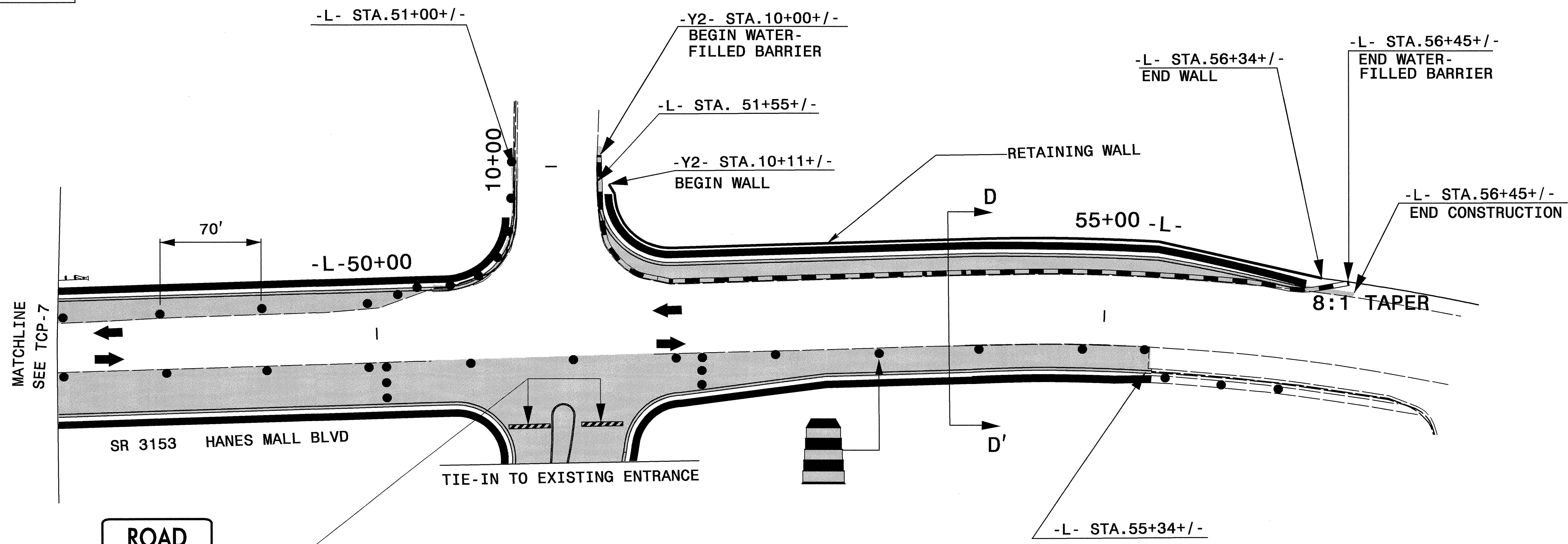

**ROAD
CLOSED**

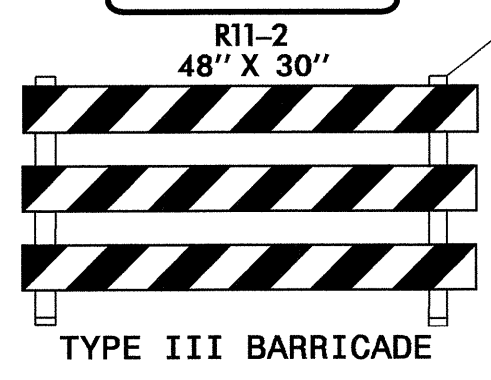

CONSTRUCT DRAINAGE STRUCTURES THAT ARE LOCATED IN THE EXISTING PAVEMENT UP TO THE EXISTING ELEVATION AND COVER WITH A TRAFFIC BEARING STEEL PLATE, AS NEEDED. (SEE ROADWAY PLANS)

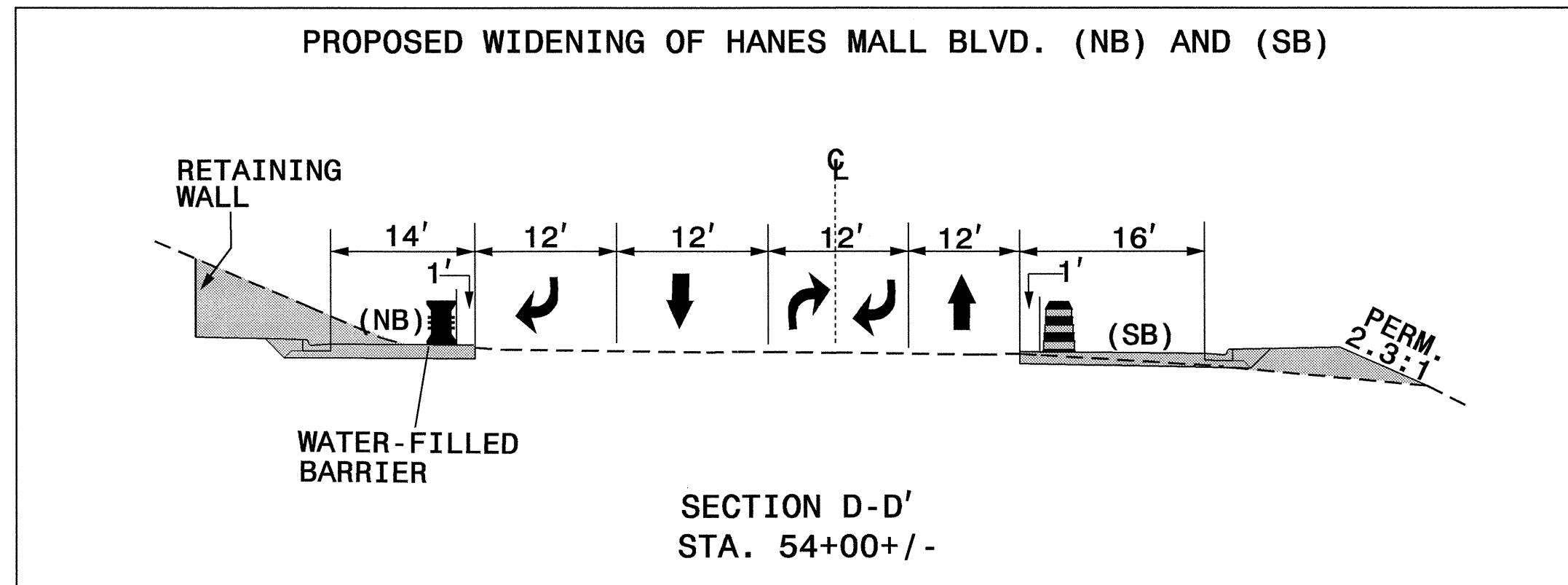

25-JAN-2005 08:56
C:\jtk\cc\fs01\38374\TCP\TCP-8.dgn
mmgkoy AT 11:03:45

APPROVED: <i>Joseph Ishak</i> DATE: 1/26/05	PHASE I, DETAIL 3	
	SCALE: NONE	
	DATE: NOV 03	
	DWG. BY: MM	
	DESIGN BY: MM	
REVIEWED BY: JI	REVISIONS	