

5/28/95

-L- SR 3153 (HANES MALL BLVD.)

PROJECT REFERENCE NO. U-3837		SHEET NO. 9	
ROADWAY DESIGN ENGINEER		HYDRAULICS ENGINEER	
PRELIMINARY PLANS			
DO NOT USE FOR CONSTRUCTION			
INCOMPLETE PLANS			
DO NOT USE FOR R/W ACQUISITION			

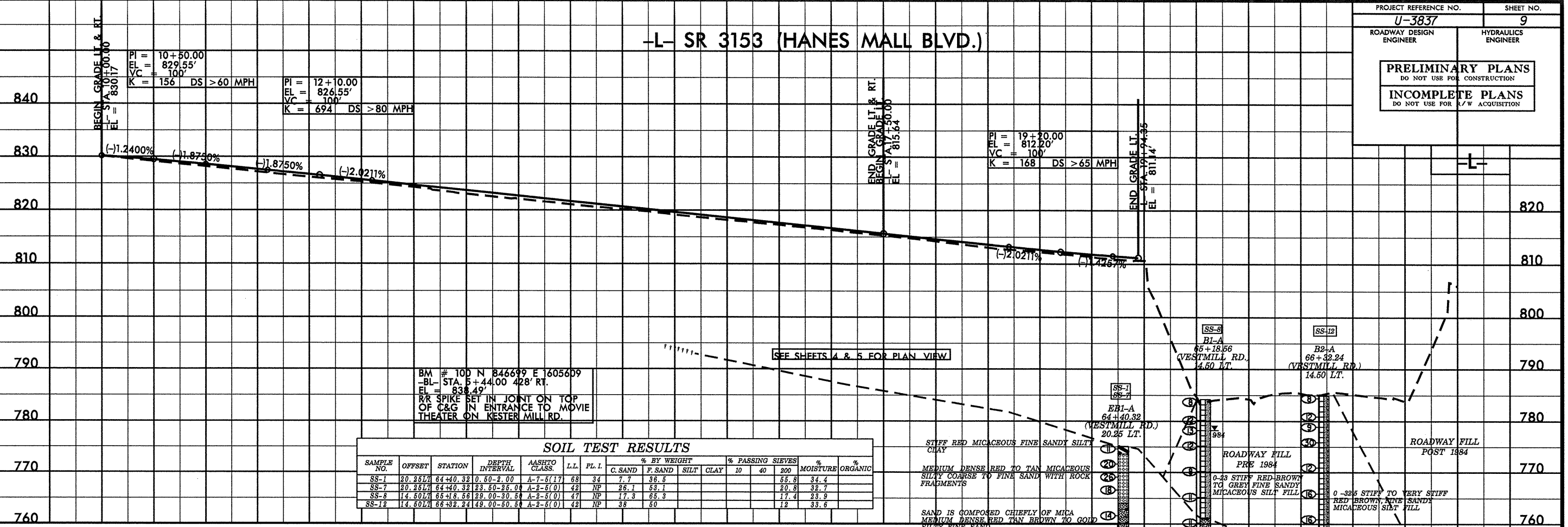

BM # 100 N 846699 E 1605609
 -BL- STA. 5+44.00 428' RT.
 EL = 838.49'
 RR SPIKE SET IN JOINT ON TOP
 OF C&G IN ENTRANCE TO MOVIE
 THEATER ON KESTER MILL RD.

SOIL TEST RESULTS

SAMPLE NO.	OFFSET	STATION	DEPTH INTERVAL	AASHTO CLASS.	L.L.	P.L.	% BY WEIGHT				% PASSING SIEVES		MOISTURE	% ORGANIC
							C. SAND	F. SAND	SILT	CLAY	10	40		
SS-1	20.26 LT	64+40.32	0.50-2.00	A-7-5(17)	68	34	7.7	36.5				55.8	34.4	
SS-7	20.26 LT	64+40.32	23.50-25.00	A-2-5(0)	42	NP	26.1	58.1				20.8	32.7	
SS-8	14.50 LT	66+18.56	28.00-30.50	A-2-5(0)	47	NP	17.3	65.3				17.4	23.9	
SS-12	14.50 LT	66+32.24	49.00-50.50	A-2-5(0)	42	NP	38	50				12	33.6	

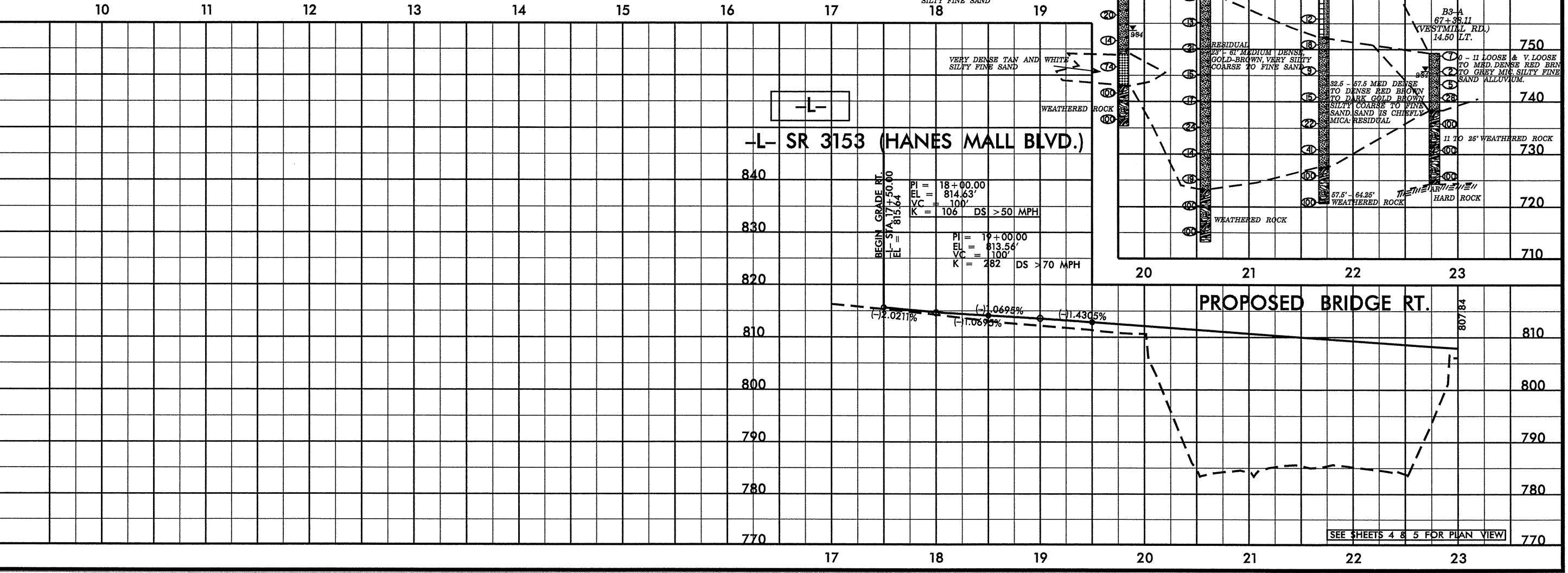

SEE SHEETS 4 & 5 FOR PLAN VIEW