

SPAN "A"

SPAN "B"

PARTIAL PLAN OF SPAN

NOTES

- FOR BARRIER RAIL REINFORCING STEEL, SEE "CONCRETE BARRIER RAIL" SHEET.
- FOR SIDEWALK REINFORCING STEEL, SEE "SIDEWALK DETAILS" SHEET.
- FOR SECTIONS A-A & B-B, SEE "TYPICAL SECTIONS & DETAILS" SHEET.
- THE #4 B2 BARS SHALL BE SPLICED TO THE #6 B4 BARS WITH A 2'-0" MINIMUM SPLICE.
- FOR TRANSVERSE CONST. JT. DETAILS, SEE "SUPERSTRUCTURE - BILL OF MATERIAL" SHEET

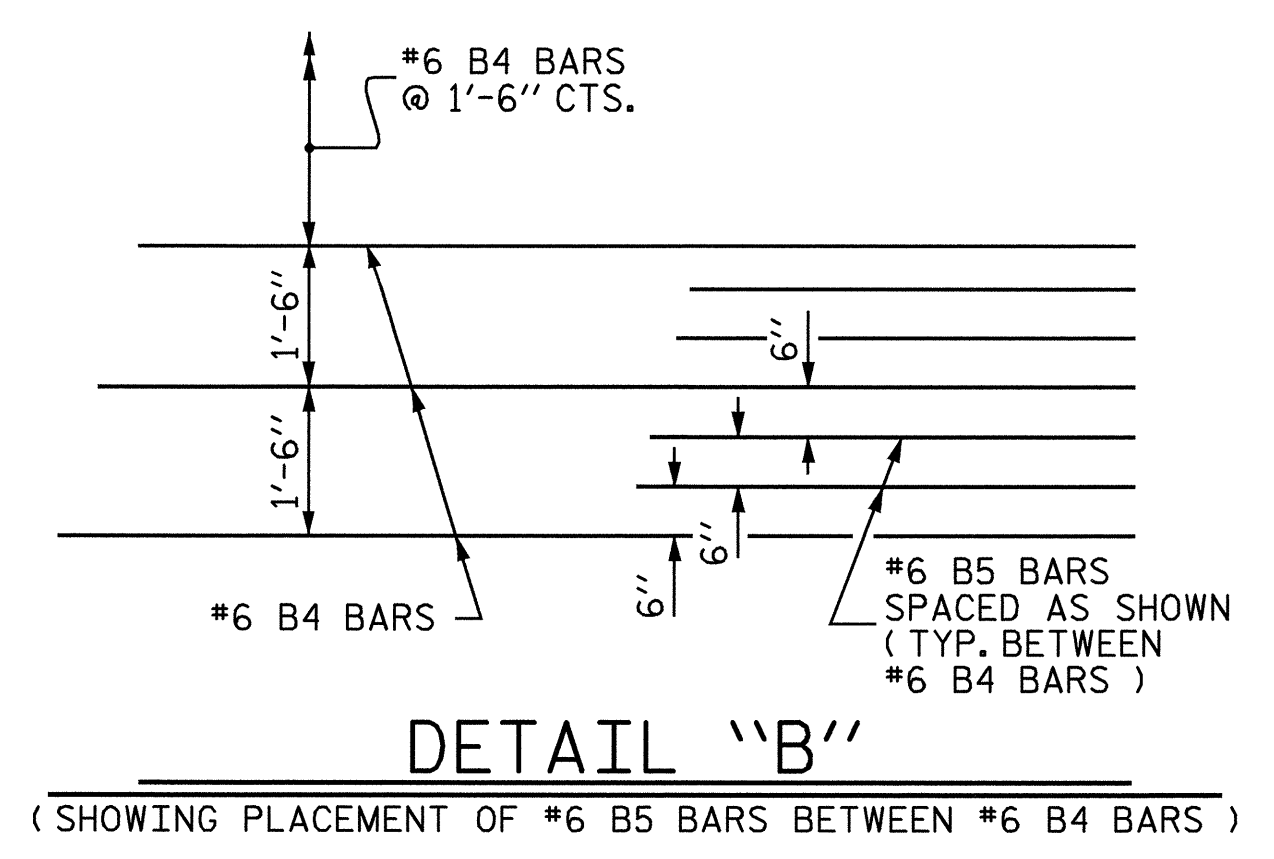

PROJECT NO. U-3837  
 FORSYTH COUNTY  
 STATION: 21+64.07 -L-

SHEET 1 OF 2

STATE OF NORTH CAROLINA  
 DEPARTMENT OF TRANSPORTATION  
 RALEIGH

SUPERSTRUCTURE  
 PLAN OF SPAN  
 (RIGHT LANE)

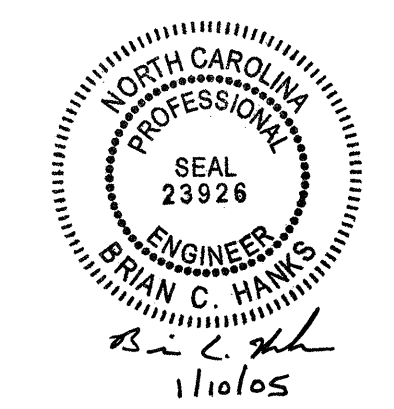

REVISIONS						SHEET NO.	
NO.	BY:	DATE:	NO.	BY:	DATE:	S-51	
1			3			TOTAL SHEETS	78
2			4				

DRAWN BY: MIKE BRITT DATE: 11-19-03  
 CHECKED BY: William J. Parker DATE: 05/26/04