

**BILL OF MATERIAL**

BAR	NO.	SIZE	TYPE	LENGTH	WEIGHT
A1	218	7	1	10'- 6"	4679
A2	218	7	1	8'- 2"	3639
A100	81	5	STR.	26'- 9"	2260
A101	4	5	STR.	24'- 8"	103
A102	4	5	STR.	22'-10"	95
A103	4	5	STR.	20'-11"	87
A104	4	5	STR.	19'- 1"	80
A105	4	5	STR.	17'- 2"	72
A106	4	5	STR.	15'- 4"	64
A107	4	5	STR.	13'- 5"	56
A108	4	5	STR.	11'- 7"	48
A109	4	5	STR.	9'- 8"	40
A110	4	5	STR.	7'-10"	33
A111	4	5	STR.	5'-11"	25
A112	4	5	STR.	4'- 1"	17
A113	4	5	STR.	2'- 2"	9
A200	95	5	STR.	13'- 0"	1288
A201	2	5	STR.	10'-11"	23
A202	2	5	STR.	9'- 1"	19
A203	2	5	STR.	7'- 2"	15
A204	2	5	STR.	5'- 4"	11
A205	2	5	STR.	11'- 7"	24
A206	2	5	STR.	9'- 8"	20
A207	2	5	STR.	7'-10"	16
A208	2	5	STR.	5'-11"	12
A209	2	5	STR.	4'- 1"	9
A210	2	5	STR.	2'- 2"	5
A250	91	5	STR.	16'- 2"	1534
A251	2	5	STR.	15'- 4"	32
A252	2	5	STR.	13'- 5"	28
A253	2	5	STR.	11'- 7"	24
A254	2	5	STR.	9'- 8"	20
A255	2	5	STR.	7'-10"	16
A256	2	5	STR.	5'-11"	12
A257	2	5	STR.	4'- 1"	9
A258	2	5	STR.	2'- 2"	5
A259	2	5	STR.	14'- 1"	29
A260	2	5	STR.	12'- 3"	26
A261	2	5	STR.	10'- 4"	22
A262	2	5	STR.	8'- 6"	18
A263	2	5	STR.	6'- 7"	14
A264	2	5	STR.	4'- 9"	10
A300	81	6	STR.	26'- 9"	3254
A301	4	6	STR.	24'- 8"	148
A302	4	6	STR.	22'-10"	137
A303	4	6	STR.	20'-11"	126
A304	4	6	STR.	19'- 1"	115
A305	4	6	STR.	17'- 2"	103
A306	4	6	STR.	15'- 4"	92
A307	4	6	STR.	13'- 5"	81
A308	4	6	STR.	11'- 7"	70
A309	4	6	STR.	9'- 8"	58
A310	4	6	STR.	7'-10"	47
A311	4	6	STR.	5'-11"	36
A312	4	6	STR.	4'- 1"	25
A313	4	6	STR.	2'- 2"	13
A400	95	6	STR.	13'- 0"	1855
A401	2	6	STR.	10'-11"	33
A402	2	6	STR.	9'- 1"	27
A403	2	6	STR.	7'- 2"	22
A404	2	6	STR.	5'- 4"	16
A405	2	6	STR.	11'- 7"	35
A406	2	6	STR.	9'- 8"	29
A407	2	6	STR.	7'-10"	24
A408	2	6	STR.	5'-11"	18
A409	2	6	STR.	4'- 1"	12
A410	2	6	STR.	2'- 2"	7
A450	91	6	STR.	16'- 2"	2210
A451	2	6	STR.	15'- 4"	46
A452	2	6	STR.	13'- 5"	40
A453	2	6	STR.	11'- 7"	35
A454	2	6	STR.	9'- 8"	29
A455	2	6	STR.	7'-10"	24
A456	2	6	STR.	5'-11"	18
A457	2	6	STR.	4'- 1"	12
A458	2	6	STR.	2'- 2"	7
A459	2	6	STR.	14'- 1"	42
A460	2	6	STR.	12'- 3"	37
A461	2	6	STR.	10'- 4"	31
A462	2	6	STR.	8'- 6"	26
A463	2	6	STR.	6'- 7"	20
A464	2	6	STR.	4'- 9"	14
B1	218	6	STR.	13'- 3"	4339
B2	218	5	STR.	9'- 4"	2122
B3	436	4	STR.	13'- 3"	3859
C1	411	4	STR.	21'- 1"	5788
D1	54	6	STR.	2'- 6"	203
G1	4	5	STR.	30'-11"	129
S1	3	8	STR.	17'- 1"	137
S2	6	6	STR.	15'- 0"	135
S3	3	8	STR.	18'- 9"	150
S4	6	6	STR.	18'- 9"	169
S5	3	8	STR.	30'-11"	248
S6	6	6	STR.	30'-11"	279

REINFORCING STEEL - LBS. 41080

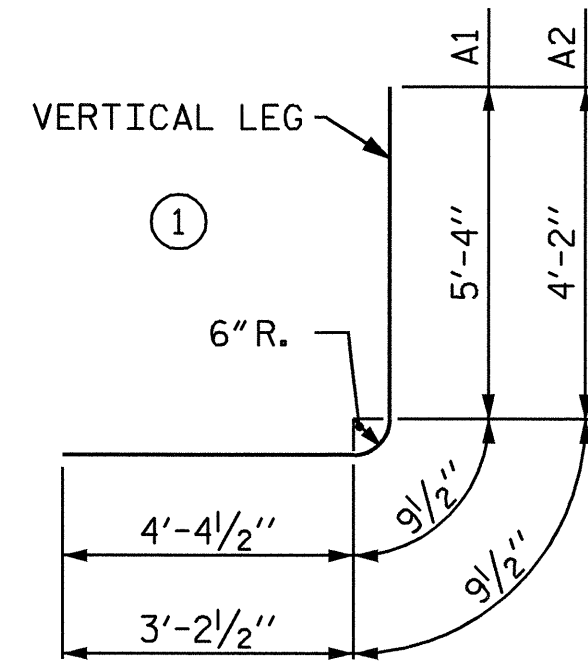

**BAR TYPE**

BAR DIMENSIONS ARE OUT TO OUT

**SPLICE CHART**

BAR	SIZE	SPLICE LENGTH
A200	5	2'- 5"
A400	6	2'- 4"
B1	6	2'- 4"
B3	4	1'- 9"
C1	4	1'-11"
S1	8	4'-11"
S2	6	2'- 9"

DRAWN BY: William F. Parker DATE: 10/13/03  
 CHECKED BY: A.B. NAIK DATE: 11/26/03

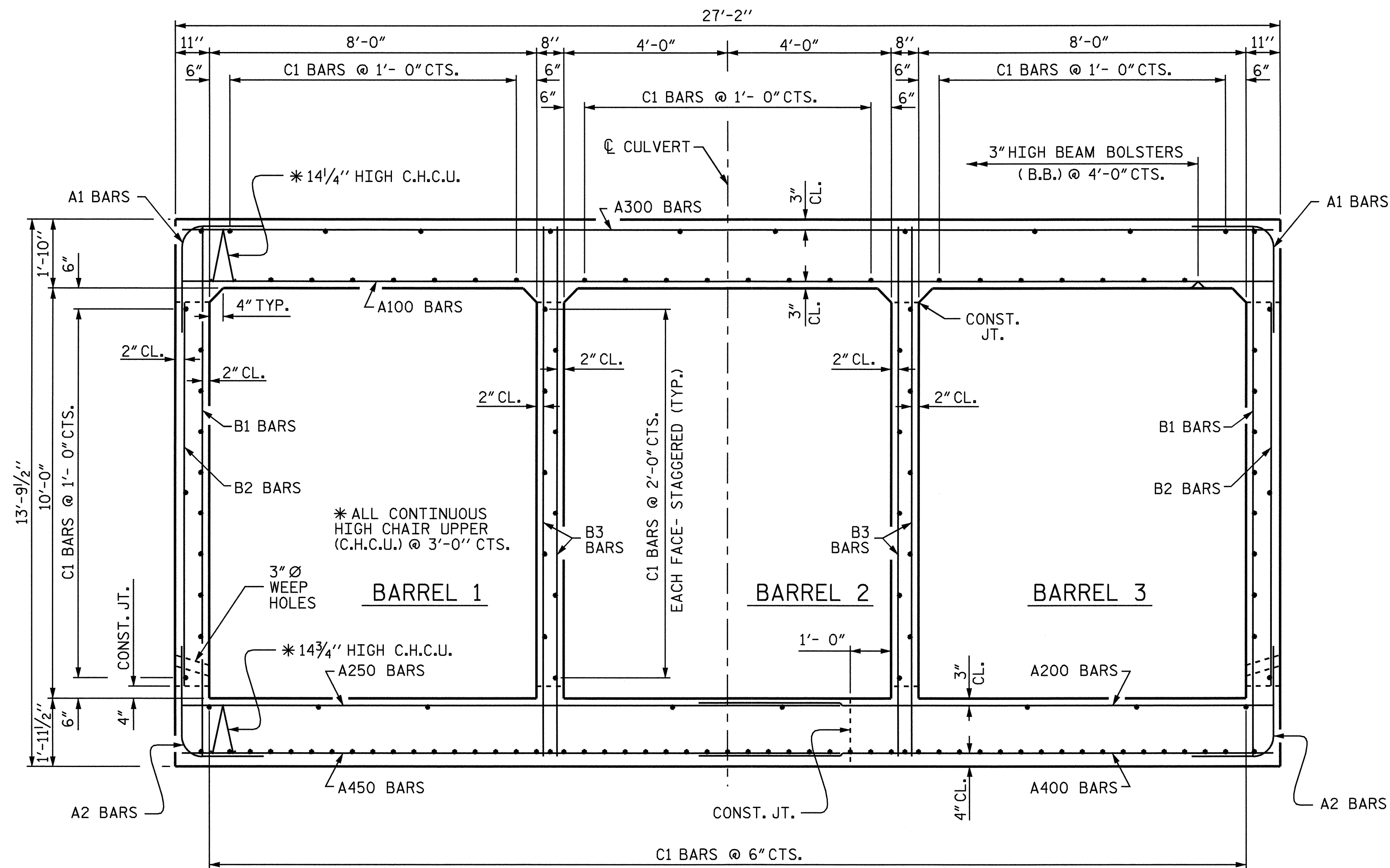

**RIGHT ANGLE SECTION OF BARREL**

(LOOKING UPSTREAM)

THERE ARE 137 "C" BARS IN SECTION OF BARREL.

PROJECT NO. U-3837  
FORSYTH COUNTY  
 STATION: 24+21.46 -L-

SHEET 3 OF 6

STATE OF NORTH CAROLINA  
 DEPARTMENT OF TRANSPORTATION  
 RALEIGH  
**TRIPLE 8 FT. X 10 FT.  
 CONCRETE BOX CULVERT  
 EXTENSION  
 60° SKEW**

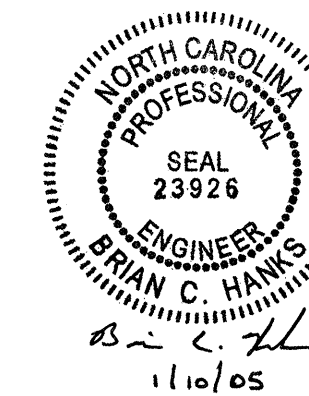

REVISIONS						SHEET NO.
NO.	BY:	DATE:	NO.	BY:	DATE:	C-3
1			3			TOTAL SHEETS
2			4			6