

BENCH MARK #102 : RAILROAD SPIKE SET IN JOINT ON TOP OF CURB AND GUTTER IN FRONT OF TARGET PARKING LOT, 72' LEFT OF -BL- STA. 45+71.00 ELEV. 751.06

F.A. PROJECT NO. STP-3153 (2)

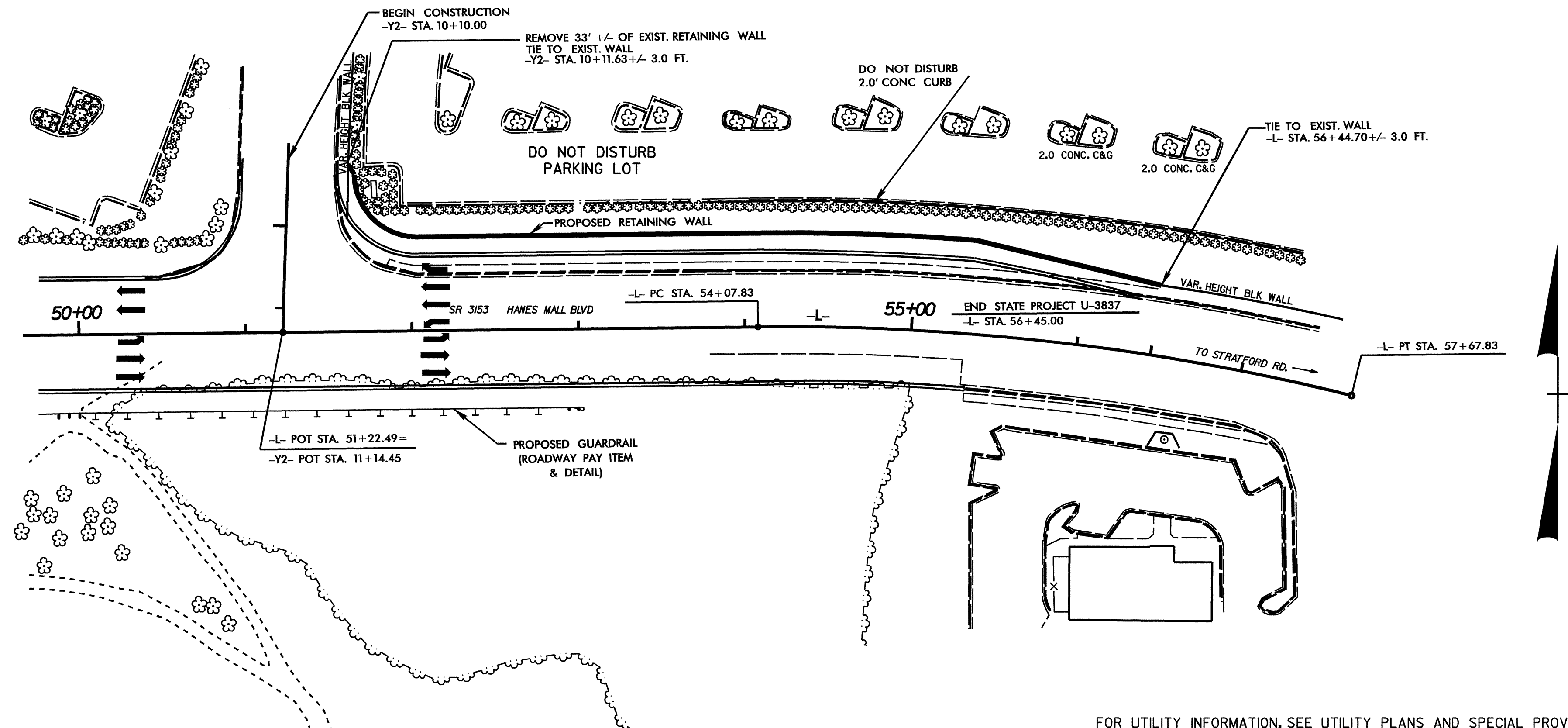

FOR UTILITY INFORMATION, SEE UTILITY PLANS AND SPECIAL PROVISIONS.

WALL OFFSETS AND ELEVATIONS

-Y2- STATION	OFFSET LEFT	TOP OF WALL ELEVATION	GRADE AT FRONT FACE OF WALL	BOTTOM OF WALL ELEVATION
10+11.63	35.90	790.15	783.30	781.30
10+30.00	42.49	790.85	783.56	781.56
10+50.00	60.31	787.71	783.13	781.13
-L- STATION	OFFSET LEFT	TOP OF WALL ELEVATION	GRADE AT FRONT FACE OF WALL	BOTTOM OF WALL ELEVATION
52+00	57.00	787.08	782.02	780.02
52+50	56.75	786.80	781.23	779.23
53+00	56.75	786.18	780.50	778.50
53+50	56.75	785.64	780.31	778.31
54+00	56.75	785.11	780.31	778.31
54+50	56.75	784.57	780.32	778.32
55+00	56.75	784.04	779.77	777.77
55+50	54.15	783.50	779.04	777.04
56+00	47.15	781.13	778.00	776.00
56+44.70	42.46	780.31	777.07	775.07

TOTAL BILL OF MATERIAL

	MODULAR BLOCK RETAINING WALL AT STA. 51+85.44 -L-
TOTAL	LUMP SUM

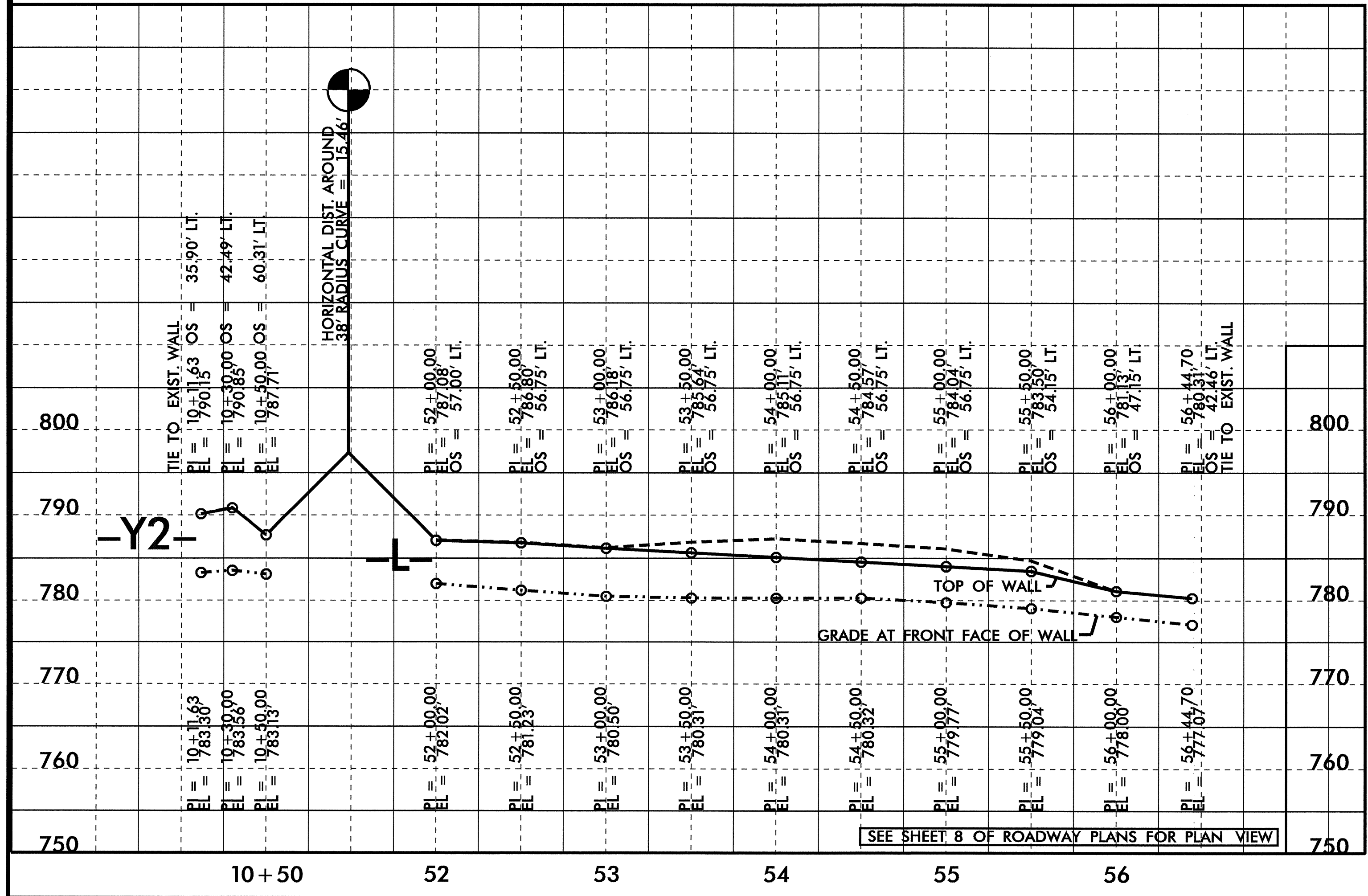

PROJECT NO. U-3837
FORSYTH COUNTY
 STATION: 51+85.44 -L-
 SHEET 1 OF 2



STATE OF NORTH CAROLINA
 DEPARTMENT OF TRANSPORTATION
 RALEIGH

MODULAR BLOCK RETAINING WALL DETAIL

REVISIONS						SHEET NO. W-1
NO.	BY:	DATE:	NO.	BY:	DATE:	
1			3			TOTAL SHEETS 2
2			4			