

8/17/99

PROJECT REFERENCE NO.		SHEET NO.	
B-3822		EC-6/CONST.4	
RW SHEET NO.			
ROADWAY DESIGN ENGINEER		HYDRAULICS ENGINEER	

DESIGN EXCEPTION REQUIRED FOR THE DESIGN SPEED FROM 60 MPH TO 30 MPH.

-L-

PI Sta 11+96.26 Δ = 1° 40' 37.0" (RT) D = 0' 38' 32.4" L = 261.07' T = 130.55' R = 8,920.00' RO = 150 SE = NC	PI Sta 17+24.25 Δ = 16° 29' 39.0" (LT) D = 11' 27' 33.0" L = 143.94' T = 72.47' R = 500.00' RO = 150 SE = 06 V = 40 MPH	PI Sta 19+15.38 Δ = 19° 24' 04.0" (LT) D = 8' 11' 06.4" L = 237.03' T = 119.66' R = 700.00' RO = 150 SE = 06 V = 46 MPH
--	---	---

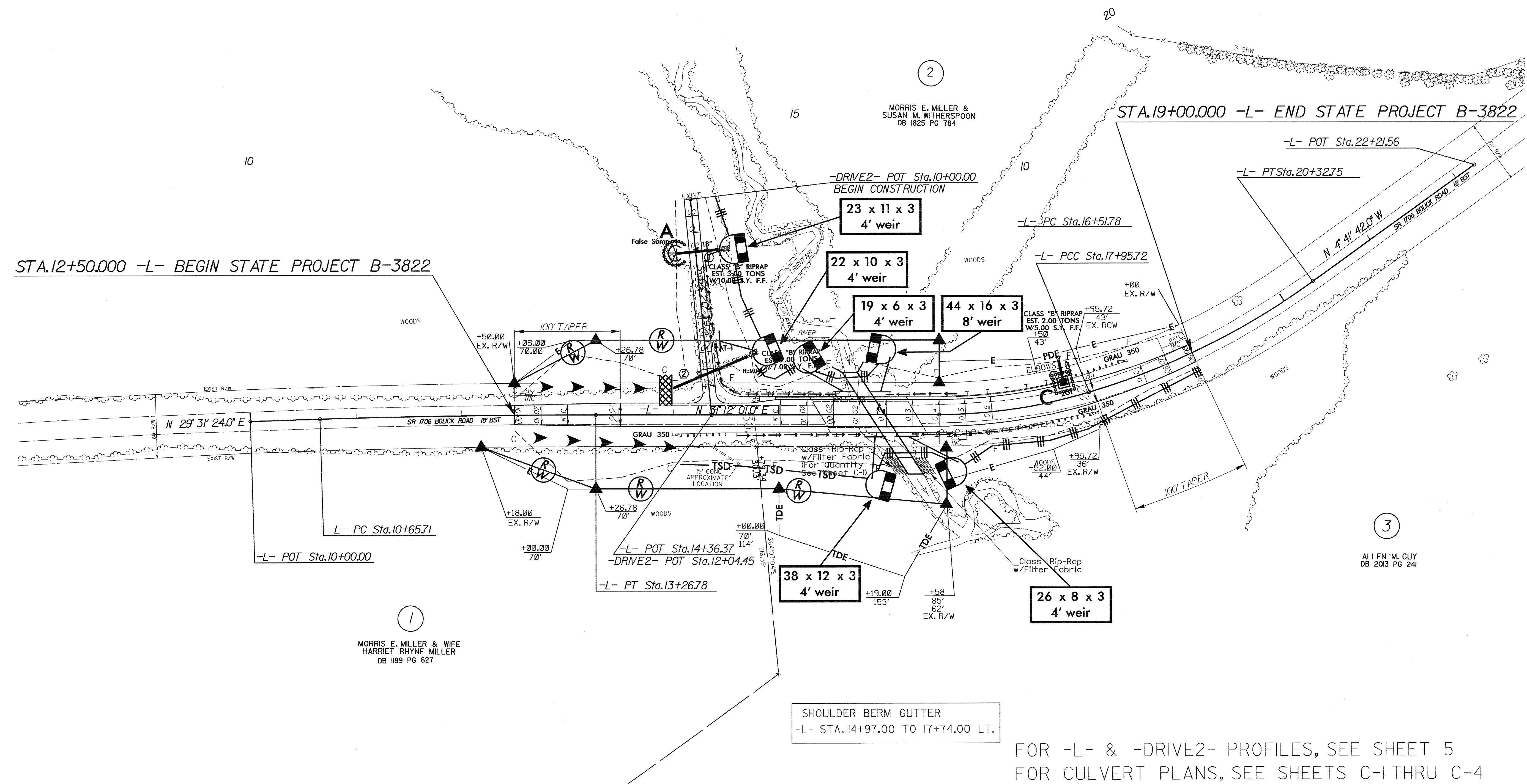
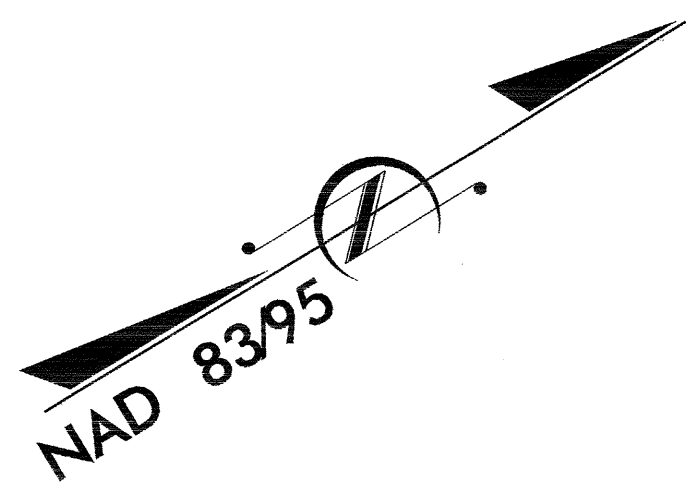

13-MAY-2005 08:27
d:\reut\p\br\idg\B-3822\proj\NB3822.psh
Jsgoodwin AT RENV21500

(1)
MORRIS E. MILLER & WIFE
HARRIET RHYNE MILLER
DB 1189 PG 627

(3)
ALLEN M. GUY
DB 2013 PG 241

SHOULDER BERM GUTTER
-L- STA. 14+97.00 TO 17+74.00 LT.

FOR -L- & -DRIVE2- PROFILES, SEE SHEET 5
FOR CULVERT PLANS, SEE SHEETS C-1 THRU C-4