

CONTRACT: C201185 TIP PROJECT: B-3899

STATE	STATE PROJECT REFERENCE NO.	
N.C.	B-3899	
STATE PROJ. NO.	F.A. PROJ. NO.	DESCRIPTION
33335.1.1	BRZ-1001(23)	P.E.
33335.2.2	BRZ-1001(23)	R/W & UTIL.
33335.3.1	BRZ-1001(23)	CONST.

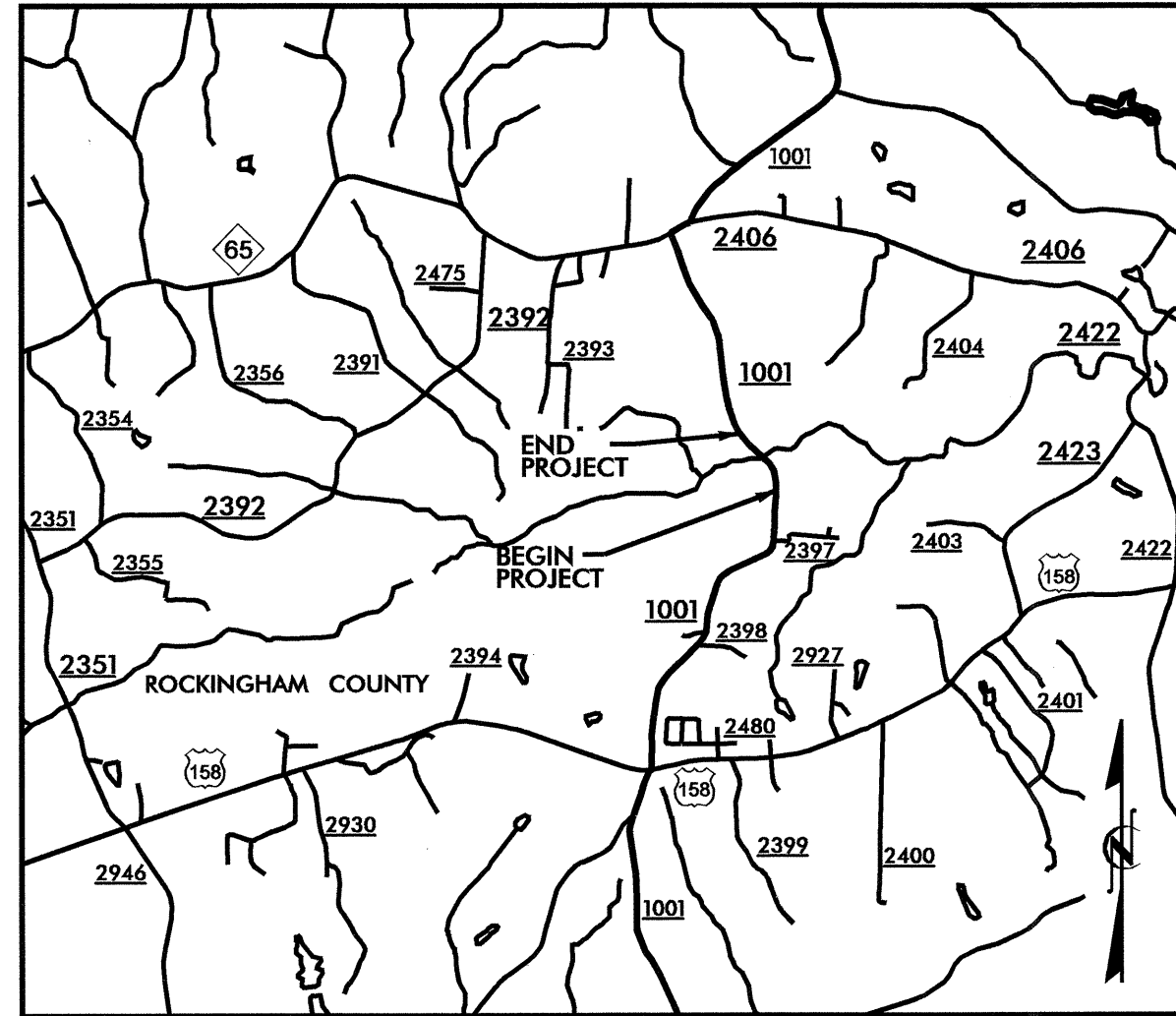

VICINITY MAP

STATE OF NORTH CAROLINA
DIVISION OF HIGHWAYS
ROCKINGHAM COUNTY

**LOCATION: REPLACE BRIDGE NO. 21 AND APPROACHES
ON SR 1001 OVER TROUBLESOME CREEK**

TYPE OF WORK: GRADING, PAVING, DRAINAGE, AND STRUCTURE

STRUCTURE

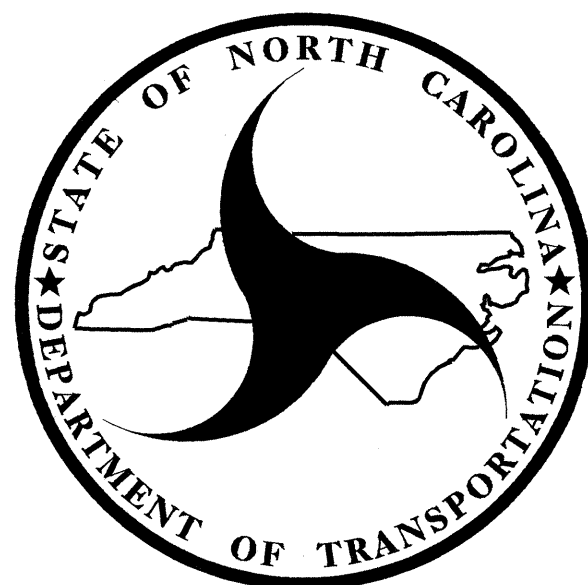
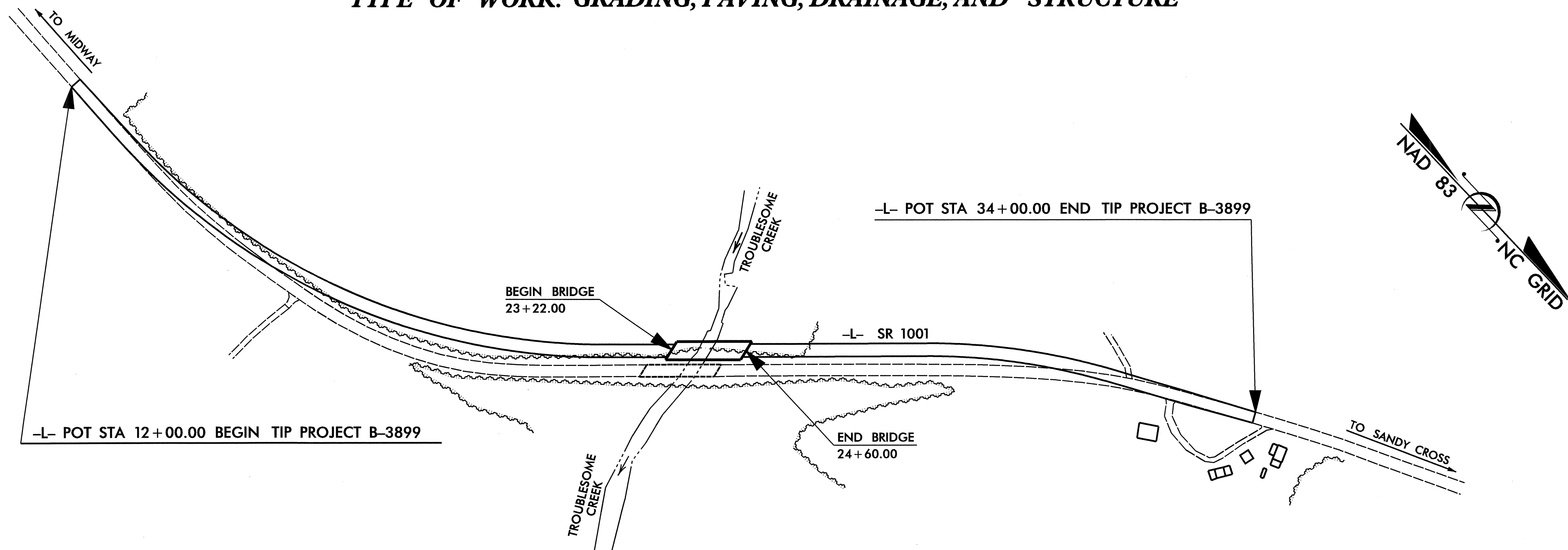

DESIGN DATA

ADT 2005 =	2,484
ADT 2025 =	3,900
DHV =	13 %
D =	60 %
T =	3 % *
V =	55 MPH
* TTST 1 %	DUAL 2 %

PROJECT LENGTH

LENGTH ROADWAY TIP PROJECT B-3899 =	0.391 mi
LENGTH STRUCTURE TIP PROJECT B-3899 =	0.026 mi
TOTAL LENGTH OF TIP PROJECT B-3899 =	0.417 mi

2002 STANDARDS SPECIFICATION

LETTING DATE:
AUGUST 16, 2005

Prepared In the Office of:
**DEPARTMENT OF TRANSPORTATION
DIVISION OF HIGHWAYS**
1000 Birch Ridge Drive Raleigh, N.C. 27610

B. S. COX, P. E.
PROJECT ENGINEER

T. J. BEACH, P. E.
PROJECT DESIGN ENGINEER

STRUCTURE DESIGN UNIT

Gregory R. Peretti
 6.24.05

DIVISION OF HIGHWAYS
STATE OF NORTH CAROLINA

P.E.
 STATE HIGHWAY ENGINEER - DESIGN
**DEPARTMENT OF TRANSPORTATION
FEDERAL HIGHWAY ADMINISTRATION**

APPROVED FOR
DIVISION ADMINISTRATOR

DATE