

5/14/99

PROJECT REFERENCE NO. B-3681	SHEET NO. 7
ROADWAY DESIGN ENGINEER NORTH CAROLINA PROFESSIONAL ENGINEER SEAL 27771 MICHAEL B. COPPLE 6/10/05	HYDRAULICS ENGINEER NORTH CAROLINA PROFESSIONAL ENGINEER SEAL 18442 RICHARD BOLLEA 6-10-05

B.M.\*3 ELEV. = 76.94'  
RR SPIKE IN 36" PINE  
65.4' RT. OF -BL- STA. 30+95.1

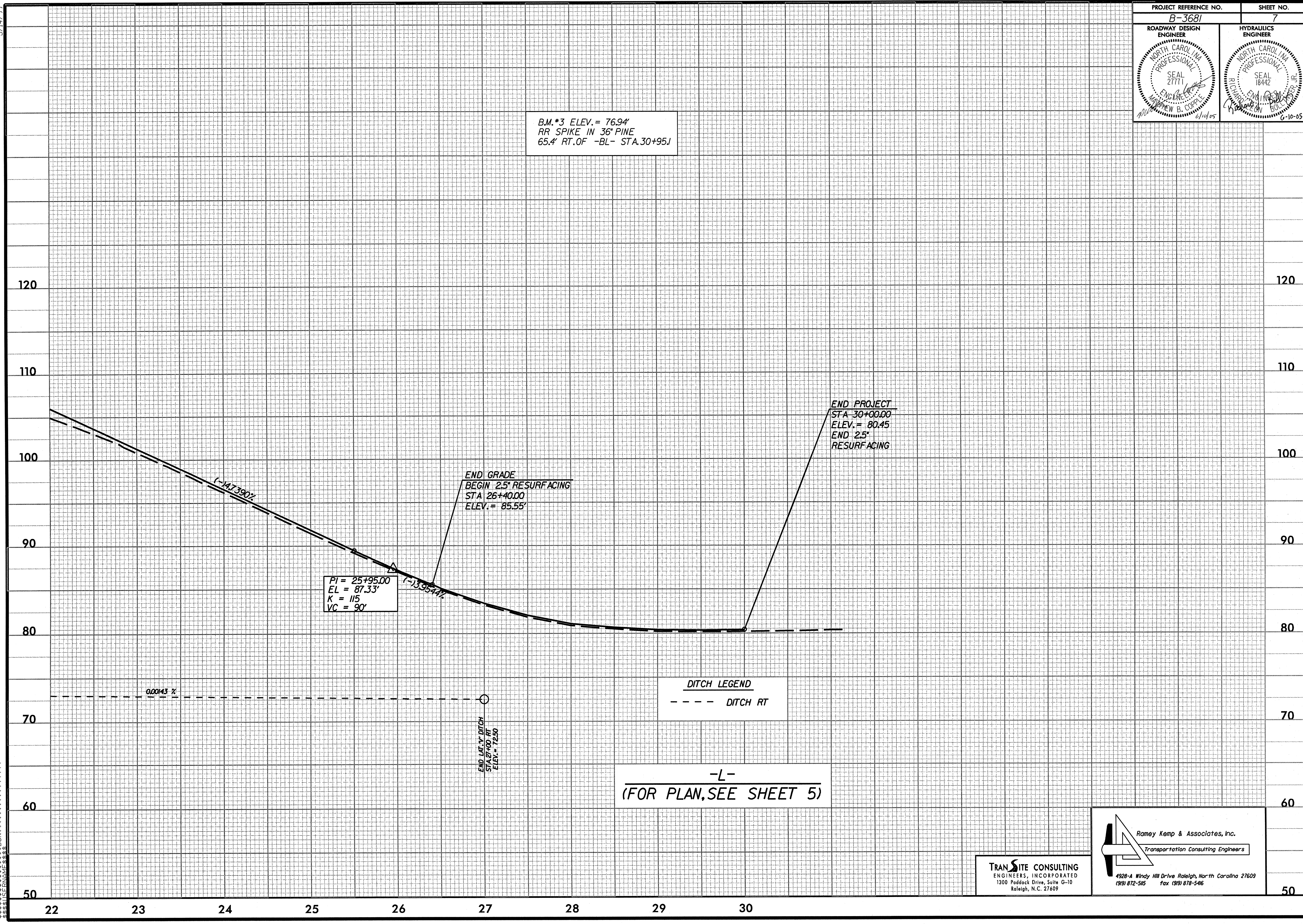

PI = 25+95.00  
EL = 87.33'  
K = 115  
VC = 90'

END GRADE  
BEGIN 2.5" RESURFACING  
STA 26+40.00  
ELEV. = 85.55'

END PROJECT  
STA 30+00.00  
ELEV. = 80.45  
END 2.5"  
RESURFACING

DITCH LEGEND  
- - - - DITCH RT

-L-  
(FOR PLAN, SEE SHEET 5)

END LAT. Y DITCH  
STA 27+00 RT  
ELEV. = 72.50

0.00143 %

(-14.7390%)

(-13.9544%)

SYTIME\$EDON\$

TRANSITE CONSULTING  
ENGINEERS, INCORPORATED  
1300 Paddock Drive, Suite G-10  
Raleigh, N.C. 27609

Ramey Kemp & Associates, Inc.  
Transportation Consulting Engineers  
4928-A Windy Hill Drive Raleigh, North Carolina 27609  
(919) 872-545 Fax (919) 878-5416