

TOTAL BILL OF MATERIAL																
	REMOVAL OF EXISTING STRUCTURE	UNCLASSIFIED STRUCTURE EXCAVATION	REINFORCED CONCRETE DECK SLAB	GROOVING BRIDGE FLOORS	CLASS A CONCRETE	BRIDGE APPROACH SLABS	REINFORCING STEEL	STRUCTURAL STEEL	HP 12 X 53 STEEL PILES	PP 24 X 0.50 STEEL PILES	CONCRETE BARRIER RAIL	4" SLOPE PROTECTION	ELASTOMERIC BEARINGS	EVAZOTE JOINT SEALS		
	LUMP SUM	CU. YDS.	SQ. FT.	SQ. FT.	CU. YDS.	LUMP SUM	LBS.	APPROX. LBS.	NO.	LIN. FT.	NO.	LIN. FT.	LIN. FT.	SQ. YDS.	LUMP SUM	LUMP SUM
SUPERSTRUCTURE			9934	10253		LUMP SUM		271,900					459.36		LUMP SUM	LUMP SUM
END BENT 1		2110			33.2		5307		8	360				375		
BENT 1					24.7		3337				8	440				
BENT 2					24.6		3335				8	360				
END BENT 2		790			32.7		5232		8	360				380		
TOTAL	LUMP SUM	2900	9934	10253	115.2	LUMP SUM	17211	271,900	16	720	16	800	459.36	755	LUMP SUM	LUMP SUM

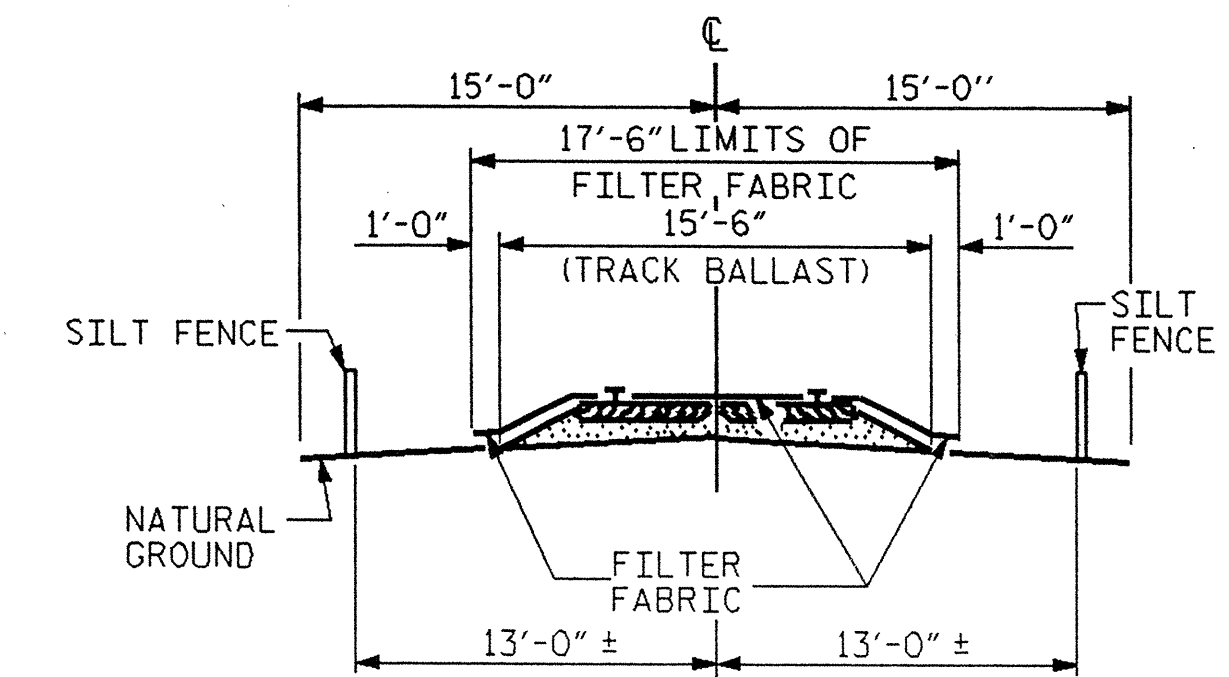

* STEEL PROTECTOR PLATES SHALL BE USED TO PROTECT THE EXISTING FIBER OPTIC LINES. SEE SPECIAL PROVISIONS.

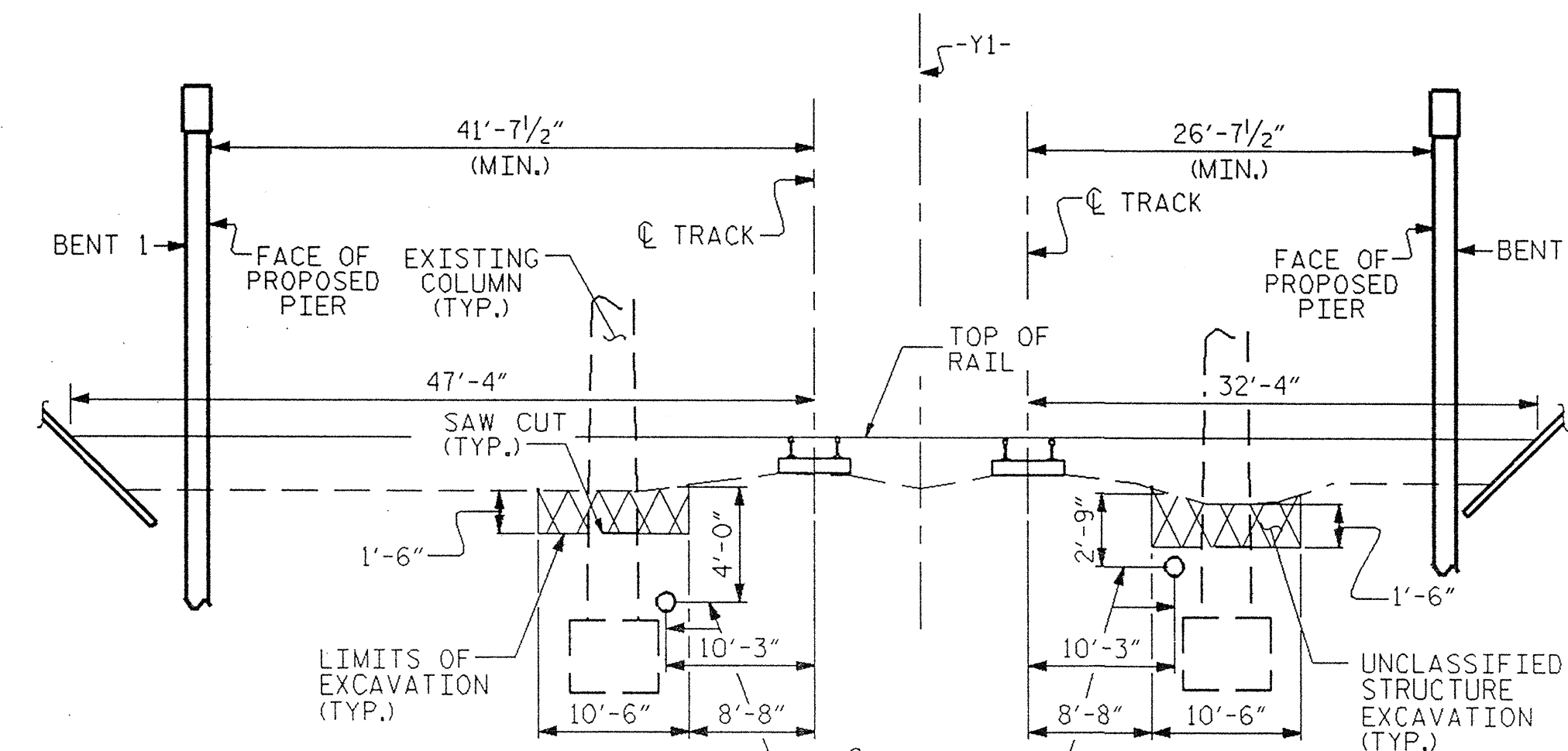
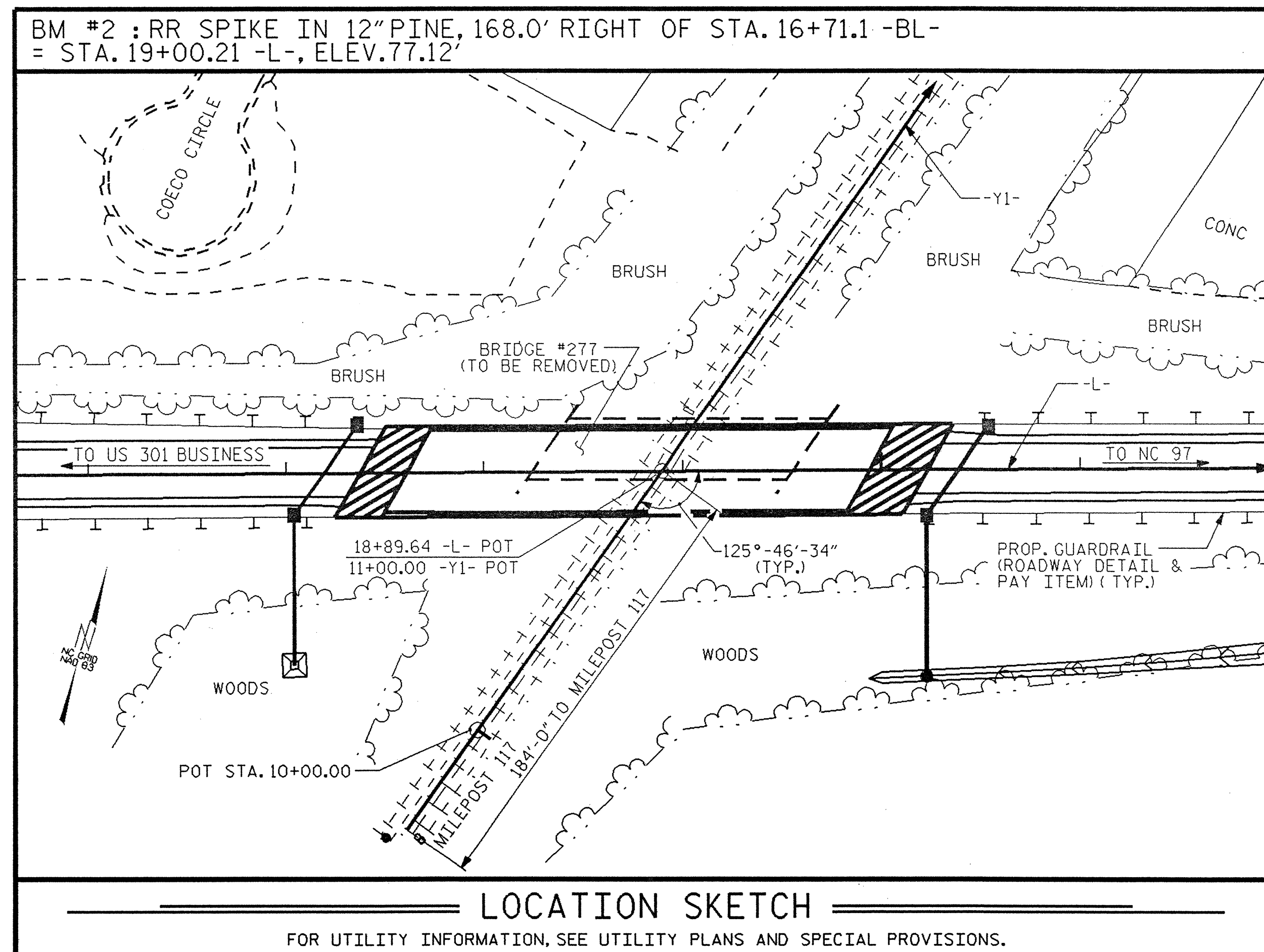

LEFT TRACK TOP OF RAIL ELEVATIONS			
STATION -Y1-	LT RAIL	STATION -Y1-	RT RAIL
10+71.49	85.155	10+75.05	85.151
11+16.25	85.197	11+19.79	85.212

RIGHT TRACK TOP OF RAIL ELEVATIONS			
STATION -Y1-	LT RAIL	STATION -Y1-	RT RAIL
10+80.68	85.244	10+84.27	85.272
11+25.44	85.301	11+29.01	85.262

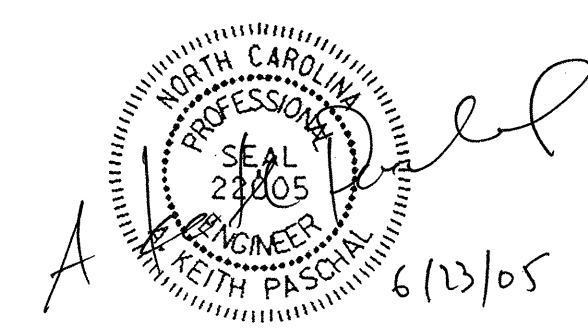

PROJECT NO. B-3681

NASH/EDGEcombe COUNTY

STATION: 18+89.64 -L- 11+00.00 -Y1-

SHEET 3 OF 3

STATE OF NORTH CAROLINA

DEPARTMENT OF TRANSPORTATION

RALEIGH

GENERAL DRAWING

BRIDGE ON SR 1555 OVER CSX RAILROAD BETWEEN US 301 BUSINESS (N. CHURCH STREET) & NC 97 (ATLANTIC AVENUE) (ROCKY MOUNT)

REVISIONS						SHEET NO.	
NO.	BY:	DATE:	NO.	BY:	DATE:	S-3	
1			3			TOTAL SHEETS	36
2			4				

DRAWN BY: K. MCCAULEY DATE: 12/7/04

CHECKED BY: A. M. KEETER DATE: 1/27/05

23 JUN-2005 10:39

Z:\STRUCT\12\ameadows\MICROSD\B3681.dgn

ameadows