

PROJECT REFERENCE NO.	SHEET NO.
B-3681	EC-6/CONST.5
RW SHEET NO.	
ROADWAY DESIGN ENGINEER	HYDRAULICS ENGINEER

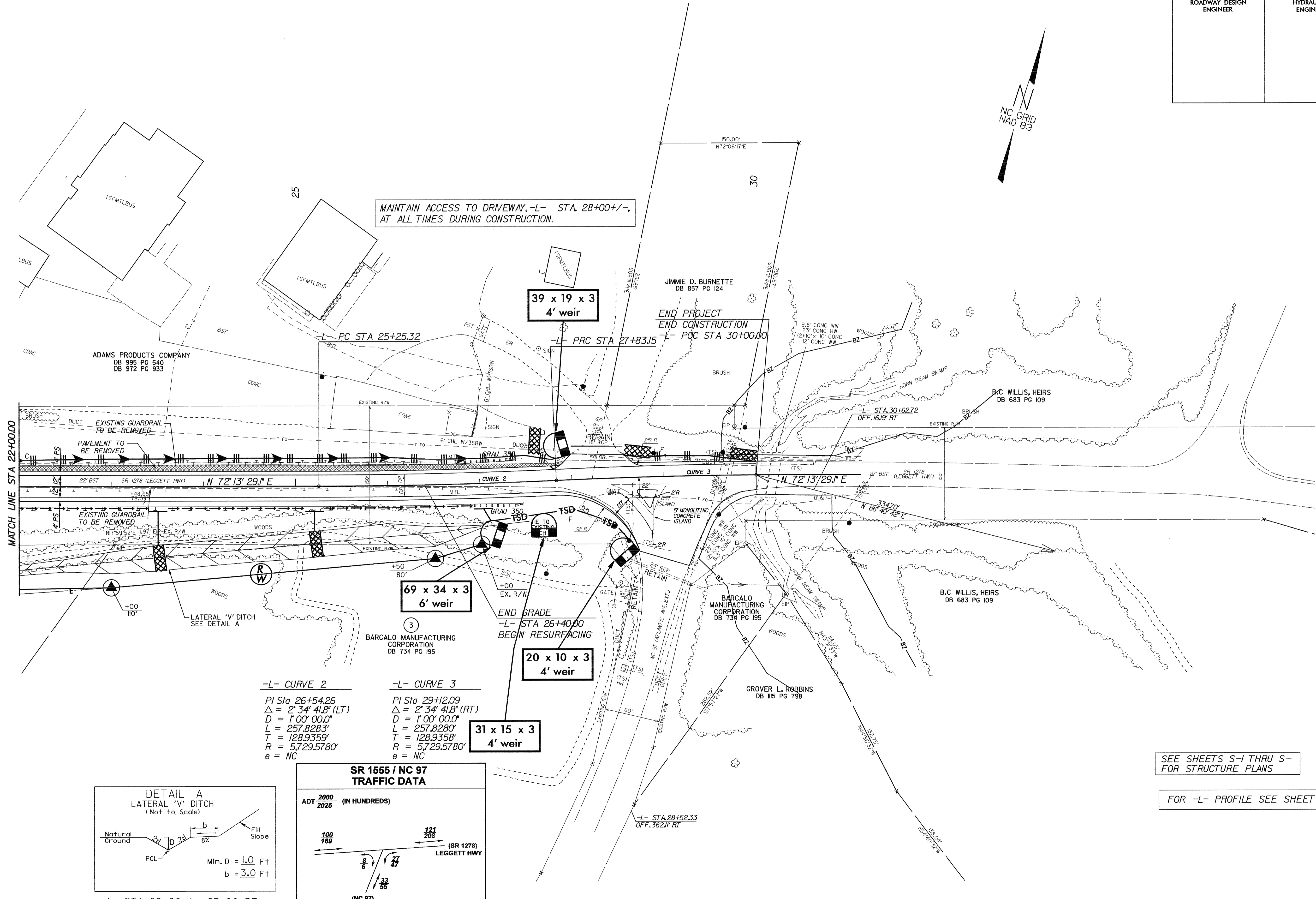

**-L- CURVE 2**  
 PI Sta 26+54.26  
 $\Delta = 2^\circ 34' 41.8''$  (LT)  
 $D = 1^\circ 00' 00.0''$   
 $L = 257.8283'$   
 $T = 128.9359'$   
 $R = 5729.5780'$   
 $e = NC$

**-L- CURVE 3**  
 PI Sta 29+12.09  
 $\Delta = 2^\circ 34' 41.8''$  (RT)  
 $D = 1^\circ 00' 00.0''$   
 $L = 257.8280'$   
 $T = 128.9358'$   
 $R = 5729.5780'$   
 $e = NC$

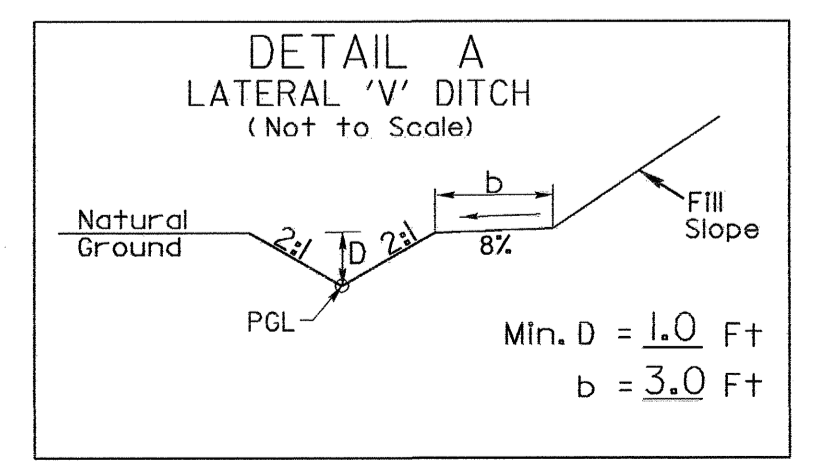

-L- STA 20+00 to 27+00 RT

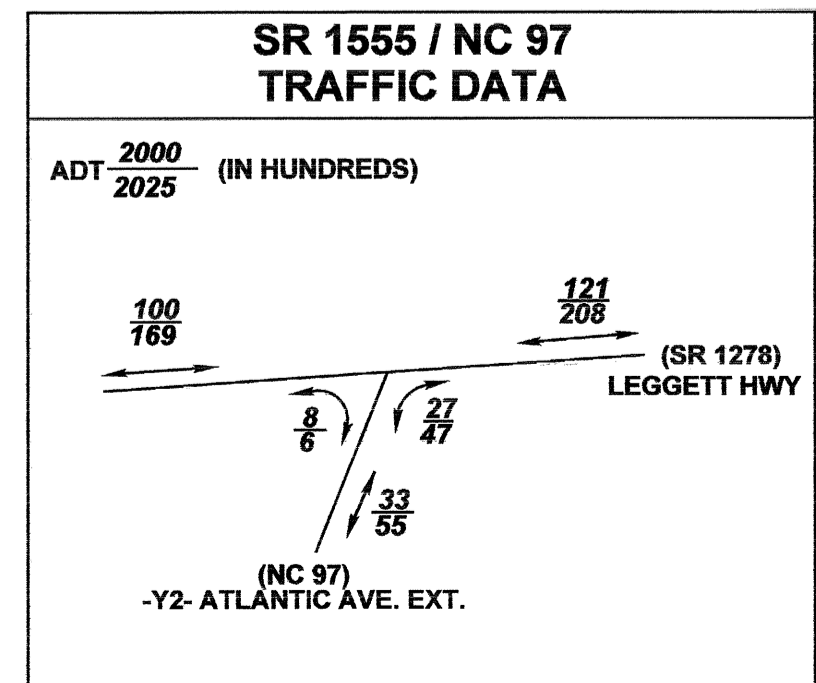

SEE SHEETS S-1 THRU S- FOR STRUCTURE PLANS

FOR -L- PROFILE SEE SHEET NO.7