

VICINITY MAP

SURVEY CONTROL SHEET B-3714

PROJECT REFERENCE NO.	SHEET NO.
33253.1.1	1 C
LOCATION AND SURVEYS	

BL	POINT	DESC.	NORTH	EAST	ELEVATION	L STATION	OFFSET
1		GPS B3714-1	894876.1180	1375387.3610	1036.94	5+74.20	36.01 RT
3		BL-3	895252.1777	1376370.4883	997.13	16+28.44	56.84 RT
4		BL-4	895551.7425	1377221.7031	998.40	25+32.63	22.87 RT
2		GPS B3714-2	895867.2020	1378130.0940	1015.13	OUTSIDE PROJECT LIMITS	

 (B3714-1) BM1 ELEVATION = 1036.94
 N 894876 E 1375387
 L STATION 5+74 36' RIGHT
 30" REBAR AND CAP

 BM2 ELEVATION = 994.15
 N 895063 E 1376360
 L STATION 15+55 231' RIGHT
 8" SPIKE IN BASE OF H-FRAME POWER POLE

 (B3714-2) BM3 ELEVATION = 1015.13
 N 895867 E 1378130
 OUTSIDE PROJECT LIMITS
 30" REBAR AND CAP

DISCLAIMER: THIS COORDINATE LIST IS PROVIDED FOR THE CONVENIENCE OF INTERESTED CONTRACTORS AND IS INTENDED FOR USE DURING THE PROJECT BIDDING PROCESS ONLY. COORDINATES ARE LOCALIZED TO THIS PARTICULAR PROJECT AND ANY CONVERSION TO STATE GRID COORDINATES OR OTHER FORMATS WILL BE THE RESPONSIBILITY OF THE RECIPIENT. WHILE EVERY EFFORT HAS BEEN MADE TO PROVIDE UP-TO-DATE, ACCURATE INFORMATION, NCDOT MAKES NO EXPRESS GUARANTEE AS TO THE VALIDITY OR POTENTIAL FOR REVISION OF THIS INFORMATION PRIOR TO PROJECT LETTING.

POINT	CHAIN	STATION	NORTHING(Y)	EASTING(X)
1	L	8+00.00	894986.6095	1375587.5419
2	L	9+00.00	895020.5491	1375681.6062
3	L	10+00.00	895056.7933	1375774.7983
4	L	11+00.00	895097.0681	1375866.3208
5	L	12+00.00	895141.2967	1375955.9994
6	L	13+00.00	895185.5302	1376045.6755
7	L	14+00.00	895225.8100	1376137.1957
8	L	15+00.00	895262.0595	1376230.3858
9	L	16+00.00	895295.9994	1376324.4500
10	L	17+00.00	895329.9298	1376418.5177
11	L	18+00.00	895363.8602	1376512.5854
12	L	19+00.00	895397.7906	1376606.6530
13	L	20+00.00	895430.1185	1376701.2756
14	L	21+00.00	895458.3173	1376797.2092
15	L	22+00.00	895482.3047	1376894.2814
16	L	23+00.00	895504.8612	1376991.6983
17	L	24+00.00	895531.4995	1377088.0768
18	L	25+00.00	895562.3165	1377183.2016
19	L	25+00.00	895562.3165	1377183.2016

STA. 8+00.00 -L- BEGIN T.I.P. PROJECT B-3714
LOCALIZED PROJECT COORDINATES
 N = 894986.6095
 E = 1375587.5419

NC DOT GPS STATION B3714-1
 LOCALIZED PROJECT COORDINATES
 N = 894876.1180
 E = 1375387.3610

NC DOT GPS STATION B3714-2
 LOCALIZED PROJECT COORDINATES
 N = 895867.2020
 E = 1378130.0940

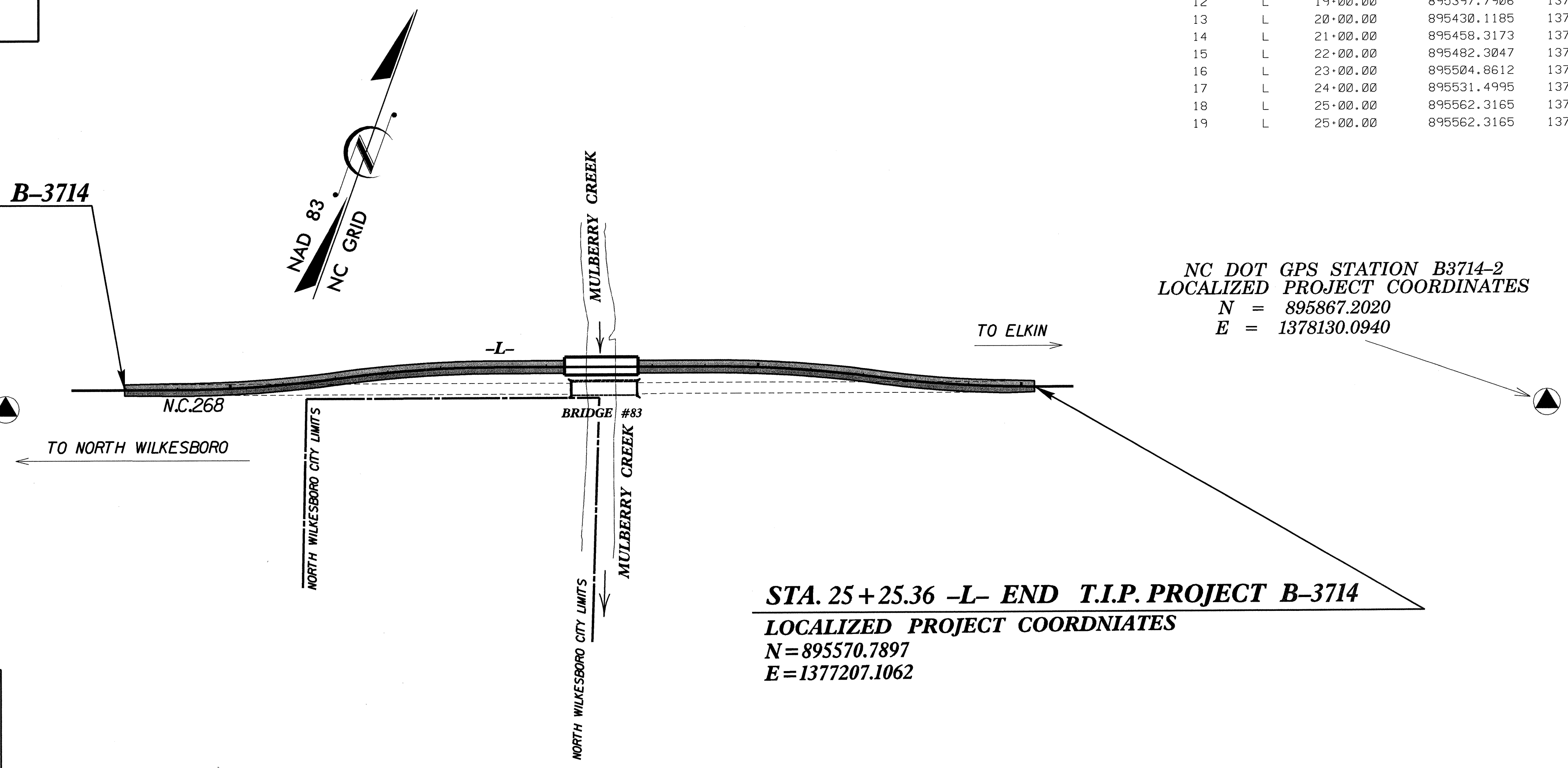

STA. 25+25.36 -L- END T.I.P. PROJECT B-3714
LOCALIZED PROJECT COORDINATES
 N = 895570.7897
 E = 1377207.1062

DATUM DESCRIPTION
 THE LOCALIZED COORDINATE SYSTEM DEVELOPED FOR THIS PROJECT IS BASED ON THE STATE PLANE COORDINATES ESTABLISHED BY NCDOT FOR MONUMENT "B3714-1" WITH NAD 83 STATE PLANE GRID COORDINATES OF NORTHING: 894876.1180(ft) EASTING: 1375387.3610(ft) THE AVERAGE COMBINED GRID FACTOR USED ON THIS PROJECT (GROUND TO GRID) IS: 0.99996334 THE N.C. LAMBERT GRID BEARING AND LOCALIZED HORIZONTAL GROUND DISTANCE FROM "B3714-1" TO -L- STATION 8+00 IS N 61°06'11.31" 228.65' ALL LINEAR DIMENSIONS ARE LOCALIZED HORIZONTAL DISTANCES VERTICAL DATUM USED IS NAVD 88

NOTES:
 THE CONTROL DATA FOR THIS PROJECT CAN BE FOUND ELECTRONICALLY BY SELECTING PROJECT CONTROL DATA AT:
[HTTP://WWW.DOH.DOT.STATE.NC.US/PRECONSTRUCT/HIGHWAY/LOCATION/PROJECT](http://www.doh.dot.state.nc.us/preconstruct/highway/location/project)
 THE FILES TO BE FOUND ARE AS FOLLOWS
 B3714_LS_CONTROL_040421.TXT
 SITE CALIBRATION INFORMATION HAS NOT BEEN PROVIDED FOR THIS PROJECT.
 IF FURTHER INFORMATION IS NEEDED, PLEASE CONTACT THE LOCATION AND SURVEYS UNIT.
 INDICATES GEODETIC CONTROL MONUMENTS USED OR SET FOR HORIZONTAL PROJECT CONTROL BY THE NCDOT LOCATION AND SURVEYS UNIT.

NOTE: DRAWING NOT TO SCALE