

TRANSVERSE CONSTRUCTION JOINT DETAIL

NOTE: REINFORCING STEEL IN SLAB NOT SHOWN. LONGITUDINAL REINFORCING STEEL SHALL BE CONTINUOUS THRU JOINT

SUPERSTRUCTURE REINFORCING STEEL LENGTHS ARE BASED ON THE FOLLOWING MINIMUM SPLICE LENGTHS

BAR SIZE	SUPERSTRUCTURE EXCEPT APPROACH SLABS, PARAPET, AND BARRIER RAIL		APPROACH SLABS		PARAPET AND BARRIER RAIL
	EPOXY COATED	UNCOATED	EPOXY COATED	UNCOATED	
#4	2'-0"	1'-9"	2'-0"	1'-9"	2'-9"
#5	2'-6"	2'-2"	2'-6"	2'-2"	3'-5"
#6	3'-0"	2'-7"	3'-10"	2'-7"	4'-4"
#7	5'-3"	3'-6"	—	—	—
#8	6'-10"	4'-7"	—	—	—

BILL OF MATERIAL

SPANS "A", "B", & "C"					
BAR	NO.	SIZE	TYPE	LENGTH	WEIGHT
*A1	253	#5	STR	36'-11"	9742
A2	253	#5	STR	36'-11"	9742
*B1	23	#4	STR	22'-6"	346
B2	126	#5	STR	50'-7"	6648
*B3	46	#7	STR	42'-9"	4020
*B4	44	#7	STR	16'-6"	1484
*B5	23	#4	STR	20'-0"	307
*B6	23	#4	STR	27'-6"	423
*B7	12	#4	STR	26'-3"	210
*G1	2	#5	STR	36'-11"	77
*K1	8	#8	1	11'-6"	246
*K2	12	#8	2	18'-2"	582
K3	16	#5	6	7'-0"	117
K4	16	#5	STR	6'-8"	111
K5	16	#4	STR	4'-8"	50
K6	48	#4	STR	6'-4"	203
K7	16	#4	STR	17'-0"	182
*S1	56	#5	3	4'-11"	287
S2	48	#4	4	6'-1"	195
S3	128	#4	5	2'-9"	235
U1	32	#4	2	13'-2"	281
U2	16	#4	2	11'-2"	119

REINFORCING STEEL = 17,883 LBS
EPOXY COATED REINF. STEEL = 17,724 LBS
* THESE BARS ARE EPOXY COATED

BAR TYPES

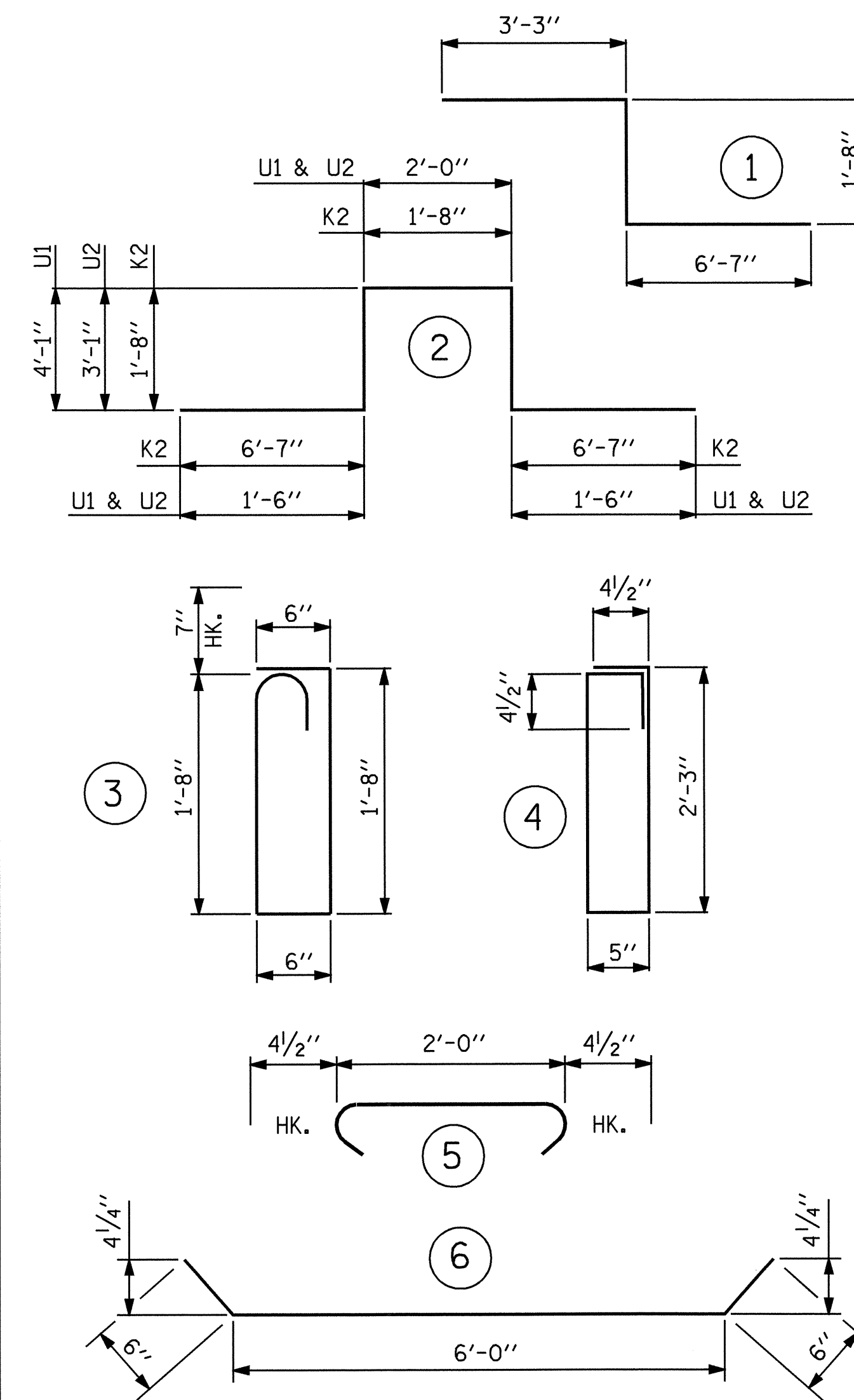

ALL BAR DIMENSIONS ARE OUT TO OUT

SUPERSTRUCTURE BILL OF MATERIAL

	CLASS AA CONCRETE (CU. YDS.)	REINFORCING STEEL (LBS.)	EPOXY COATED REINFORCING STEEL (LBS.)
SPAN "A", "B", & "C"		17,883	17,724
POUR #1	35.7		
POUR #2	84.3		
POUR #3	71.0		
TOTALS **	191.0	17,883	17,724

** QUANTITIES FOR BARRIER RAIL ARE NOT INCLUDED

PROJECT NO. B-3714
WILKES COUNTY
STATION: 17+05.50 -L-

GROOVING BRIDGE FLOORS	
APPROACH SLABS	1498 SQ.FT.
BRIDGE DECK	4569 SQ.FT.
TOTAL	6067 SQ.FT.



STATE OF NORTH CAROLINA
DEPARTMENT OF TRANSPORTATION
RALEIGH

SUPERSTRUCTURE BILL OF MATERIAL

REVISIONS						TOTAL SHEETS
NO.	BY:	DATE:	NO.	BY:	DATE:	35
1			3			
2			4			

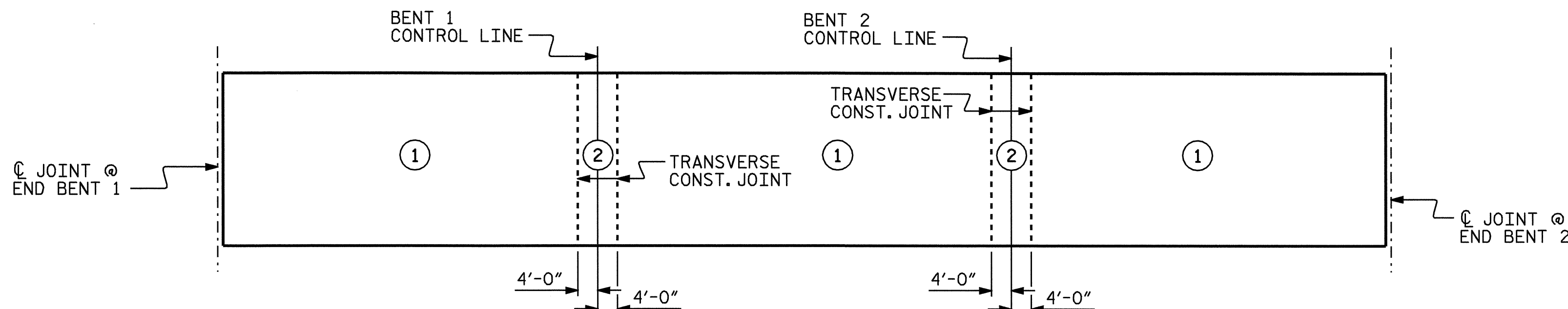

OPTIONAL POURING SEQUENCE

POUR (2) CAN NOT BE STARTED UNTIL BOTH ADJACENT (1) POURS REACH A MINIMUM OF 3000 PSI.

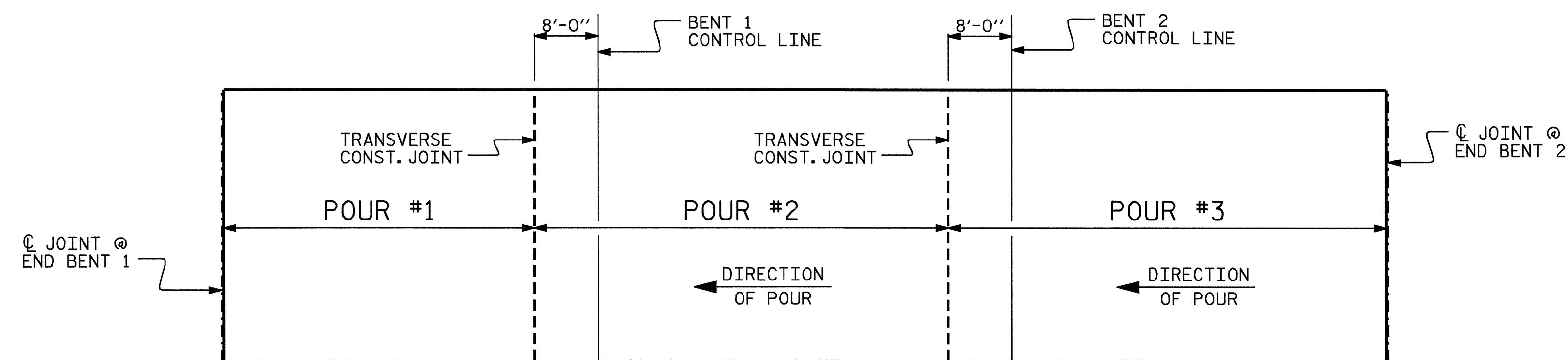

POURING SEQUENCE

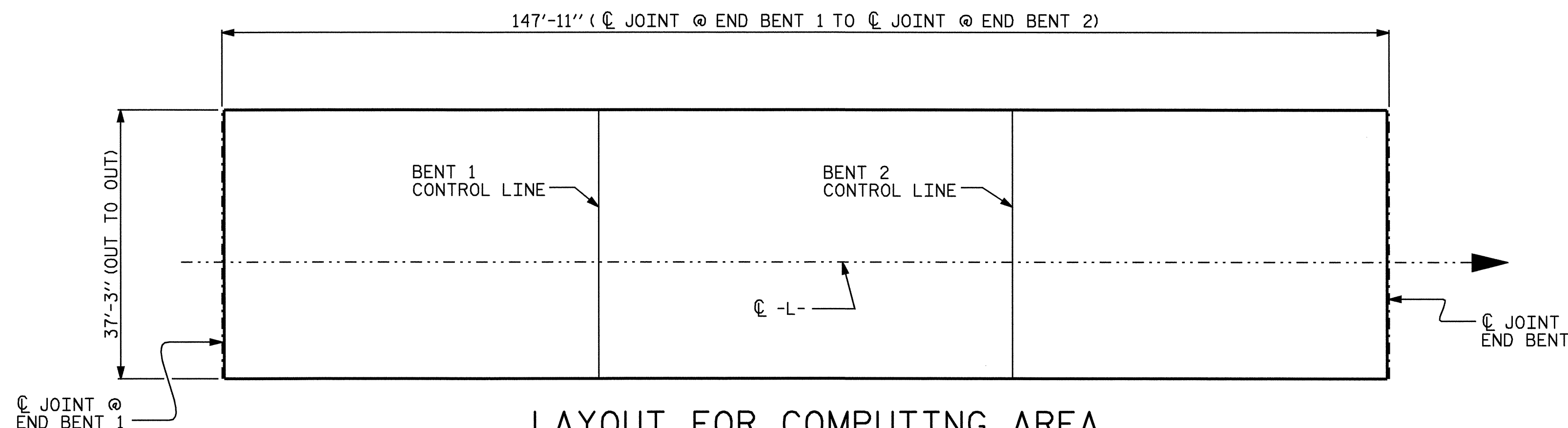

LAYOUT FOR COMPUTING AREA
OF REINFORCED CONCRETE DECK SLAB
(SQ. FT. = 5510)

DRAWN BY : P.C. BREWER DATE : 7/12/04
CHECKED BY : K.W. ALFORD DATE : 8/6/04