

B.M. R-2552-15
 N 208,696.4610 E 651,634.783
 LOCATED 48.027 LT. OF -L- STA.
 27+75.439 AT AN ELEVATION 87.1560

-L- US 70 BYPASS

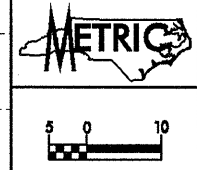

PROJECT REFERENCE NO. R-2552AB	SHEET NO. 13
ROADWAY DESIGN ENGINEER	HYDRAULICS ENGINEER
PRELIMINARY PLANS DO NOT USE FOR CONSTRUCTION	

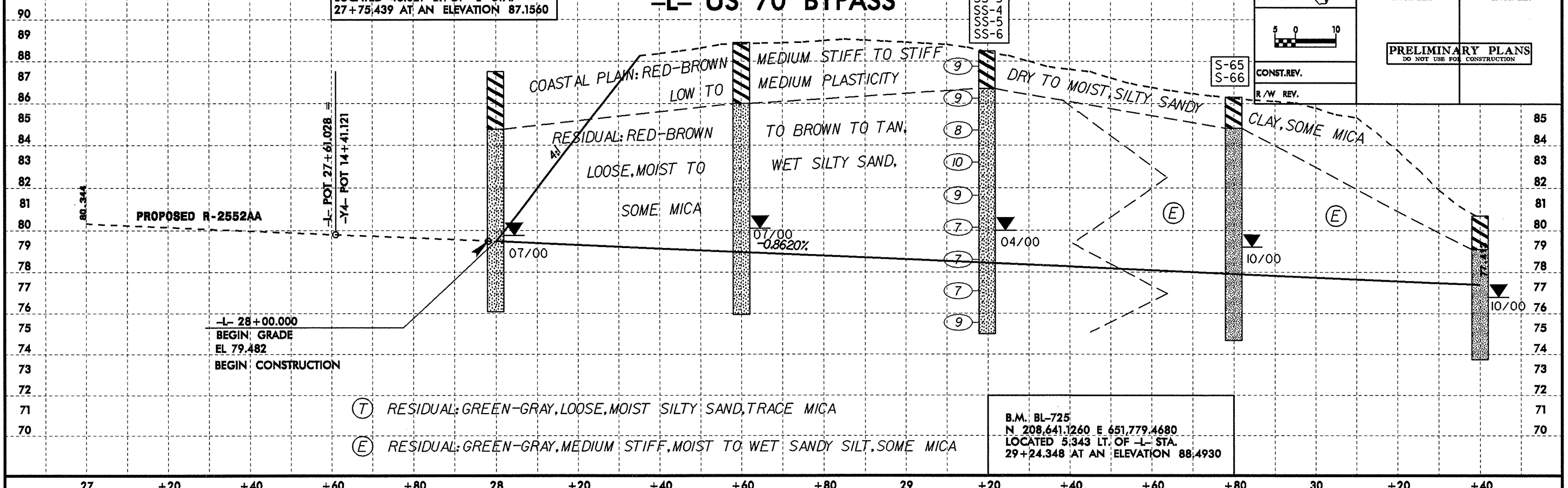

27 +20 +40 +60 +80 28 +20 +40 +60 +80 29 +20 +40 +60 +80 30 +20 +40

-L- US 70 BYPASS

(U) COASTAL PLAIN: RED-BROWN, STIFF, MOIST, SILTY SANDY CLAY AND SANDY SILT, LOW PLASTICITY

SOIL TEST RESULTS

SAMPLE NO.	OFFSET	STATION	DEPTH INTERVAL	AASHTO CLASS.	LL	PI	% BY WEIGHT				% PASSING (SIEVES)			% MOISTURE	% ORGANIC
							C. SAND	F. SAND	SILT	CLAY	10	40	200		
SS-1	CL	29+20	0.74-1.19	A-7-5(12)	57	24	26.0	20.5	17.3	36.2	100	82	57	-	-
SS-2	CL	29+20	2.26-2.71	A-2-4(0)	40	NP	37.0	36.2	18.7	8.0	100	76	32	-	-
SS-3	CL	29+20	6.84-7.29	A-2-4(0)	38	NP	37.2	33.4	21.3	8.0	98	74	34	-	-
SS-4	CL	29+20	8.36-8.81	A-2-4(0)	38	NP	47.1	33.0	15.9	4.0	100	67	25	-	-
SS-5	CL	29+20	9.89-10.34	A-2-4(0)	39	NP	46.3	32.6	17.1	4.0	100	68	26	-	-
SS-6	CL	29+20	12.94-13.39	A-2-4(0)	37	NP	40.4	33.8	21.7	4.0	95	68	31	-	-

SOIL TEST RESULTS

SAMPLE NO.	OFFSET	STATION	DEPTH INTERVAL	AASHTO CLASS.	LL	PI	% BY WEIGHT				% PASSING (SIEVES)			% MOISTURE	% ORGANIC
							C. SAND	F. SAND	SILT	CLAY	10	40	200		
S-65	CL	29+80	0.00-1.50	A-7-5(5)	43	12	19.8	29.5	18.4	32.3	100	93	55	-	-
S-66	CL	29+80	1.50-3.00	A-4(0)	35	3	23.0	36.6	22.2	18.2	100	90	45	-	-
SS-51	CL	31+00	1.02-1.47	A-2-4(0)	27	NP	41.0	38.4	6.5	14.1	100	81	24	20.6	-
SS-52	CL	31+00	2.64-2.99	A-2-4(0)	36	NP	36.2	37.8	18.0	8.1	100	77	32	29.0	-
SS-53	CL	31+00	4.06-4.51	A-2-4(0)	38	NP	36.6	36.2	19.2	8.1	97	76	32	28.8	-
SS-54	CL	32+20	1.21-1.66	A-4(3)	38	7	42.6	31.5	16.2	100	98	59	23.3	-	-
SS-55	CL	32+20	2.73-3.18	A-7-5(6)	47	13	17.6	30.5	19.6	32.3	98	90	57	-	-
SS-56	CL	32+20	5.77-6.22	A-2-4(0)	27	NP	39.8	37.0	15.2	8.1	100	76	29	21.4	-
S-57	CL	33+00	2.00-3.50	A-4(0)	38	6	32.5	30.1	23.2	14.1	100	84	42	-	-
S-58	CL	33+80	0.00-1.05	A-7-5(17)	53	21	19.8	25.7	16.2	36.4	100	89	59	-	-

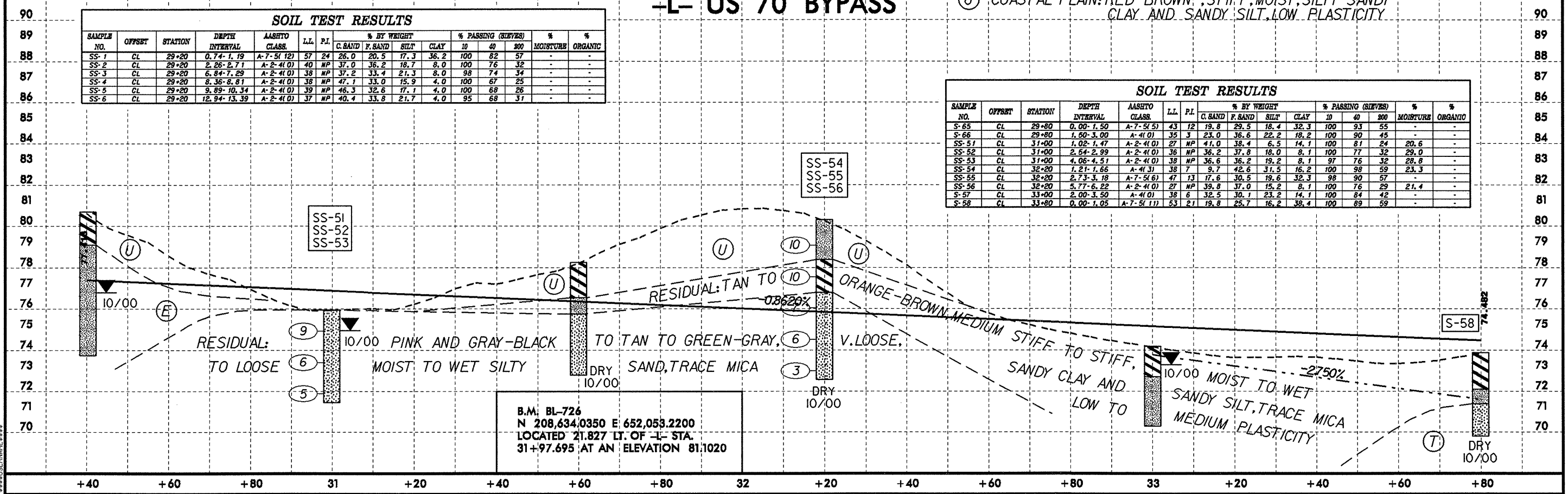

+40 +60 +80 31 +20 +40 +60 +80 32 +20 +40 +60 +80 33 +20 +40 +60 +80