

END ELEVATION - NORMAL TO SKEW

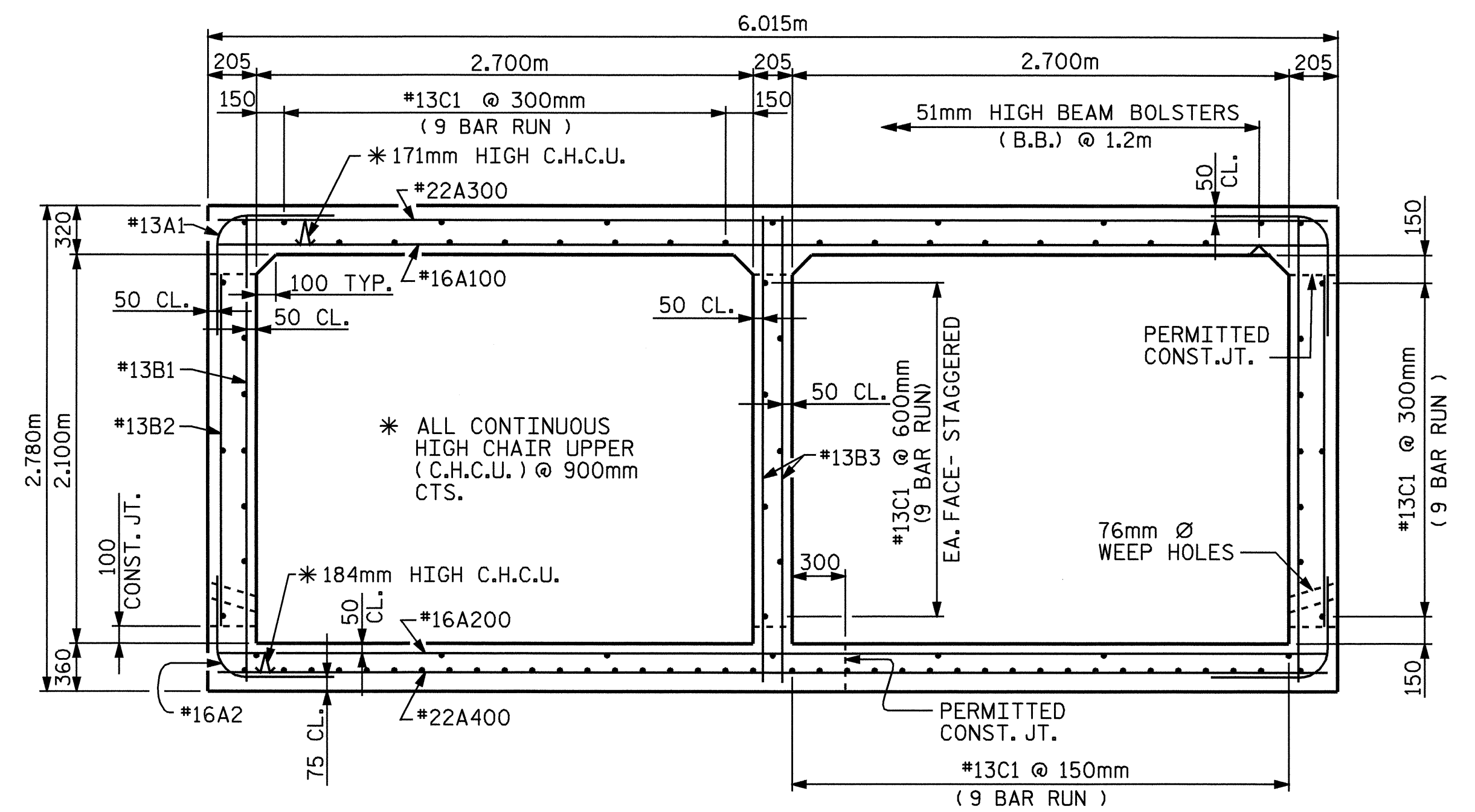

RIGHT ANGLE SECTION OF BARREL
THERE ARE 93 "C" BARS IN SECTION OF BARREL

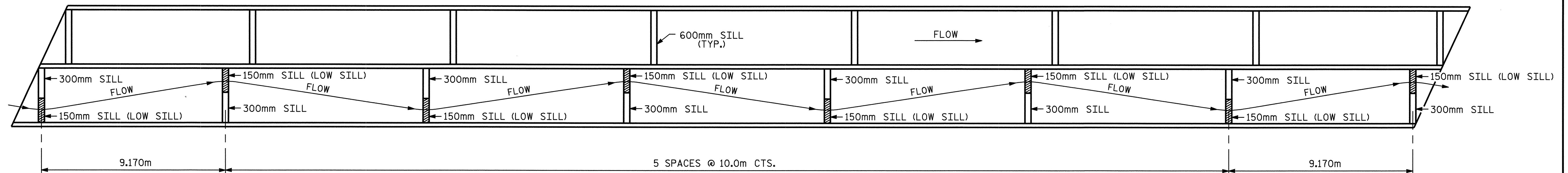

PLAN OF CULVERT SHOWING LOCATION OF SILLS

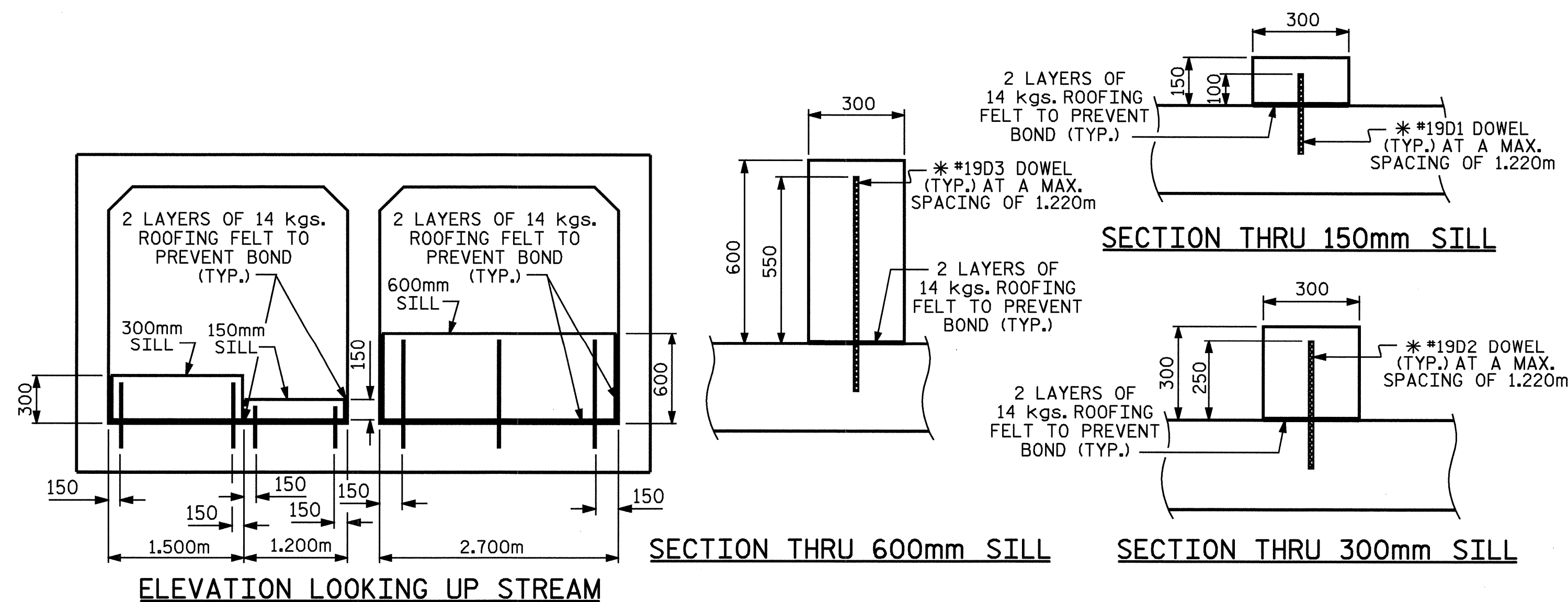

CULVERT SILL DETAILS

NOTES

BED MATERIAL PLACED BETWEEN SILLS IN THE CULVERT SHALL PROVIDE A CONTINUOUS LOW FLOW CHANNEL BETWEEN THE LOWER SILLS. THE MATERIAL SHALL BE NATURAL STONE WITH A GRADATION SIZE SIMILAR TO THAT OF CLASS B RIPRAP. STONES LARGER THAN 150mm SHALL NOT BE PLACED WITHIN THE LOW FLOW CHANNEL. BED MATERIALS ARE SUBJECT TO APPROVAL BY THE ENGINEER.

SILLS ARE TO BE 300mm WIDE AND CAST SEPARATELY AND ATTACHED BY DOWELS.

THE 300mm AND 150mm HIGH SILLS ARE TO BE SEPARATE UNITS.

TOP OF LOW FLOW SILL SHOULD MATCH STREAM BED ELEVATION IN LOW FLOW CHANNEL OF STREAM.

* DOWELS MAY BE PUSHED INTO GREEN CONCRETE AFTER SLAB HAS BEEN FLOAT FINISHED.

PROJECT NO. R-2552AB
JOHNSTON COUNTY
STATION 37+11.500 -L-

SHEET 2 OF 4

STATE OF NORTH CAROLINA
DEPARTMENT OF TRANSPORTATION
RALEIGH

DOUBLE 2.7m X 2.1m
CONCRETE BOX CULVERT
65° SKEW



DRAWN BY: Keith D. Layne DATE: 11-18-04
CHECKED BY: J. P. ADAMS DATE: 12/04

REVISIONS						SHEET NO.	
NO.	BY:	DATE:	NO.	BY:	DATE:	C-2	
1			3			TOTAL SHEETS	
2			4			8	