

**REINFORCING BAR SCHEDULE**

SPANS "A", "B", "C" & "D"						
BAR	NO.	SIZE	TYPE	LENGTH	WEIGHT	
* A1	2009	16	STR	12880	40159	
A2	2009	16	STR	12880	40159	
* B1	1020	13	STR	8900	9024	
* B2	174	19	STR	7280	2831	
* B3	174	19	STR	6780	2637	
* B4	20	19	STR	15040	672	
* B5	20	19	STR	16400	733	
* B6	20	19	STR	18000	805	
* B7	290	19	STR	15580	10098	
B8	952	16	STR	17240	25472	
* G1	22	16	4	1100	38	
* K1	4	16	1	2360	15	
* K2	4	16	2	2640	16	
K3	6	16	STR	3140	29	
K4	8	16	STR	580	7	
* K5	4	16	1	2420	15	
* K6	4	16	2	2780	17	
K7	6	16	STR	3000	28	
* S1	75	13	3	960	72	
*EPOXY COATED REINFORCING STEEL				kg	67132	
REINFORCING STEEL				kg	65695	

SUPERSTRUCTURE REINFORCING STEEL LENGTHS ARE BASED ON THE FOLLOWING MINIMUM SPLICE LENGTHS

BAR SIZE	SUPERSTRUCTURE EXCEPT APPROACH SLABS, PARAPET, AND BARRIER RAIL		APPROACH SLABS		PARAPET AND BARRIER RAIL
	EPOXY COATED	UNCOATED	EPOXY COATED	UNCOATED	
#13	610	540	610	540	840
#16	770	660	770	660	1050
#19	920	790	1190	790	1330
#22	1580	1060			
#25	2080	1390			

GROOVING BRIDGE FLOORS		
APPROACH SLABS	164.6	SQ. METER
BRIDGE DECK	3116.9	SQ. METER
TOTAL	3281.5	SQ. METER

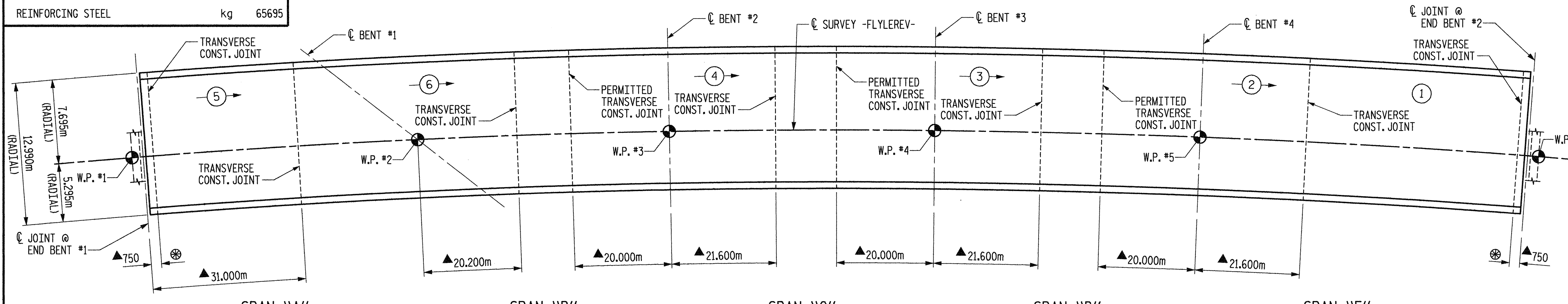
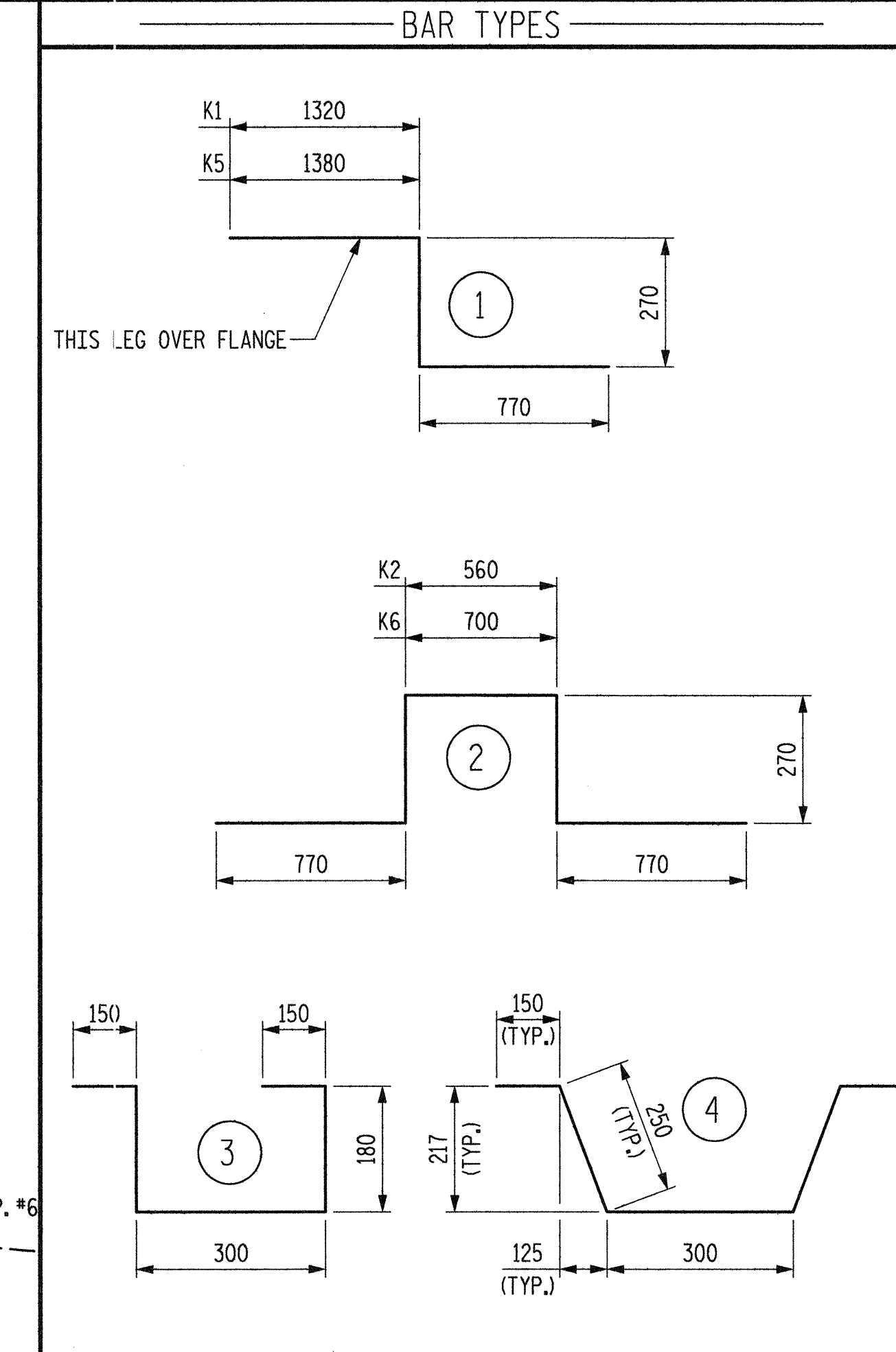

**PLAN - POURING SEQUENCE**

- # → INDICATES POUR NUMBER AND DIRECTION OF POUR.
- ⊗ CLOSURE POUR ADJACENT TO MODULAR JOINT ASSEMBLY AT END BENT #1 AND END BENT #2. CLOSURE POUR (INCLUDING DROPWALL) WILL BE PLACED AFTER ALL SPAN POURS DENOTED IN POURING DIAGRAM ARE COMPLETED.
- ▲ DIMENSIONS MEASURED ALONG CL SURVEY -FLYLEREV-.

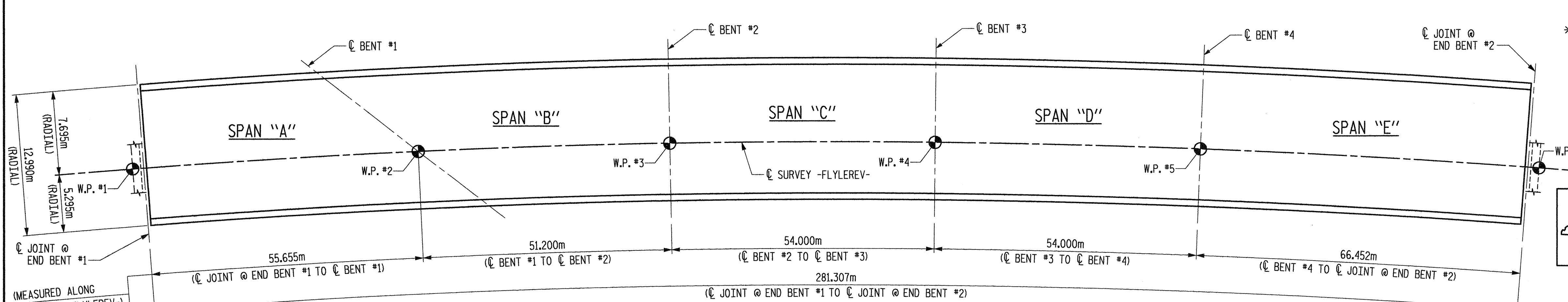

LAYOUT FOR COMPUTING AREA OF REINFORCED CONCRETE DECK SLAB (SQ. METER = 3656.6)

ALL BAR DIMENSIONS ARE OUT TO OUT.

SUPERSTRUCTURE BILL OF MATERIAL

	CLASS AA CONCRETE (CU. METER)	REINFORCING STEEL (kg)	EPOXY COATED REINFORCING STEEL (kg)
SPANS "A", "B", "C", "D" & "E"		65695	67132
POUR #1	167.4**		
POUR #2	200.4		
POUR #3	200.4		
POUR #4	195.2		
POUR #5	116.0		
POUR #6	166.5**		
TOTALS***	1045.9	65695	67132

\*\*\*QUANTITIES FOR BARRIER RAIL ARE NOT INCLUDED.  
\*\*CLOSURE POUR QUANTITY (3.7 m3) AT END BENT IS INCLUDED IN THE CONCRETE QUANTITY OF THIS POUR.

PROJECT NO. R-2552AA  
WAKE-JOHNSTON COUNTY  
STATION: 28+31.359 -I1Y1-

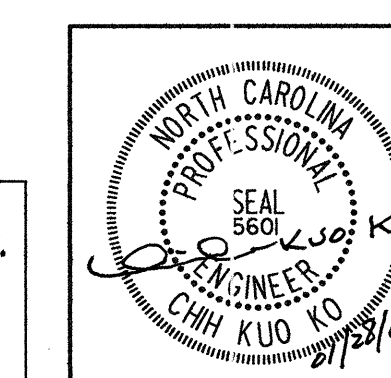
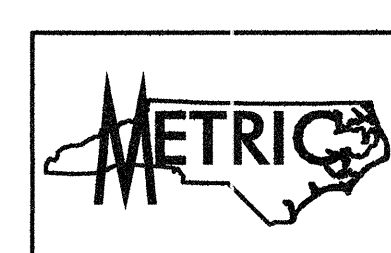

STATE OF NORTH CAROLINA  
DEPARTMENT OF TRANSPORTATION  
RALEIGH  
STANDARD  
SUPERSTRUCTURE  
BILL OF MATERIAL

ASSEMBLED BY : B.E. LANNING DATE : JAN. 2005  
CHECKED BY : J.C. KO DATE : JAN. 2005  
DRAWN BY : JMB 5/87 REV. 5/16/97 EEM/RGW  
CHECKED BY : SJD 9/87

Plans prepared by:  
**KO & ASSOCIATES, P.C.**  
Consulting Engineers  
101 SCHAUB DR., SUITE #202  
RALEIGH, N.C. 27606  
For Division of Highways

NO.	REVISIONS				SHEET NO.
	BY:	DATE:	NO.	DATE:	
1			3		S-116
2			4		TOTAL SHEETS 429

DWG. NO. 33