



PROJECT REFERENCE NO. <b>R-2552AA</b>	SHEET NO. <b>8-A</b>
R/W SHEET NO. <b>1426</b>	
ROADWAY DESIGN ENGINEER	HYDRAULICS ENGINEER
<b>PRELIMINARY PLANS</b> <small>DO NOT USE FOR CONSTRUCTION</small>	
<b>INCOMPLETE PLANS</b> <small>DO NOT USE FOR R/W ACQUISITION</small>	
CONST.REV.	
R/W REV.	

8/17/15  
HEIRS



**MATCHLINE TO SHEET 8**

**MATCHLINE TO SHEET 9A**

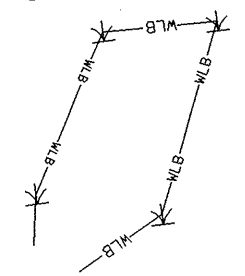

J. PEELE JOHNSON, HEIRS  
 C/O GLENN NIXON, EXEC.  
 DB 630 PG.592

J. PEELE JOHNSON, HEIRS  
 C/O GLENN NIXON, EXEC.  
 DB 630 PG.592

ROBERT A. BRYAN, ET UX  
 DB 210 PG 627

FRANCIS E. SOROKO  
 DB 954 PG.39  
 PB 25 PG.205

DANIEL Y. ROBINSON  
 DB 1004 PG.153

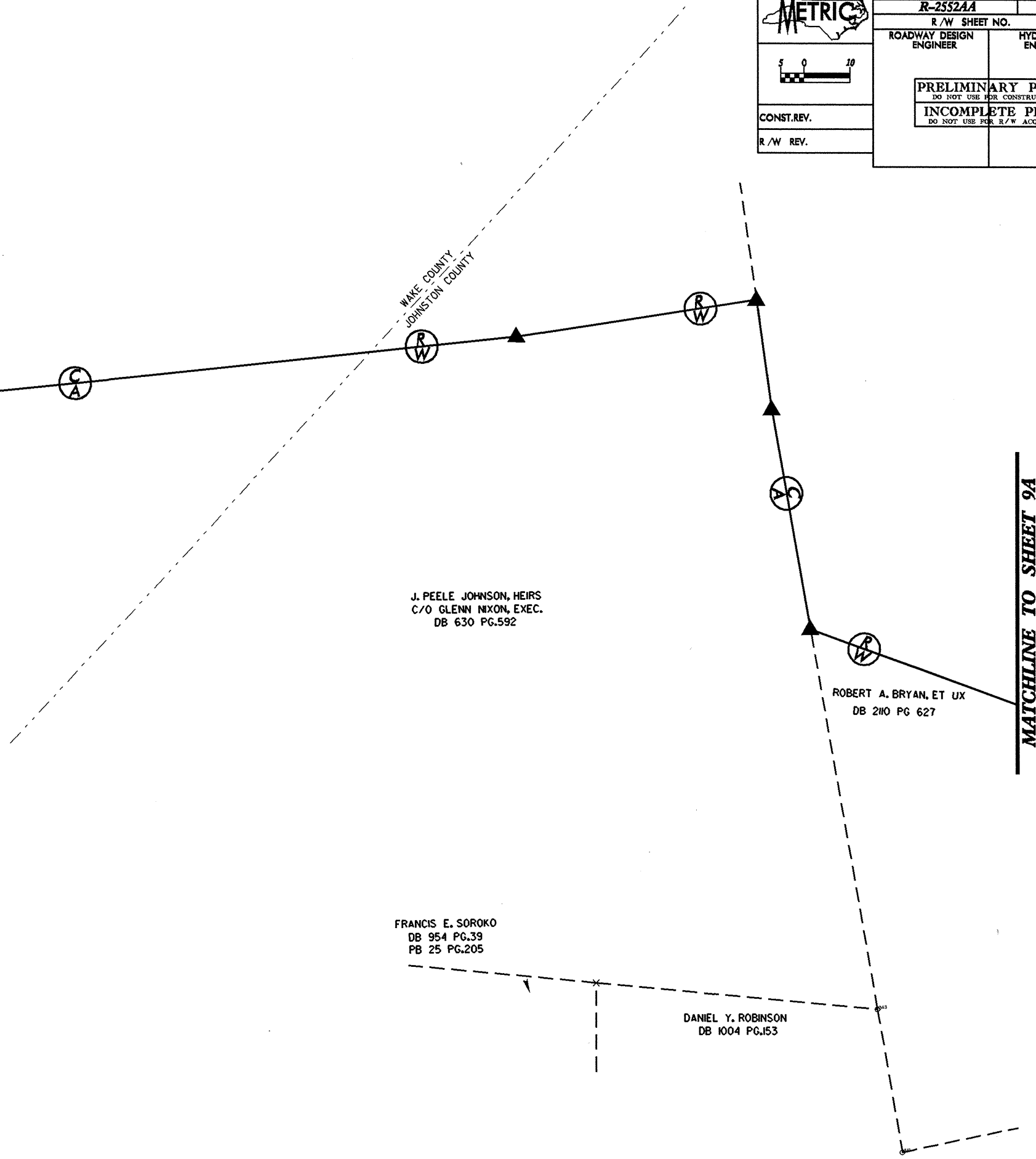

\*\*\*\*\*  
 SYSTEMS  
 \*\*\*\*\*