

6/09/09

NC 42 -Y2-



PROJECT REFERENCE NO. R-2552AB SHEET NO. 26

ROADWAY DESIGN ENGINEER HYDRAULICS ENGINEER

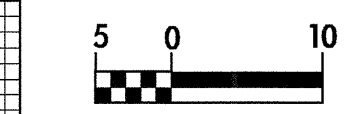

CONST. REV.

R /W REV.

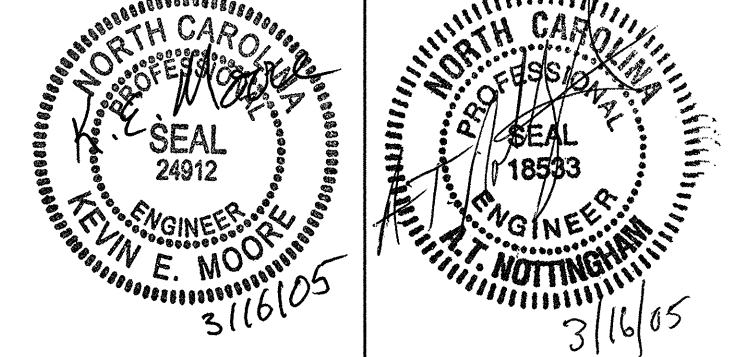

PI = 19+60.000
EL = 98.130 m
VC = 80 m
K = 75
V = 100 m

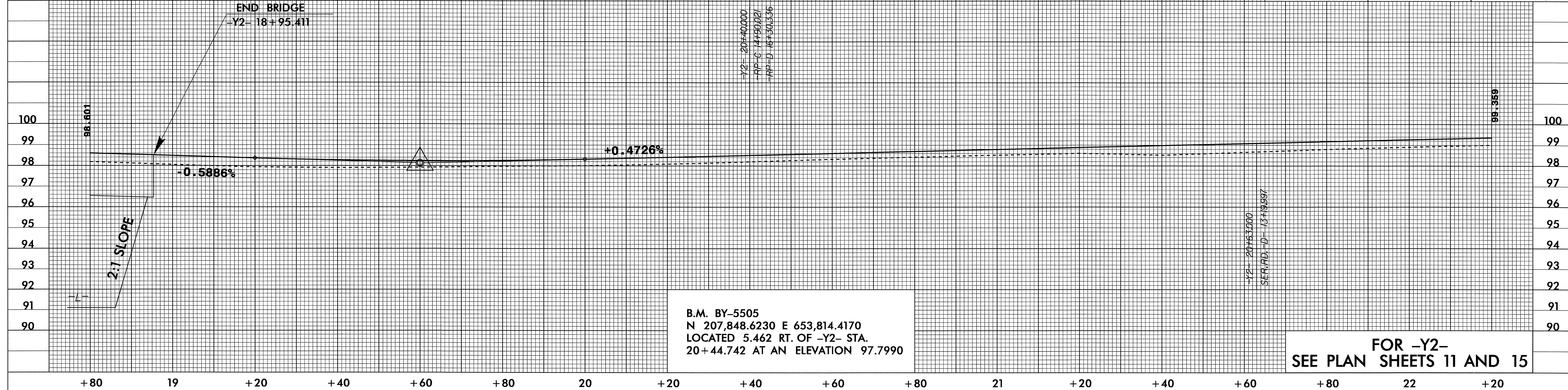

NC 42 -Y2-

B.M. BY-5506
N 207,707.8140 E 653,606.1440
LOCATED 8.226 RT. OF -Y2- STA.
22+97.009 AT AN ELEVATION 98.8950

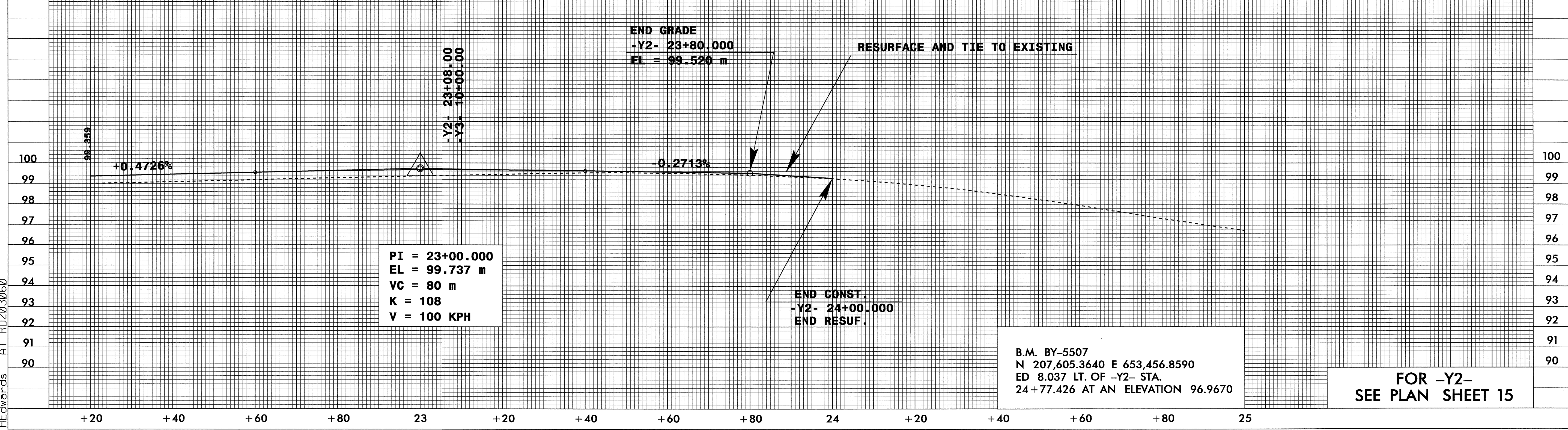

PI = 23+00.000
EL = 99.737 m
VC = 80 m
K = 108
V = 100 KPH

B.M. BY-5507
N 207,605.3640 E 653,456.8590
ED 8.037 LT. OF -Y2- STA.
24+77.426 AT AN ELEVATION 96.9670

FOR -Y2-
SEE PLAN SHEET 15

13-JAN-2005 11:05
R:\Proj\2552\pbf\Hewards AT R0203060