

10/26/08

★BM # BL-722 EL 76.161
4.331m RT -L- STA 25+12.682

★BM # BL-723 EL 83.504
23.866m RT -L- STA 26+45.037

LEFT DITCH - - - - -
RIGHT DITCH - - - - -

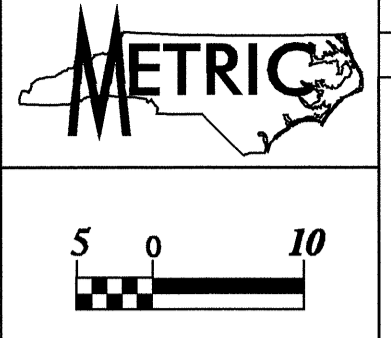

PROJECT REFERENCE NO. R-255244	SHEET NO. 38
ROADWAY DESIGN ENGINEER <i>[Signature]</i>	HYDRAULICS ENGINEER <i>[Signature]</i>
SEAL 2/28/05 NORTH CAROLINA PROFESSIONAL ENGINEER W. W. MUMFORD	SEAL 1/8/05 NORTH CAROLINA PROFESSIONAL ENGINEER J. T. NOTTINGHAM

★BM # R-2552-15 EL 87.156
47.166m RT -L- STA 27+66.382

PIPE HYDRAULIC DATA
DRAINAGE STRUCTURE NO. 148

DRAINAGE AREA	= 8.05 HA
DESIGN FREQUENCY	= 50 YRS
DESIGN DISCHARGE	= 1.78 CMS
DESIGN HW ELEVATION	= 76.62 M
100 YEAR DISCHARGE	= 1.87 CMS
100 YEAR HW ELEVATION	= 76.70 M
OVERTOPPING FREQUENCY	= 100+ YRS
OVERTOPPING DISCHARGE	= 2.00 CMS
OVERTOPPING ELEVATION	= 80.10 M

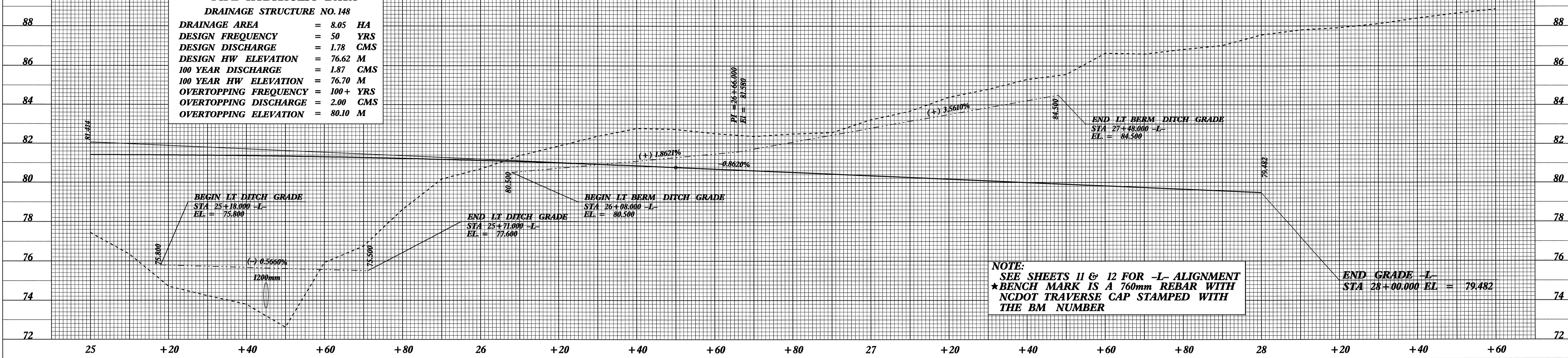

NOTE:
SEE SHEETS 11 & 12 FOR -L- ALIGNMENT
★BENCH MARK IS A 760mm REBAR WITH
NCDOT TRAVERSE CAP STAMPED WITH
THE BM NUMBER

07-MAR-2008 11:33

★BM # BY2-201 EL 94.595
4.790m RT -Y2- STA 11+29.454

★BM # BY1-104 EL 87.610
2.066m RT -I1Y1- STA 19+51.187

-YREV-

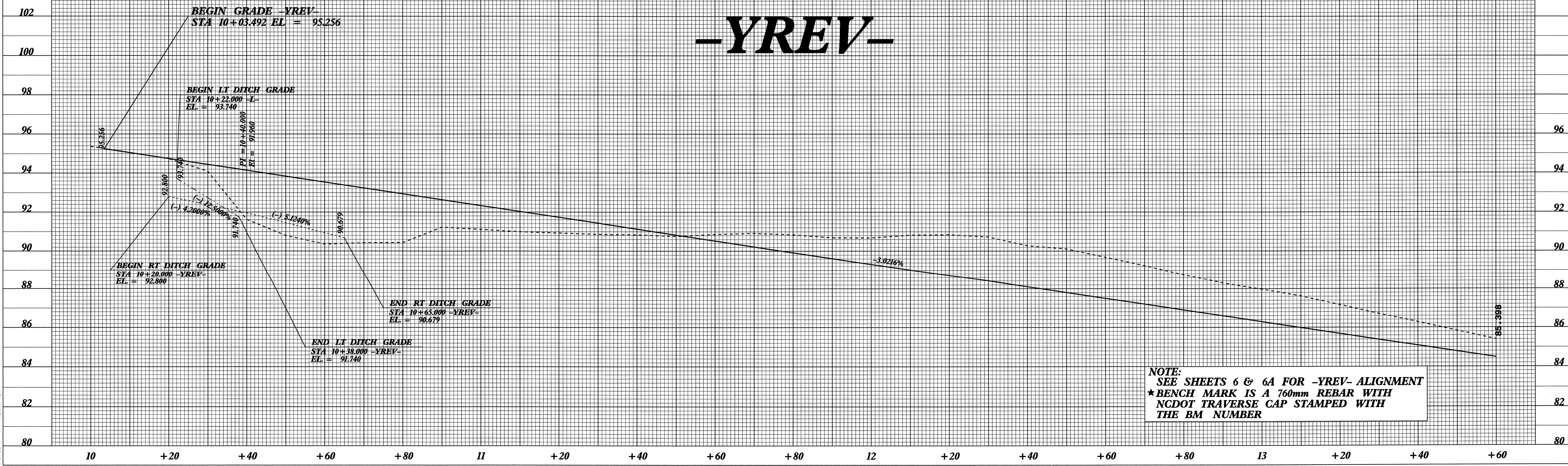

NOTE:
SEE SHEETS 6 & 6A FOR -YREV- ALIGNMENT
★BENCH MARK IS A 760mm REBAR WITH
NCDOT TRAVERSE CAP STAMPED WITH
THE BM NUMBER

BCFowler 07-MAR-2008 11:33 \\intermap\p1