

15-MAR-2005 15:11
JL Teague
R:\Projects\2005\15-MAR-2005\15-MAR-2005.dwg

★BM # BL-720 EL. 79.117
15.644m RT -L- STA 22+28.404

★BM # BL-721 EL. 79.764
13.731m RT -L- STA 23+75.784

LEFT DITCH
RIGHT DITCH

METRIC

PROJECT REFERENCE NO. R-25524A SHEET NO. 41

ROADWAY DESIGN ENGINEER

HYDRAULICS ENGINEER

SEAL 3197
W. W. MUNFORD
3/14/05

SEAL 18533
T. M. BISHOP
3/17/05

CONST. REV.
R / W REV.

-Y2B-

PIPE HYDRAULIC DATA
DRAINAGE STRUCTURE NO. 158

DRAINAGE AREA	= 2.70 HA
DESIGN FREQUENCY	= 50 YRS
DESIGN DISCHARGE	= 0.68 CMS
DESIGN HW ELEVATION	= 75.59 M
100 YEAR DISCHARGE	= 0.72 CMS
100 YEAR HW ELEVATION	= 75.62 M
OVERTOPPING FREQUENCY	= 100+ YRS
OVERTOPPING DISCHARGE	= 1.50 CMS
OVERTOPPING ELEVATION	= 75.60 M

PI = 15+00.000
EL = 75.800 m
VC = 60 m
K = 46

PIPE HYDRAULIC DATA
DRAINAGE STRUCTURE NO. 164

DRAINAGE AREA	= 12.57 HA
DESIGN FREQUENCY	= 50 YRS
DESIGN DISCHARGE	= 2.94 CMS
DESIGN HW ELEVATION	= 3.09 M
100 YEAR DISCHARGE	= 3.09 CMS
100 YEAR HW ELEVATION	= 72.09 M
OVERTOPPING FREQUENCY	= 100+ YRS
OVERTOPPING DISCHARGE	= 7.00 CMS
OVERTOPPING ELEVATION	= 77.50 M

★BM # BL-722 EL. 76.161
4.331m RT -L- STA 25+12.682

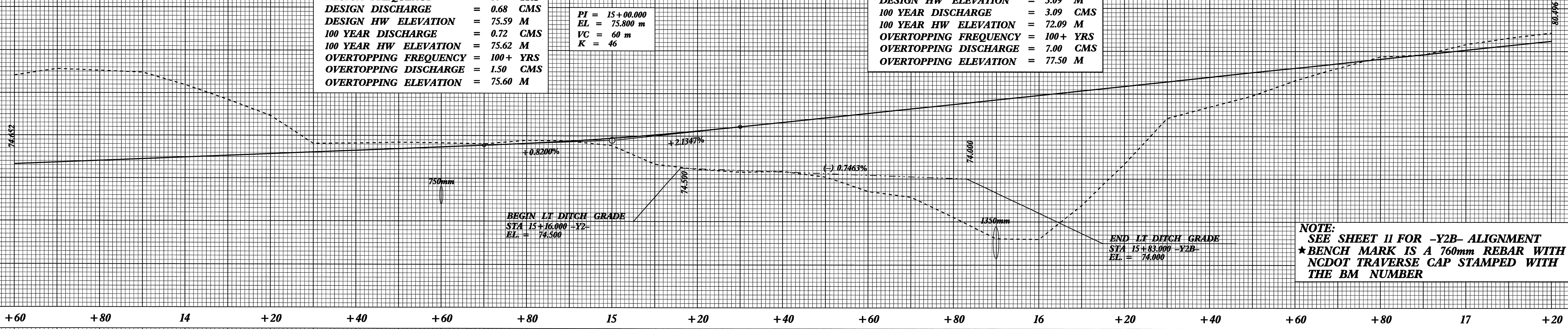

★BM # BL-723 EL. 83.504
23.866m RT -L- STA 26+45.037

★BM # R-2552-15 EL. 87.156
47.166m RT -L- STA 27+66.382

-Y2B-

PI = 18+20.000
EL = 82.631 m
VC = 75 m
K = 40

END GRADE -Y2B-
STA 19+28.404 EL = 86.967

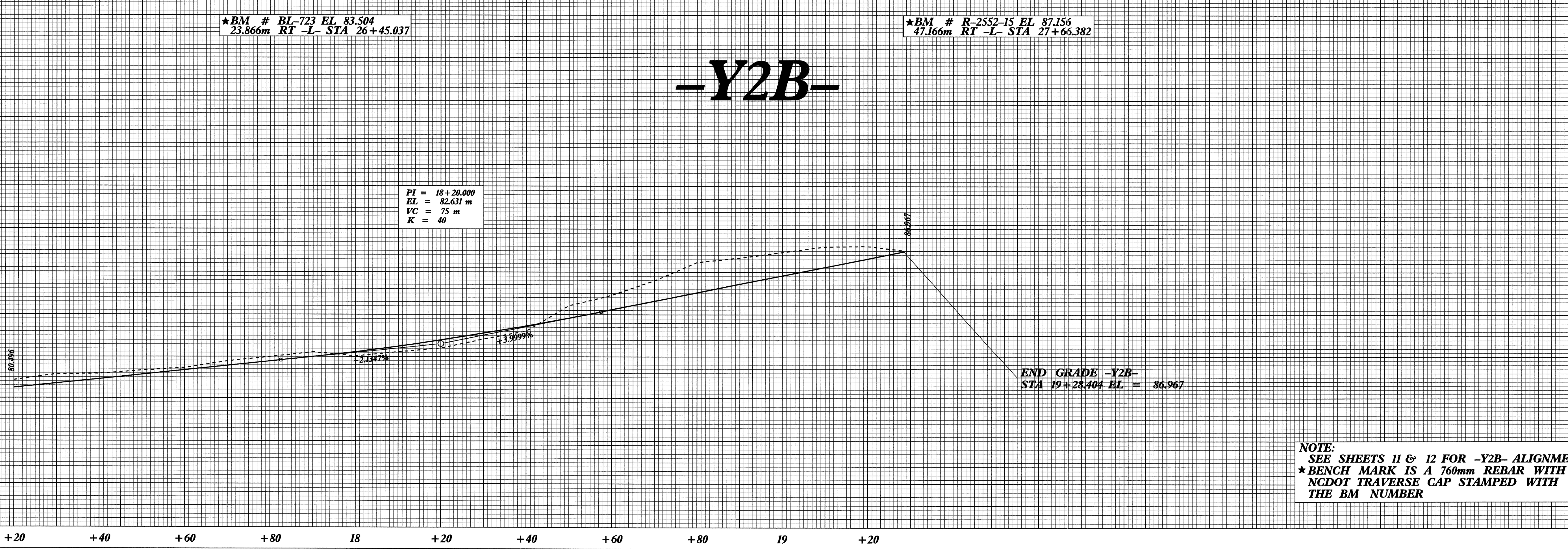

NOTE:
SEE SHEETS 11 & 12 FOR -Y2B- ALIGNMENT
★BENCH MARK IS A 760mm REBAR WITH
NCDOT TRAVERSE CAP STAMPED WITH
THE BM NUMBER